



22 WAY LIGHT CONTROL PLUG

TABLE OF CONTENTS

1 GENERAL

- 1.1 PURPOSE
- 1.2 CUSTOMER DRAWINGS
- 1.3 DELIVERY CONDITION
 - 1.3.1 22 WAY LIGHT CONTROL PLUG
 - 1.3.2 TERMINALS FOR 22 WAY LIGHT CONTROL PLUG

2 22 WAY LIGHT CONTROL PLUG

- 2.1 ASSEMBLY OF 22 WAY LIGHT CONTROL PLUG
- 2.2 TERMINAL INSERTION / REMOVAL INSTRUCTIONS
GENERATION Y, TE 2.8mm
- 2.3 APPLICABLE WIRES
- 2.4 22 WAY TPA (SPACER) INSERTION / REMOVAL INSTRUCTIONS
- 2.5 TPA (SPACER) REMOVED COMPLETELY FROM HOUSING

3 MATING AND UNMATING OF THE 22 WAY LIGHT CONTROL PLUG

- 3.1 MATING OF THE 22 WAY LIGHT CONTROL PLUG
- 3.2 UNMATING OF THE 22 WAY LIGHT CONTROL PLUG
- 3.3 MATING OF THE CPA (OPTIONAL)
- 3.4 UNMATING OF THE CPA (OPTIONAL)

1 GENERAL

1.1 PURPOSE

THIS SPECIFICATION DESCRIBES HOW YOU HAVE TO HANDLE THE 22 WAY LIGHT CONTROL PLUG COMPONENTS.

1.2 CUSTOMER DRAWINGS

THIS APPLICATION SPECIFICATION IS BASED ON THE LATEST VALID TE-CUSTOMER DRAWING.

C-2295163 22 WAY LIGHT CONTROL PLUG

INTERFACE SPECIFICATION:

114-94384 22 WAY LIGHT CONTROL PLUG INTERFACE SPECIFICATION

PRODUCT SPECIFICATION:

108-94601 22 WAY LIGHT CONTROL PLUG PRODUCT SPECIFICATION

1.3 DELIVERY CONDITION

1.3.1 22 WAY LIGHT CONTROL PLUG ASSEMBLY

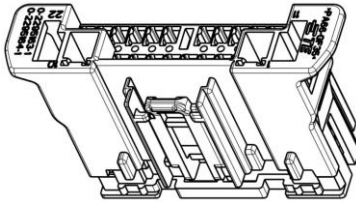
<p>22 WAY LIGHT CONTROL PLUG</p>	<p>0-2295163-1 CODING A / BLACK 0-2295163-2 CODING B / GREY 0-2295163-3 CODING C / BLUE 0-2295163-4 CODING D / GREEN</p>	
----------------------------------	--	---

1.3.2 TERMINALS FOR 22 WAY LIGHT CONTROL PLUG

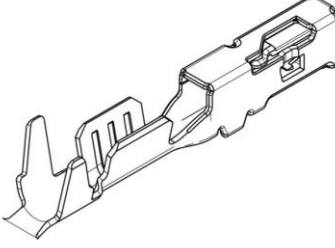
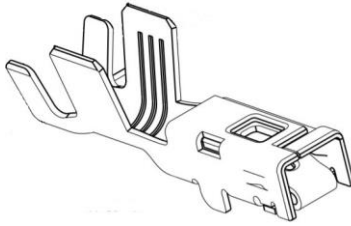
<p>GENERATION Y TERMINALS 0,35 - 0,75mm²</p>	<p>SEE CUSTOMER DRAWING C-2098762 APPL. SPEC. 114-13183</p>	
<p>TE 2,8mm TERMINALS 0.50 – 2.5mm² AWG14 - 20</p>	<p>SEE CUSTOMER DRAWING C-1326030 APPL. SPEC. 114-13013</p>	

2 22 WAY LIGHT CONTROL PLUG

2.1 ASSEMBLY OF 22 WAY LIGHT CONTROL PLUG

POS. 1 : 22 WAY RECEPTACLE HOUSING

POS. 2 : 22 WAY TPA (SPACER)

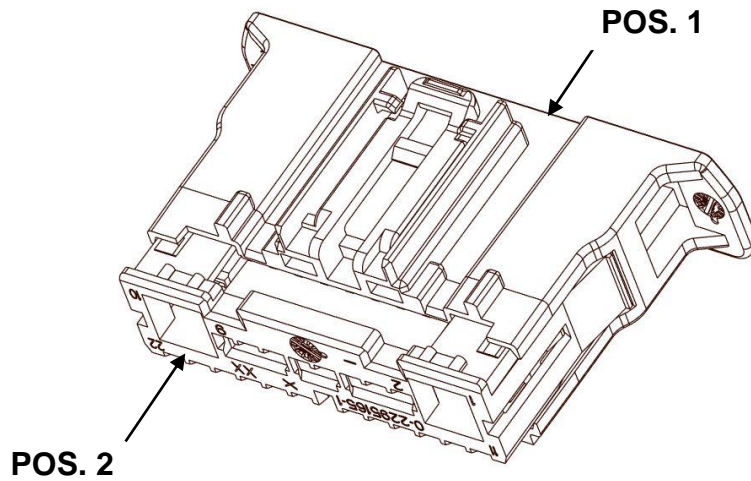

0-2295163-1 / CODING A / BLACK

0-2295163-2 / CODING B / GREY

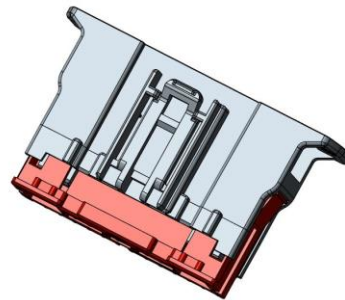
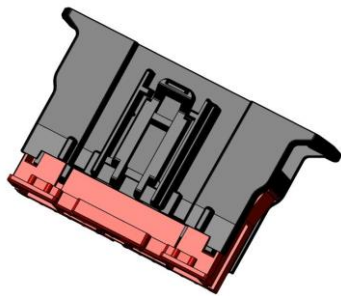

0-2295163-3 / CODING C / BLUE

0-2295163-4 / CODING D / GREEN

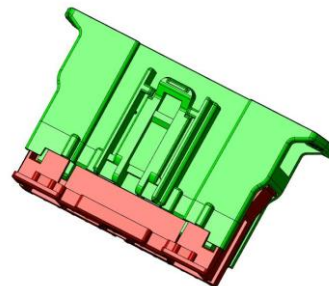
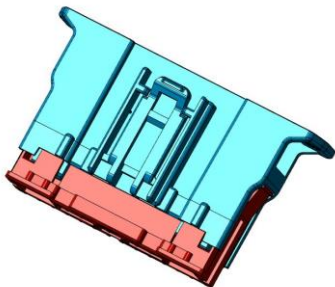

2.2 TERMINAL INSERTION / REMOVAL INSTRUCTIONS GENERATION Y, TE 2.8mm

GENERATION Y

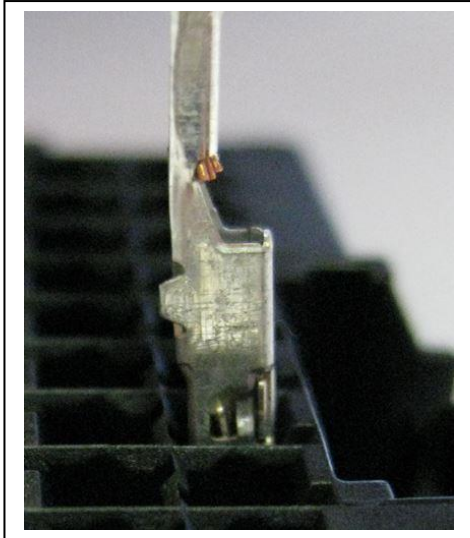

ORIENT GENERATION Y CONTACTS
ALWAYS AS SHOWN ON THE PHOTO

TE 2.8mm

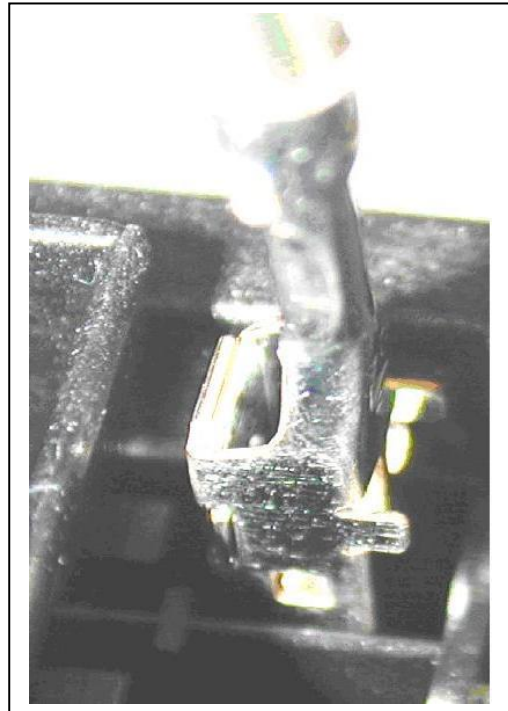

ORIENT TE 2.8mm CONTACTS ALWAYS AS
SHOWN ON THE PHOTO

PUSH ALL TERMINALS INTO THE CONNECTOR UNTIL THE LOCKING IS FELT OR HEARD BY AN AUDIBLE CLICK. CONTACT INSERTION ONLY POSSIBLE WITH TPA IN PRESET POSITION.

TERMINAL REMOVAL INSTRUCTION GENERATION Y, TE 2,8mm

**FOR REMOVING THE TERMINALS THE TPA (SPACER)
HAVE TO BE REMOVED COMPLETELY**

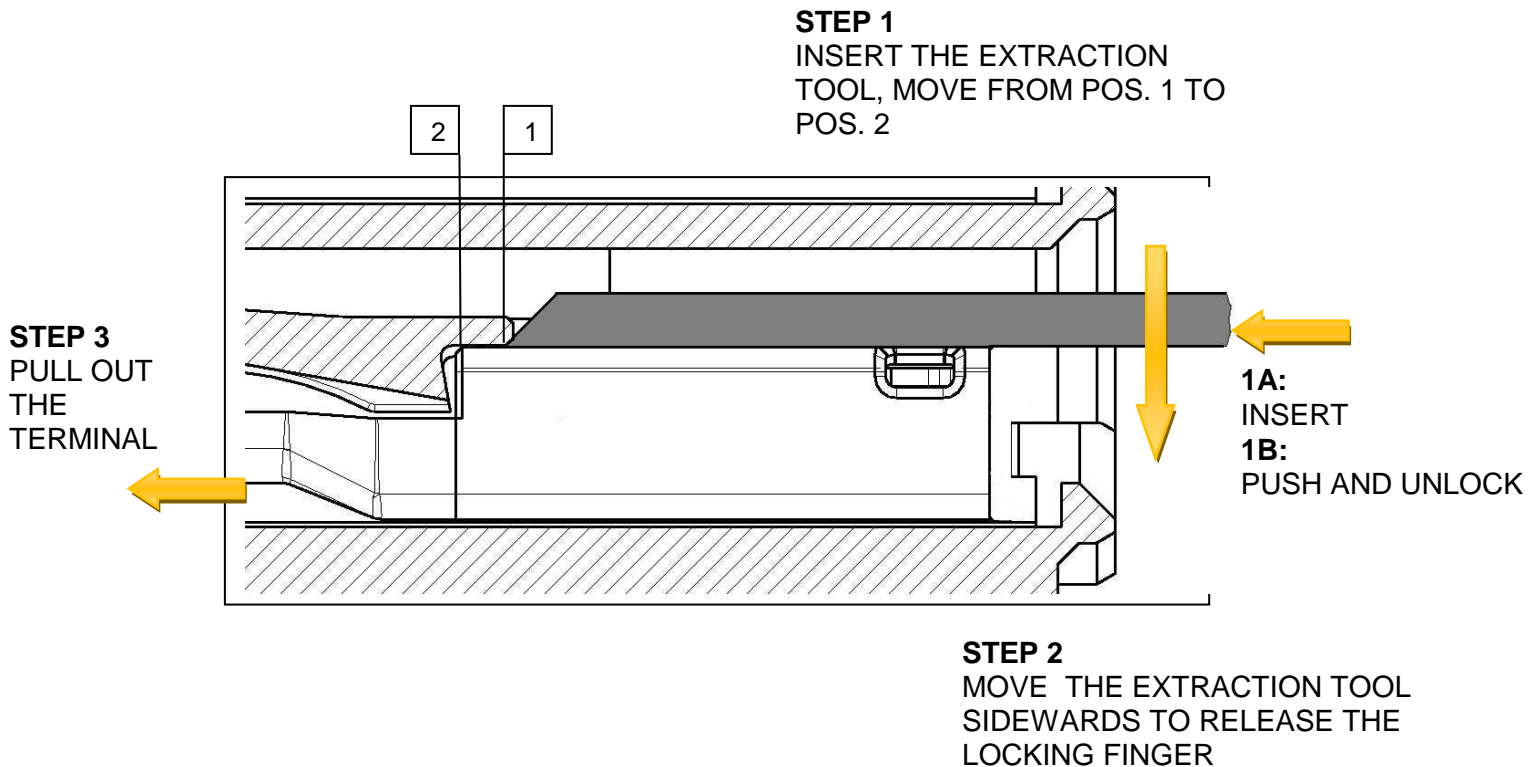

EXTRACTION TOOLS FOR TERMINALS:

GENERATION Y -> TE-NO: 1452426-1
TE 2.8mm -> SMALL SCREW DRIVER

2.3 APPLICABLE WIRES

CONTACT SYSTEM	WIRE SIZE [mm ²]	WIRE INSULATION DIAMETER [mm]
GENERATION Y	0,35mm ²	1,20 - 1,40 mm
	0,50mm ²	1,50 – 1,85 mm
	0,75 mm ²	1,60 – 2,06 mm
TE 2.8mm	0,50 mm ² - 1,00 mm ²	1,61 – 2,14 mm
	1,50 mm ² - 2,50 mm ²	2,24 - 2,85 mm
	AWG 20	1,40 – 1,85 mm
	AWG 18	1.60 – 2.06 mm
	AWG 16	1.88 – 2.34 mm
	AWG 14	2.34 – 2.69 mm

2.4 TPA (SPACER) INSERTION / REMOVAL INSTRUCTIONS

TPA (SPACER) INSERTION INSTRUCTIONS

DELIVERY CONDITION OF THE RECEPTACLE HOUSING IS WITH THE FRONT LOADED TPA (SPACER) IN PRESET POSITION.

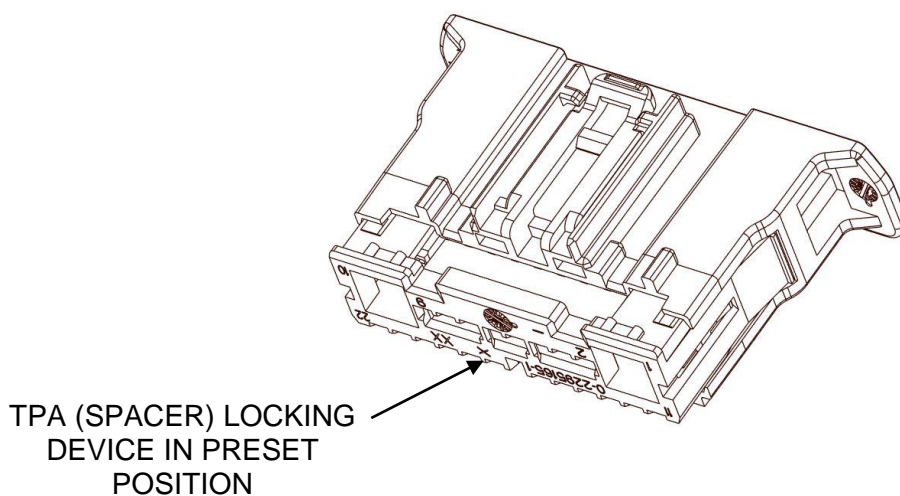

DO NOT PUSH THE SPACER FURTHER THAN THIS POSITION BEFORE CONTACT MOUNTING

AFTER CONTACT MOUNTING, THE SPACER SHOULD BE PUSHED IN END POSITION (2. LOCK IS NOW ACTIVE) TPA (SPACER) IS FLUSHED (ONE PLANE) WITH THE HOUSING.

AFTER SPACER INSERTION PLEASE CHECK THE SPACER FLATNESS. BOWING SPACER SURFACE SHOWS PARTIAL INSTALLED TERMINALS. SPACER SHOULD BE REMOVED AND CONTACTS POSITIONED PROPERLY.

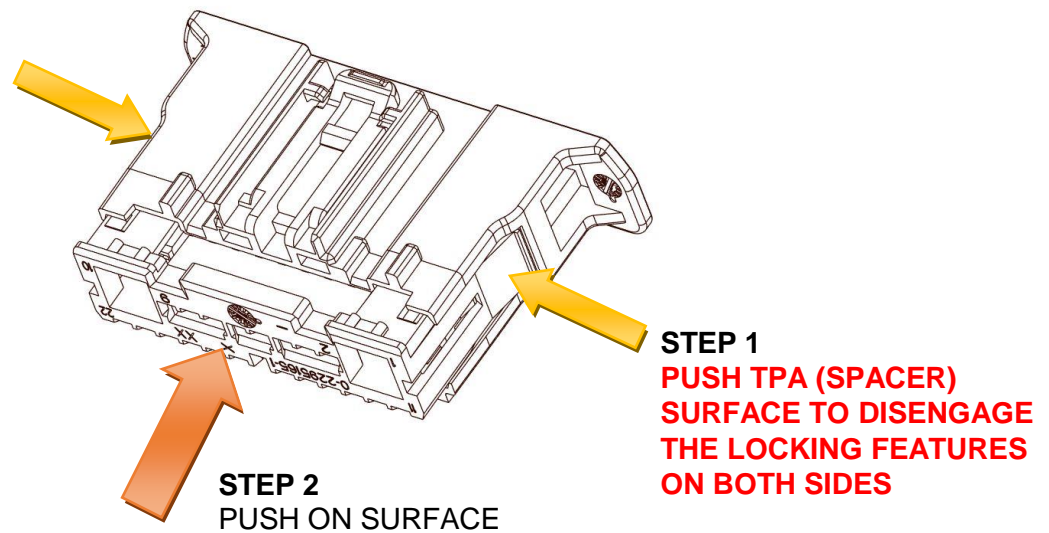

TPA (SPACER) IS NOW IN ENDLOCK POSITION

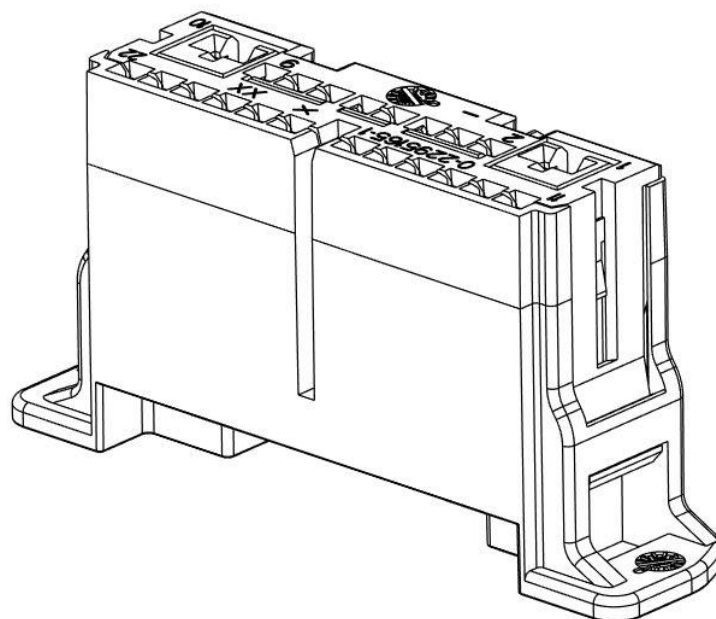

TPA (SPACER) REMOVAL INSTRUCTIONS

PUSH THE TPA (SPACER) ON BOTH SIDES WITH A **LITTLE SCREW DRIVER** AND PULL IT AWAY FROM THE HOUSING

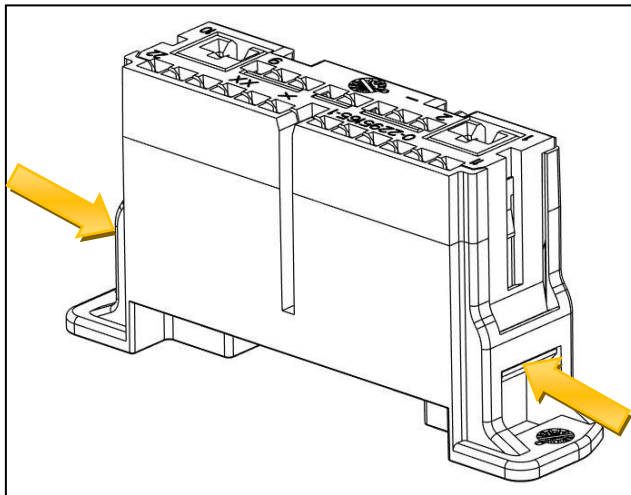

STEP 1
PUSH ON SPACER SIDE LATCH
WITH A **LITTLE SCREW DRIVER**
AND UNLOCK THE TPA (SPACER)
ON BOTH SIDES

STEP 2
LIFT AND MOVE ON THE
TPA (SPACER) TO
PRELOCK POSITION

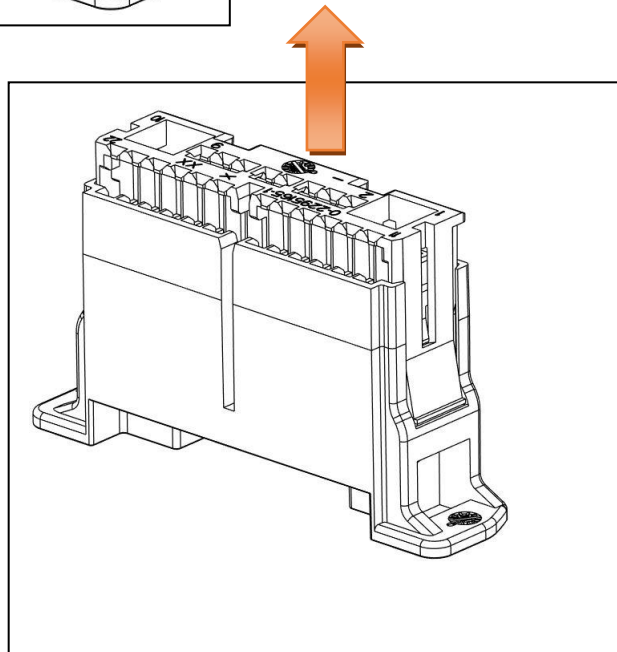

**FOR REMOVING THE TERMINALS THE TPA (SPACER) HAVE
TO BE REMOVED COMPLETELY**

2.5 HOW TO REMOVE TPA (SPACER) COMPLETELY FROM HOUSING

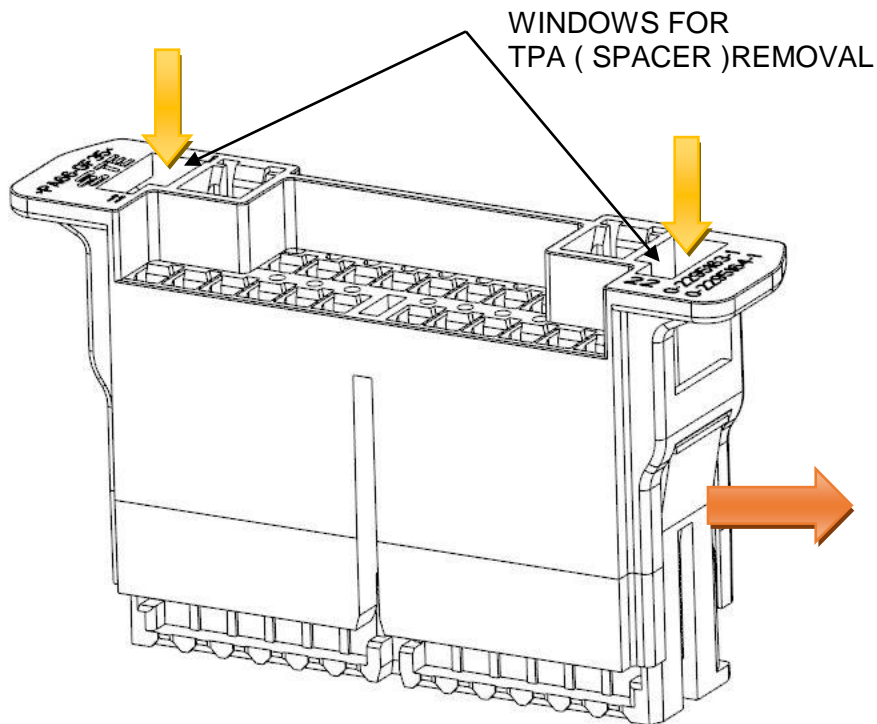

STEP 1
SLIDE WITH A **LITTLE SCREW DRIVER** FROM ABOVE INTO THE WINDOWS AND PRESS THE TPA (SPACER) TO THE SIDE

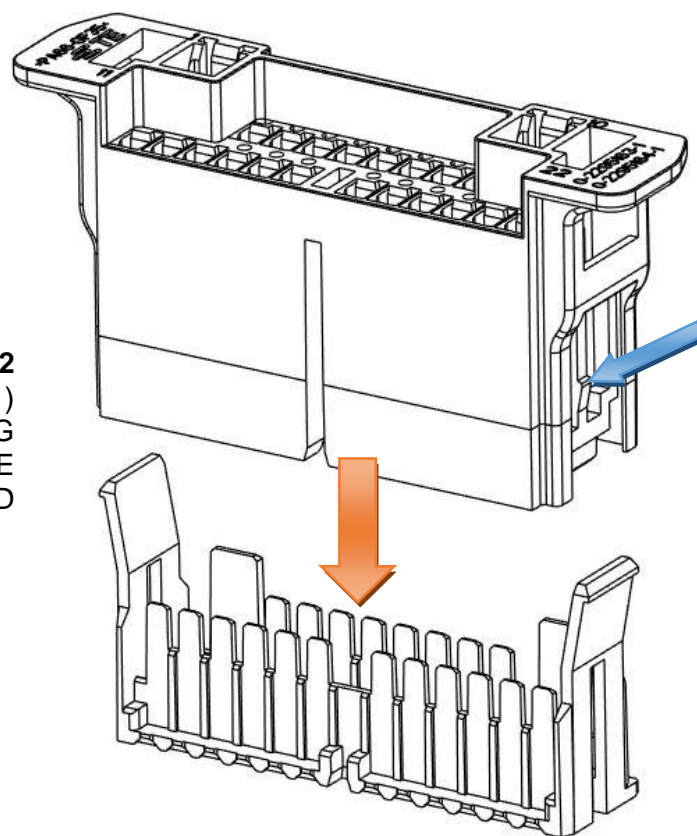

STEP 2
THE TPA (SPACER) WILL SKIP THE LOCKING HOOKS CAN BE REMOVED

3 MATING AND UNMATING OF THE 22 WAY LIGHT CONTROL PLUG

3.1 MATING OF THE 22 WAY LIGHT CONTROL PLUG

**FOR APPLICATIONS USING MORE THAN 20V:
DO NOT HOT MATE / CONNECT OR DISCONNECT CONNECTOR UNDER LOAD**

TE-INTERFACE SPECIFICATION 114-94384

CODING A

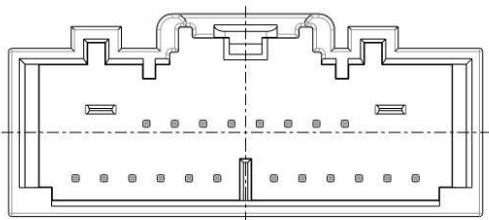

CODING B

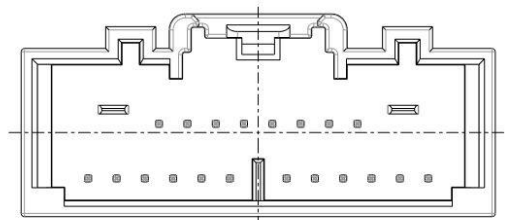

CODING C

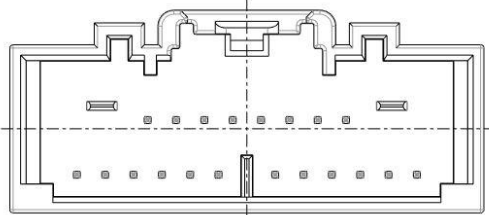

CODING D

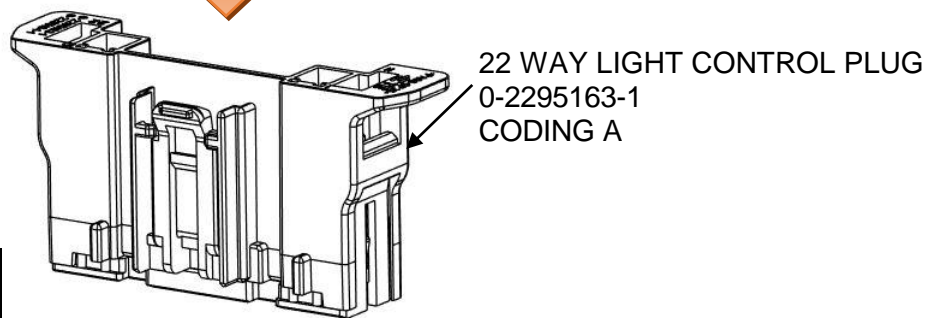
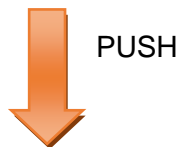
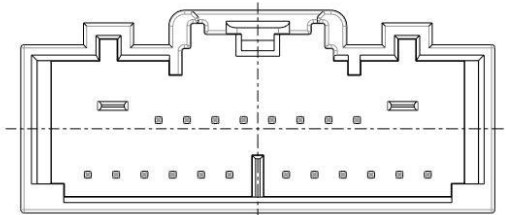

**NOTICE THE
DIFFERENT CODINGS**

**COUNTERPART IS
NOT PRODUCED BY
TE CONNECTIVITY**

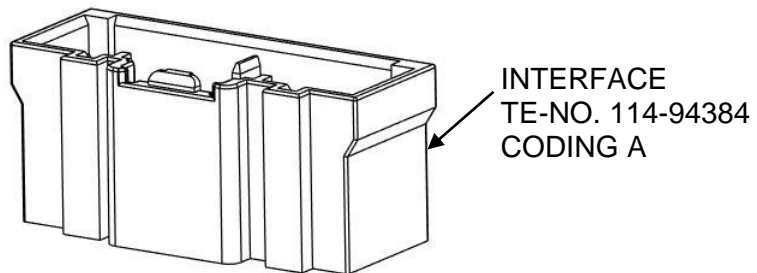

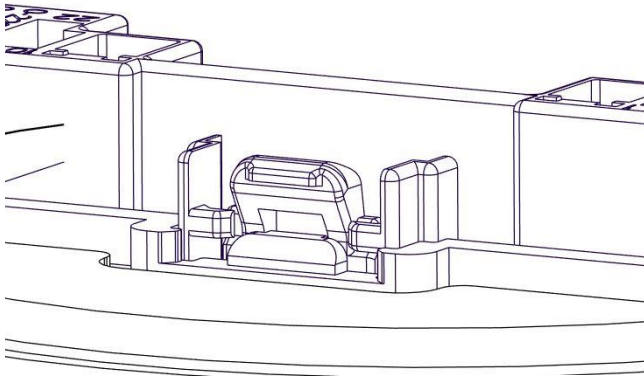

INSERT 22 WAY LIGHT CONTROL PLUG UNTIL IT STOPS

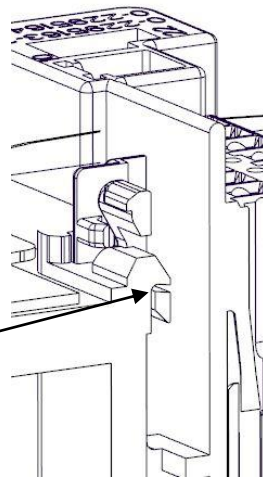

CLICK

YOU CAN HEAR A CLICK BY LOCKING OF THE RECEPTACLE HOUSING!

3.2 UNMATING OF THE 22 WAY LIGHT CONTROL PLUG

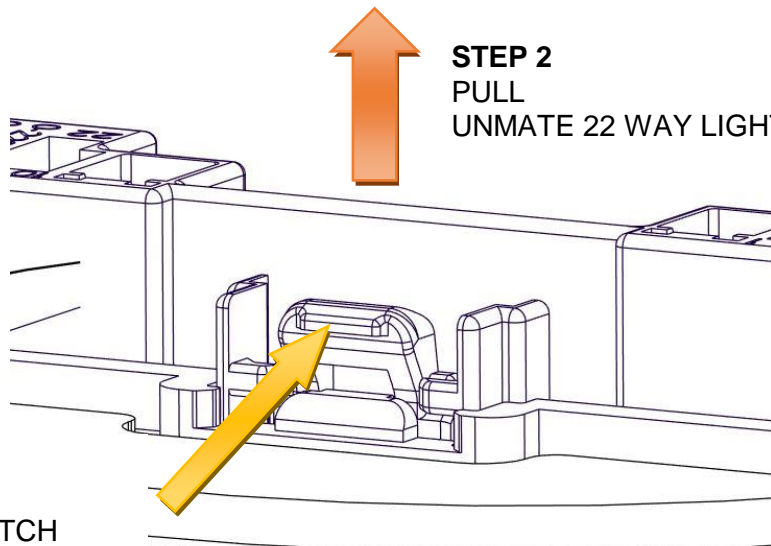

STEP 1
PUSH
RELEASE LATCH

STEP 2
PULL
UNMATE 22 WAY LIGHT CONTROL PLUG

PUSH THE LOCKING FEATURE AND REMOVE THE RECEPTACLE HOUSING FROM TAB HOUSING OR HEADER.

3.3 MATING OF THE CPA (OPTIONAL)

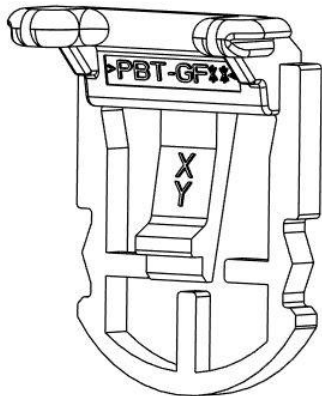

CPA
TE-NO: 8-1419168-4

**CPA IS AN OPTIONAL PART.
THIS IS NOT A PART OF ACTUAL SERIES PRODUCTION**

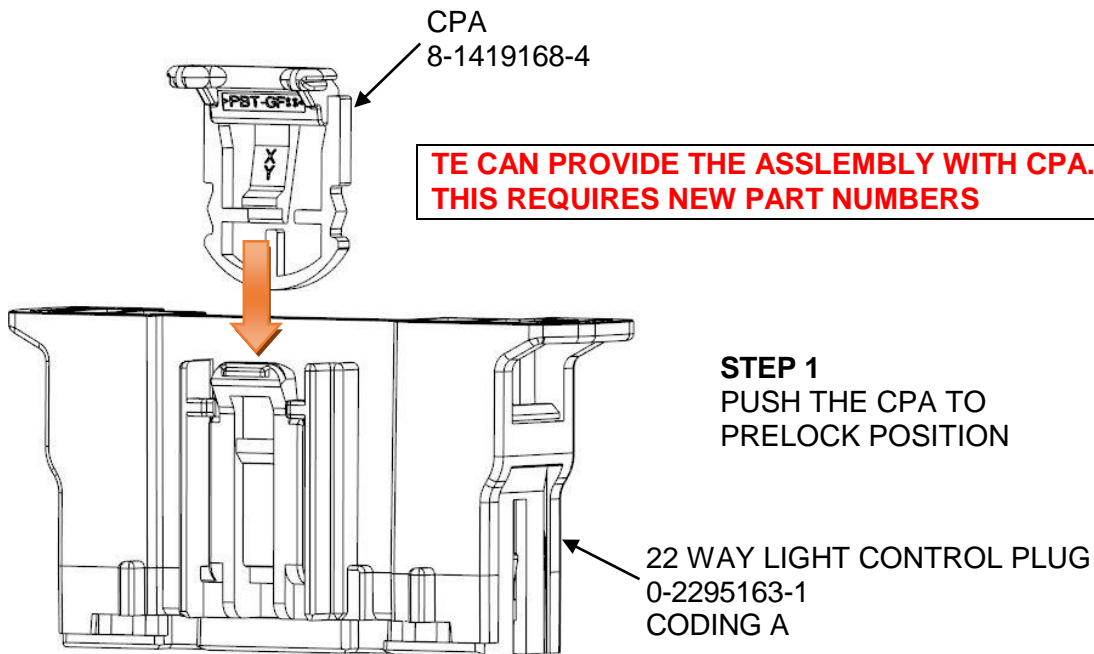

**TE CAN PROVIDE THE ASSEMBLY WITH CPA.
THIS REQUIRES NEW PART NUMBERS**

STEP 1
PUSH THE CPA TO
PRELOCK POSITION

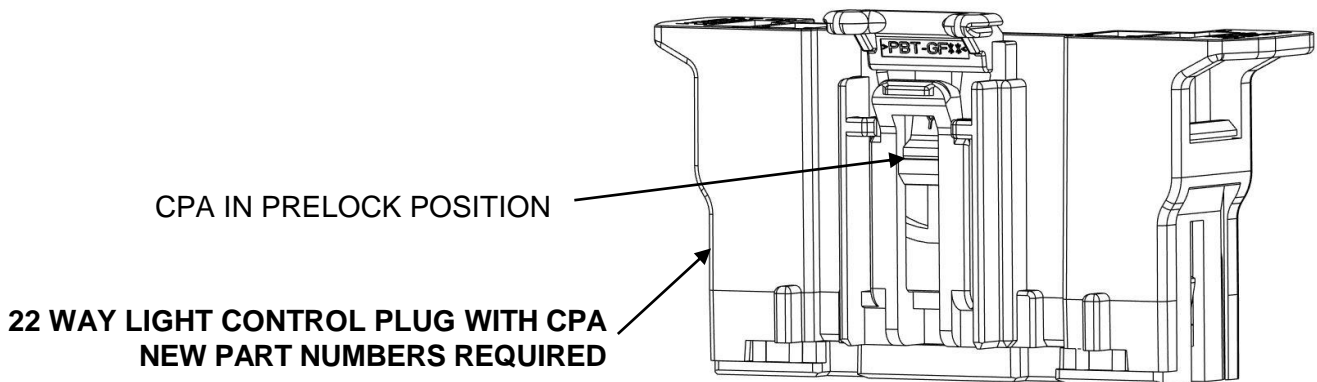

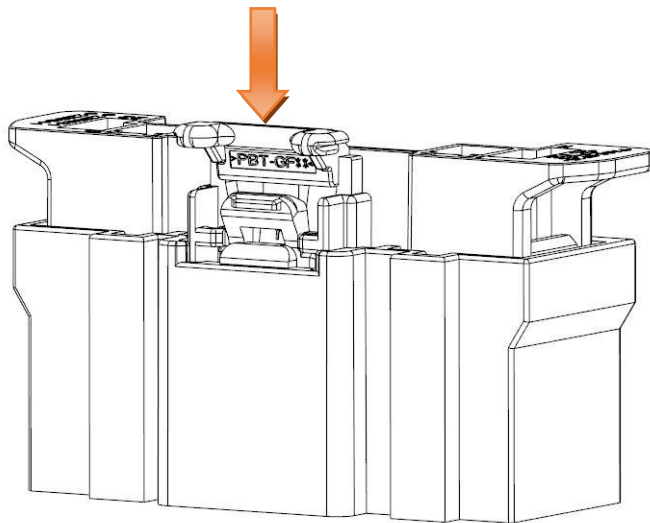

STEP 2
IF THE 22 WAY LIGHT CONTROL
PLUG INSERT INTO THE
INTERFACE PUSH THE CPA TO
PRELOCK POSITION

CPA IN ENDLOCK POSITION

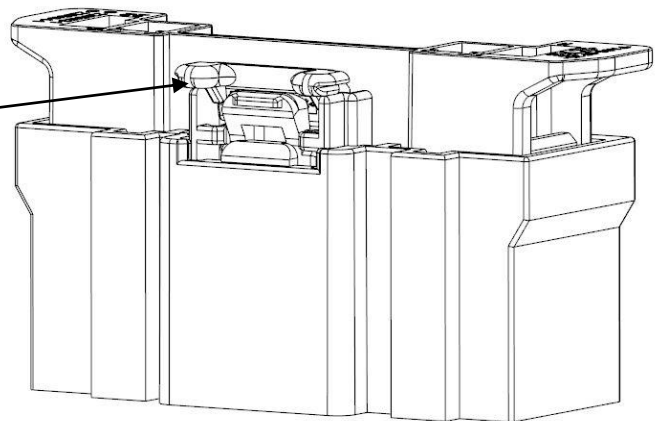

3.4 UNMATING OF THE CPA (OPTIONAL)

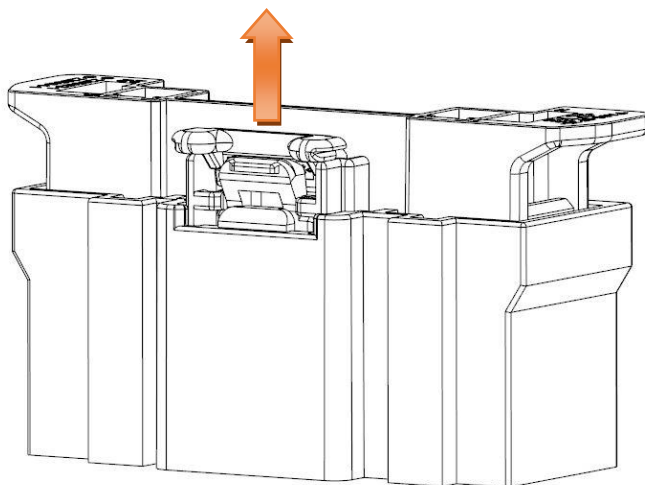

STEP 1
PULL THE CPA FROM ENDLOCK
TO PRELOCK POSITION

CPA IN PRELOCK POSITION

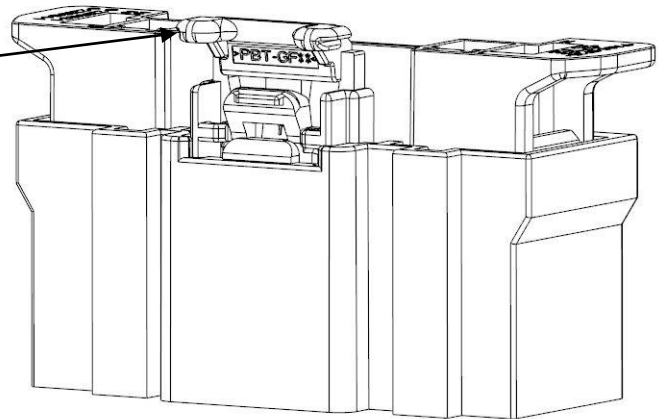

STEP 3
PULL
UNMATE 22 WAY LIGHT CONTROL PLUG

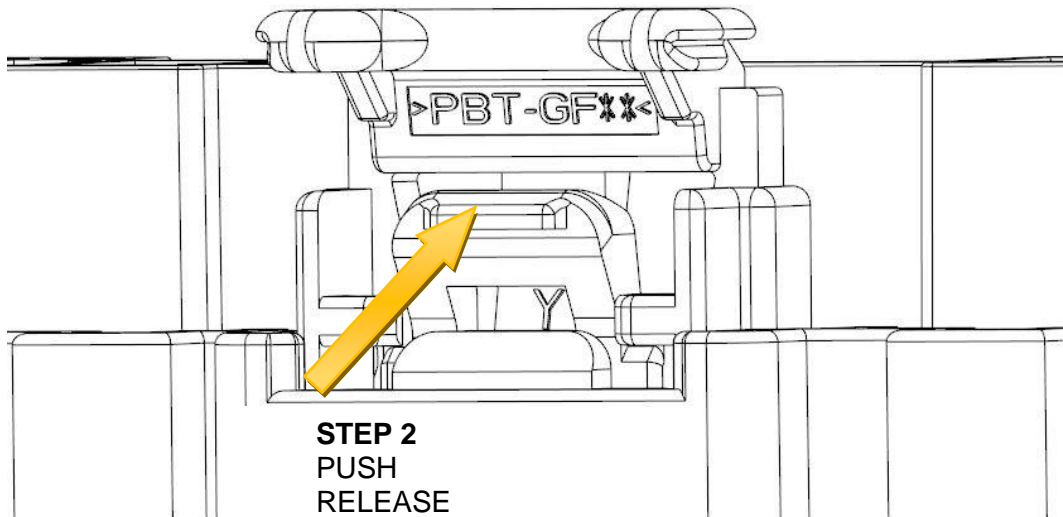

PUSH THE LOCKING FEATURE AND REMOVE THE RECEPTACLE HOUSING FROM TAB HOUSING OR HEADER.