

1. MATERIAL:
 BODY: ALUMINUM PER ASTM B317
 INSERT: BRASS PER ASTM B36
2. FINISH:
 BODY: .000600 MIN MATTE TIN PER ASTM B545
 OVER .000060 MIN NICKEL PER ASTM B733.
 INSERT: .000150 MIN MATTE NICKEL PER QQ-N-290
3. PTFE DRY LUBRICANT 360 DEGREE ON OUTER DIAMETER OF CRIMP BARREL IN ZONE SHOWN.
4. WIRE INSULATION RANGE: .425-.513.
5. SEE TE CONNECTIVITY APPLICATION SPEC. 114-32098 FOR APPLICATION REQUIREMENTS.
6. SEE TE CONNECTIVITY INSTRUCTION SHEET 408-32087 FOR TOOLING AND CRIMP INSTRUCTIONS, FIGURE 3 FOR WIRE STRIPPING DETAIL.

REVISIONS				
P.	LTN	DESCRIPTION	DATE	APVD
E		REV PER ECO 19-019314	2-27-20	CT PD

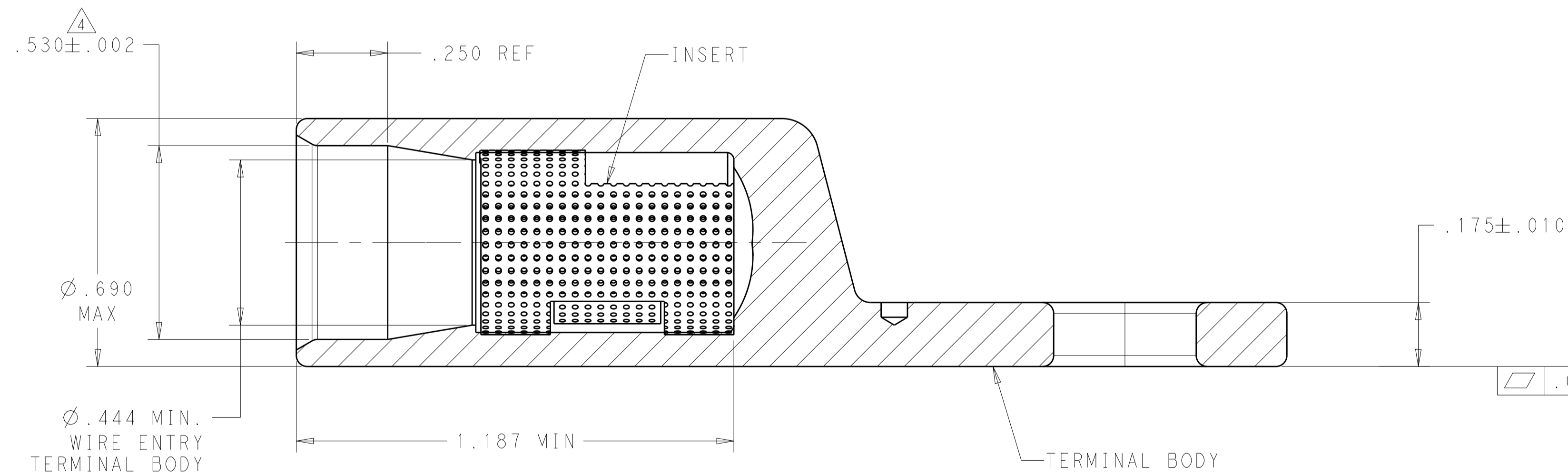
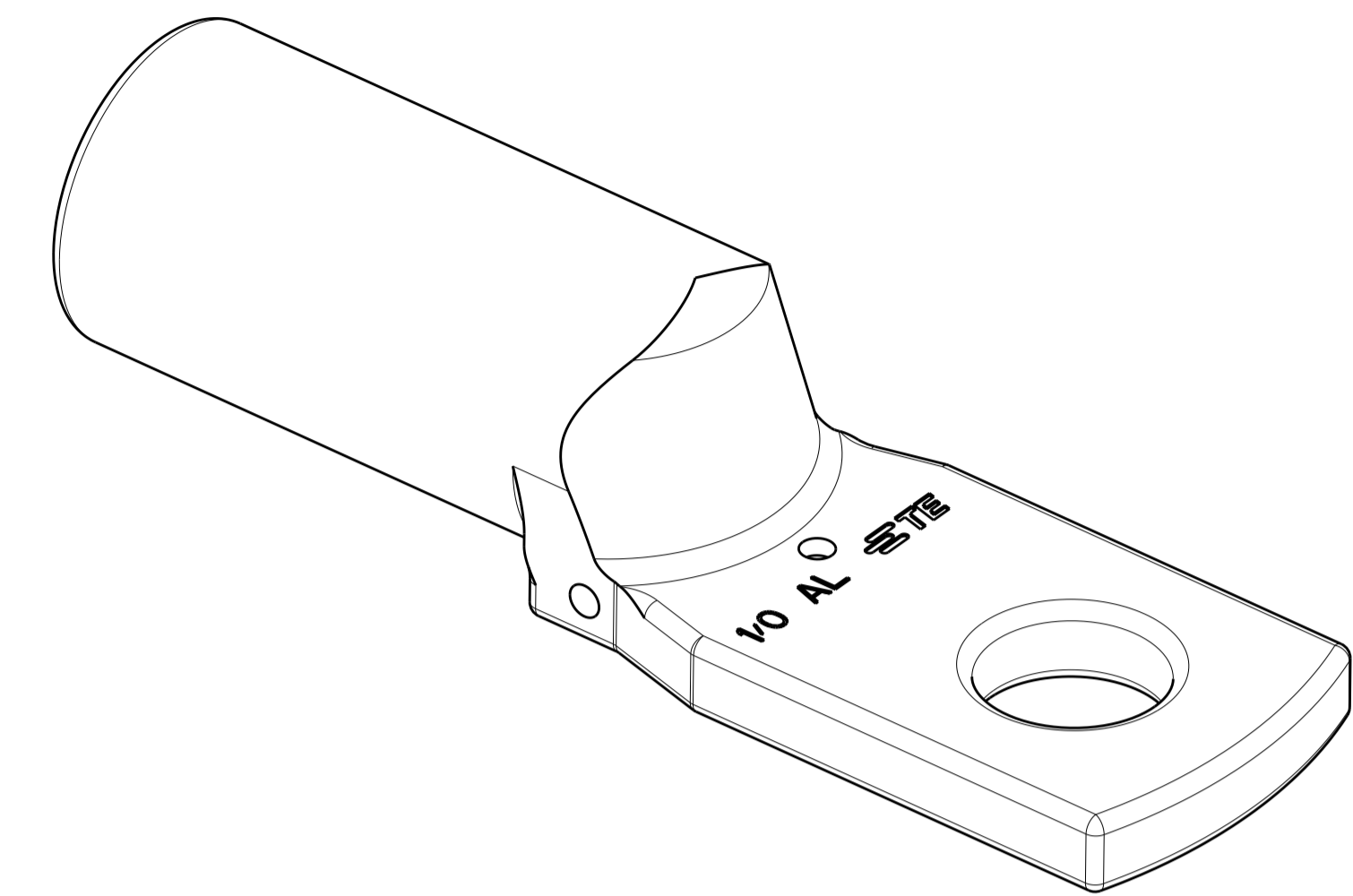
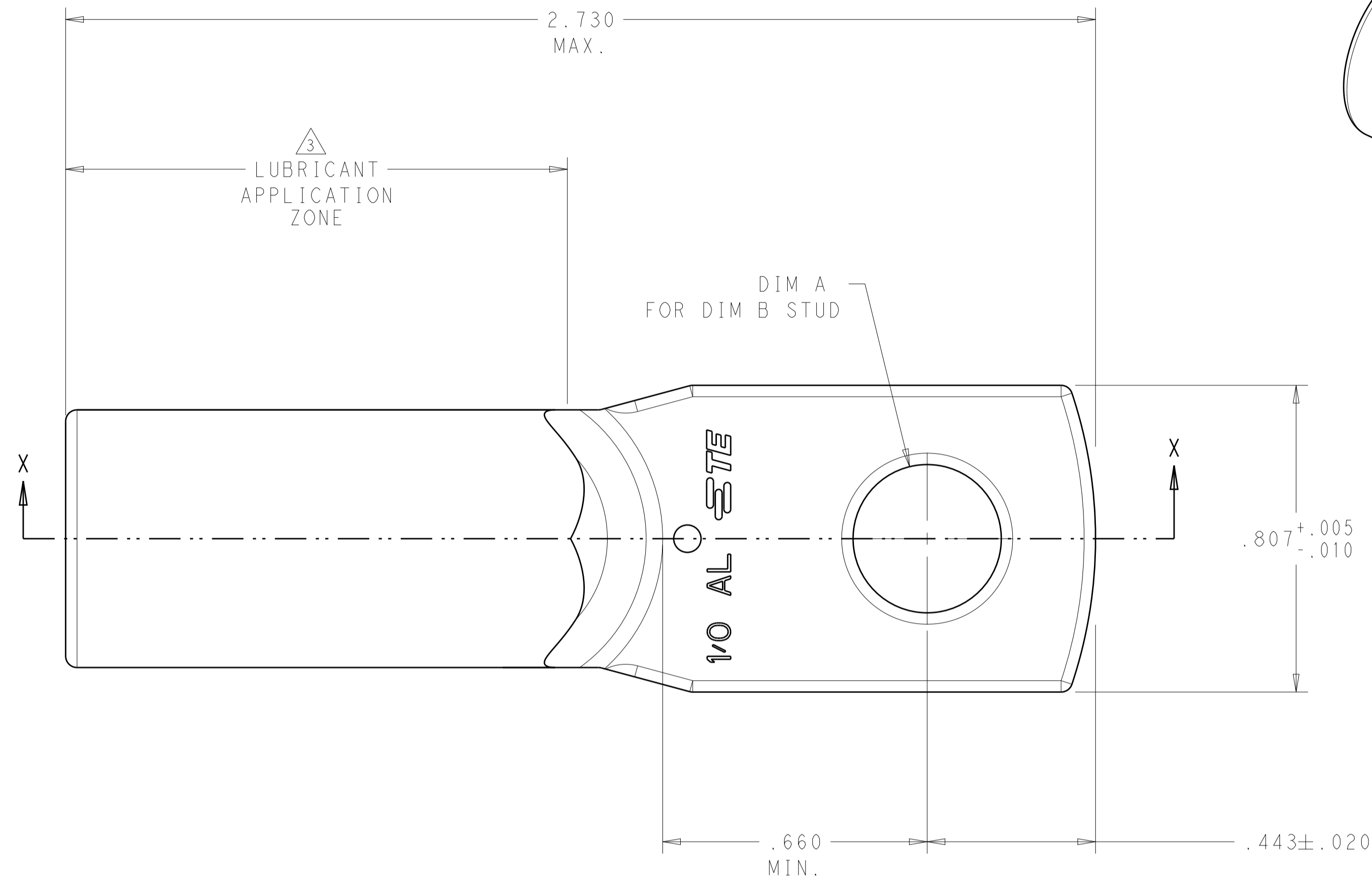

SECTION X-X

5/16	.328	2102572-3
3/8	.390	2102572-1
DIM B	DIM A	PART NO.

THIS DRAWING IS A CONTROLLED DOCUMENT.		DWN D. FABIAN 14NOV2011	NAME ASSEMBLY, ALUMINUM TERMINAL, STRAIGHT, SINGLE HOLE, 1/0
DIMENSIONS: IN		CHK DEROCK, KIM 28NOV2012	RESTRICTED TO
TOLERANCES UNLESS OTHERWISE SPECIFIED:		APVD DEROCK, KIM 28NOV2012	SIZE A 100779
0 PLC ±.1	1 PLC ±.01	PRODUCT SPEC	SCALE 4:1
2 PLC ±.005	3 PLC ±.005	APPLICATION SPEC	SHEET 1 OF 1
4 PLC ±.0005	ANGLES ±1°	FINISH SEE CALL-OUT	REV E
MATERIAL SEE CALL-OUT	FINISH SEE CALL-OUT	WEIGHT 21.22GRAMS	CUSTOMER DRAWING