

LOC		DIST		REVISIONS			
GP	00	P	LTN	DESCRIPTION	DATE	DWN	APVD
		5		ADDED NEW DASH NUMBER -4	03DEC2019	SH	SH
		6		GASKET EC CHANGE;-4 HSK DECREASE 0.5MM	28MAY2020	IT	SH
		A		ADD PN -5 WITH CUSTOMIZED HSK	16JUN2020	IT	SH
		A1		REVISED PER ECN-24-247077	11JAN2024	AB	SZ

- ⚠ MATERAIL : CAGE :0.4MM THICK NICKEL SILVER ALLOY;
 EMI SPRING: COPPER ALLOY;
 HEAT SINK CLIP: STAINLESS STEEL;
 HEAT SINK:ALUMINUM ALLOY;
 RECEPTACLE COVER:ZINC ALLOY;
- ⚠ FINISH: EMI SPRING 1.27um NICKEL PALTING OVER ALL;
 HEAT SINK:BLACK ANODIZED COATING;
 RECEPTACLE COVER: 1.27um MIN NICKEL PLATING OVER COPPER PLATING;
 HEAT SINK CLIP: PASSIVATE;
- 3.MATES WITH CFP MSA COMPLIANT TRANSCEIVERS.
- ⚠ DATUM AND BASIC DIMENSION ESTABLISHED BY CUSTOMER.
- 5.MINIMUM PC BOARD THICKNESS: SIGLE SIDE APPLICATIONS:2.0mm;
 BELLY TO BELLY APPLICATION:3.0MM
- ⚠.PADS AND VIAS CHASSIS GROUND;
- ⚠:REFERENCE APPLICATION SPEC 114-32146,FOR
 RECOMMENDED DRILL HOLE DIAMETER AND PLATING THICKNESS.

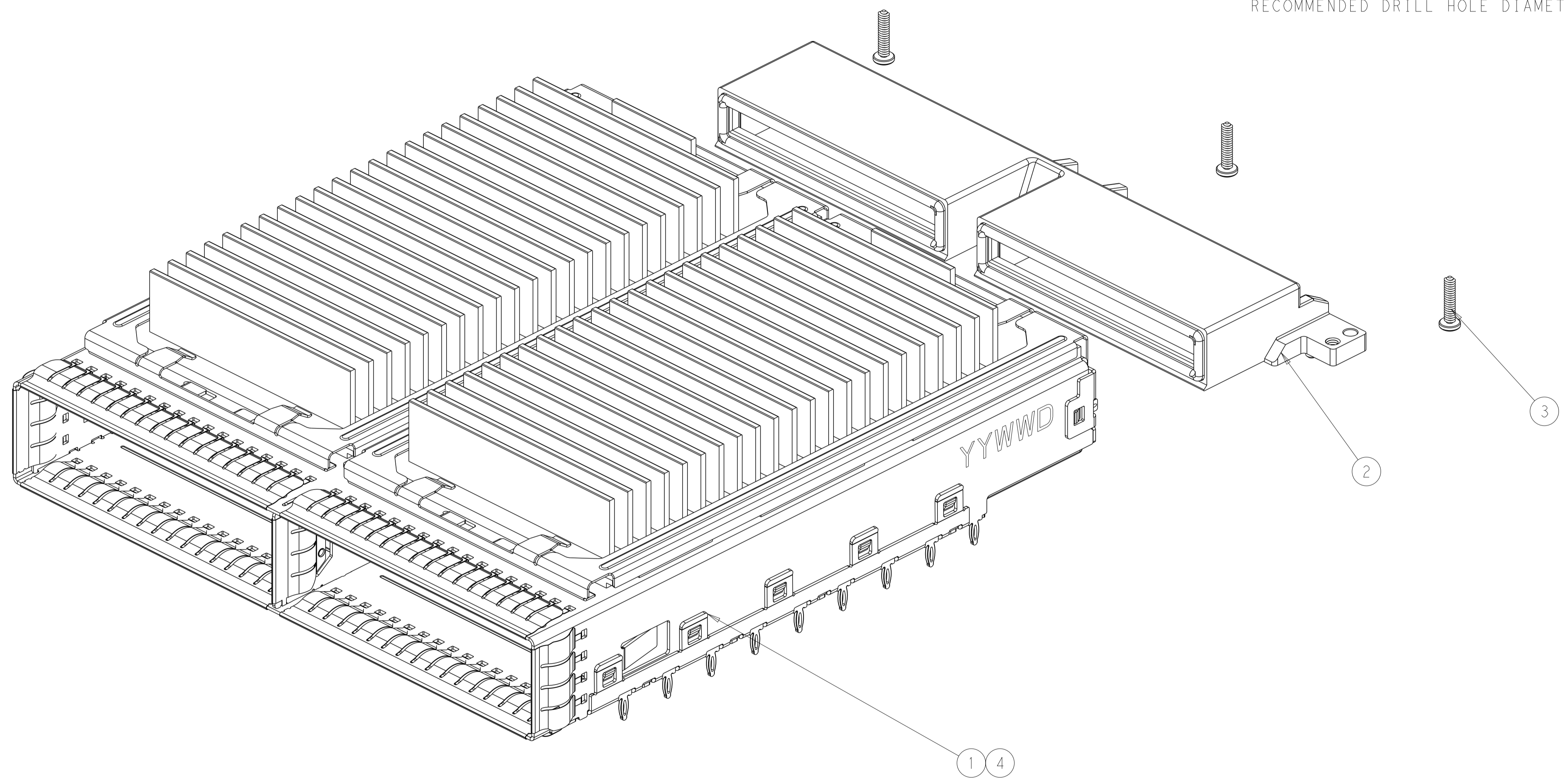

1	-	-	-	-	2293288-9	CAGE ASSEMBLY WITH H/S,CFP2 1X2	4
-	-	1	-	-	2293288-8	CAGE ASSEMBLY WITH H/S,CFP2 1X2	
-	1	-	-	-	2293288-6	CAGE ASSEMBLY WITH H/S,CFP2 1X2	
-	-	-	-	-	2293288-2	CAGE ASSEMBLY WITH H/S,CFP2 1X2	
3	3	3	3	3	2292789-1	SCREW	3
1	1	1	1	1	2287077-1	RECEPTACLE COVER ASSEMBLY	2
-	-	-	-	-	2293288-1	CAGE ASSEMBLY WITH H/S,CFP2 1X2	1
-6	-5	-4	-2	-1	PAR NUMBER	DESCRIPTION	ITEM

THIS DRAWING IS A CONTROLLED DOCUMENT. DWN: Charles Wan 31JAN2015
 CHK: Sean Han 31JAN2015

STE TE Connectivity

NAME: CFP2 HARDWARE AND RECEPTACLE ASSEMBLY, 1X2

PRODUCT SPEC: 108-32103
 APPLICATION SPEC: 114-32146

SIZE: A1 CAGE CODE: - DRAWING NO: C=2287075 RESTRICTED TO: -

CUSTOMER DRAWING SCALE: 1:1 SHEET: 1 OF 8 REV: A1

LOC	DIST	REVISIONS			
P	LYR	DESCRIPTION	DATE	DMN	APVD
GP	00	SEE SHEET 1	-	-	-

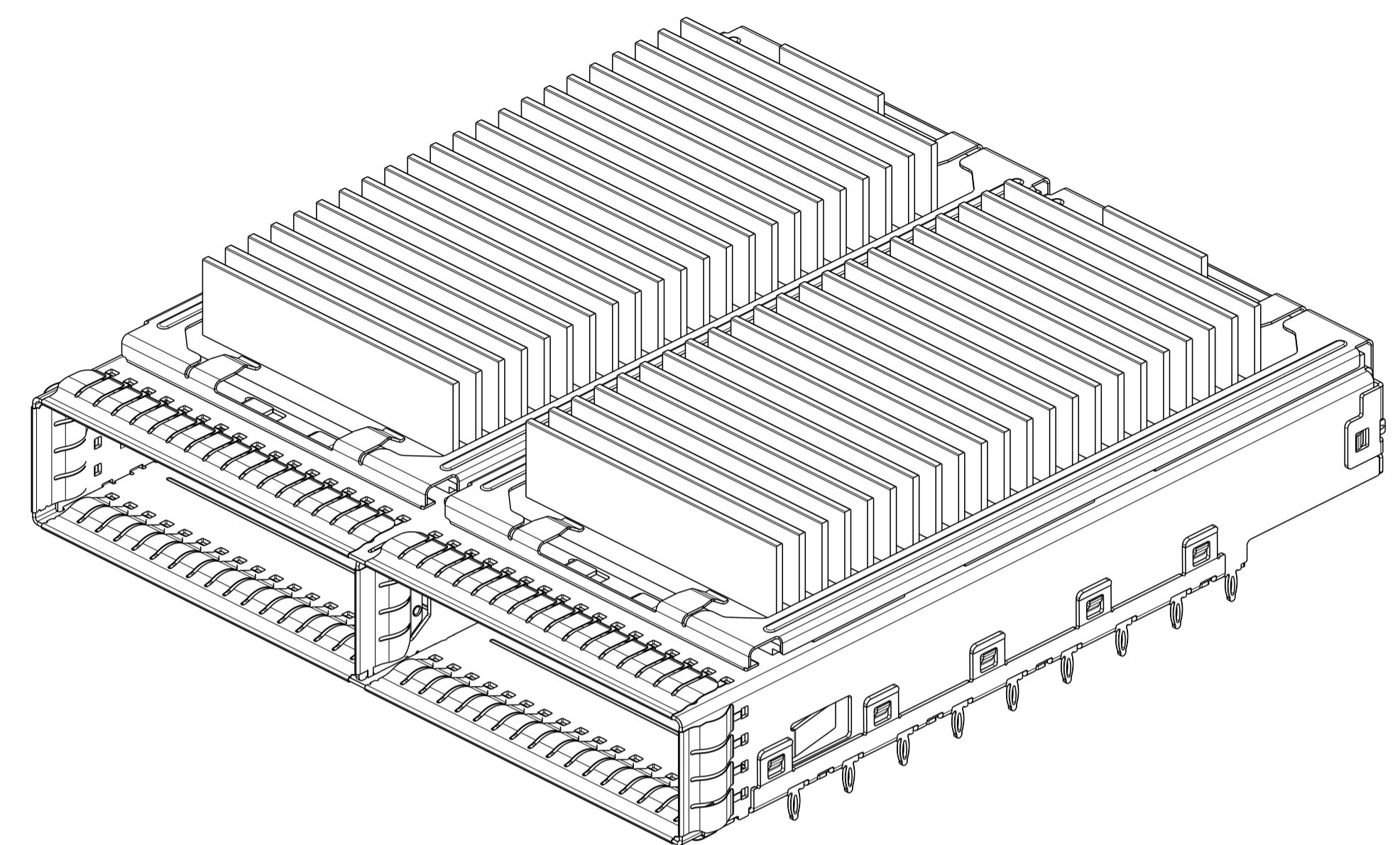
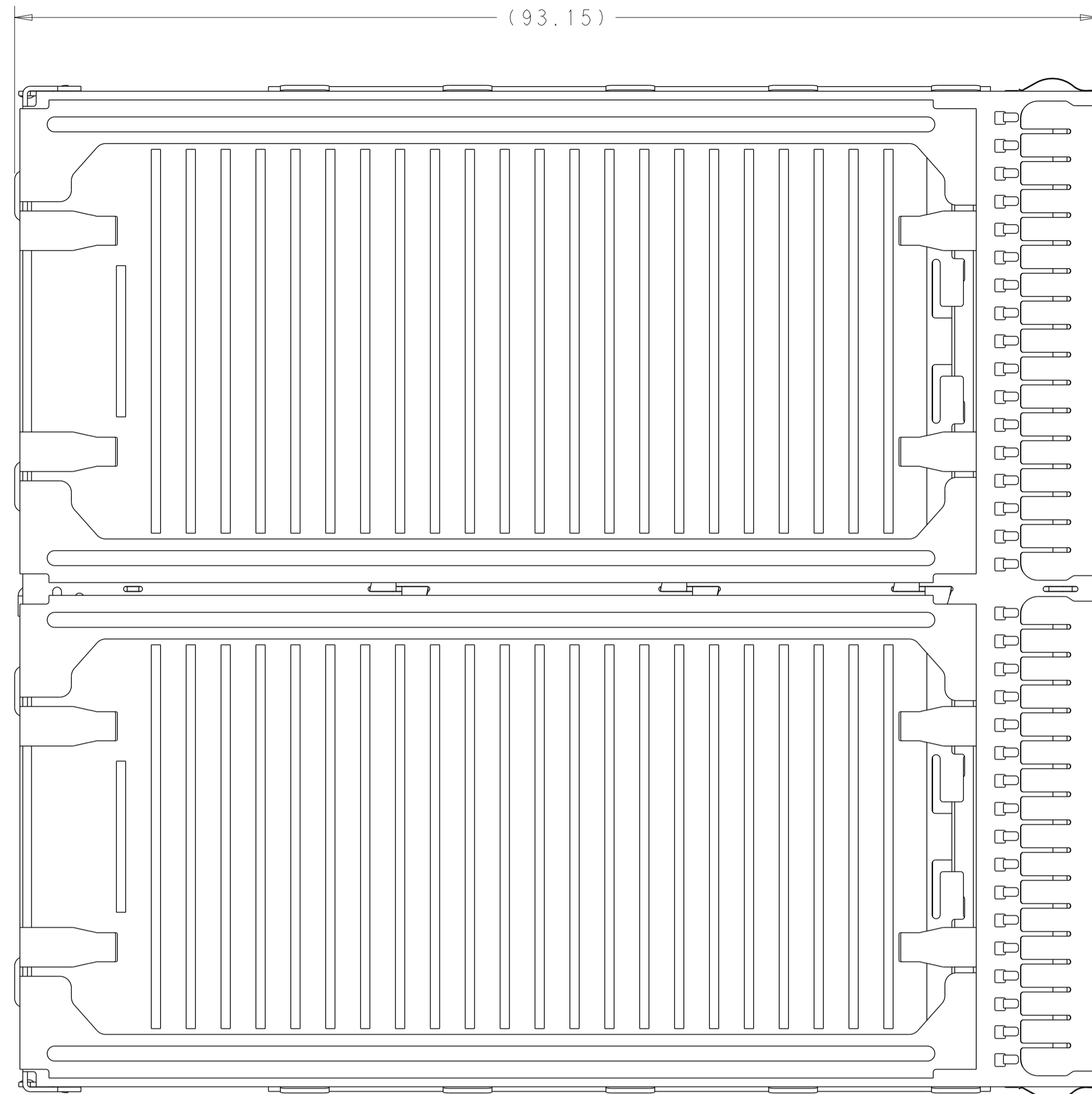

2293288-1 3D VIEW
SCALE 2:1

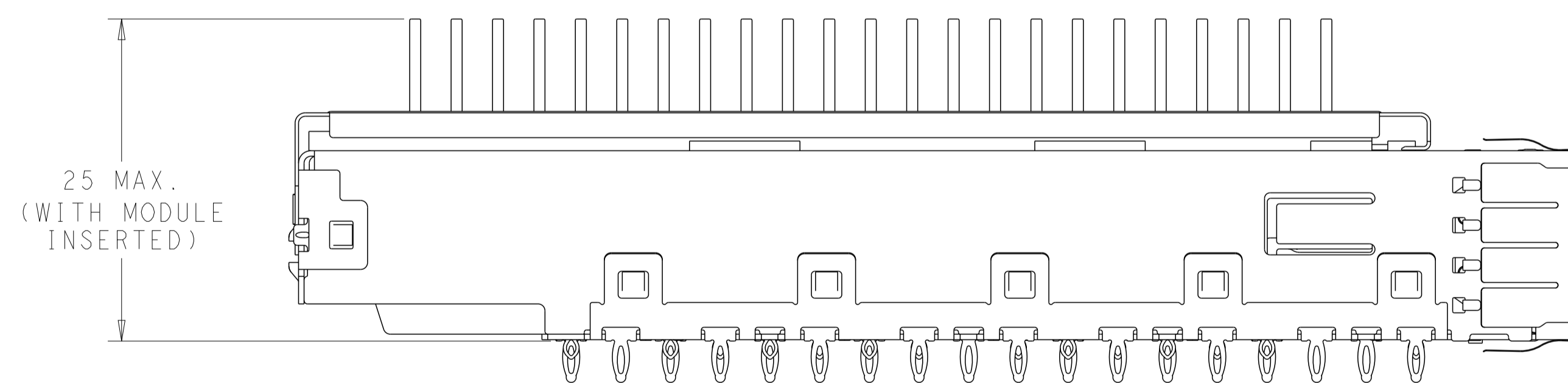

2293288-1 AS SHOWN

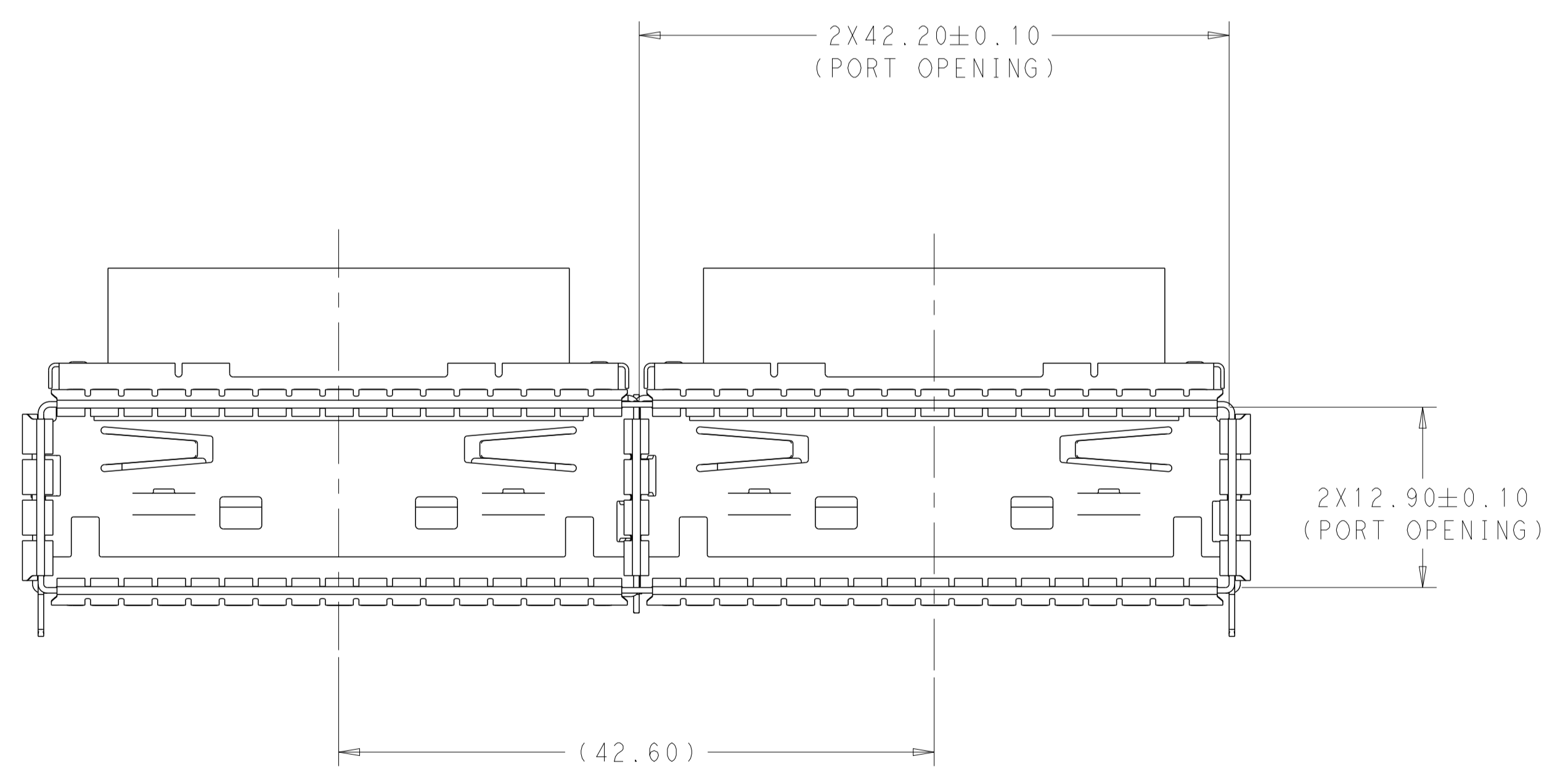

THIS DRAWING IS A CONTROLLED DOCUMENT.		DMN Charles Wan 31JAN2015	TE Connectivity NAME CFP2 HARDWARE AND RECEPTACLE ASSEMBLY, 1X2
DIMENSIONS:		CHK Sean Han 31JAN2015	
mm	0 PLC ±0.25 1 PLC ±0.13 2 PLC ±0.10 3 PLC ±0.10 4 PLC ±0.10 ANGLES ±0.10	APVD Sean Han 31JAN2015	PRODUCT SPEC 108-32103
MATERIAL		FINISH	APPLICATION SPEC 114-32146
		WEIGHT	SIZE A1
		CUSTOMER DRAWING	CAGE CODE 2287075
		SCALE 1:1	RESTRICTED TO SHEET 2 OF 8 REV A1

LOC	DIST	REVISIONS					
GP	00	P	LYR	DESCRIPTION	DATE	DWN	APVD
		-		SEE SHEET 1			

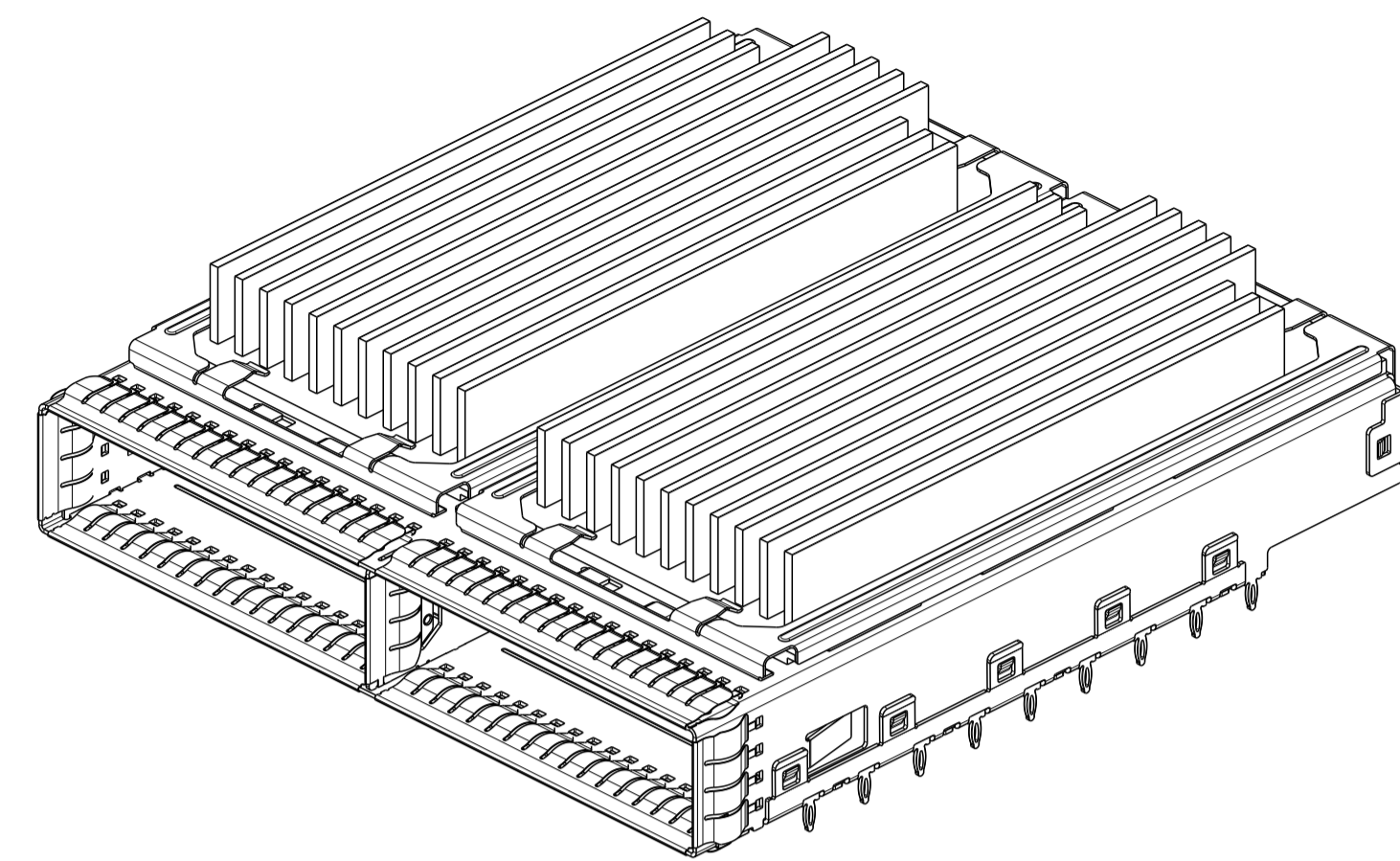

2293288-2 3D VIEW

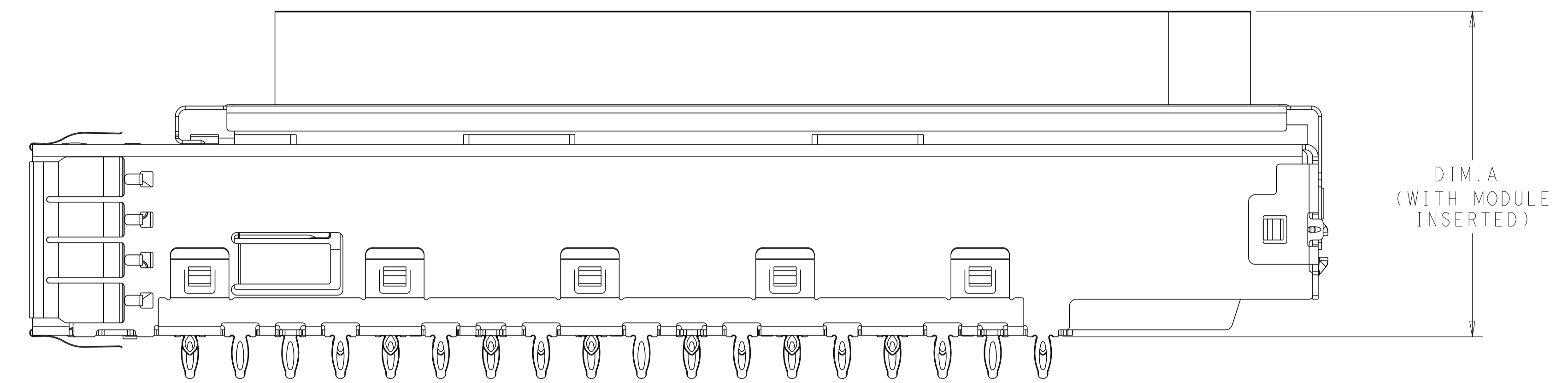

2293288-2, -6
 OTHER DIMENSIONS
 SAME AS 2293288-1
 SCALE 4:1

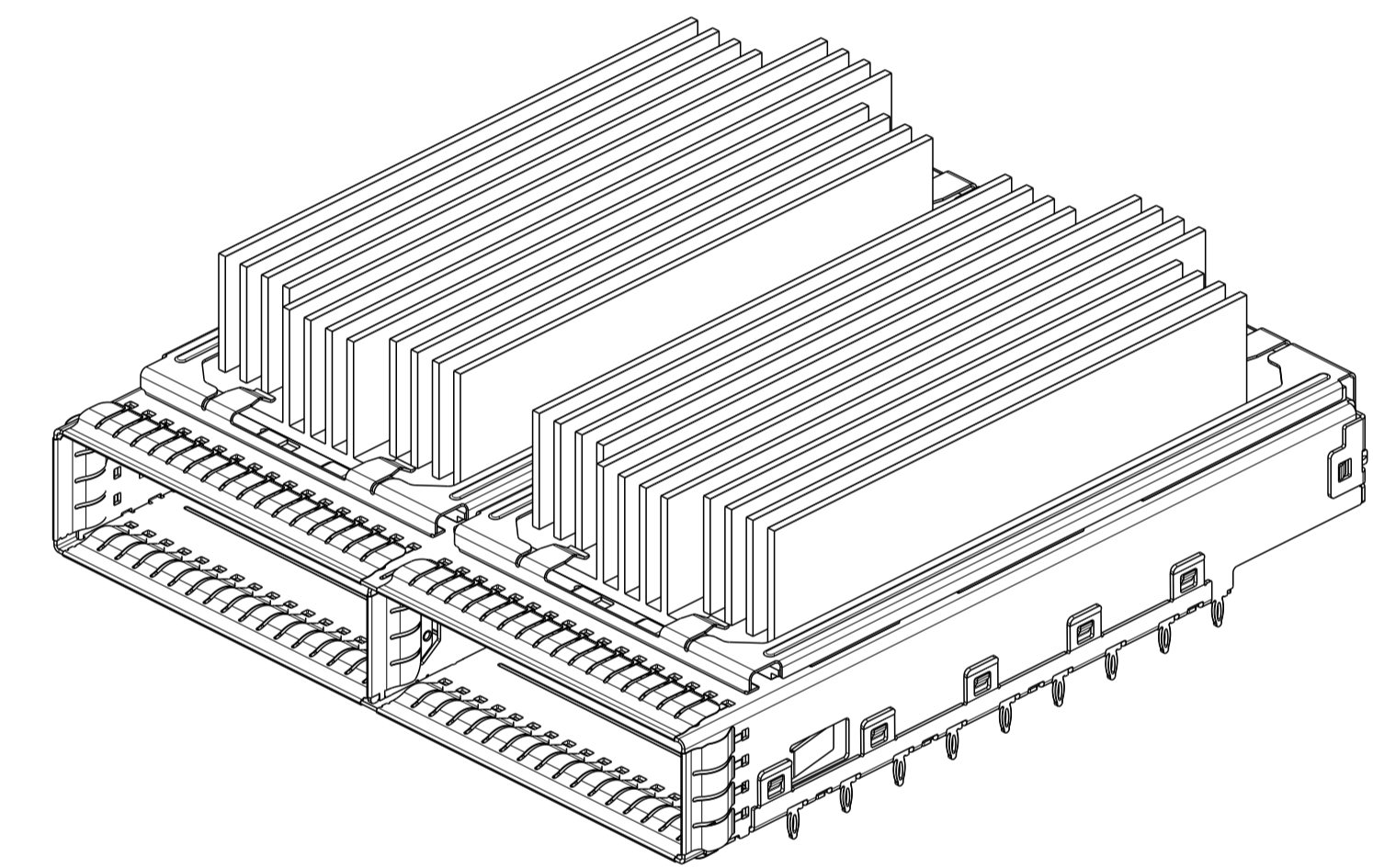

2293288-6 3D VIEW

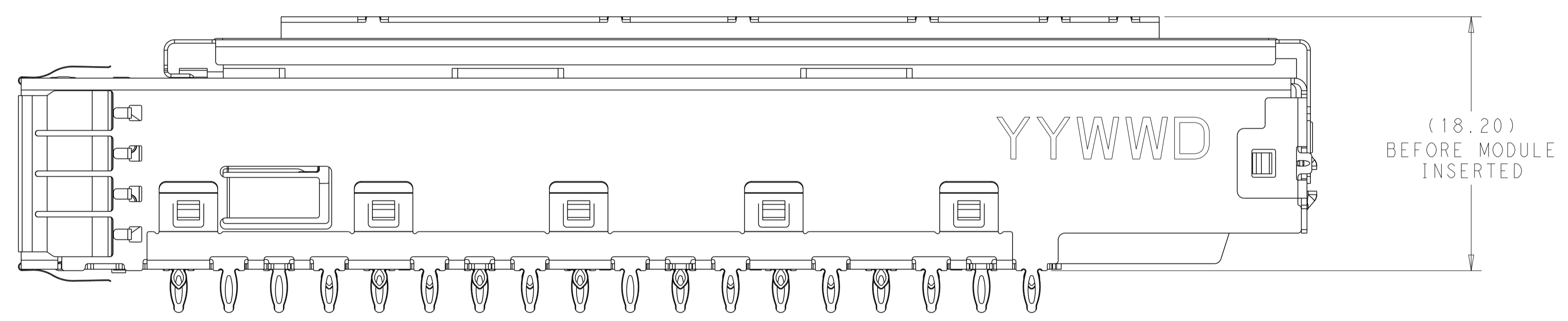

2293288-8 AS SHOWN
 OTHERS DIMENSIONS
 SAME AS 2293288-1
 SCALE 4:1

29.5 MAX	2293288-6
25 MAX	2293288-2
DIM. A	PART NUMBER

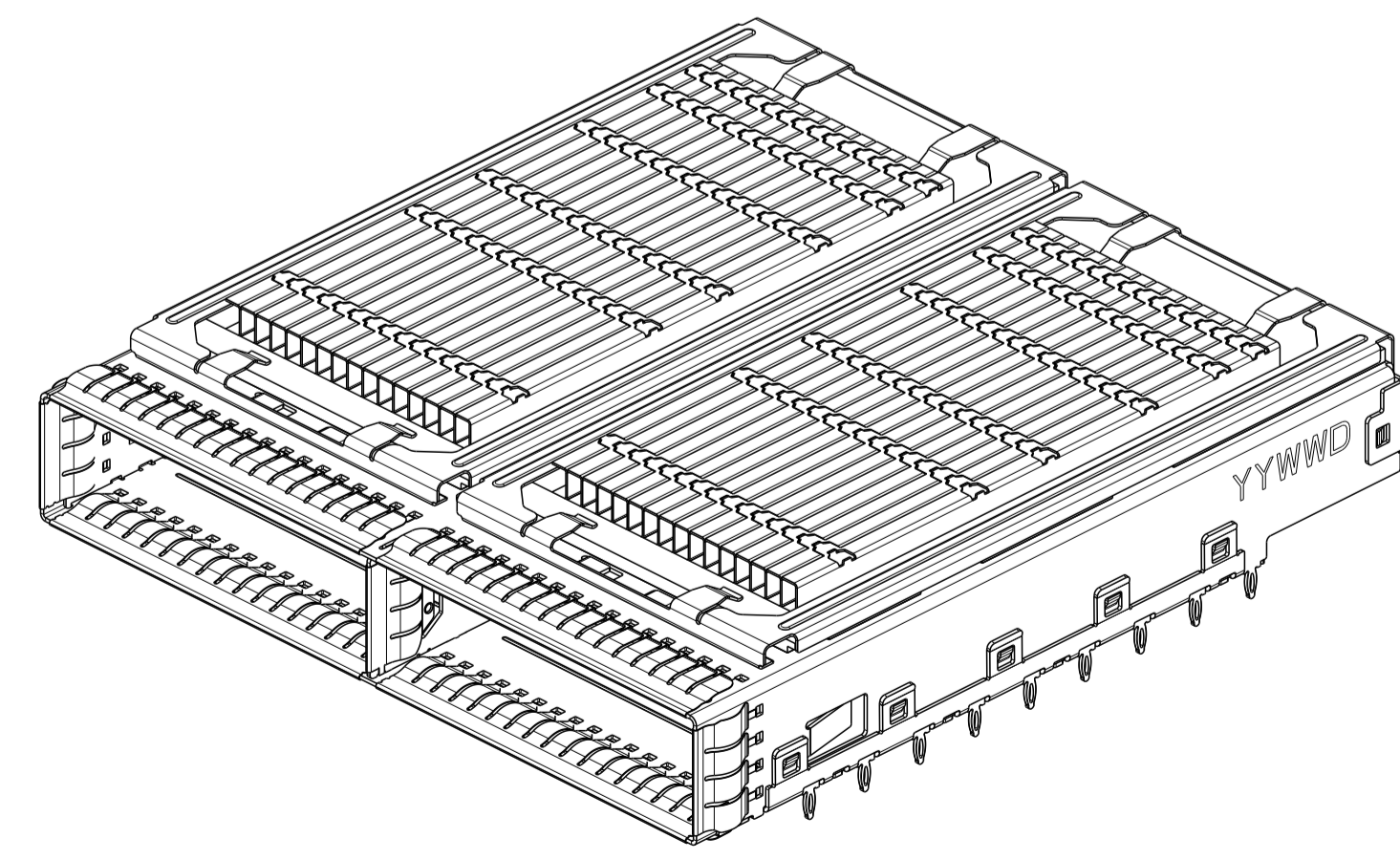

2293288-8 3D VIEW
 SCALE 3:2

THIS DRAWING IS A CONTROLLED DOCUMENT.		DWN Charles Wan 31JAN2015	TE Connectivity NAME CFP2 HARDWARE AND RECEPTACLE ASSEMBLY, 1X2
DIMENSIONS:		CHK Sean Han 31JAN2015	
mm	TOLERANCES UNLESS OTHERWISE SPECIFIED:	APVD Sean Han 31JAN2015	PRODUCT SPEC
	0 PLC ±		108-32103
	1 PLC ±0.25		APPLICATION SPEC
	2 PLC ±0.13		114-32146
	3 PLC ±0.10		WEIGHT
	4 PLC ±		A1
	ANGLES ±		C=2287075
	FINISH ±		SCALE 1:1 SHEET 3 OF 8 REV A1
MATERIAL		CUSTOMER DRAWING	

LOC	DIST	REVISIONS					
GP	00	P	LTN	DESCRIPTION	DATE	DMN	APVD
-	-	-	-	SEE SHEET 1	-	-	-

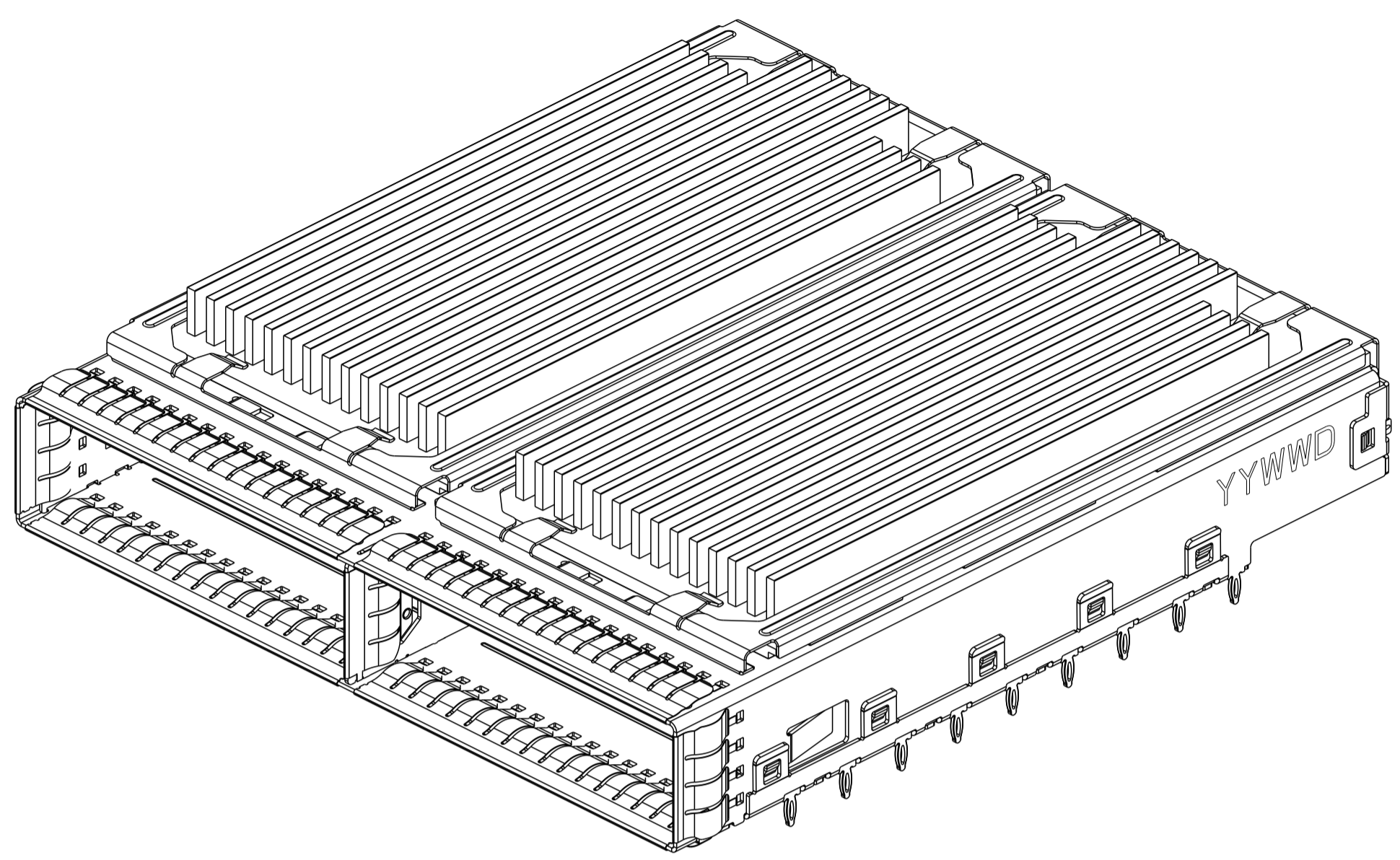

2293288-9
 SCALE 2:1

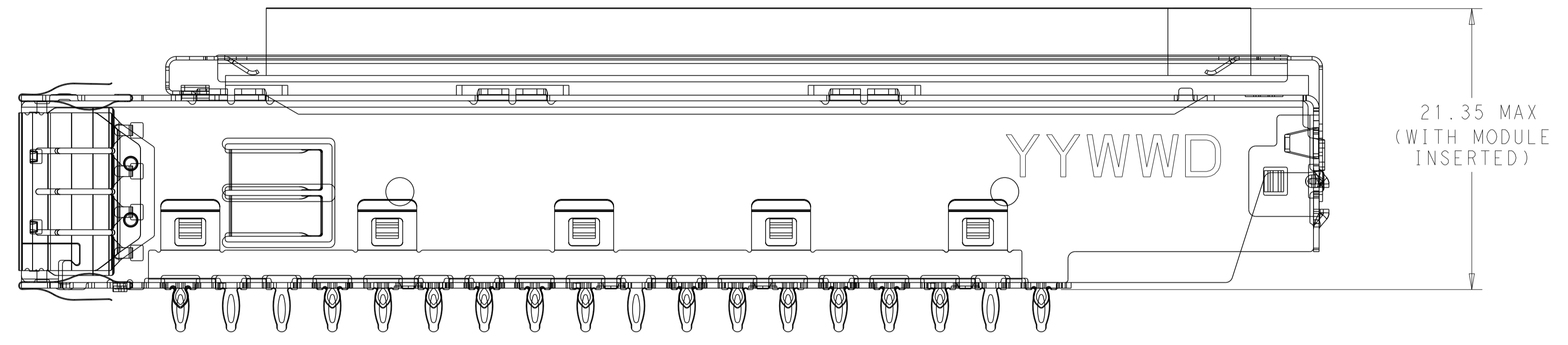

2293288-9 AS SHOWN
 OTHER DIMENSIONS ARE
 SAME AS 2293822-2
 SCALE 4:1

THIS DRAWING IS A CONTROLLED DOCUMENT.		DMN Charles Wan 31JAN2015	
DIMENSIONS:		CHK Sean Han 31JAN2015	
mm	0 PLC ±0.25 1 PLC ±0.25 2 PLC ±0.13 3 PLC ±0.10 4 PLC ±0.10	APVD Sean Han 31JAN2015	NAME CFP2 HARDWARE AND RECEPTACLE ASSEMBLY, 1X2
		PRODUCT SPEC 108-32103	SIZE A1
MATERIAL		APPLICATION SPEC 114-32146	CAGE CODE -
FINISH		WEIGHT	RESTRICTED TO
CUSTOMER DRAWING		SCALE 1:1	SHEET 4 OF 8 REV A1

LOC	DIST	REVISIONS			
P	LTN	DESCRIPTION	DATE	DMN	APVD
GP	00	SEE SHEET 1	-	-	-

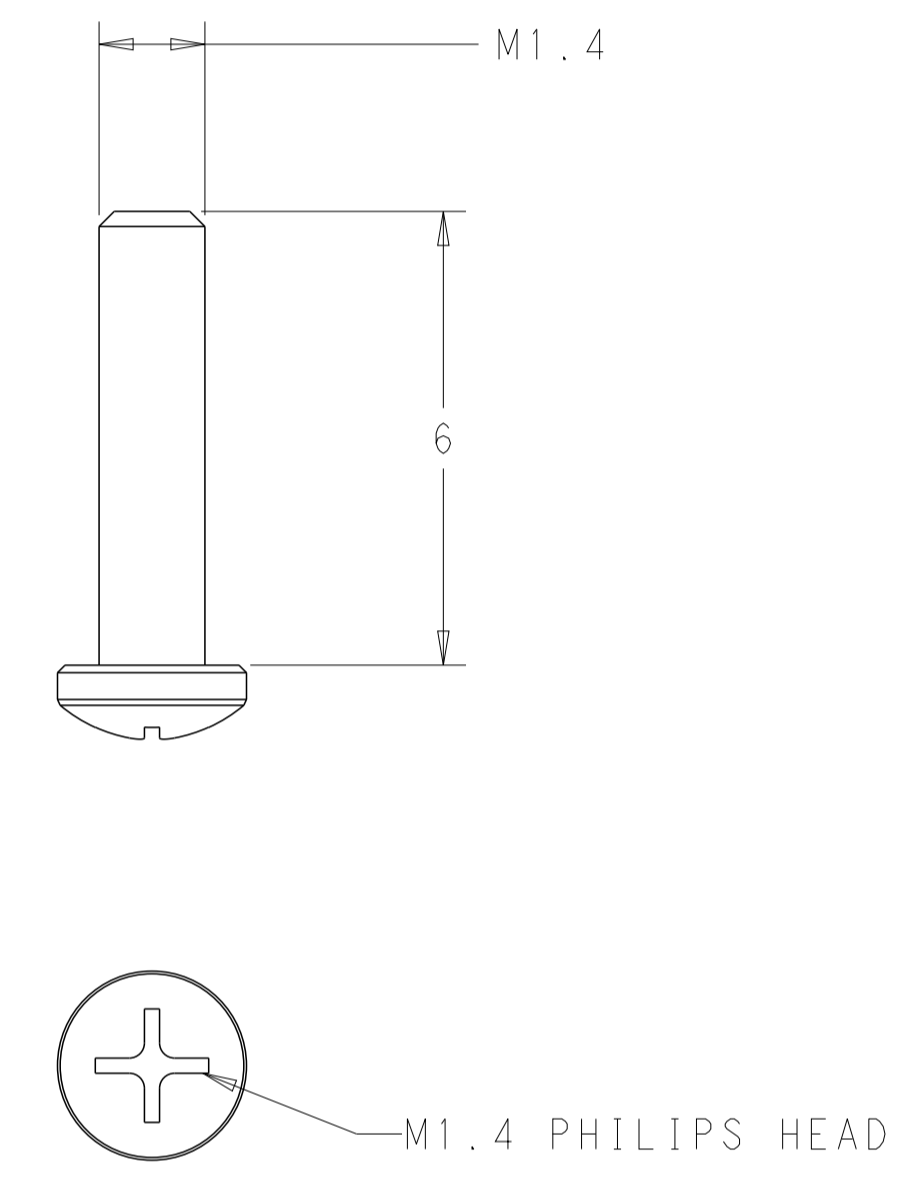
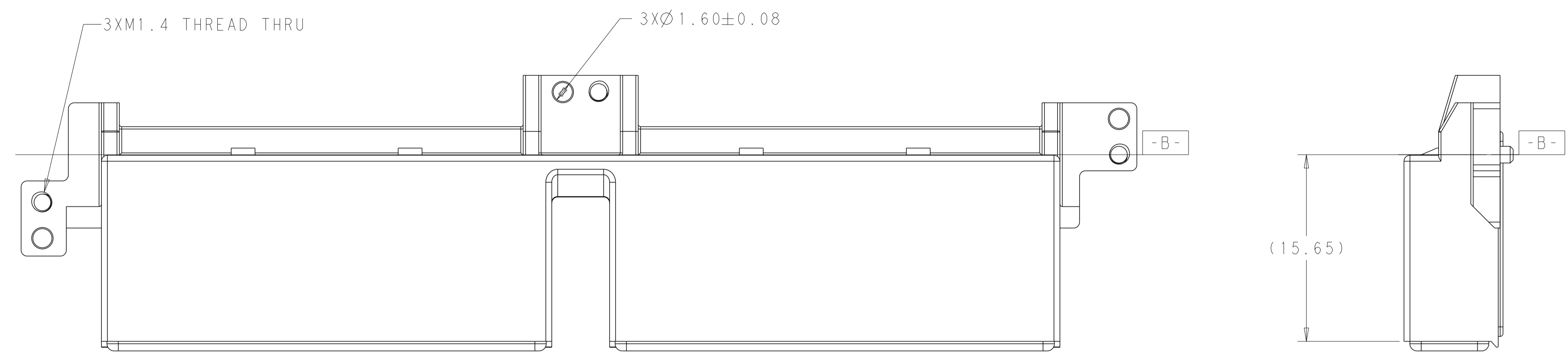

2292789-1
 SCALE 10:1

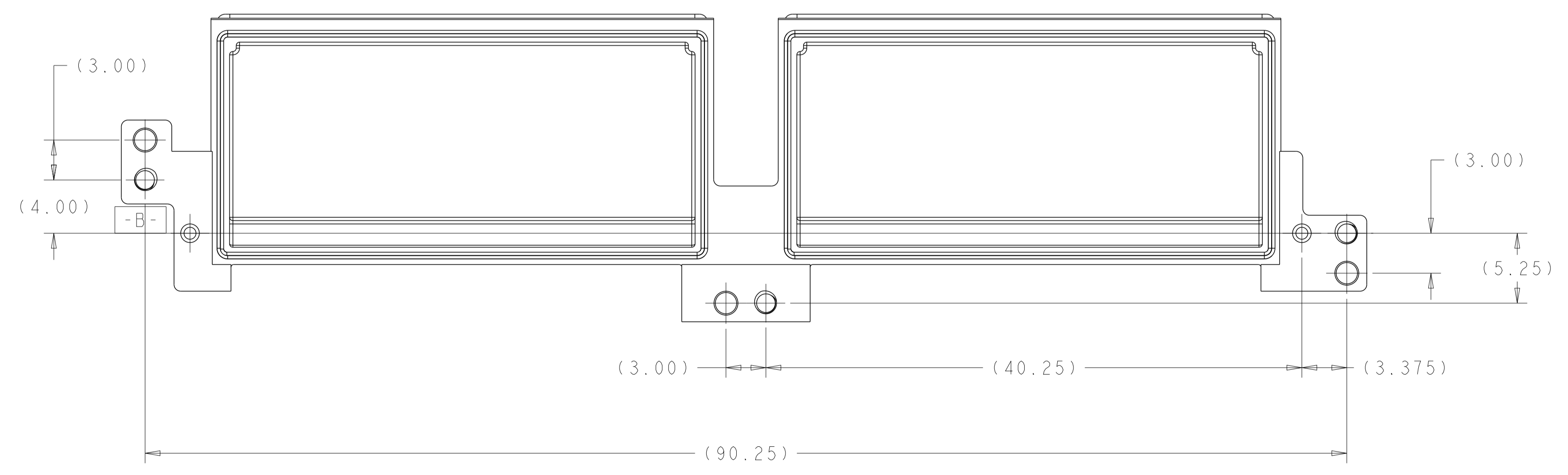
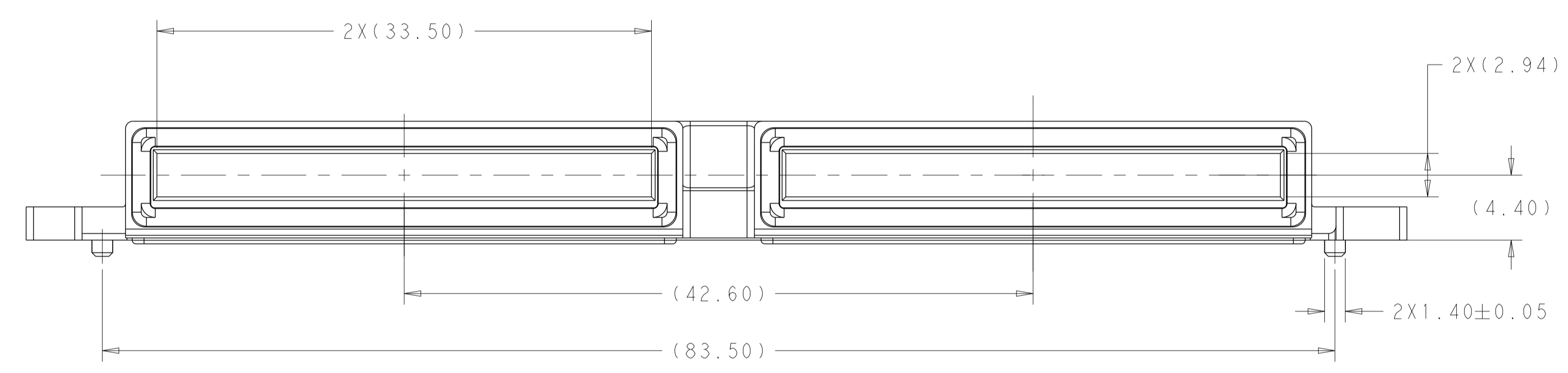

2287077-1

THIS DRAWING IS A CONTROLLED DOCUMENT.		DMN Charles Wan 31JAN2015	TE Connectivity	
		CHK Sean Han 31JAN2015		
DIMENSIONS:		APVD Sean Han 31JAN2015	NAME CFP2 HARDWARE AND RECEPTACLE ASSEMBLY, 1X2	
mm	TOLERANCES UNLESS OTHERWISE SPECIFIED:	PRODUCT SPEC 108-32103	SIZE A1	
	0 PLC ±0.25	APPLICATION SPEC 114-32146	CAGE CODE DRAWING NO	
	2 PLC ±0.13	WEIGHT	RESTRICTED TO	
	3 PLC ±0.10		SCALE 1:1 SHEET 5 OF 8 REV A1	
	4 PLC ±			
	ANGLES ±			
MATERIAL	FINISH			
		CUSTOMER DRAWING		

LOC	DIST	REV	DATE	BY	APPV
GP	00				

REVISONS		DATE	BY	APPV
	SEE SHEET 1			

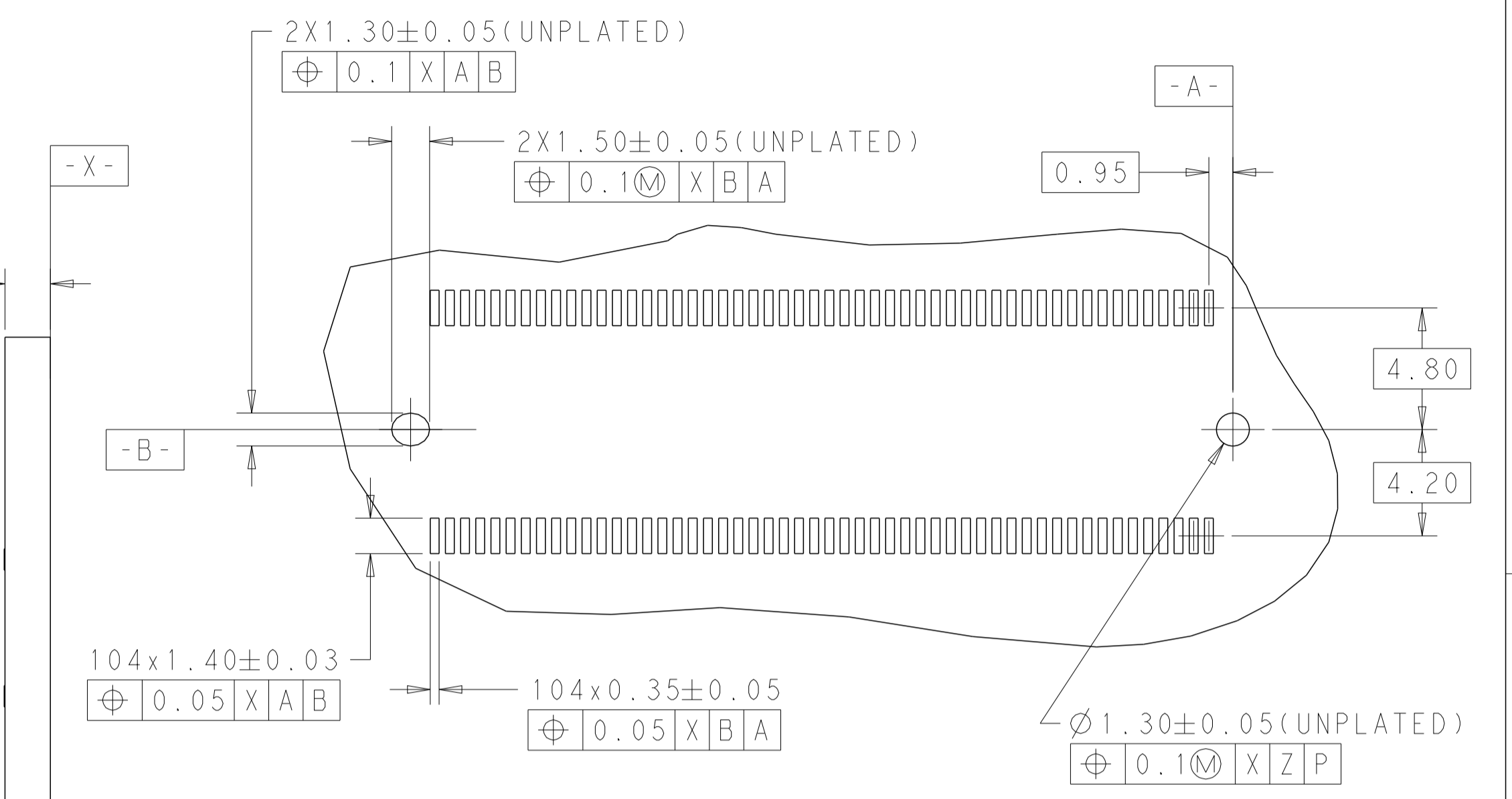
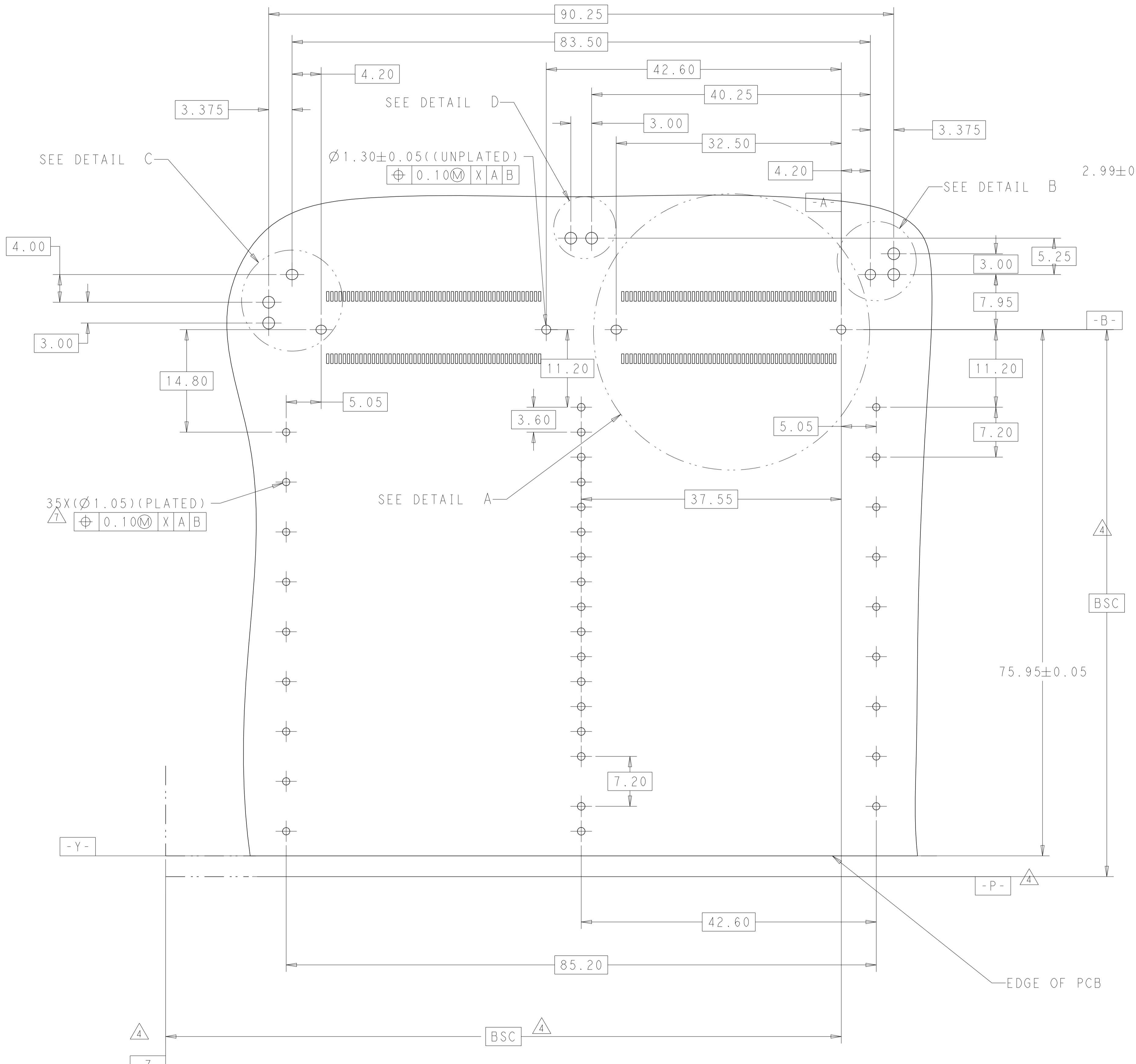

DETAIL A
SCALE 5:1

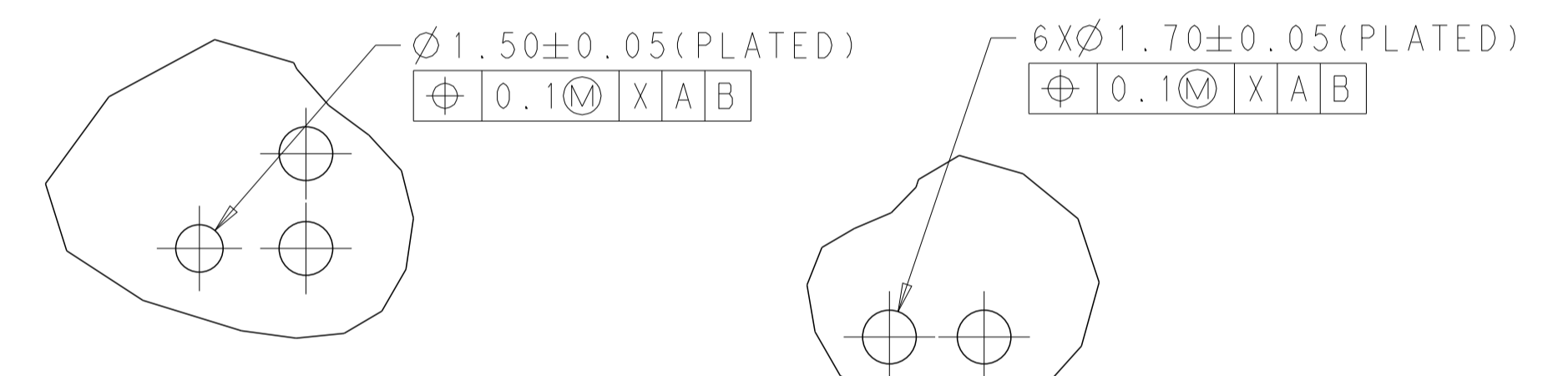

DETAIL B
SCALE 5:1

DETAIL D
SCALE 5:1

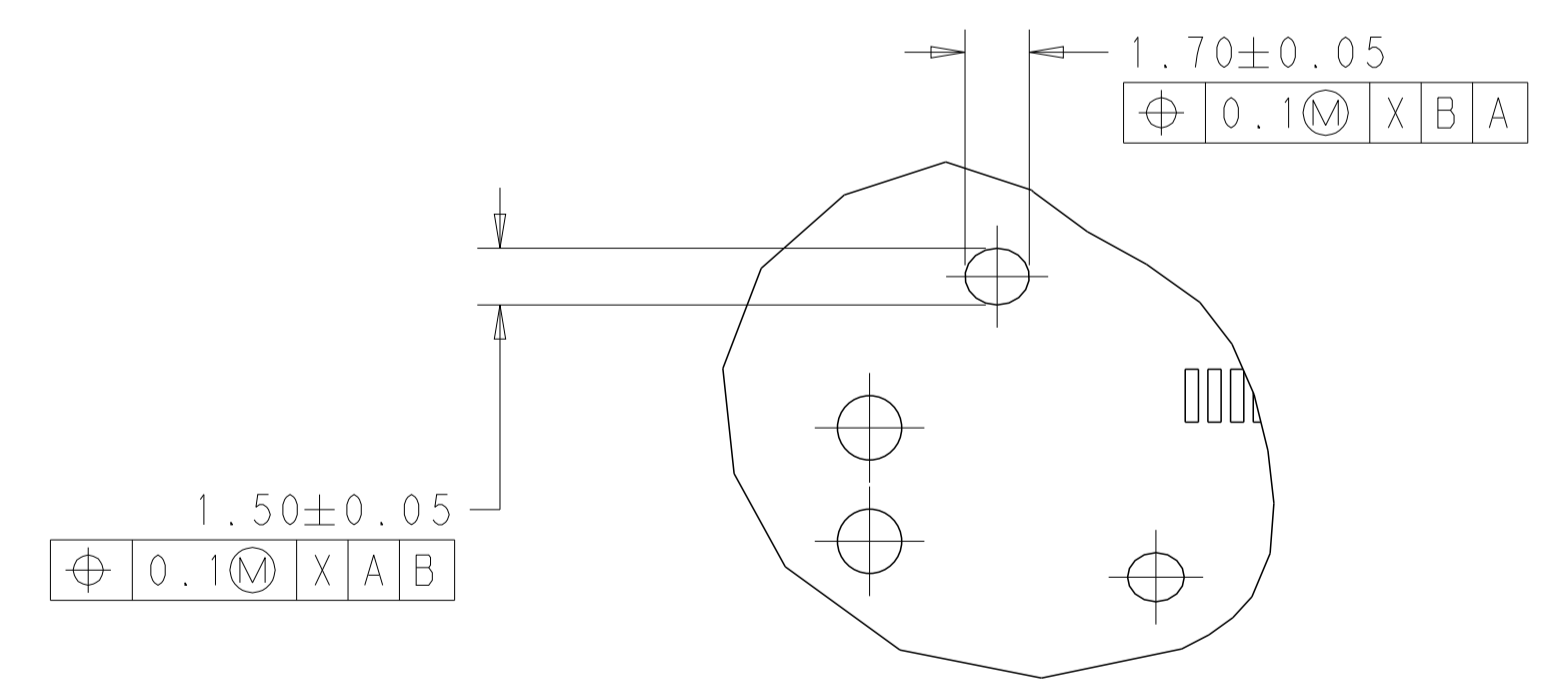

DETAIL C
SCALE 5:1

THIS DRAWING IS A CONTROLLED DOCUMENT.		OWN: Charles Wan 31JAN2015	TE Connectivity NAME: CFP2 HARDWARE AND RECEPTACLE ASSEMBLY, 1X2 PRODUCT SPEC: 108-32103 APPLICATION SPEC: 114-32146 WEIGHT: - SCALE: 1:1 SHEET 6 OF 8 REV A1
DIMENSIONS:		CHK: Sean Han 31JAN2015	
mm		APVD: Sean Han 31JAN2015	
0 PLC ±0.25 2 PLC ±0.13 3 PLC ±0.10 4 PLC ±0.075 ANGLES ±0.13		TOLERANCES UNLESS OTHERWISE SPECIFIED: PRODUCT SPEC: 108-32103 APPLICATION SPEC: 114-32146	
MATERIAL:		SIZE: A1	RESTRICTED TO:
FINISH:		CAGE CODE: -	CUSTOMER DRAWING

LOC		DIST		REVISIONS			
P	LYN	DATE	DMN	APVD	DESCRIPTION		
-	-	-	-	-	SEE SHEET 1		

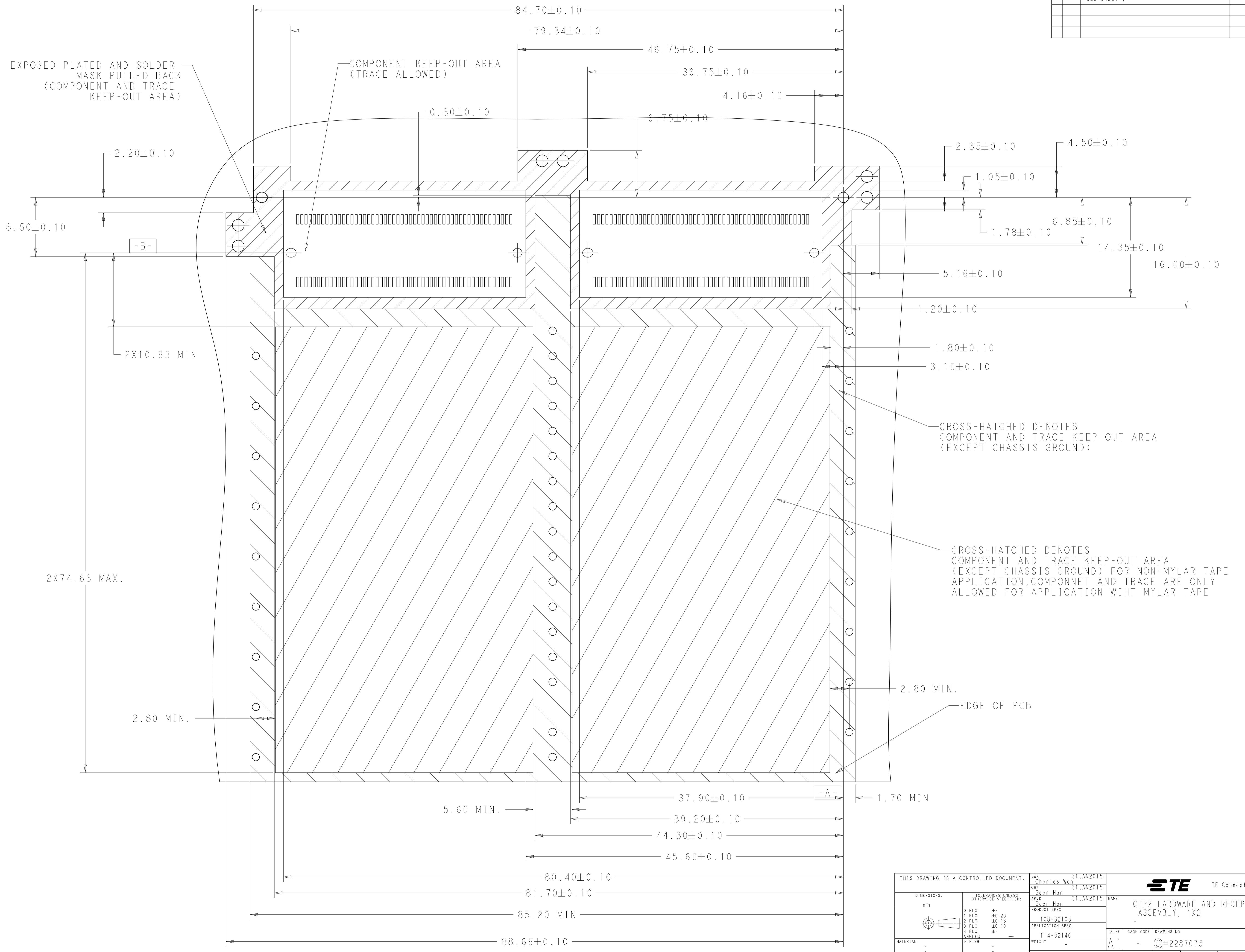

CROSS-HATCHED DENOTES COMPONENT AND TRACE KEEP-OUT AREA (EXCEPT CHASSIS GROUND)

CROSS-HATCHED DENOTES COMPONENT AND TRACE KEEP-OUT AREA (EXCEPT CHASSIS GROUND) FOR NON-MYLAR TAPE APPLICATION, COMPONENT AND TRACE ARE ONLY ALLOWED FOR APPLICATION WITH MYLAR TAPE

THIS DRAWING IS A CONTROLLED DOCUMENT.		DMN: Charles Wan 31JAN2015	TE Connectivity
		CHK: Sean Han 31JAN2015	
DIMENSIONS: mm		APVD: Sean Han 31JAN2015	NAME: CFP2 HARDWARE AND RECEPTACLE ASSEMBLY, 1X2 PRODUCT SPEC: 108-32103 APPLICATION SPEC: 114-32146
TOLERANCES UNLESS OTHERWISE SPECIFIED: 0 PLC ±.25 1 PLC ±.13 2 PLC ±.10 3 PLC ±.10 4 PLC ±.10 ANGLES ±.10		SIZE: A1 CAGE CODE: - DRAWING NO: C=2287075 WEIGHT: - CUSTOMER DRAWING	
MATERIAL: -		FINISH: -	RESTRICTED TO: - SCALE: 1:1 SHEET 7 OF 8 REV: A1

LOC	DIST	REVISIONS			
P	LTN	DESCRIPTION	DATE	DMN	APVD
-	-	SEE SHEET 1	-	-	-

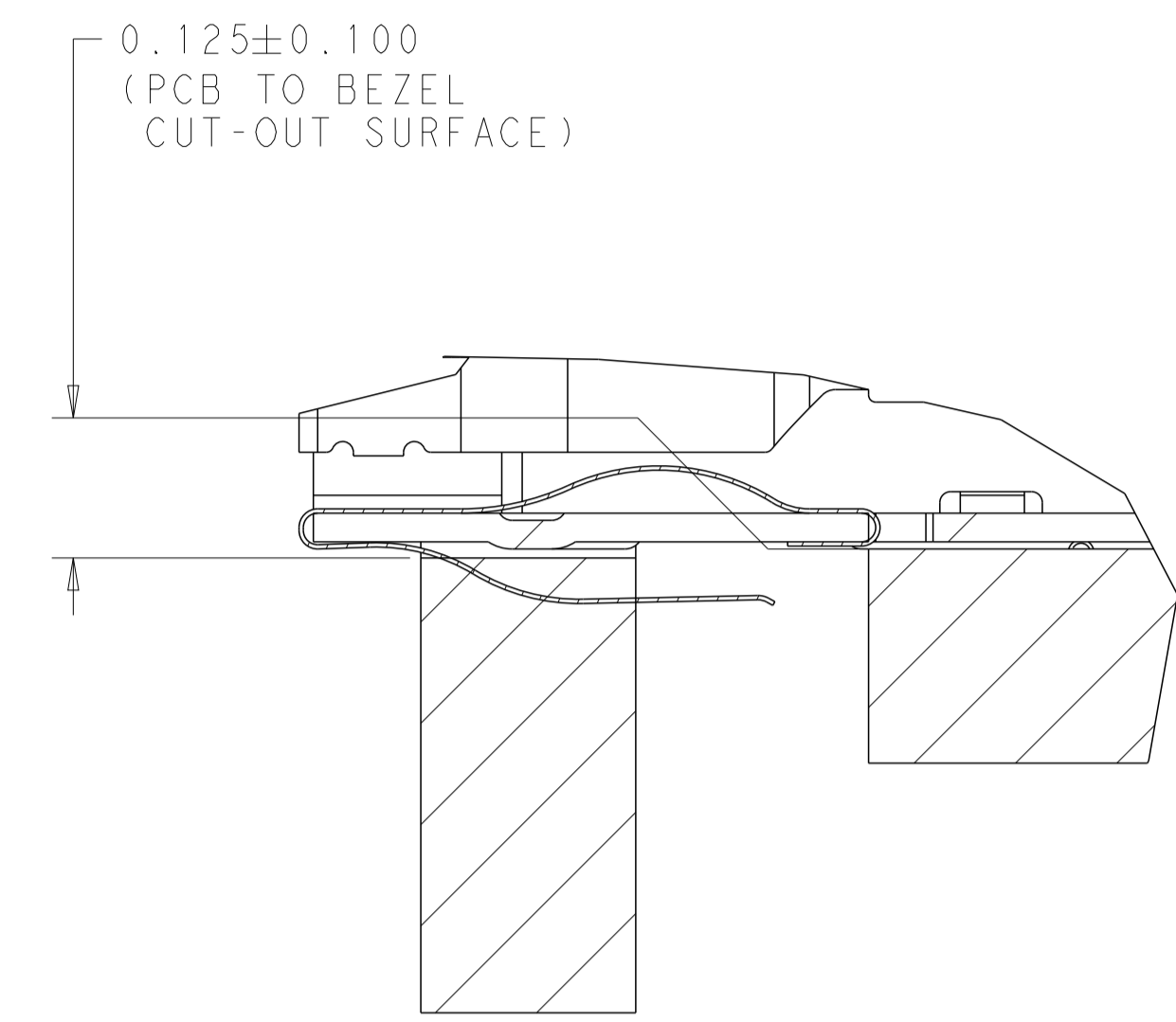
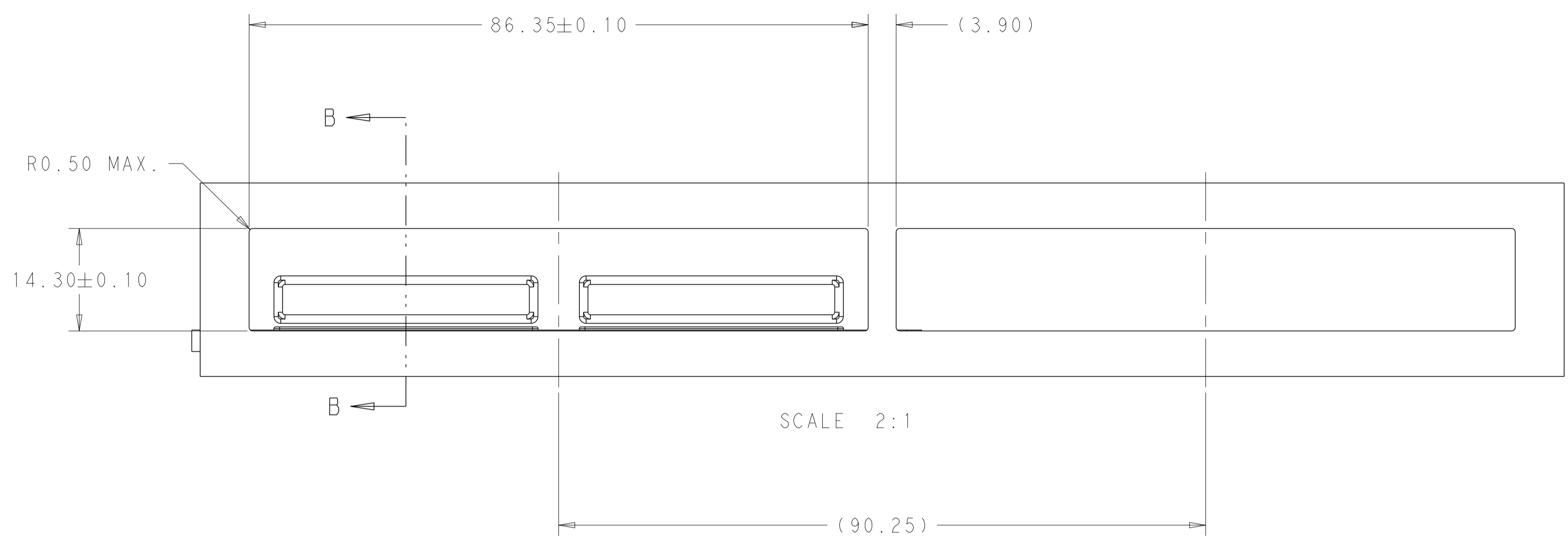

DETAIL E
SCALE 10:1

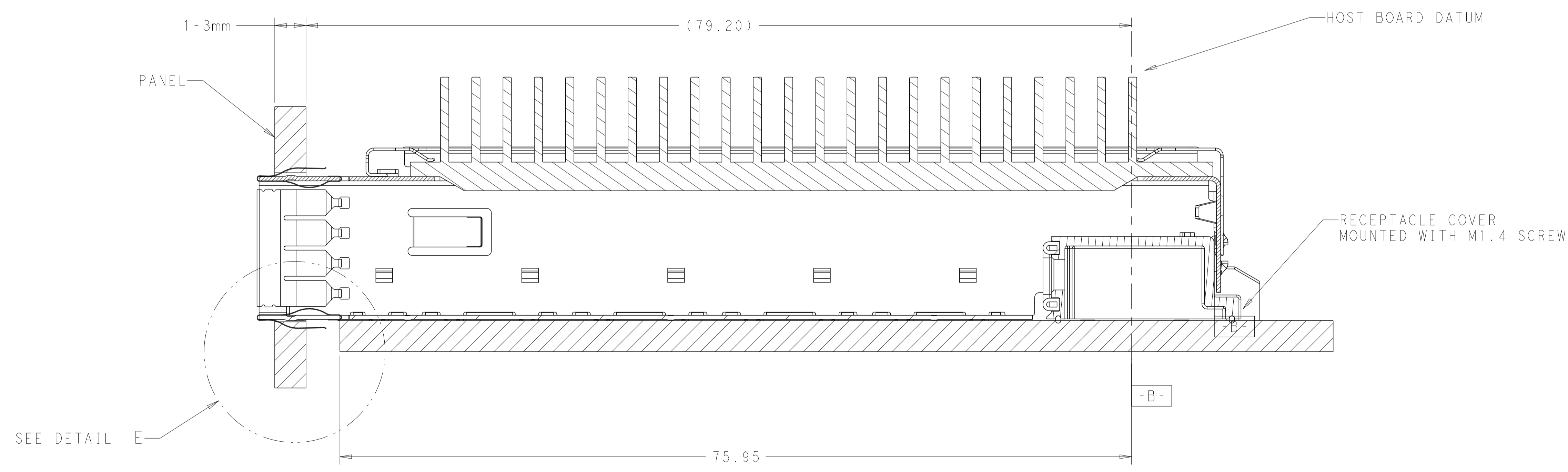

SECTION B-B
SCALE 4:1

THIS DRAWING IS A CONTROLLED DOCUMENT.		DMN Charles Wan 31JAN2015	TE Connectivity
DIMENSIONS: mm		CHK Sean Han 31JAN2015	
TOLERANCES UNLESS OTHERWISE SPECIFIED:		APVD Sean Han 31JAN2015	NAME CFP2 HARDWARE AND RECEPTACLE ASSEMBLY, 1X2
0 PLC ±0.25	1 PLC ±0.13	PRODUCT SPEC 108-32103	SIZE A1
2 PLC ±0.10	3 PLC ±0.10	APPLICATION SPEC 114-32146	CAGE CODE - C=2287075
4 PLC ±0.10	ANGLES ±0.10	WEIGHT -	RESTRICTED TO -
MATERIAL -	FINISH -	CUSTOMER DRAWING	SCALE 1:1 SHEET 8 OF 8 REV A1