

4

3

2

1

THIS DRAWING IS UNPUBLISHED. RELEASED FOR PUBLICATION
 © COPYRIGHT - TE Connectivity Ltd. ALL RIGHTS RESERVED.

| REVISIONS | | | | | |
|-----------|-----|---------------------------|-----------|-----|------|
| P | LTR | DESCRIPTION | DATE | DWN | APVD |
| D | | REV PER 0G3A-0012-02 | 21JAN02 | - | MS |
| D1 | | REVISED PER ECO-17-008806 | 19FEB2018 | RS | DR |

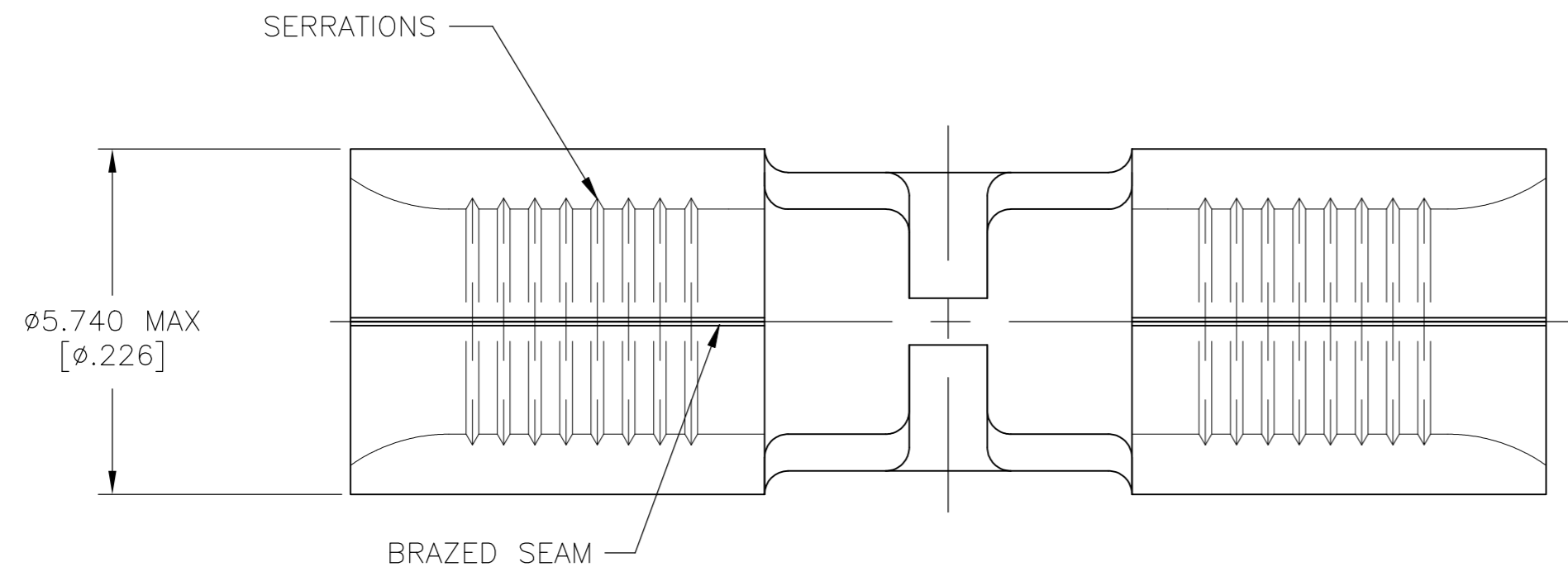

| | |
|--------------------------------|---------------------------|
| AMP WIRE RANGE | E13288 Listed |
| 12-10 AWG SOLID OR STRANDED | 12-10 AWG STRANDED |
| LR7189 Certified | MILITARY P/N AND CLASS |
| 12-10 AWG SOLID OR STRANDED | NOT APPLICABLE |

- 1 STAMP AMP 12-10* APPROX AS SHOWN
- 2 MAXIMUM LENGTH DOES NOT INCLUDE MANUFACTURING TABS
- 3 NOTE DELETED

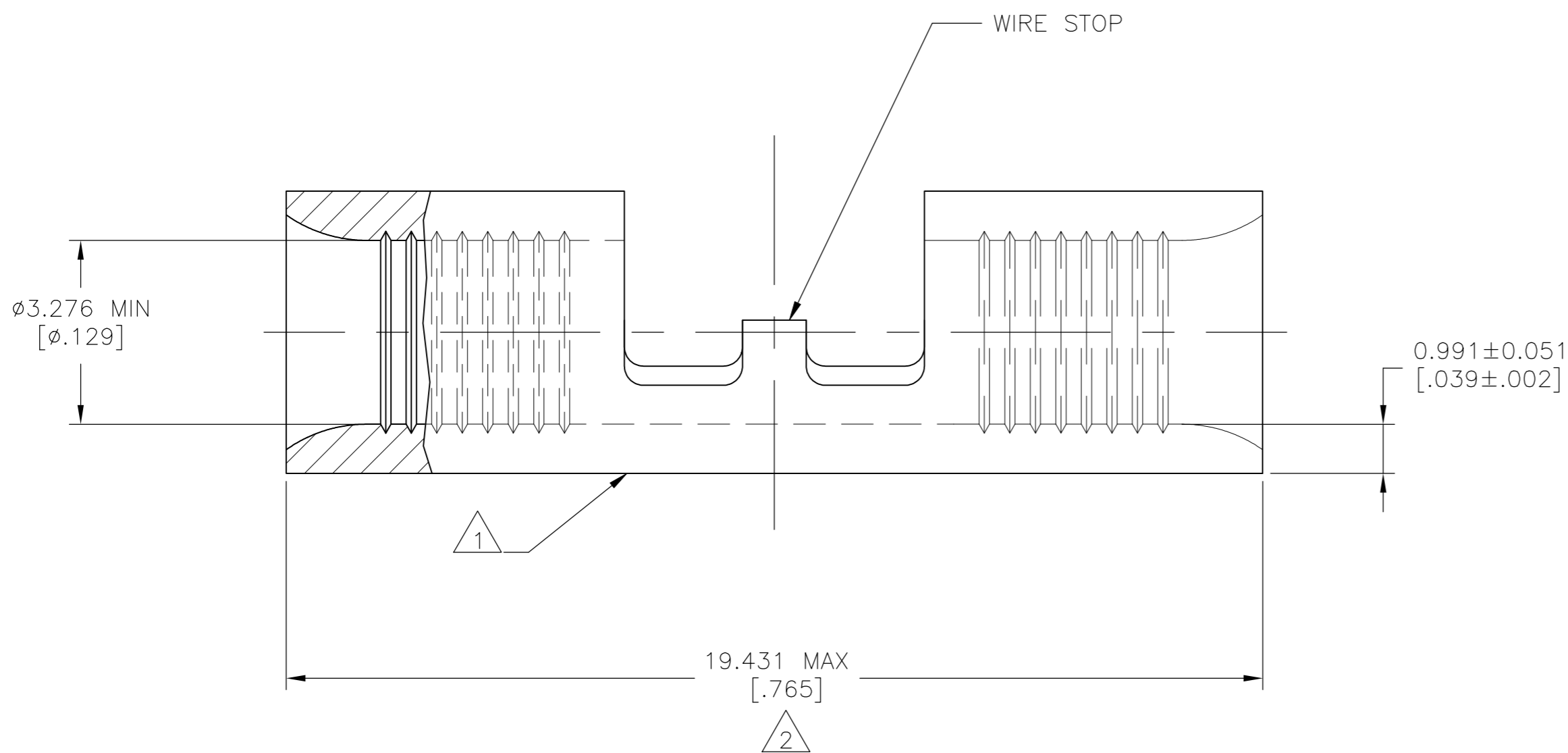

| | | |
|-----|--------------|---------|
| 500 | LOOSE PIECE | 324893 |
| QTY | PACKAGE TYPE | PART NO |

| | | | | | |
|--|--|--|--|---|---|
| AMP INCORPORATED CUSTOMER SERVICE SYSTEMS | | THIS DRAWING IS A CONTROLLED DOCUMENT. | | DWN TA BRINKMAN 4-14-93 | TE Connectivity Ltd. |
| FOR ADDITIONAL PRODUCT INFORMATION OR COPIES OF DRAWINGS AND TECHNICAL DOCUMENTS | PRODUCT INFORMATION CENTER 1-800-522-6752 | MAX RECOMMENDED OPERATING TEMPERATURE: 170°C [338°F] MAX | DIMENSIONS: mm [INCHES] | CHK DA PATTERSON 4-14-93 | |
| FOR APPLICATION | TOOLING ASSISTANCE CENTER 1-800-722-1111 | VOLTAGE RATING: NOT APPLICABLE | | APVD DE MILLER 4-14-93 | NAME SPLICE, BUTT, STRAP, SOLISTRAND 12-10 AWG |
| TOOLING INFORMATION | 1-800-722-1111 | WIRE CROSS SECTIONAL AREA RANGE, 2.62-6.64mm²[5,180-13,100] CIR MILS SOLID OR STRANDED | | TOLERANCES UNLESS OTHERWISE SPECIFIED: 0 PLC ± - 1 PLC ± - 2 PLC ± - 3 PLC ± 0.127[.005] 4 PLC ± - ANGLES ± - | PRODUCT SPEC UL 486 A-B |
| FOR ORDER ENTRY | 1-800-526-5142 | MATERIAL COPPER PER ASTM B-152 ANNEALED | FINISH TIN PLATE 0.00254[.000100] MIN THK PER ASTM B545 | APPLICATION SPEC - | CAGE CODE 00779 |
| | | | | WEIGHT | DRAWING NO 324893 |
| | | | | CUSTOMER DRAWING | RESTRICTED TO - |
| | | | | SCALE 10:1 | SHEET 1 of 1 |
| | | | | REV D1 | |