

LOC	DIST	REVISIONS	DATE	DMN	APVD
A1	-	DESCRIPTION			
PROJECT NR.	A5	E-23-173042	20APR2023	SH	MC
	A6	E-23-193008	20NOV2023	SH	MC

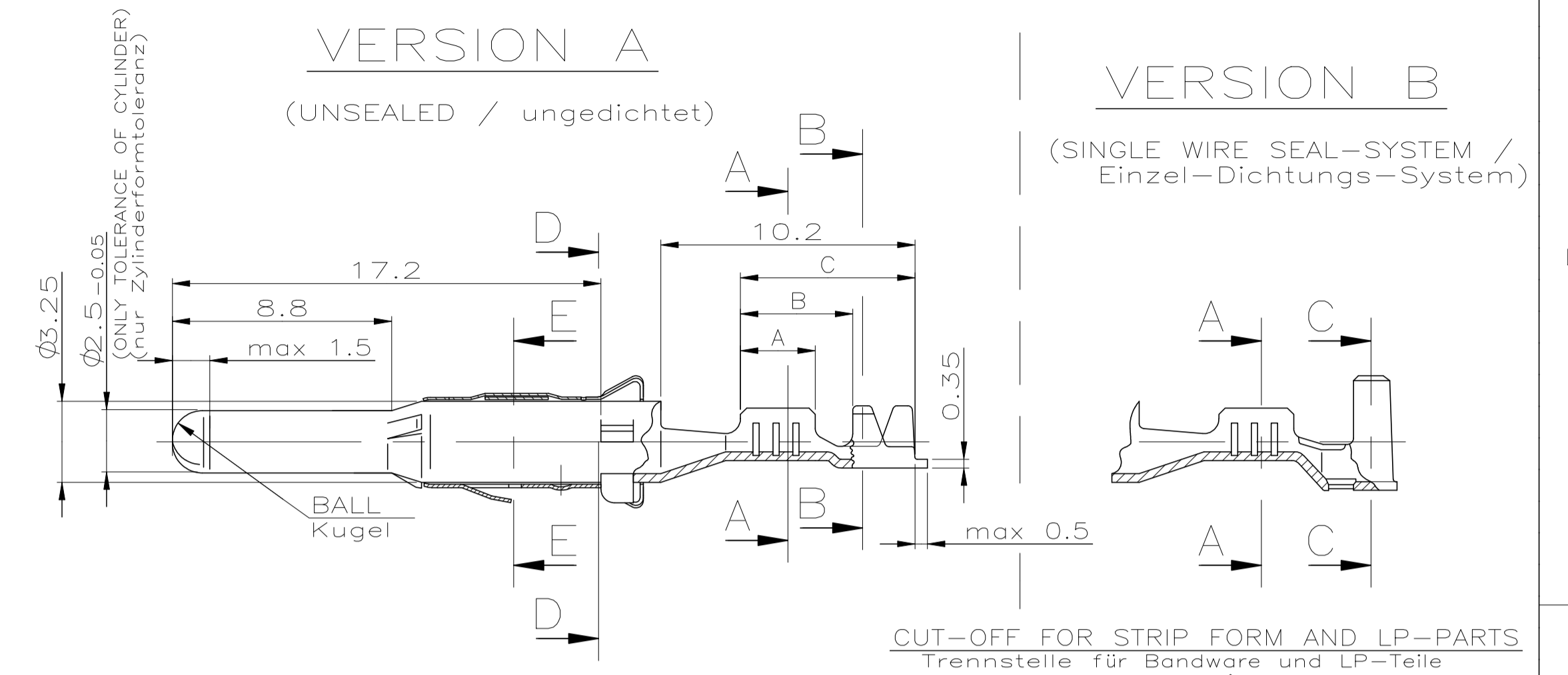
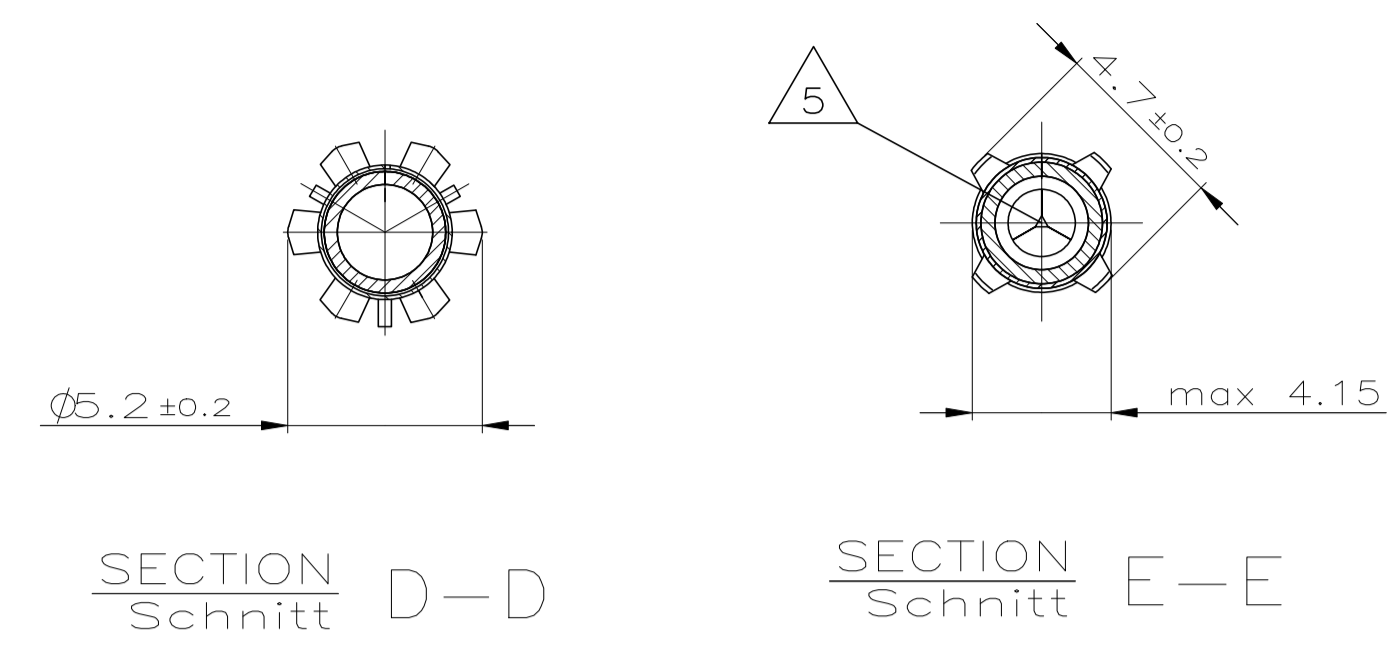

Version B (SINGLE WIRE SEAL-SYSTEM / Einzel-Dichtungs-System)

TE CONNECTIVITY ORDER-Nr.	TE CONNECTIVITY ORDER-Nr.	MATERIAL	SURFACE	DGB	WIRE CRIMP	NSUL.-CRIMP	WIRE CRIMP HEIGHT CH	APPLICATION TOOL	HAND TOOL	A	B	C	TE CONNECTIVITY ORDER-Nr.	TE CONNECTIVITY ORDER-Nr.
STRIP FORM	LOOSE PIECE	Werkstoff	Oberfläche	[mm <sup>2</sup> ]	Drahtcrimp	Isol.-Crimp	Drahtcrimp-Höhe CH	Anschlag-WKZ	Handzange				SINGLE SEAL	DEAD END PLUG
Bandware	Einzelausführung												Einzelichtung	Blindstopfen
1-962800-4	1-962973-4	A			E = 4.3	BH = 5.4	4.0mm <sup>2</sup> = 2.30	MQC-Applicator		4	6.9	8.5	828985-1	-
962800-7	962973-7	L			G = 4.5	K = 5.9	3.0mm <sup>2</sup> = 2.05	4151297-X						
962800-1	962973-1	L			D <sub>cr</sub> = 2.4	D = 3.9								
1-929968-4	1-962972-4	A			E = 3.6	BH = 5.0	2.5mm <sup>2</sup> = 1.97	MQC-Applicator	539679-2	4	6.9	8.5	828921-1	828922-1
929968-8	962972-8	M			G = 3.8	K = 5.0	2.0mm <sup>2</sup> = 1.82	2-878486-2	1579024-5					
929968-1	962972-1	M			D <sub>cr</sub> = 1.7	D = 3.6	1.5mm <sup>2</sup> = 1.67	2151345						
1-929967-4	1-962971-4	A			E = 2.6	BH = 4.8	1.0mm <sup>2</sup> = 1.45	MQC-Applicator	734289-1	3	5.4	7	828920-1	828922-1
929967-8	962971-8	M			G = 2.8	K = 4.8	0.75mm <sup>2</sup> = 1.36	2-878485-2	1579024-3					
929967-1	962971-1	M			D <sub>cr</sub> = 1.1	D = 3.2	0.5mm <sup>2</sup> = 1.27	2151139						
1-929966-4	1-962970-4	A			E = 2.1	BH = 4.5	0.35mm <sup>2</sup> = 1.11	MQC-Applicator	734289-1	3	5.4	7	828920-1	828922-1
929966-8	962970-8	M			G = 2.1	K = 4.5		2-878484-2	1579024-3					
929966-1	962970-1	M			D <sub>cr</sub> = 0.8	D = 3.2		2151732						

Version A (UNSEALED / ungedichtet)

TE CONNECTIVITY ORDER-Nr.	TE CONNECTIVITY ORDER-Nr.	MATERIAL	SURFACE	DGB	WIRE CRIMP	NSUL.-CRIMP	WIRE CRIMP HEIGHT CH	APPLICATION TOOL	HAND TOOL	A	B	C	TE CONNECTIVITY ORDER-Nr.	TE CONNECTIVITY ORDER-Nr.
STRIP FORM	LOOSE PIECE	Werkstoff	Oberfläche	[mm <sup>2</sup> ]	Drahtcrimp	Isol.-Crimp	Drahtcrimp-Höhe CH	Anschlag-WKZ	Handzange				SINGLE SEAL	DEAD END PLUG
Bandware	Einzelausführung												Einzelichtung	Blindstopfen
1-929965-4	1-962969-4	A			E = 4.3	BH = 5.4	4.0mm <sup>2</sup> = 2.30	MQC-Applicator	734285-3	4	5.5	8.5		
929965-8	962969-8	J			G = 4.5	K = 5.6	3.0mm <sup>2</sup> = 2.05	2-878483-2	734289-3					
929965-1	962969-1	J			D <sub>cr</sub> = 2.4	D = 3.2		2836098						
1-929964-4	1-962968-4	A			E = 3.6	BH = 4.3	2.5mm <sup>2</sup> = 1.97	MQC-Applicator	734285-2	4	5.5	8.5		
929964-8	962968-8	J			G = 3.8	K = 4.5	2.0mm <sup>2</sup> = 1.82	2-878482-2						
929964-1	962968-1	J			D <sub>cr</sub> = 1.7	D = 2.6	1.5mm <sup>2</sup> = 1.67	2266503						
1-929963-4	1-962967-4	A			E = 2.6	BH = 3.2	1.0mm <sup>2</sup> = 1.45	MQC-Applicator	734285-1	3	4.5	7		
929963-8	962967-8	L			G = 2.8	K = 3.4	0.75mm <sup>2</sup> = 1.36	2-878481-2	2-1579024-5					
929963-1	962967-1	L			D <sub>cr</sub> = 1.1	D = 1.8	0.5mm <sup>2</sup> = 1.27	2266254						
1-929962-4	1-962966-4	A			E = 2.1	BH = 2.5	0.35mm <sup>2</sup> = 1.11	MQC-Applicator	734285-1	3	4.5	7		
929962-8	962966-8	J			G = 2.1	K = 2.5	0.25mm <sup>2</sup> = 1.07	2-878480-2	2-1579024-4					
929962-1	962966-1	J			D <sub>cr</sub> = 0.8	D = 1.4	0.2mm <sup>2</sup> = 1.05	2836097						

- REMARKS**  
Bemerkungen
- 1 **PRE TINNED** 1-2μm  
vorverzinnt
  - 2 **ZONE "A": MIN 0.8μm ELECTROPL. Au OVER MIN 1.3μm ELECTROPL. Ni LAYER**  
min 0.8μm galv. Au über min 1.3μm galv. Ni  
**ZONE "B": 1-2μm ELECTROPL. Sn OVER MIN 0.1μm ELECTROPL. Ni**  
1-2μm galv. Sn über min 0.1μm galv. Ni  
**REST: min 0.1μm ELECTROPL. Ni**  
min 0.1μm galv. Ni
  - 3 **ZONE "A": MIN 3μm ELECTROPL. Ag**  
min 3μm galv. Ag  
**REST: min 0.5μm ELECTROPL. Ag**  
min 0.5μm galv. Ag
  - 4 **ZONE "A": MIN 3μm ELECTROPL. Ag**  
min 3μm galv. Ag  
**ZONE "B": 1-3μm ELECTROPL. Sn**  
1-3μm galv. Sn  
**REST: SILVER OR TIN ALLOWED IN TRANSITION AREAS.OVERLAPPING LAYERS**  
AND PLAIN SURFACES ARE NOT ALLOWED.  
Silber oder Zinn im Übergangsbereich erlaubt.  
überlagernde Schichten oder blanke Stellen sind nicht erlaubt.
  - 5 **AT AREA OF TOP OPENING PERMITTED**  
Im Bereich der Spitze Öffnung zulässig
  - 6 **AVAILABILITY MUST BE CHECKED BY TE CONNECTIVITY**  
Verfügbarkeit ist von TE CONNECTIVITY zu prüfen

THIS DRAWING IS A CONTROLLED DOCUMENT. DIESE ZEICHNUNG IST EIN KONTROLLIERTES DOKUMENT.

DIMENSIONS: MASSTABEINHEITEN	TOLERANCES: UNLESS OTHERWISE SPECIFIED: ALLERWERTIGKEITEN	DMN	25-JUN-2001	 TE Connectivity
0-PLC ± 0.15 mm	1-PLC ± 0.15 mm	C. Goetz	25-JUN-2001	
2-PLC ± -	2-PLC ± -	J. Granzow		DIA. 2.5MM PIN CONTACT DIA 2.5mm Stiftkontakt
3-PLC ± -	3-PLC ± -			PRODUCT SPEC PRODUKTSPEZ 105-18027
4-PLC ± -	4-PLC ± -			APPLICATION SPEC VERARBEITUNGSSPEZ 114-18020
ANGLES/WINKEL ± 1°				SIZE 114-18020
MATERIAL	FINISH/OBERFLÄCHE/FARBE	WEIGHT	0.85 g	SCALE MASSSTAB: 5:1
SEE TABLE	SEE TABLE	CUSTOMER DRAWING / KUNDENZEICHNUNG	A1 00779	DRAWING NO. ZEICHNUNGS-NR. 1355064
				RESTRICTED TO NUR FÜR A6