

LOC	DIST	REVISIONS			
		REV	DATE	BY	CHK
J	-	A	09MAY06	SS	SI
		B	13SEP07	SS	HY
		C	20MAY10	TS	KB

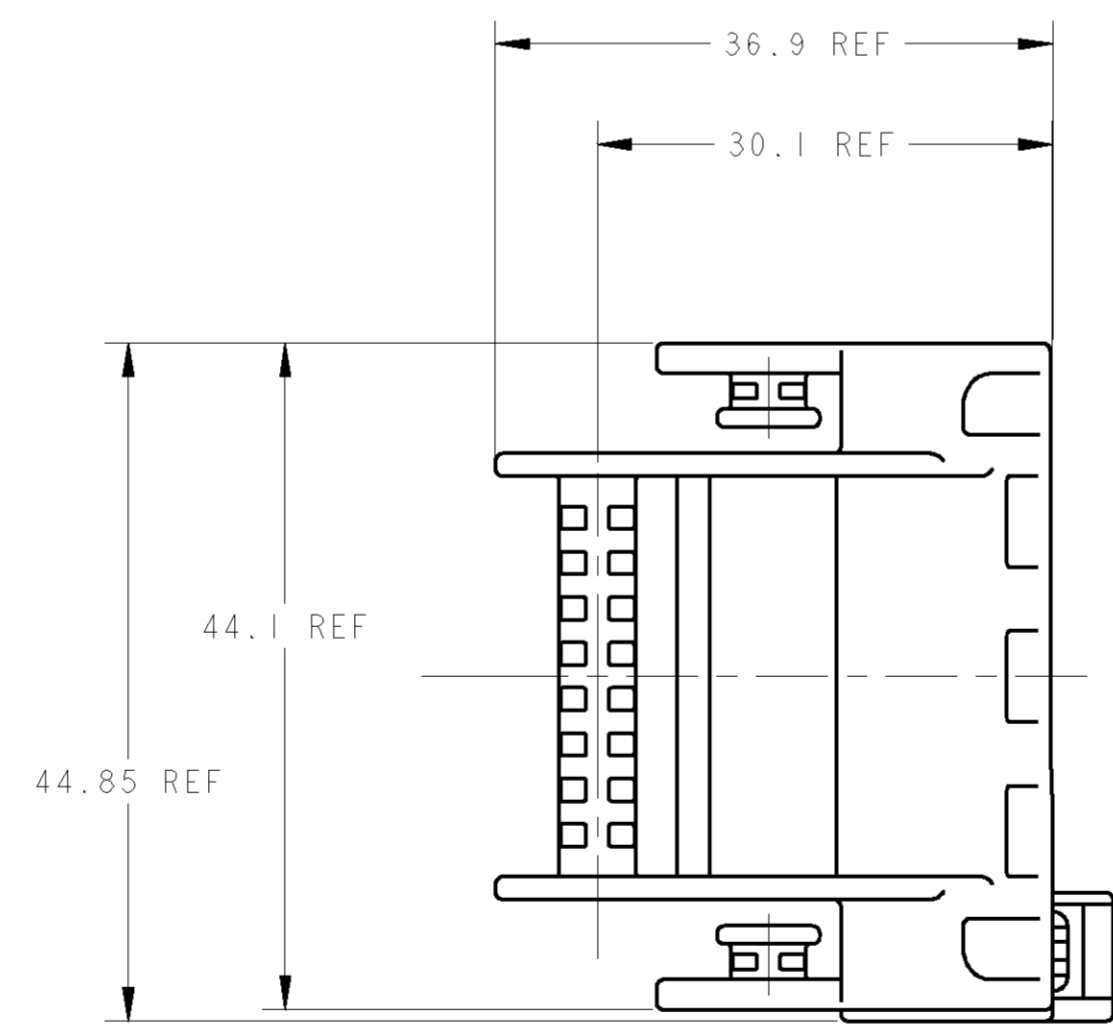
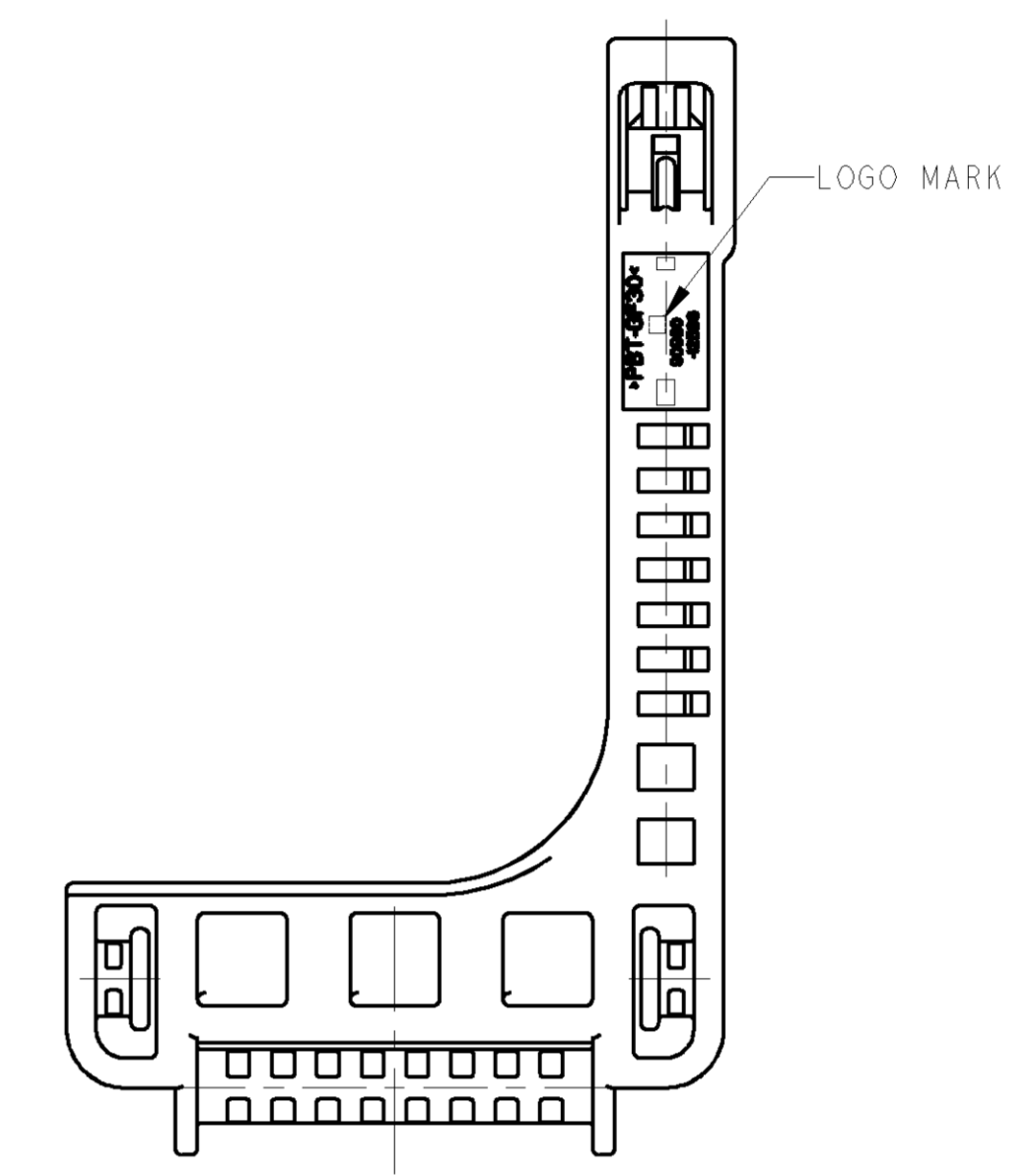
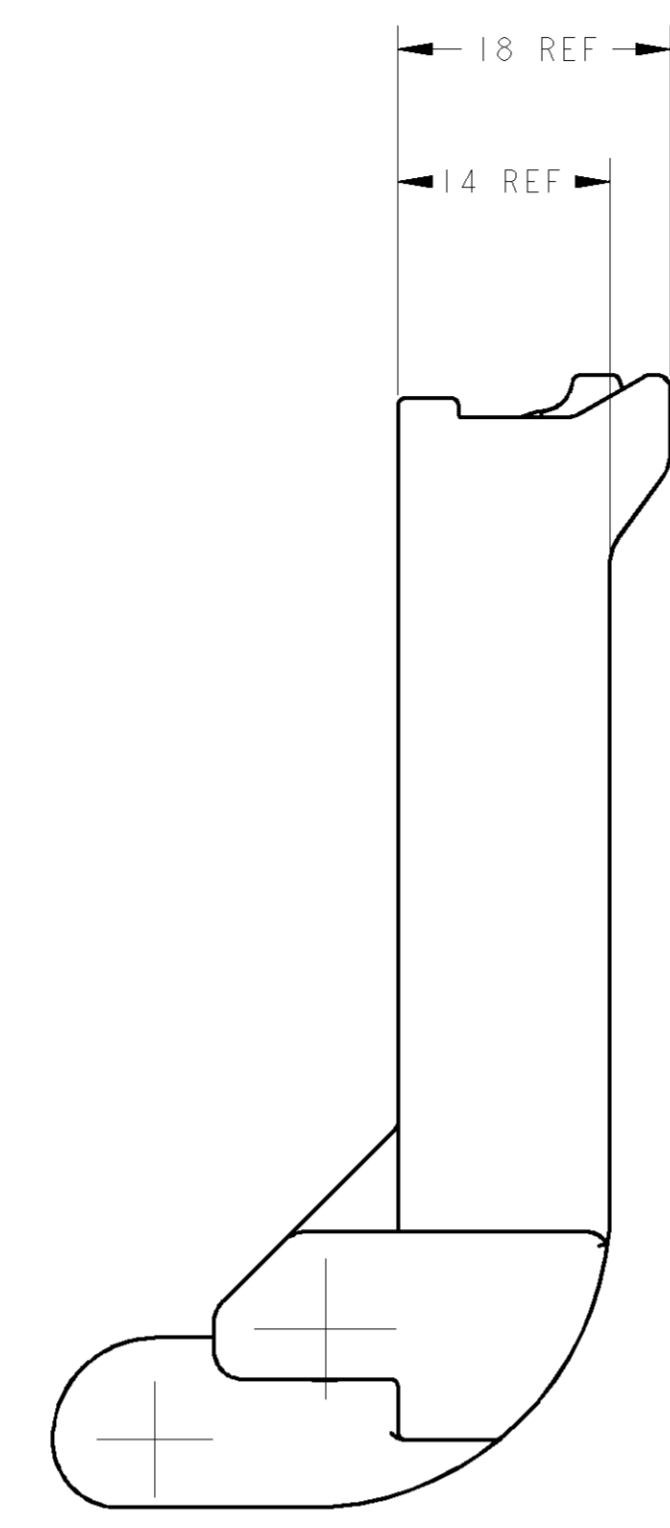
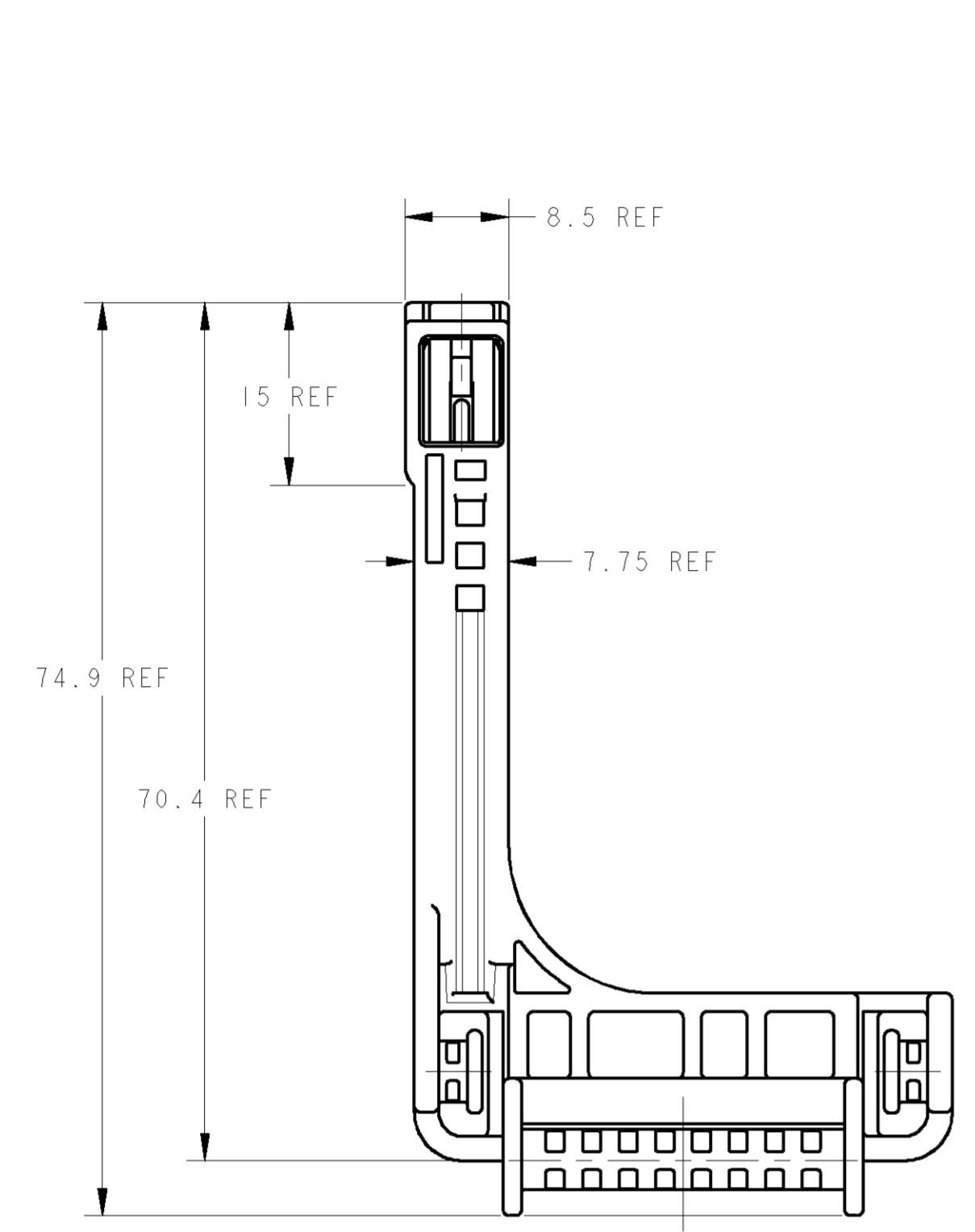

- MATING CONNECTOR IS:
TYCO ELECTRONICS P/N:1612275/1827022
- HANDLING OF THIS PART SHOULD FOLLOW
INSTRUCTION SHEET NO.411-78084.
- ASSEMBLED BY CUSTOMER.

- 嵌合相手型番:
TYCO ELECTRONICS P/N:1612275/1827022
- 本製品の取扱は取扱説明書NO.411-78084に従うこと。
- レバーは顧客にて組立てられる。

PAPER BOX ダンボール箱	PLASTIC BAG ビニール袋	GRAY	1612281-1
OUTER 外装	INNER 内装	COLOR	P/N
PACKING STYLE 梱包形態			

DIMENSIONS: mm 		TOLERANCES UNLESS OTHERWISE SPECIFIED: 公差 単位: mm 0-PLC ±0.3 1-PLC ±0.1 2-PLC ±0.1 3-PLC ±0.01 4-PLC ±0.001 ANGLES SEE TABLE		DWN S. SHISHIKURA 09MAY06 CHK K. SAKAMAKI 09MAY06 APVD S. ISOHATA 09MAY06 PRODUCT SPEC 108-5891 APPLICATION SPEC		Tyco Electronics Corporation Kawasaki, Japan SEaled EFI ECU 0.64/2.311 I/O CONNECTOR 126 POSITION LEVER	
MATERIAL PBT		FINISH SEE TABLE		WEIGHT 16.6 g		SIZE CASE CODE DRAWING NO. A100779 C=1612281	
CUSTOMER DRAWING				SCALE 2:1		SHEET 1 OF 1 REV C	