

P	LTR	DESCRIPTION	DATE	DWN	APVD
	F	PLATING CHANGE (BRIGHT TIN TO MATTE TIN)	28MAR2023	KA	SPS

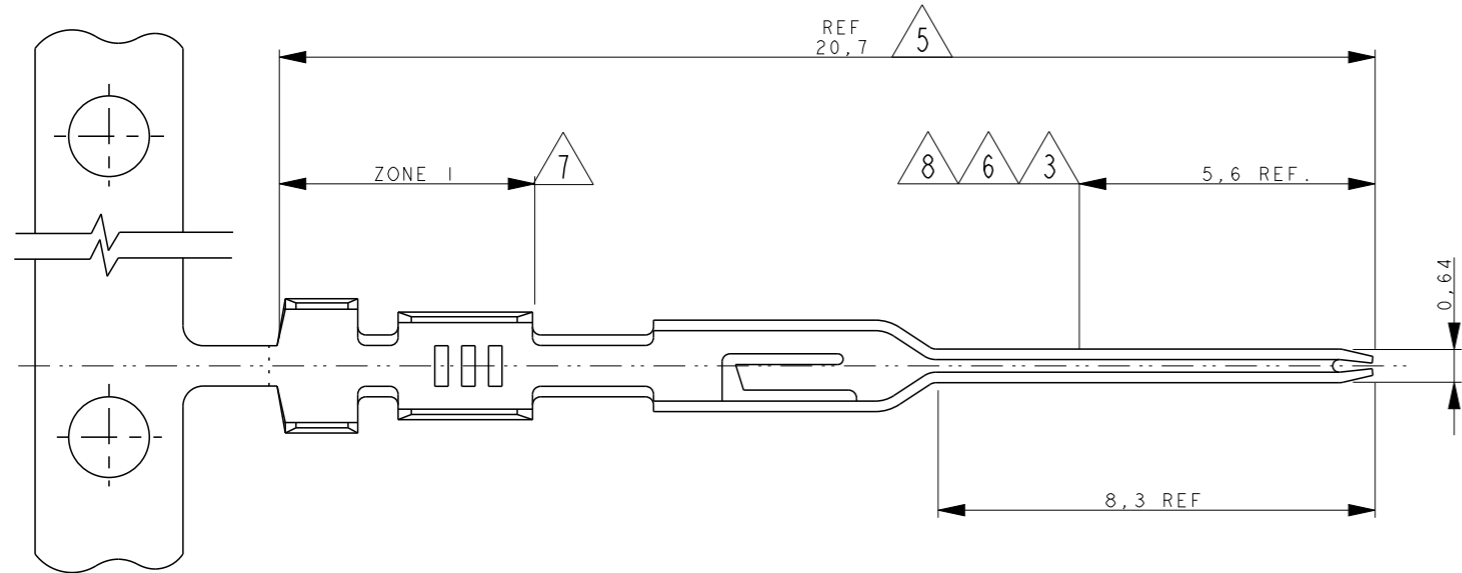

NOTES:

- 1 USE HANDTOOL 90340-1 FOR CRIMPING LOOSE PIECE CONTACTS.
- 2 FOR MINI APPLICATOR CRIMPING.
- 3 PARTS TO BE PLATED AS FOLLOWS: 166678-1
-UNDERCOATING: 0,8µm NICKEL
-SELECTIVE (OVER 5,6 LENGTH): 0,8µm MIN.GOLD
-REMAINDER: NICKEL ONLY.
- 4 MATERIAL: PHOSPHOR BRONZE.
- 5 PLATING 166678-2: 2µm MIN.Sn OVER TOTAL LENGTH
- 6 PLATING 166678-3: UNDERCOATING 0,8µm MIN. NICKEL
SELECTIVE OVER 5,6 LENGTH: 1,25µm MIN. GOLD
REMAINDER: NICKEL ONLY
- 7 ZONE I: MATTE TIN PLATED
TIN PLATING PERMITTED ON CARRIER STRIP.(1µm THICK)
- 8 PLATING 166678-4: UNDERCOATING 0,8µm MIN. NICKEL
SELECTIVE OVER 5,6 LENGTH: 0,4µm MIN. GOLD
REMAINDER: NICKEL ONLY
- 9 ADVANCED PROD. NRS. FOR DIN 41612 PART 5 SPEC.

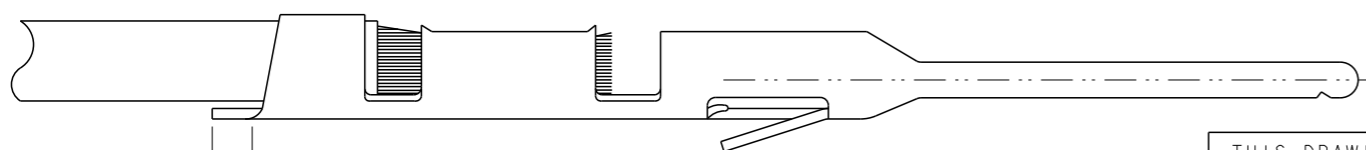
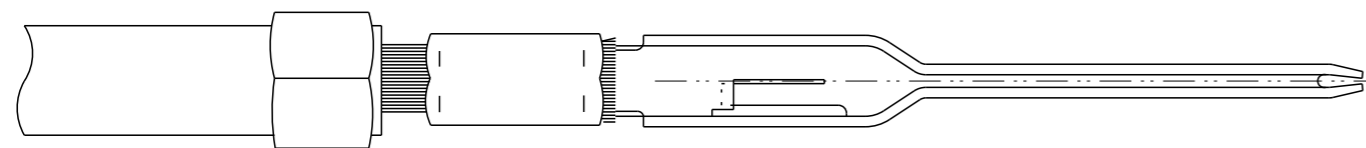
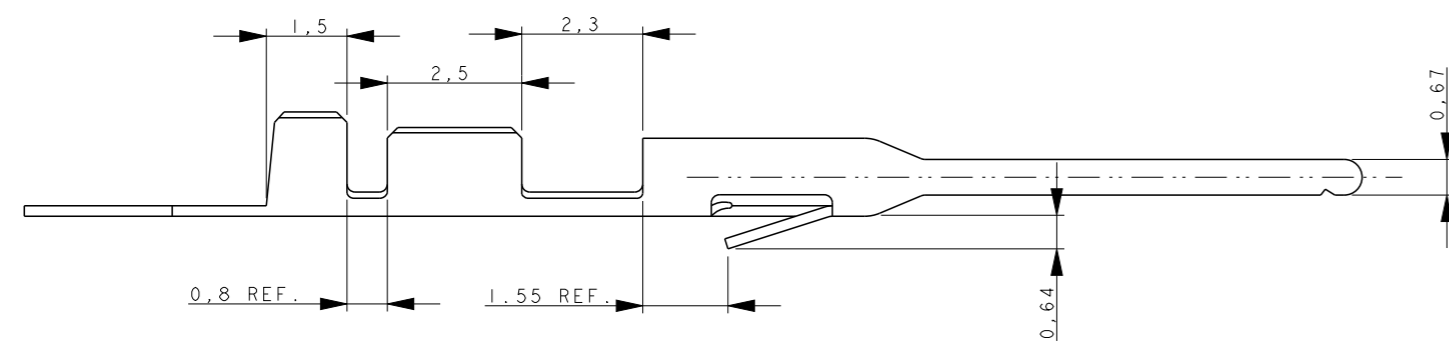

0,15 MAX. CUT-OFF TAB (REF.)

7	8	166679-4	166678-4
6	7	166679-3	166678-3
	5	166679-2	166678-2
3	7	166679-1	166678-1
PLATING		LOOSE PIECE PART NO. 1	PART NUMBER 2

THIS DRAWING IS A CONTROLLED DOCUMENT.

WIRE RANGE 0,12-0,35MM ²
INSUL. RANGE 1,55 MAX.

DIMENSIONS:	TOLERANCES UNLESS OTHERWISE SPECIFIED:
mm	
	0 PLC ±-
	1 PLC ±-
	2 PLC ±-
	3 PLC ±-
	4 PLC ±-
MATERIAL	ANGLES ±-
	FINISH

DWN	S.ELOISE	13NOV 95
CHK	Rvd IECK	04MAR 96
APVD	MvDRIEL	28FEB06
PRODUCT SPEC	-	
APPLICATION SPEC	-	
WEIGHT	-	
CUSTOMER DRAWING		

NAME	CONTACT, MOD IV, PIN FOR 22-26 AWG (STRIP)	
SIZE	A3	00779
CAGE CODE	C=166678	
DRAWING NO	166678-1	
RESTRICTED TO	-	
SCALE	-	SHEET 1 OF 1
REV	F	

