

REVISIONS 変更					
P	LTR	DESCRIPTION	DATE	DWN	APVD
	M	REVISED PER ECR-23-176373	13JUN2023	DB	JS

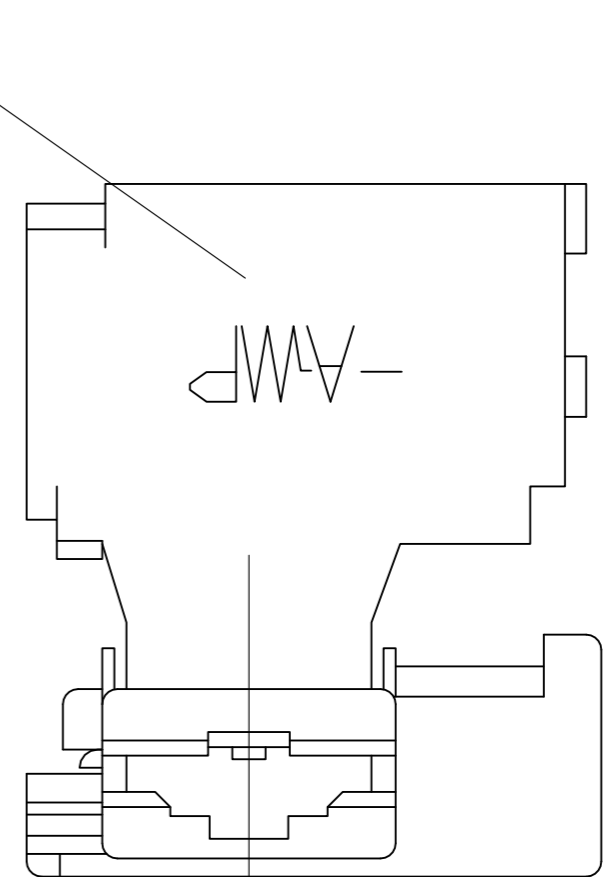
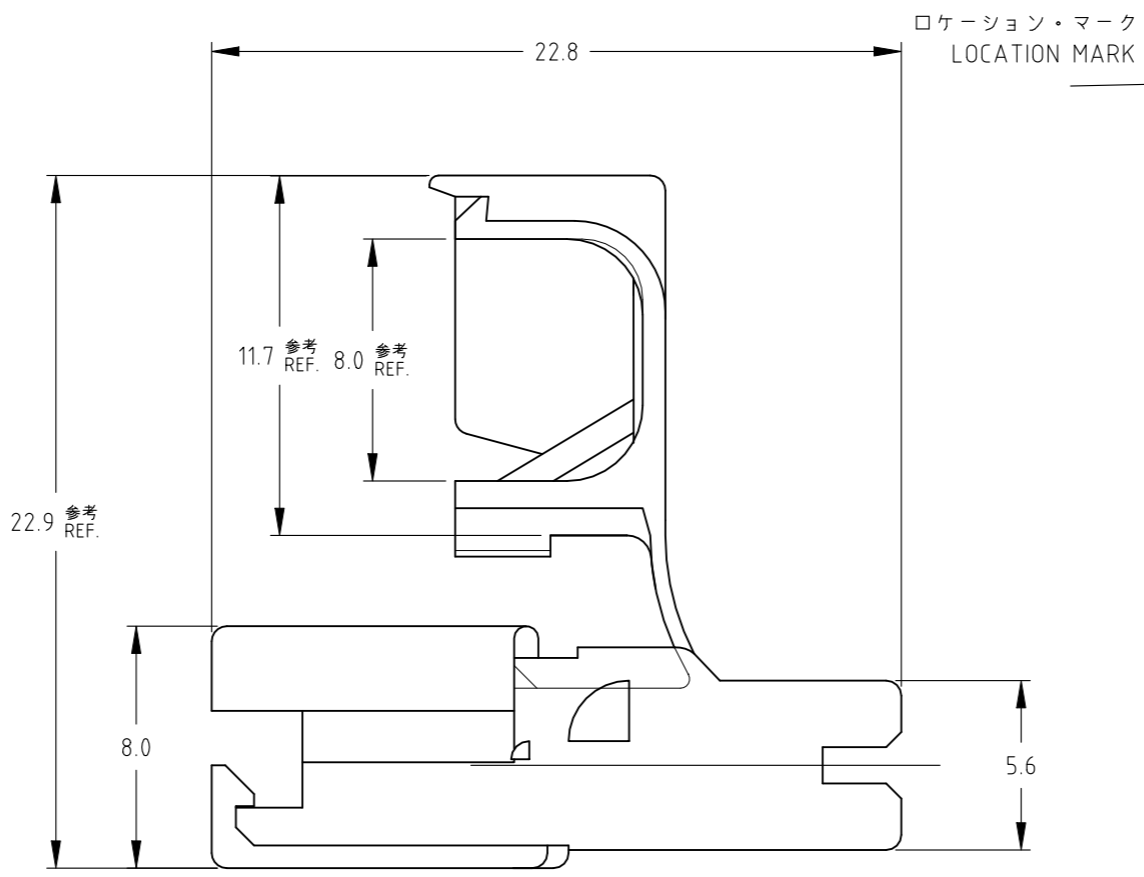
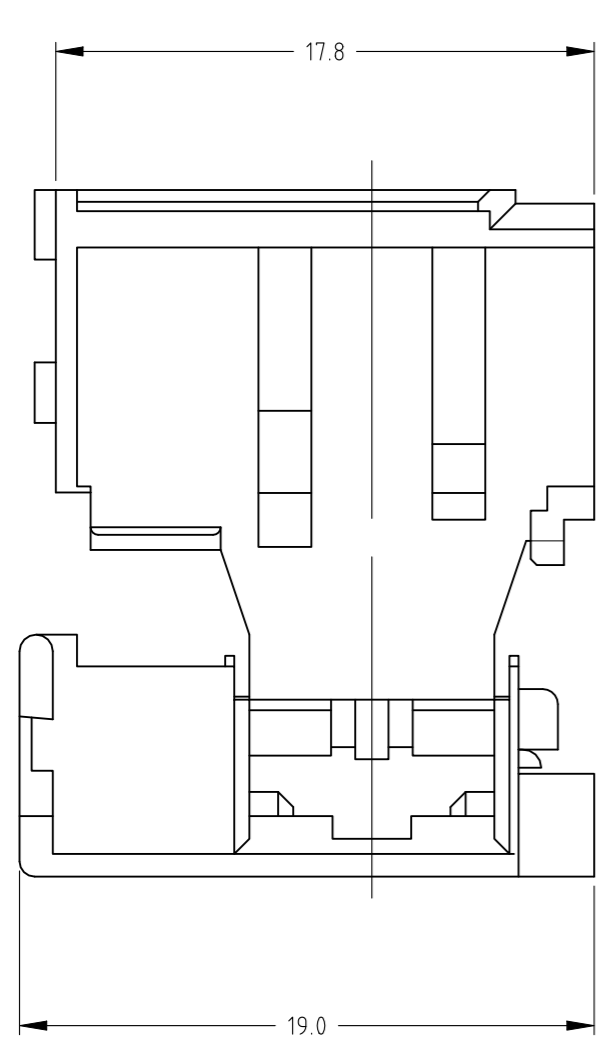

- 注；
- 適用コンタクト；
型番：172761,172782,172763
 - 取扱説明書；411-5212

- NOTES；
- APPLICABLE CONTACT PARTS NUMBER：172761,172762,172763
 - INSTRUCTION SHEET：411-5212
 - OBSOLETE PARTS: OBSOLETE CIS STREAMLINING PER D.RENAUD/D.SINISI
 - COMPLY WITH GLOW WIRE REQUIREMENT FOR PARTS OF NON-METALLIC MATERIAL SUPPORTING A CURRENT CARRYING CONNECTION DETAILED IN IEC 60335-1, SECTION 30 (GWT)
 - GENERAL TOLRERANCE: ±0.3, ±2°

OBSOLETE	7-172469-1	自然色 NATURAL	6/6ナイロン 6/6 NYLON	UL94V-0, GWT
OBSOLETE	1-172469-3	黄 YELLOW		UL94V-0
	1-172469-2	青 BLUE		UL94V-0
	1-172469-1	自然色 NATURAL		UL94V-0
	172469-8	黒 BLACK		UL94V-2
OBSOLETE	172469-7	赤 RED		UL94V-2
	172469-4	緑 GREEN		UL94V-2
OBSOLETE	172469-3	黄 YELLOW		UL94V-2
	172469-2	青 BLUE		UL94V-2
	172469-1	自然色 NATURAL		UL94V-2
型番	PART NUMBER	色調 COLOR	材料 MATERIAL	

THIS DRAWING IS A CONTROLLED DOCUMENT.		DWN M.SUZUKI 17.APR.'02	TE Connectivity	
		CHK M.SHINDO 17.APR.'02		
DIMENSIONS: 単位： 耗 mm		APVD M.SHINDO 17.APR.'02	NAME 名称 250 SERIES FLAG POSITIVE LOCK MARK-II HOUSING	
TOLERANCES UNLESS OTHERWISE SPECIFIED: 一般公差		PRODUCT SPEC 製品規格 108-5162	DRAWING NO 番号 A3 00779 C-172469	
0 PLC ± - 1 PLC ± - 2 PLC ± - 3 PLC ± - 4 PLC ± - ANGLES ±		APPLICATION SPEC 取付適用規格	SIZE	RESTRICTED TO
MATERIAL 材料 SEE TABLE		WEIGHT 0.000000	CAGE CODE A3 00779	SCALE 尺度 4:1
		CUSTOMER DRAWING		SHEET 1 OF 1
				REV M