

REVISIONS					
P	LTR	DESCRIPTION	DATE	DWN	APVD
B		REVISED PER ECR-20-100642	19SEP2022	M.G	D.Z

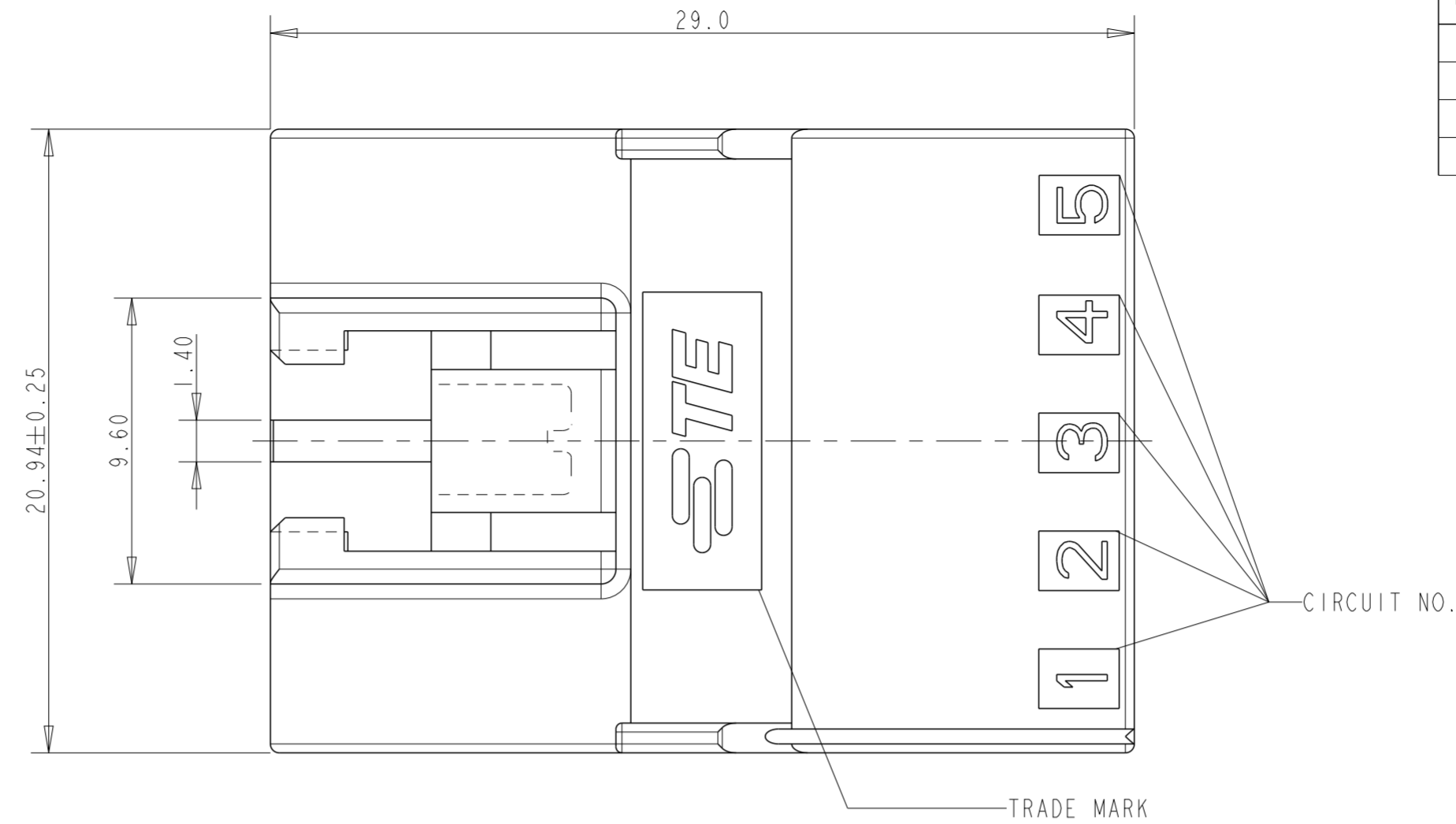

- NOTES:
- APPLICABLE CONTACT P/N:
 TAB CONTACT: 175150- (20-16 AWG)
 175149- (26-22 AWG)
 - MATING CONN. P/N:
 PLUG HSG: 176279-
 REC HSG: 175152- (20-16 AWG)
 175151- (26-22 AWG)
 - INSTRUCTION SHEET: IS-503J.

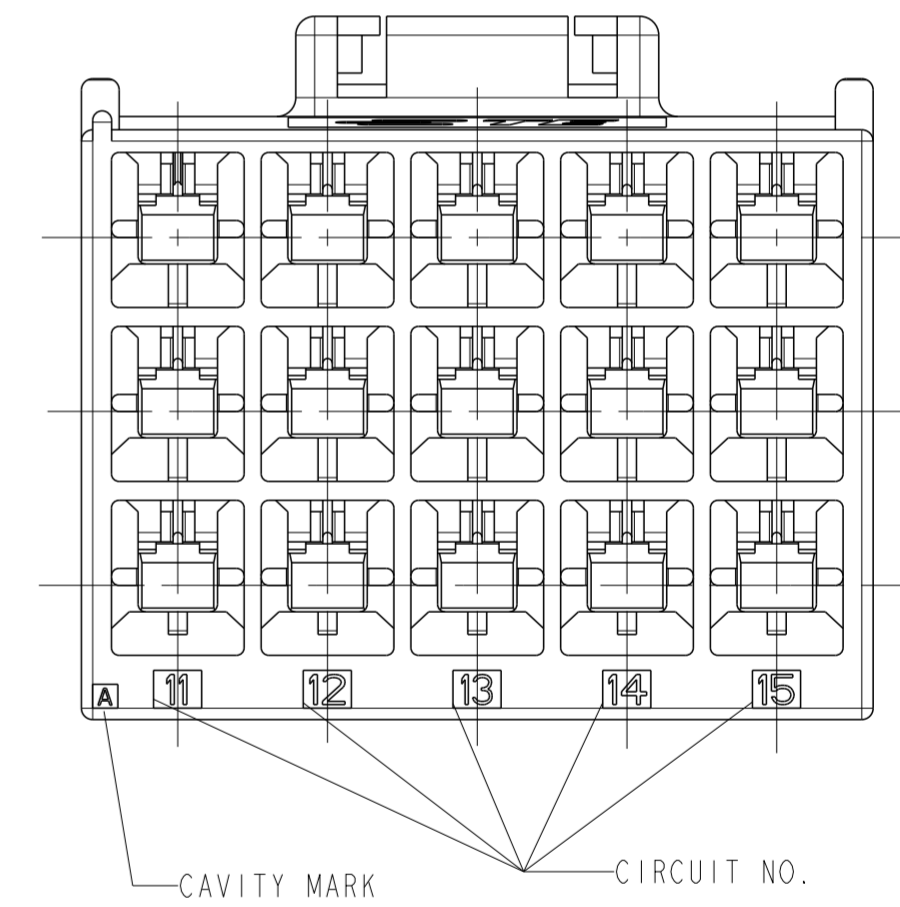
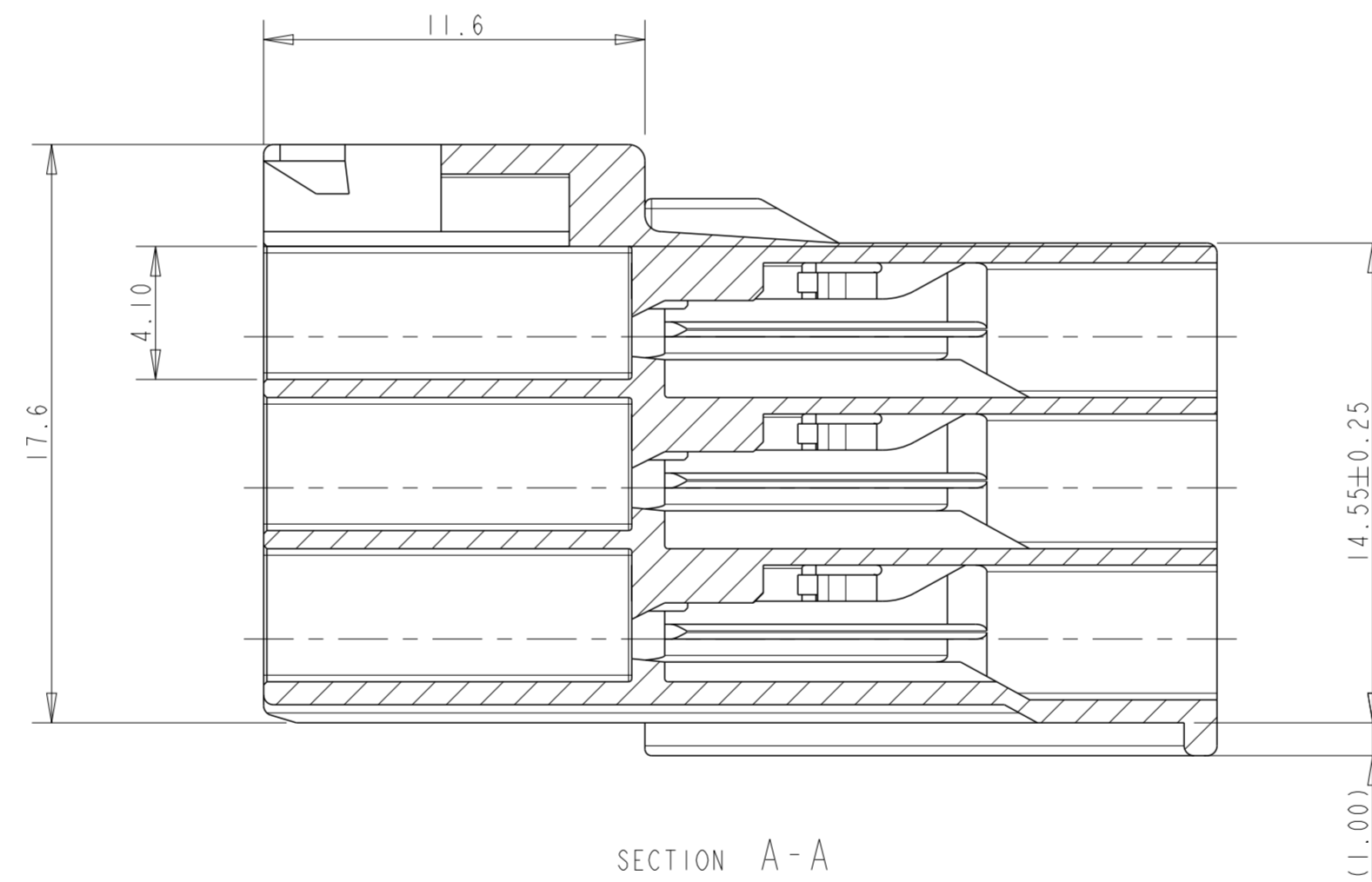
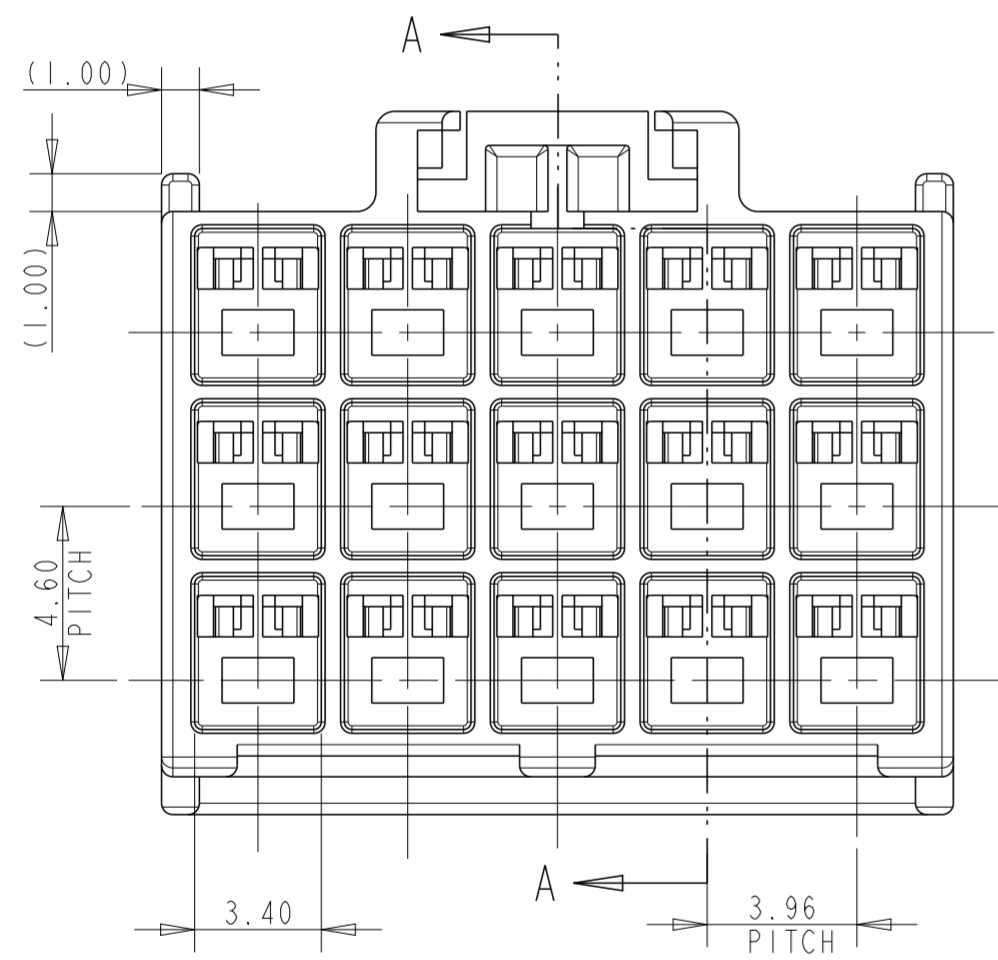

DISCONTINUED	HOUSING COLOR	POSITION	PART NUMBER
DEVELOPMENT	BLACK	15	176290-9
DEVELOPMENT	BLUE	15	176290-6
DEVELOPMENT	YELLOW	15	176290-4
DISCONTINUED	RED	15	176290-2
	NATURAL	15	176290-1

THIS DRAWING IS A CONTROLLED DOCUMENT.

DIMENSIONS: mm	TOLERANCES UNLESS OTHERWISE SPECIFIED:	DWN: M. SHINDO 23NOV1989	TE Connectivity NAME: AMP UNIVERSAL POWER CONN, 3.96mm PITCH CAP HOUSING 15 Pos (TPL ROW)
0 PLC ±	1 PLC ±0.25	CHK: M. YOSHIDA 28NOV1989	
2 PLC ±0.2	3 PLC ±	APVD: N. ONQUE 28NOV1989	
4 PLC ±	ANGLES ±3°	PRODUCT SPEC: 108-5302	
MATERIAL: 6/6 NYLON (UL94 V-0)	FINISH: -	APPLICATION SPEC: 114-5142	SIZE: A2
		WEIGHT: -	CAGE CODE: 00779
		CUSTOMER DRAWING	DRAWING NO: C-176290
			RESTRICTED TO: -
			SCALE: 5:1
			SHEET: 1 OF 1
			REV: B