

LOC	DIST	REVISIONS					
		P	LTN	DESCRIPTION	DATE	OWN	APVD
GP	00	A		ACTIVE PER ECR-14-018840	17DEC2014	RG	MC
		B		REVISED PER ECO-15-005721	4AUG2015	RG	SH

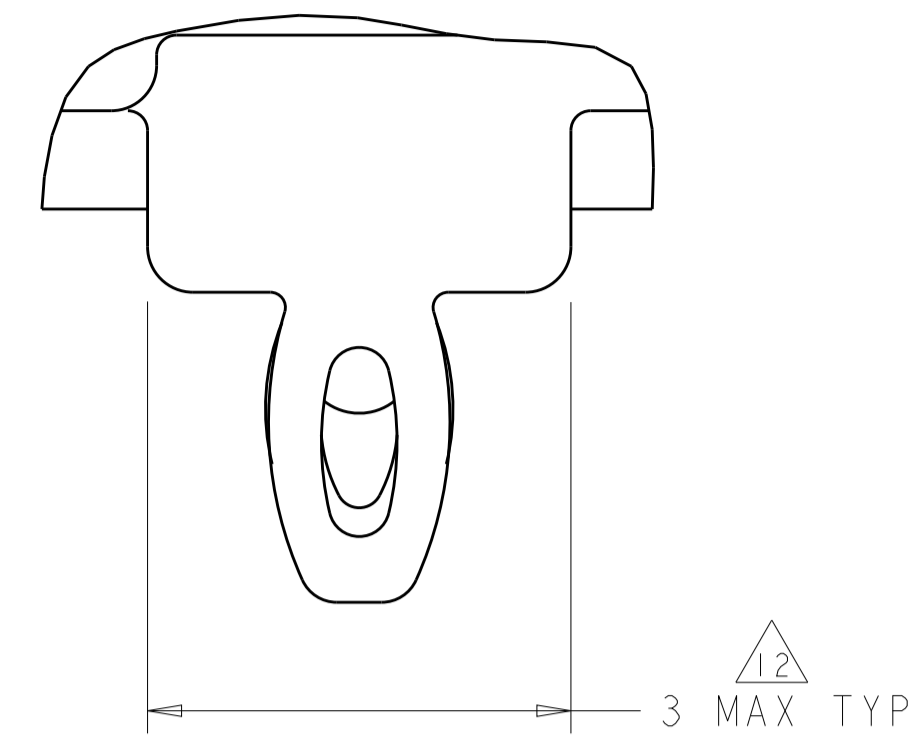

DETAIL S
SCALE 20:1

- 1 CAGE ASSEMBLY MATERIAL: NICKEL SILVER, 0.25 THICK
 HEAT SINK MATERIAL: ALUMINUM
 HEAT SINK CLIP MATERIAL: STAINLESS STEEL
 EMI SPRING MATERIAL: COPPER ALLOY
 FRONT FLANGE MATERIAL: ZINC ALLOY
 LIGHT PIPE MATERIAL: CLEAR POLYCARBONATE
- 2 PITCH BETWEEN PORTS OF ONE 1X6 CAGE ASSEMBLY.
- 3 SPACING BETWEEN CAGES ON THE SAME PC BOARD, TO BE SPECIFIED BY CUSTOMER, MUST COMPLY WITH MINIMUM DIMENSIONS SHOWN.
- 4 REFERENCE APPLICATION SPEC 114-13218 FOR RECOMMENDED DRILL HOLE DIAMETER AND PLATING THICKNESS.
- 5 DATUMS AND BASIC DIMENSIONS ESTABLISHED BY CUSTOMER.
- 6 DIMENSION F IS THE NOMINAL THICKNESS OF CUSTOMER SUPPLIED PC BOARD,
 SINGLE SIDED PC BOARD MINIMUM THICKNESS = 1.45mm
 DOUBLE SIDED PC BOARD MINIMUM THICKNESS = 2.2mm PER QSFP.
- 7 HEAT SINKS, LIGHT PIPES, AND HEAT SINK CLIPS SHIPPED ASSEMBLED TO CAGE ASSEMBLY.
- 8 DATUM A IS TOP SURFACE OF PC BOARD.
- 9 DIMENSION APPLIES WITH MODULE INSERTED IN CAGE.
- 10 UNPLATED THRU HOLE.
- 11. MATES WITH QSFP MSA COMPATIBLE TRANSCEIVER.
- 12 SURFACE TRACES PERMITTED WITHIN THIS AREA EXCEPT WHERE CAGE STANDOFFS, SHOWN IN DETAIL S, CONTACT PC BOARD.
- 13 BASELINE FOR THESE DIMENSIONS IS THE CENTER OF COMPLIANT PIN HOLE.
- 14 2D BARCODE AND DATE CODE (YYWWD) MARKED ON SIDE OF CAGE.

- 15 REFERENCE APP SPEC 114-13218 FOR GASKET THICKNESS CALCULATION.
- 16 EMI SPRING FINISH: 2um MINIMUM TIN
 FRONT FLANGE FINISH: 3um MINIMUM TIN OVER 1.27um MINIMUM NICKEL OVER 5.08um MINIMUM COPPER.
 HEAT SINK FINISH: CLEAR ANODIZED COATING OR BLACK ANODIZED COATING.

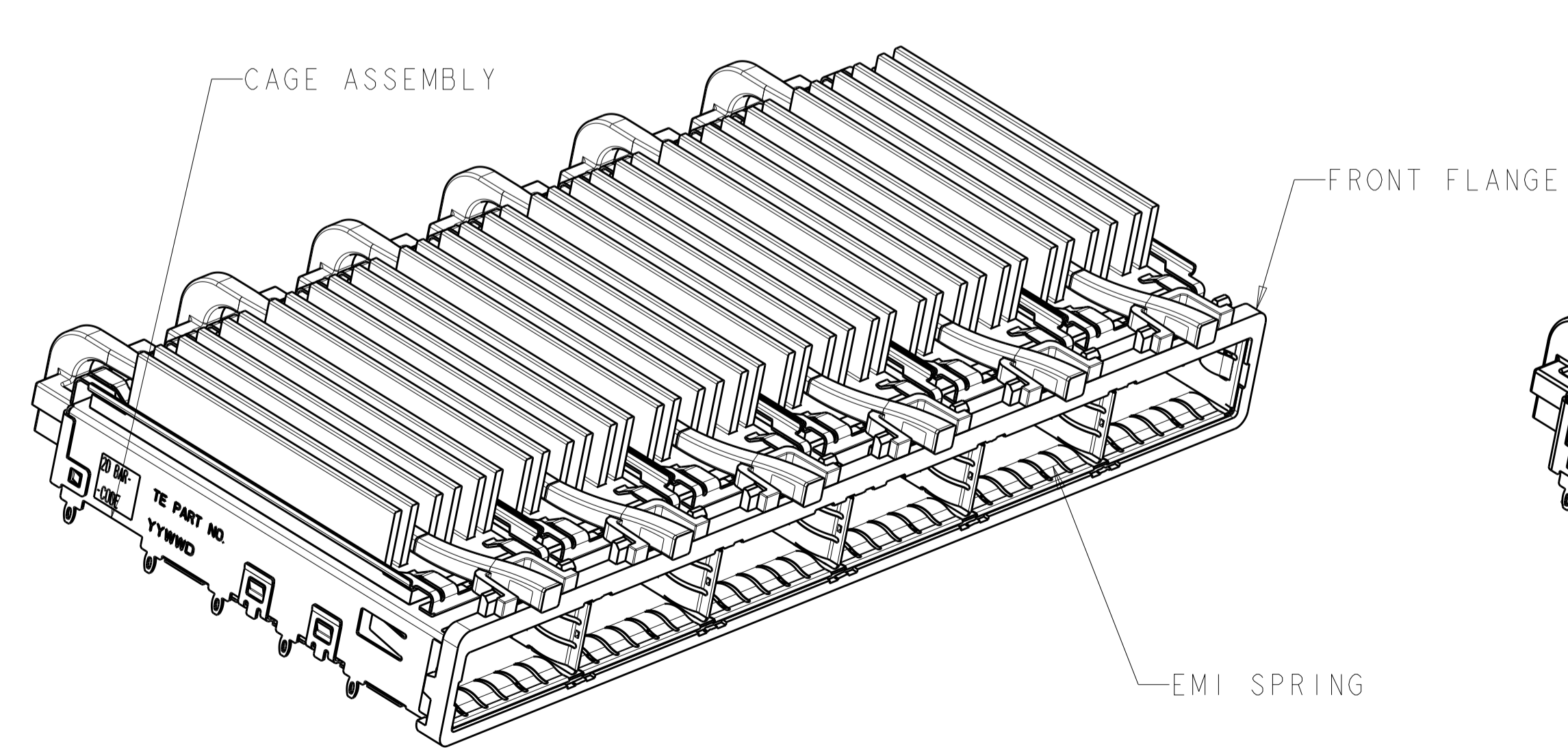
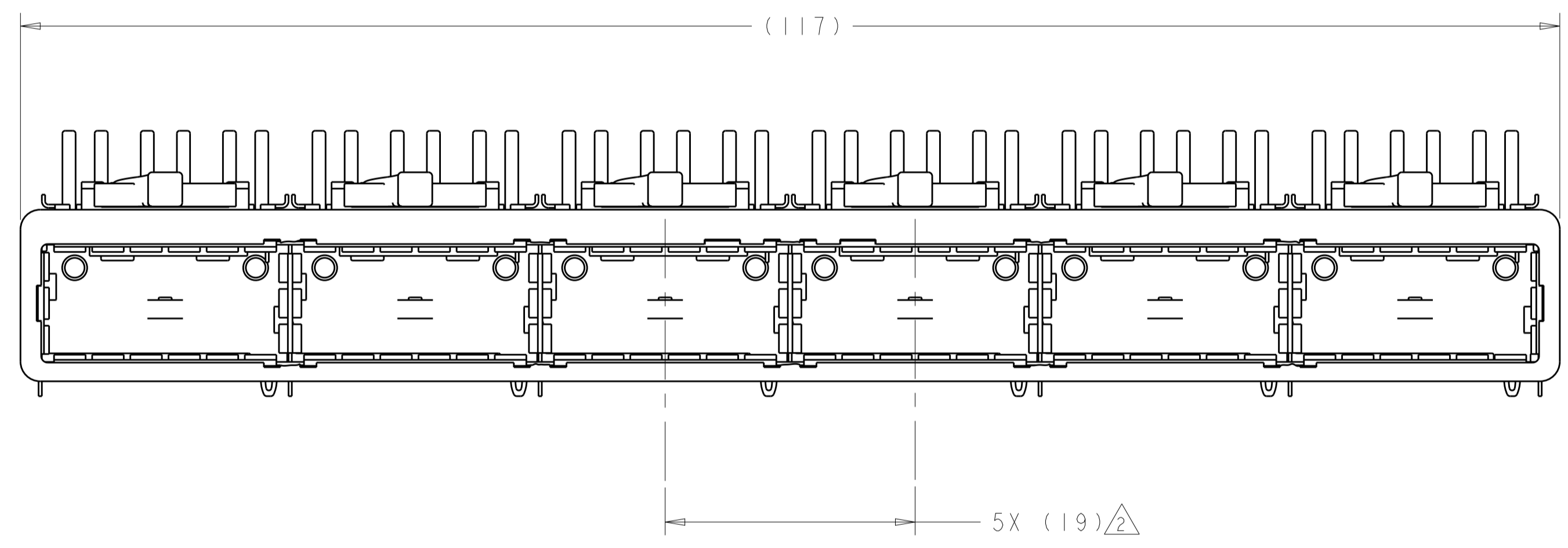
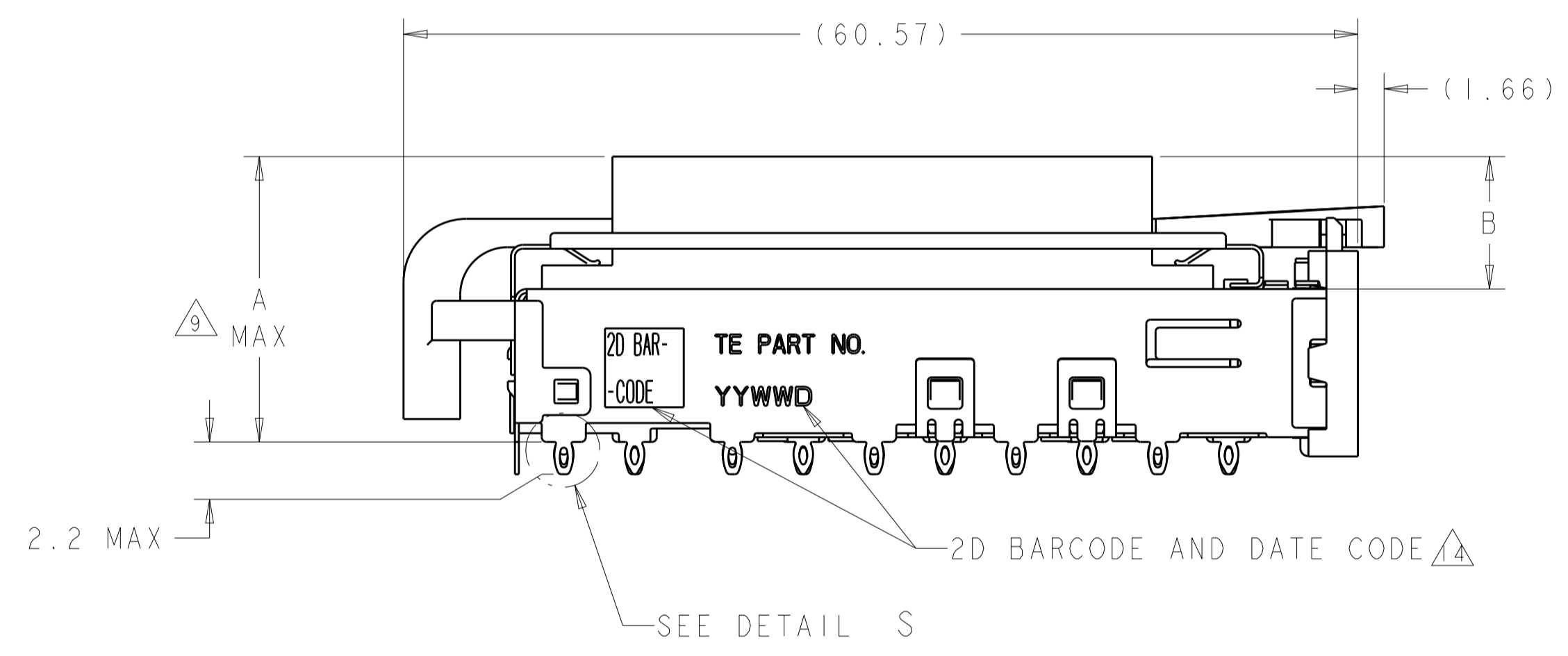

2170551-1 AS SHOWN
SCALE 2:1

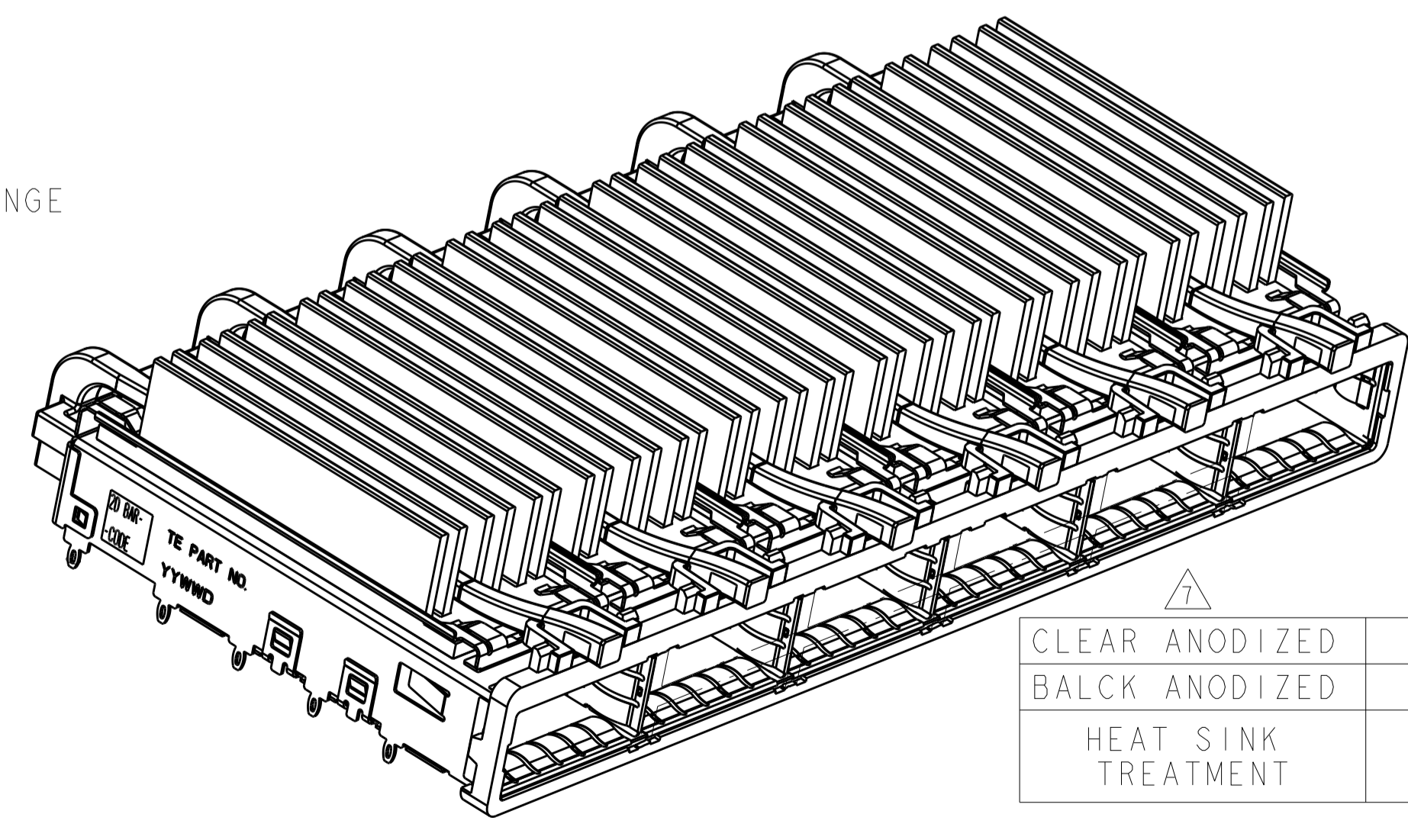

2170551-2 AS SHOWN
SCALE 2:1

CLEAR ANODIZED	10.4	21.0	SINGLE AND SQUARE	CUSTOMIZED FIN TYPE	2170551-2
BLACK ANODIZED	8.4	19.0	SINGLE AND SQUARE	CUSTOMIZED FIN TYPE	2170551-1
HEAT SINK TREATMENT	B	A	LIGHT PIPE	HEAT SINK TYPE	PART NUMBER

THIS DRAWING IS A CONTROLLED DOCUMENT.

DIMENSIONS:	TOLERANCES UNLESS OTHERWISE SPECIFIED:	OWN: BING LIU 22JUL2013	TE Connectivity
mm	0 PLC ±0.1	CHK: JASON YANG 22JUL2013	
	1 PLC ±0.1	APPD: AILEY CAI 22JUL2013	
	2 PLC ±0.1	NAME: A100779C=2170551	
MATERIAL:	FINISH:	PRODUCT SPEC: 108-2286	1X6 CAGE ASSEMBLY, BEHIND BEZEL, W/ SOR LIGHT PIPES AND HEAT SINKS, QSFP
		APPLICATION SPEC: 114-13218	RESTRICTED TO:
		WEIGHT:	Customer Drawing

SCALE 3:1 SHEET 1 OF 5 REV B

LOC		DIST		REVISIONS			
GP	00	P	LTN	DESCRIPTION	DATE	DMN	APVD
		-		SEE SHEET 1			

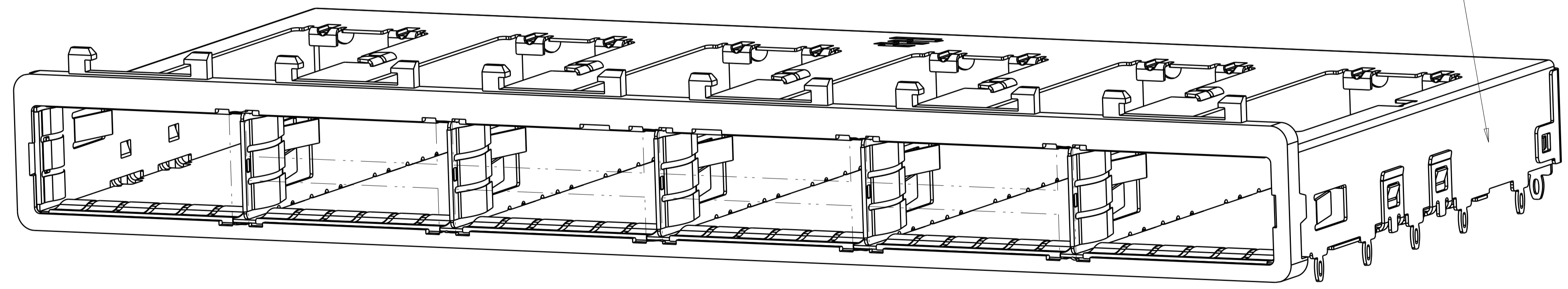
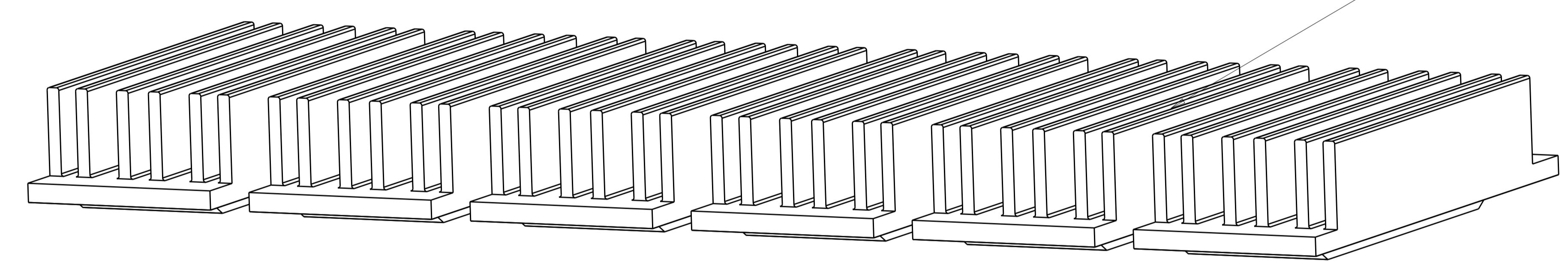
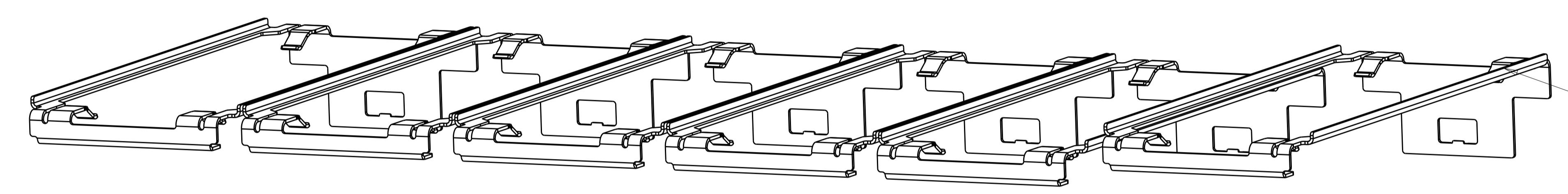
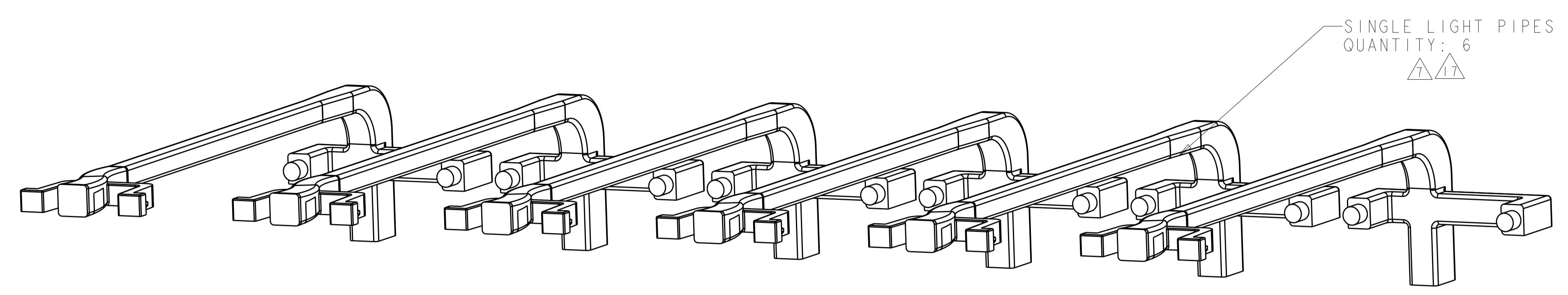

THIS DRAWING IS A CONTROLLED DOCUMENT.		DMN	BING LIU	22JUL2013	TE Connectivity
DIMENSIONS:		CHK	JASON YANG	22JUL2013	
mm	0 PLC ± 1 PLC ±0.1 2 PLC ±0.1 3 PLC ± 4 PLC ± ANGLES ± FINISH	TOLERANCES UNLESS OTHERWISE SPECIFIED:		NAME	1X6 CAGE ASSEMBLY, BEHIND BEZEL, W/
		APVD	ALEY CAI	22JUL2013	SOR LIGHT PIPES AND HEAT SINKS,
MATERIAL		PRODUCT SPEC	108-2286	APPLICATION SPEC	QSFP
		SIZE	114-13218	RESTRICTED TO	
		WEIGHT		Customer Drawing	A100779C=2170551
		SCALE	4:1	SHEET	2 OF 5
		REV	B		

LOC	DIST	REV	DESCRIPTION	DATE	OWN	APVD
GP	00		SEE SHEET 1			

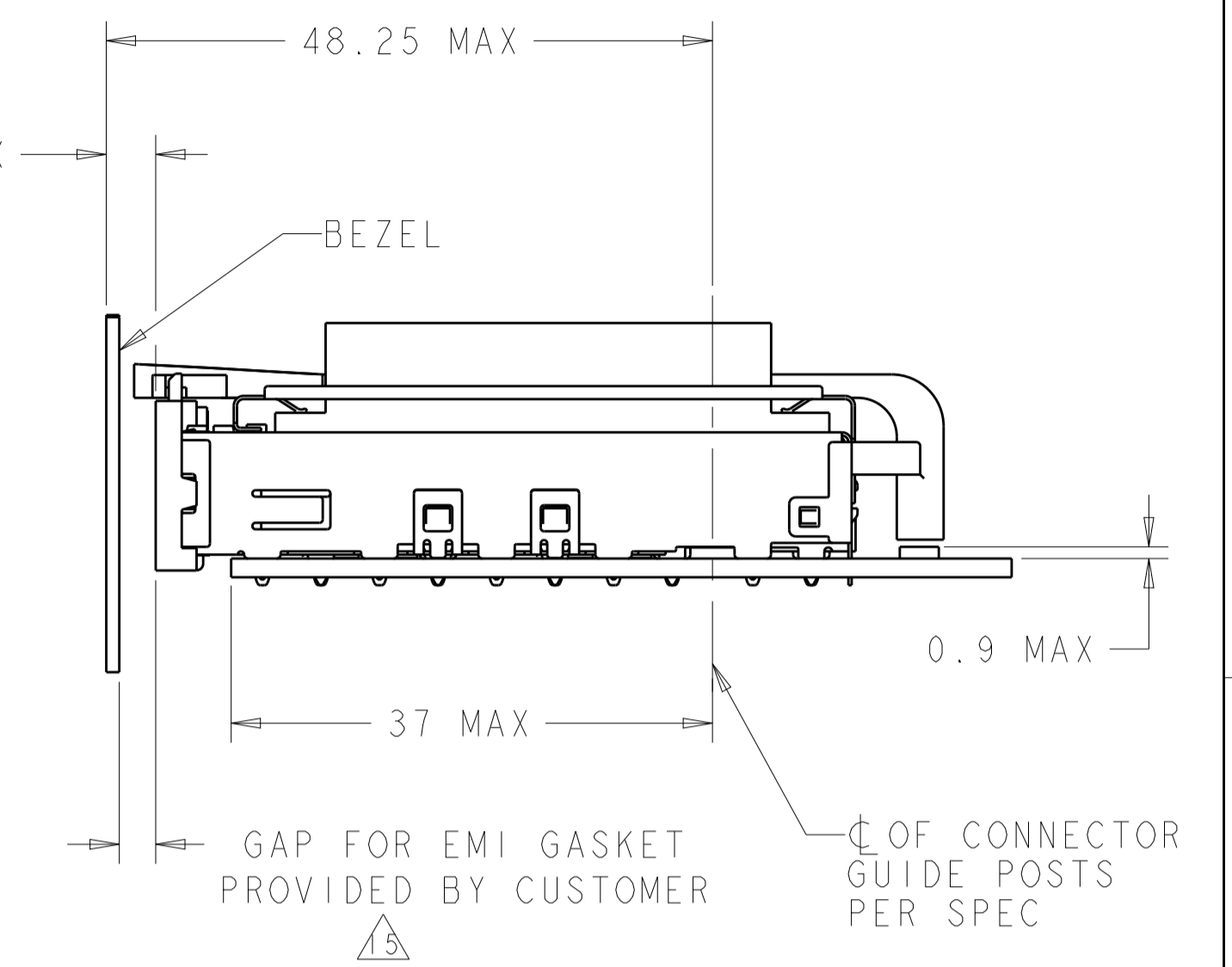
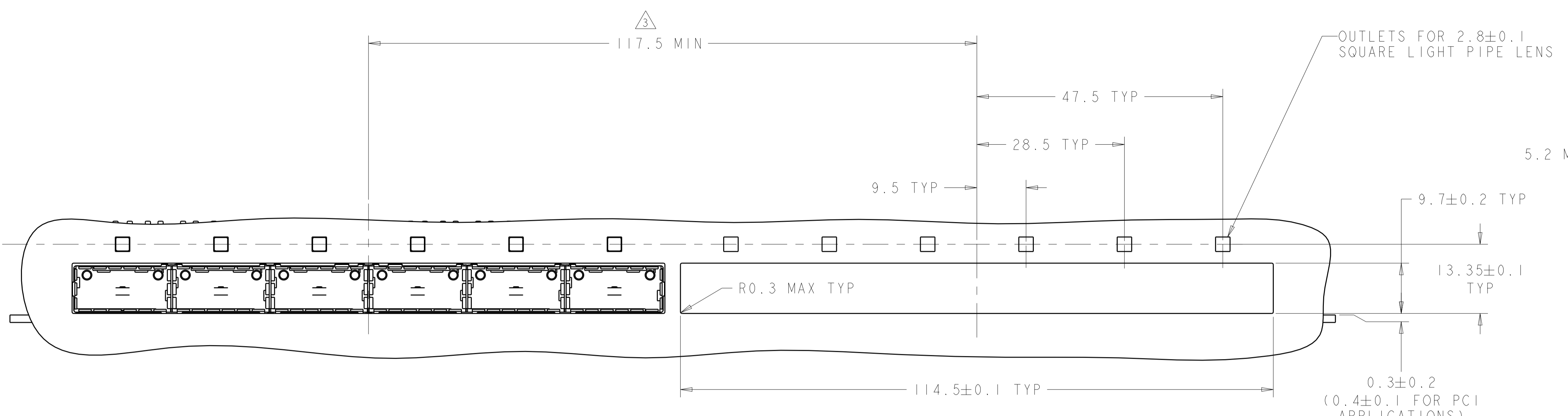

ONE SIDED CONFIGURATION WITH SQUARE LIGHT PIPES
 SCALE 2:1

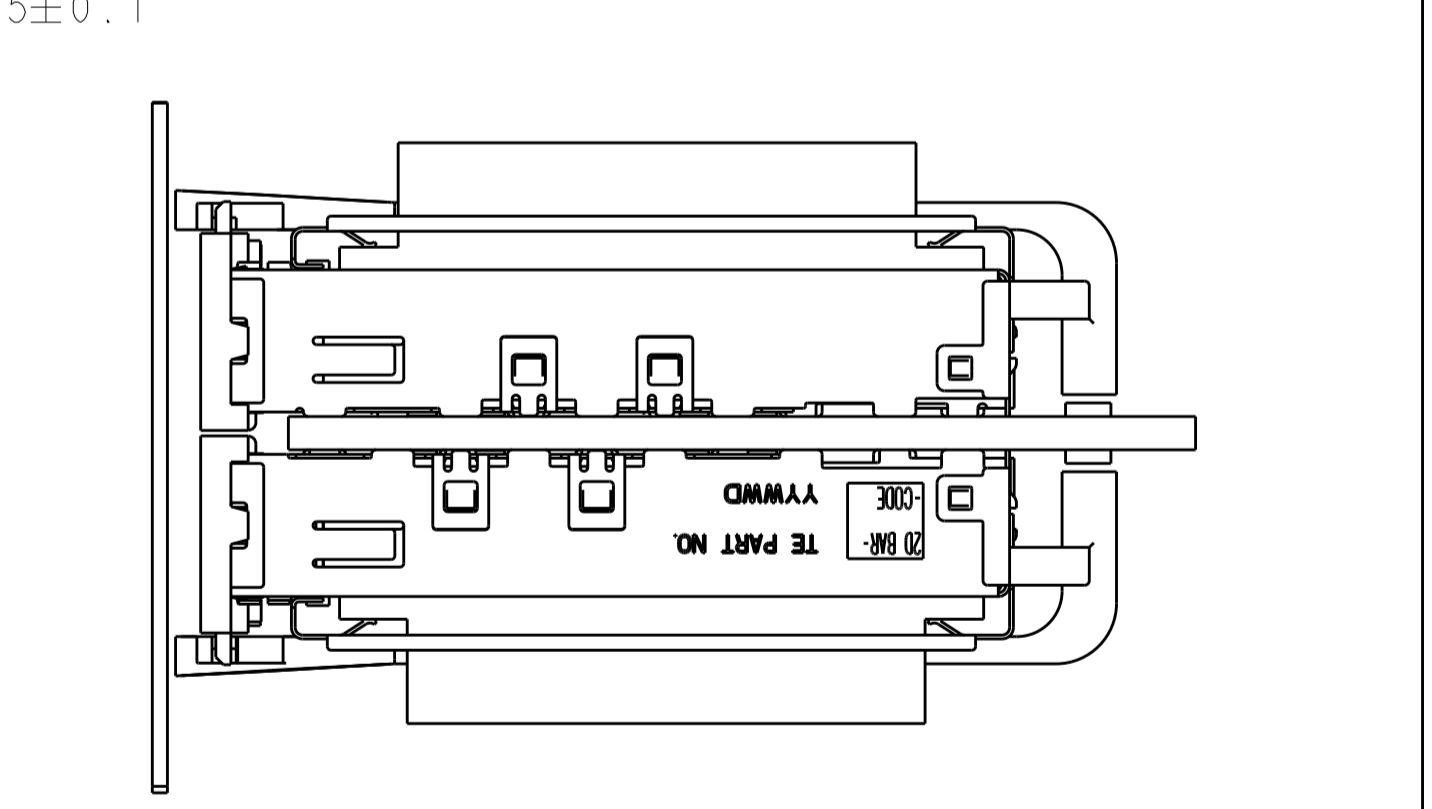
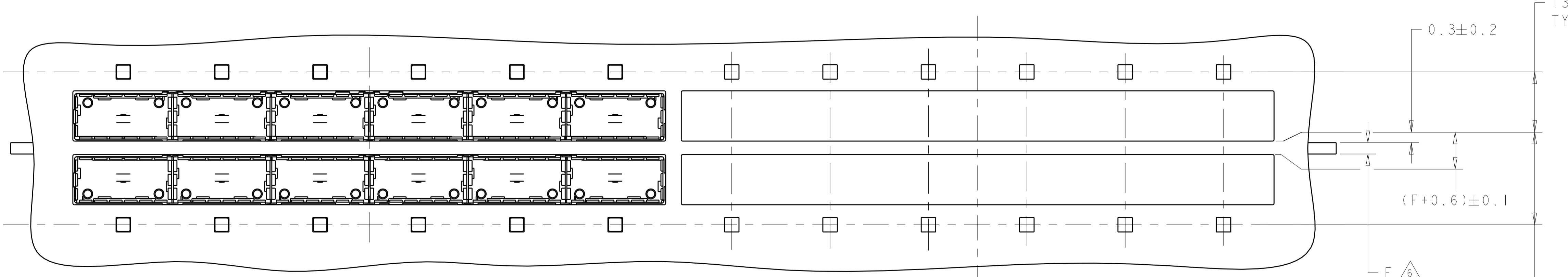

BELLY TO BELLY CONFIGURATION WITH SQUARE LIGHT PIPES
 SIMILAR TO ONE SIDED EXCEPT WHERE NOTED
 SCALE 2:1

THIS DRAWING IS A CONTROLLED DOCUMENT.

DIMENSIONS:	TOLERANCES UNLESS OTHERWISE SPECIFIED:	OWN: BING LIU 22JUL2013	CHK: JASON YANG 22JUL2013	APVD: AILEY CAI 22JUL2013
mm	0 PLC ± 1 PLC ±0.1 2 PLC ±0.1 3 PLC ± 4 PLC ± ANGLES ±	NAME: 1X6 CAGE ASSEMBLY, BEHIND BEZEL, W/ SOR LIGHT PIPES AND HEAT SINKS, QSFP	PRODUCT SPEC: 108-2286	APPLICATION SPEC: 114-13218
MATERIAL:	FINISH:	SIZE: A1	CAGE CODE: 00779	DRAWING NO: C=2170551
		Customer Drawing	SCALE: 4:1	SHEET 3 OF 5

RESTRICTED TO REV B

LOC	DIST	REV	DESCRIPTION	DATE	OWN	APVD
GP	00		SEE SHEET 1			

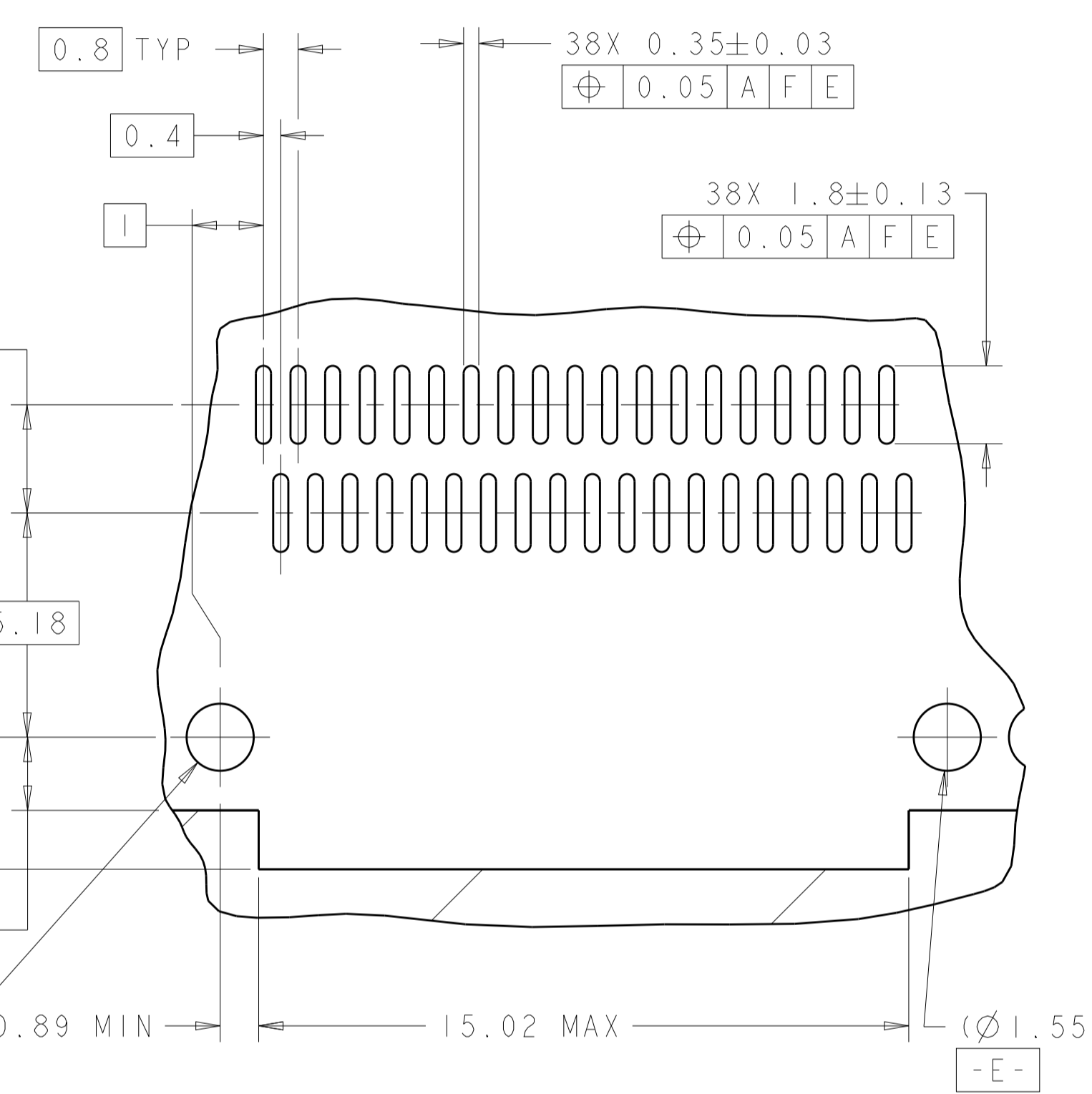
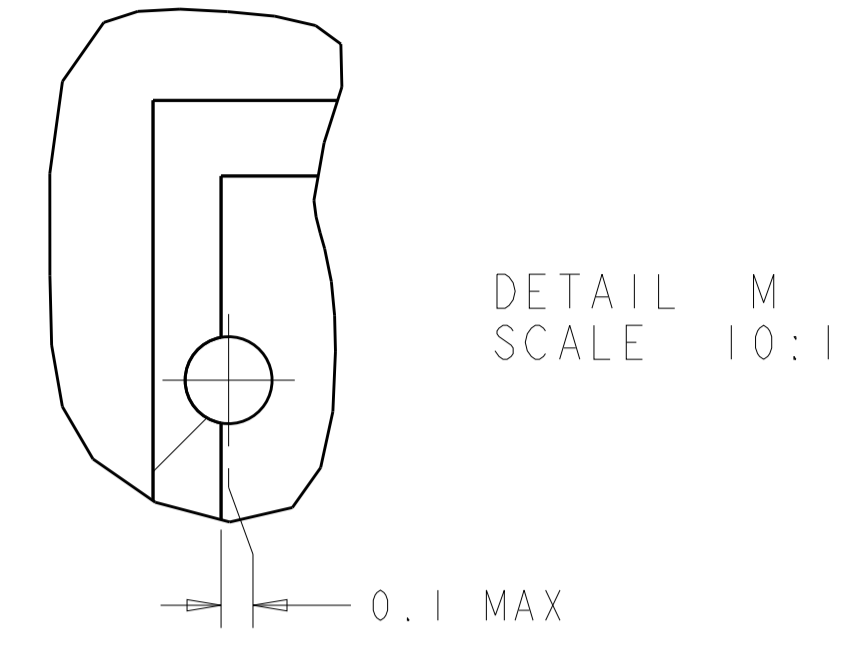
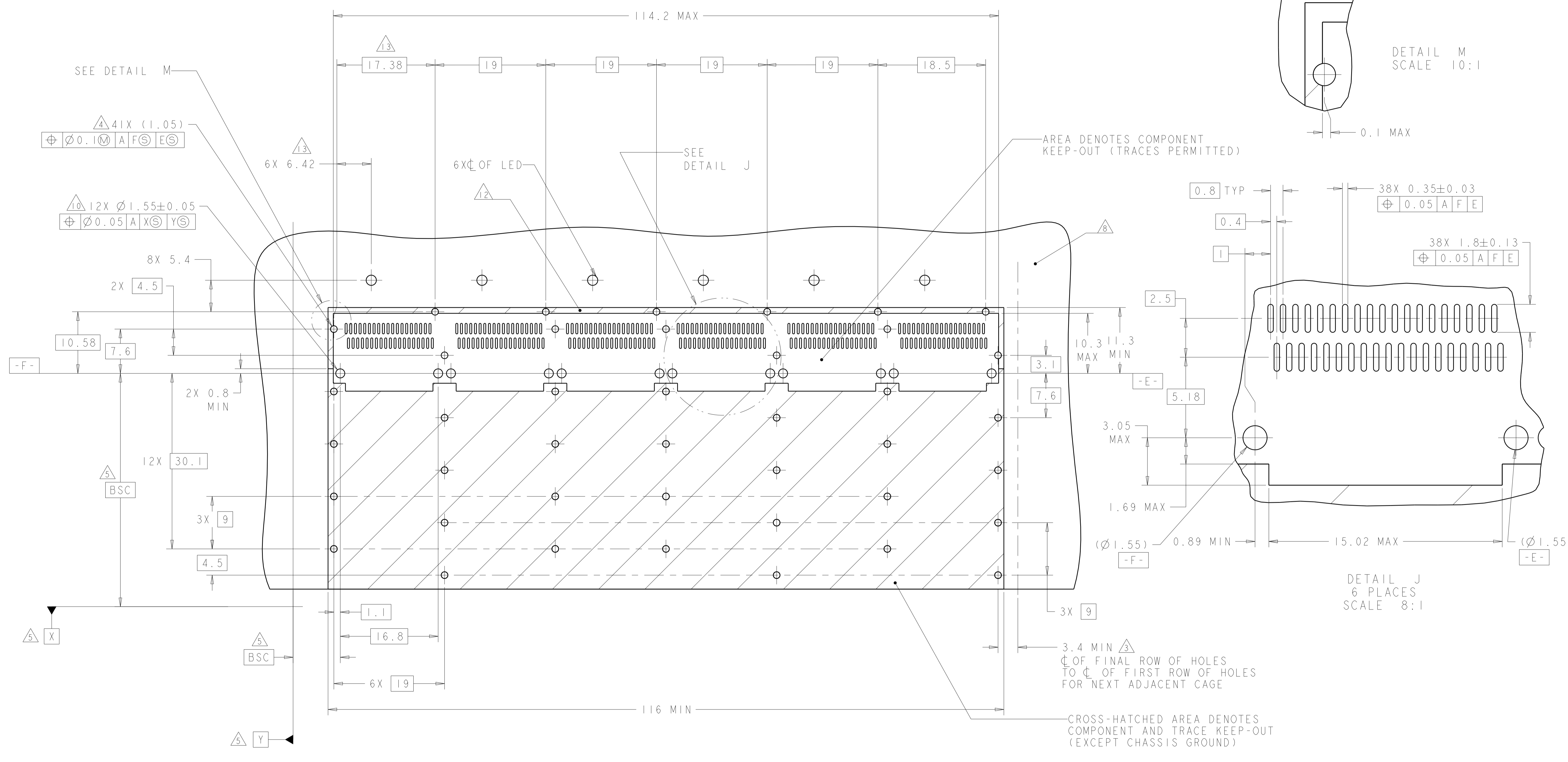

RECOMMENDED PC BOARD LAYOUT
 SINGLE SIDE MOUNT CONFIGURATION
 SCALE 3:1

THIS DRAWING IS A CONTROLLED DOCUMENT.		OWN: BING LIU 22JUL2013	TE Connectivity
DIMENSIONS: mm		CHK: JASON YANG 22JUL2013	
TOLERANCES UNLESS OTHERWISE SPECIFIED:		APVD: AILEY CAI 22JUL2013	NAME: 1X6 CAGE ASSEMBLY, BEHIND BEZEL, W/ SOR LIGHT PIPES AND HEAT SINKS, QSFP
0 PLC ±	1 PLC ±0.1	PRODUCT SPEC: 108-2286	SIZE: A1
2 PLC ±0.1	3 PLC ±	APPLICATION SPEC: 114-13218	CAGE CODE: 2170551
4 PLC ±	ANGLES ±	WEIGHT: -	RESTRICTED TO: -
MATERIAL: -	FINISH: -	Customer Drawing	SCALE: 4:1 SHEET 4 OF 5 REV B

LOC	DIST	REVISIONS					
GP	00	P	LTN	DESCRIPTION	DATE	DWN	APVD
-	-	-	-	SEE SHEET 1	-	-	-

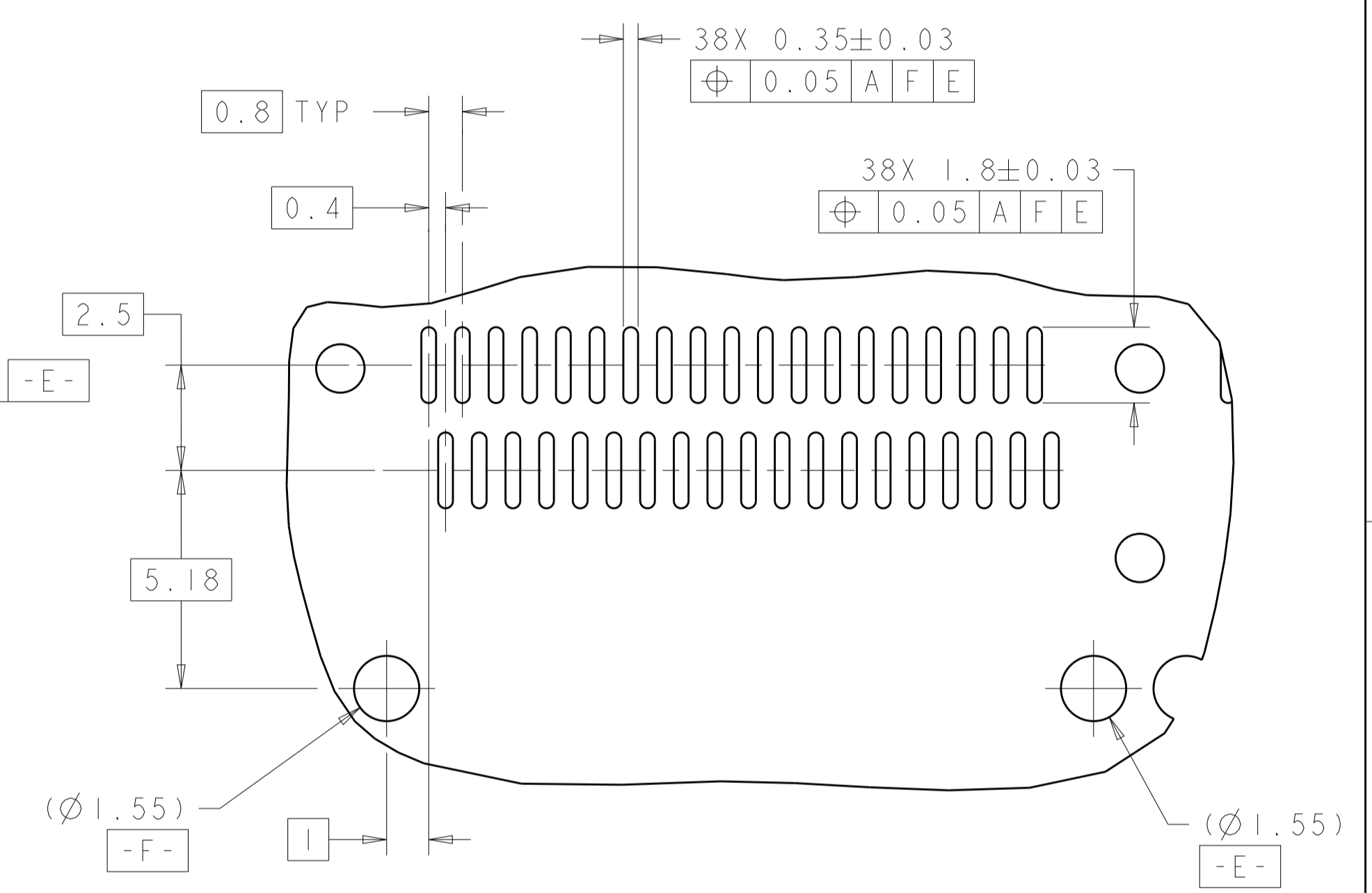
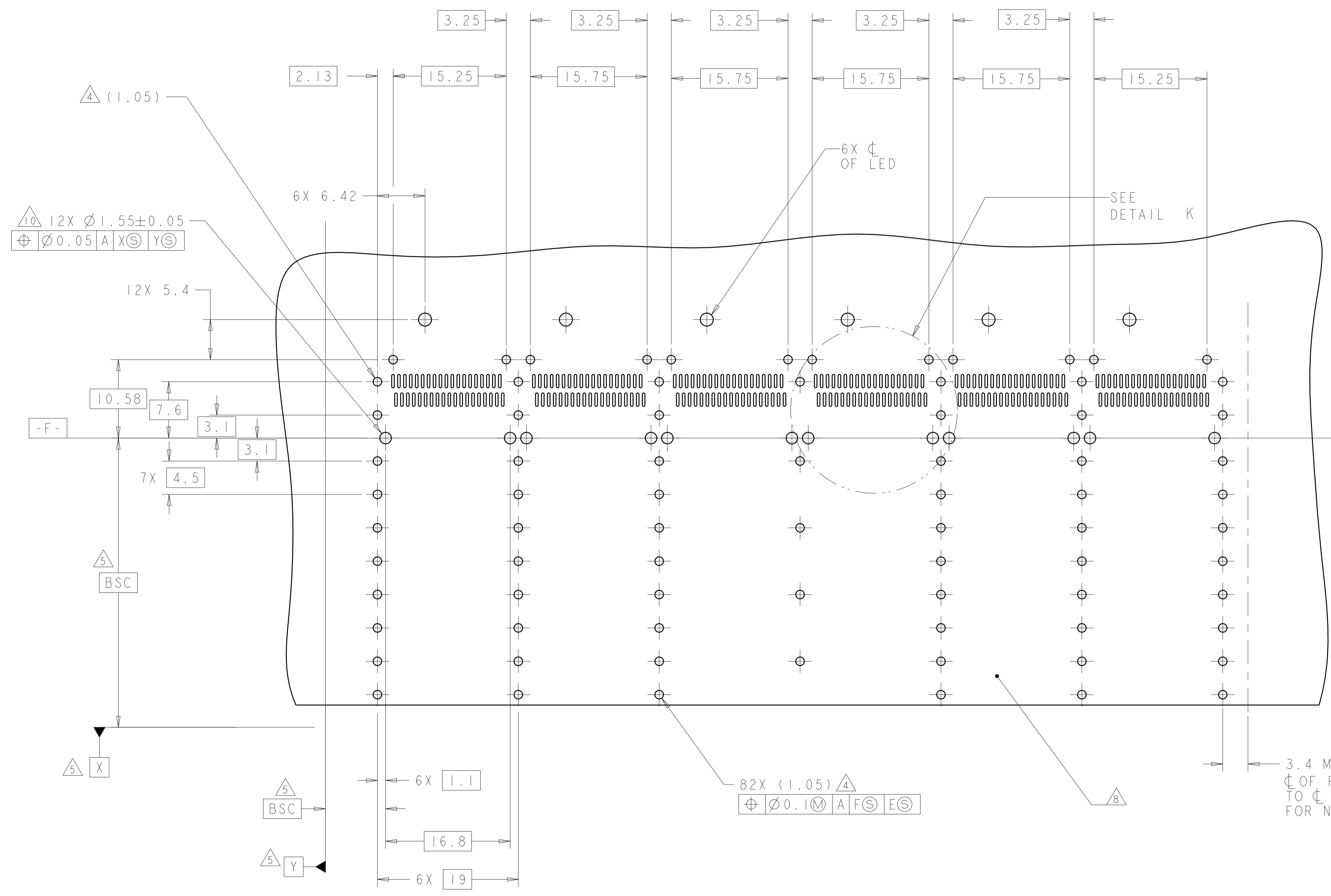

RECOMMENDED PC BOARD LAYOUT
 BELLY TO BELLY CONFIGURATION
 SEE SHEET 4 FOR COMPONENT AND TRACE KEEP-OUTS
 SCALE 3:1

THIS DRAWING IS A CONTROLLED DOCUMENT.		DWN: BING LIU 22JUL2013	TE Connectivity
DIMENSIONS: mm		CHK: JASON YANG 22JUL2013	
TOLERANCES UNLESS OTHERWISE SPECIFIED:		APVD: AILEY CAI 22JUL2013	NAME: 1X6 CAGE ASSEMBLY, BEHIND BEZEL, W/ SOR LIGHT PIPES AND HEAT SINKS, QSFP
0 PLC ±	1 PLC ±0.1	PRODUCT SPEC: 108-2286	SIZE: A1
2 PLC ±0.1	3 PLC ±	APPLICATION SPEC: 114-13218	CAGE CODE: C=2170551
4 PLC ±	ANGLES ±	WEIGHT: -	RESTRICTED TO: -
MATERIAL: -	FINISH: -	Customer Drawing	SCALE: 4:1 SHEET 5 OF 5 REV B