

REVISIONS				
REV	DATE	BY	CHK	APPV
I	11FEB2016	MDB	MDB	
A	01NOV2016	DLD	JLT	
A1	06APR2022	SMR	S1	

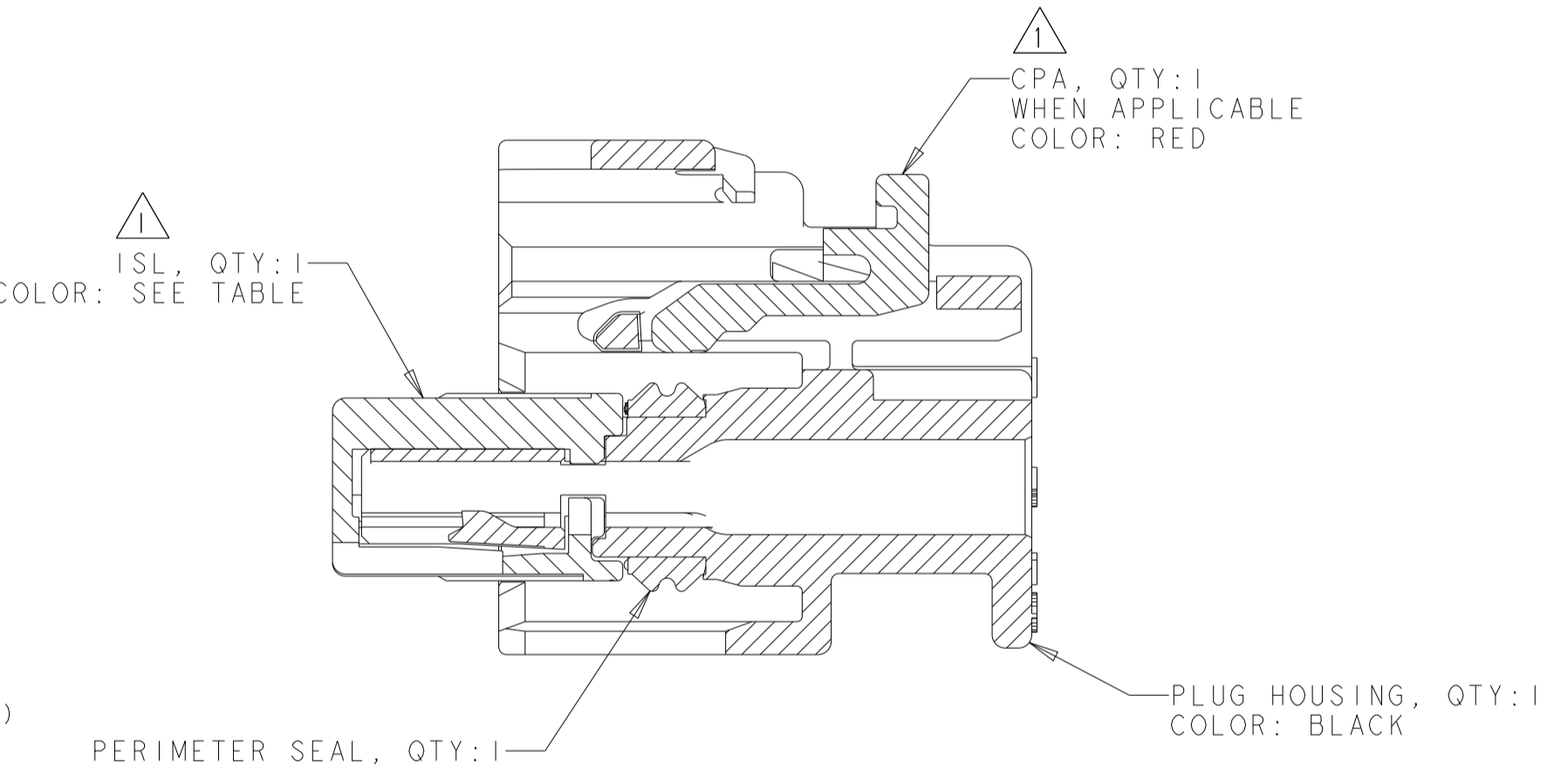

- 1. ISL AND CPA (WHEN APPLICABLE) ARE SHIPPED IN THEIR PRE-LATCHED POSITIONS.
- 2. TERMINALS SOLD SEPARATELY. FOR USE WITH TE MCON 1.2mm CLEAN BODY CONTACT AND WIRE SEAL, SEE TABLE.
- 3. APPLICABLE INTERFACE DRAWINGS: EWCAP 120-S-005-1-Z02 AND 120-S-005-1-Z03
- 4. MINIMUM FEED-THROUGH CONDITION WITH 1.0mm CLEARANCE ALL AROUND.
- 5. TRACEABILITY CODE YY = TWO DIGIT YEAR, JJJ = 3 DIGIT JULIAN DAY, S = 1 DIGIT SHIFT.
- 6. FOR OPTIONAL TERMINAL CAVITY BLOCKING, CONTACT TE SALES REPRESENTATIVE OR CUSTOMER SERVICE.
- 7. SEE INSTRUCTION SHEET 408-32103 FOR CONNECTOR SERVICE AND ISL OPERATION, ISL ACTUATION DISTANCE IS 2.0mm.
- 8. CONTACT PLATING AND APPLICABLE INDIVIDUAL WIRE SEAL ARE APPLICATION DEPENDENT, CONTACT TE SALES REPRESENTATIVE OR CUSTOMER SERVICE FOR DETAILS.
- 9. FOR WIRE CRIMP DETAILS, SEE TE APPLICATION SPECIFICATION 114-18464
- 10. DOCUMENTED I.C.D. IS SPECIFIED TO MEET MOST WIRE SEAL APPLICATIONS. HOWEVER, I.C.D. IS HIGHLY DEPENDENT ON INSULATION TYPE AND O.D. SUFFICIENT GRIP OF THE WIRE SEAL MUST BE OBTAINED SUCH THAT WIRE SEAL DOES NOT DISPLACE FROM INSULATION GRIP DURING CONTACT INSERTION INTO CONNECTOR HOUSING. THE WIRE SEAL SHALL NOT BE CRIMPED TOO TIGHTLY THAT THE WIRE SEAL TEARS DURING THE CRIMPING OPERATION.
- 11. QUALIFIED TO USCAR -2, REV 6 - T4,V4,S3 ENVIRONMENT.
- 12. KEY CODE DIMENSIONS ARE SHOWN WITH ISL IN PRE-LATCHED POSITION. FOR DIMENSION OF KEY WITH ISL IN FINAL POSITION, ADJUST SHOWN DIMENSIONS BY 2.0mm.
- 13. KEY CODE NOT TOOLED.
- 14. PRELIMINARY - NOT RELEASED FOR PRODUCTION.

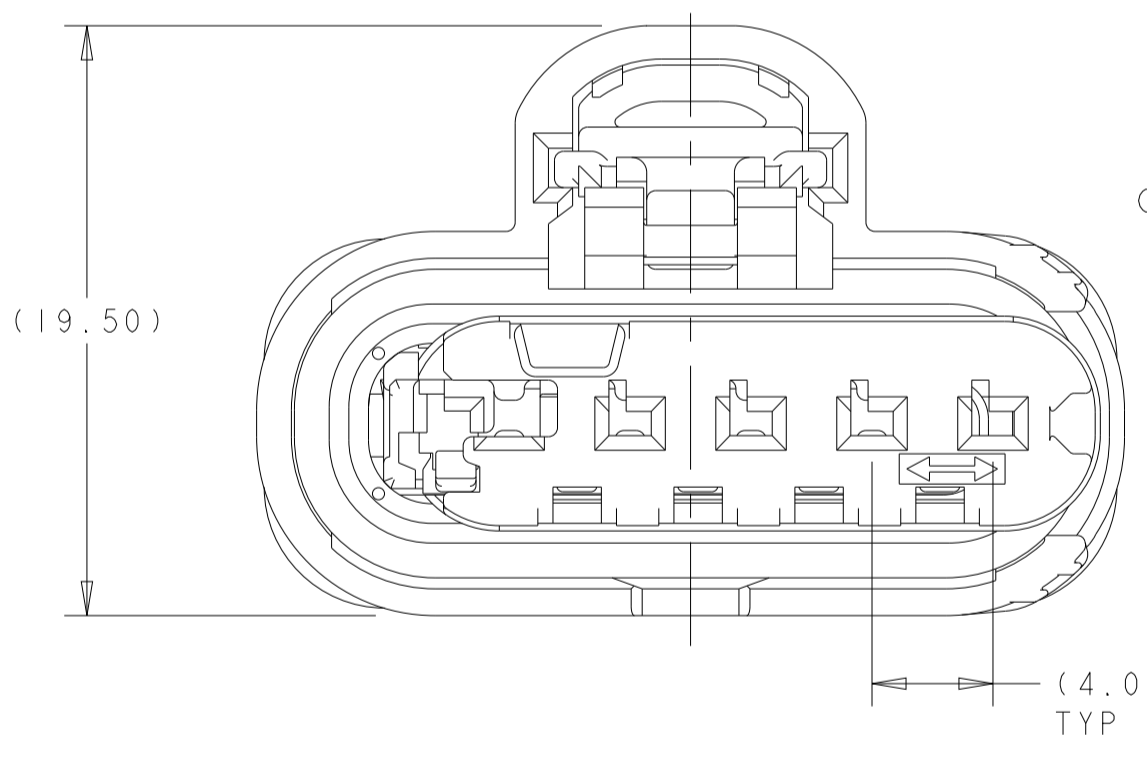
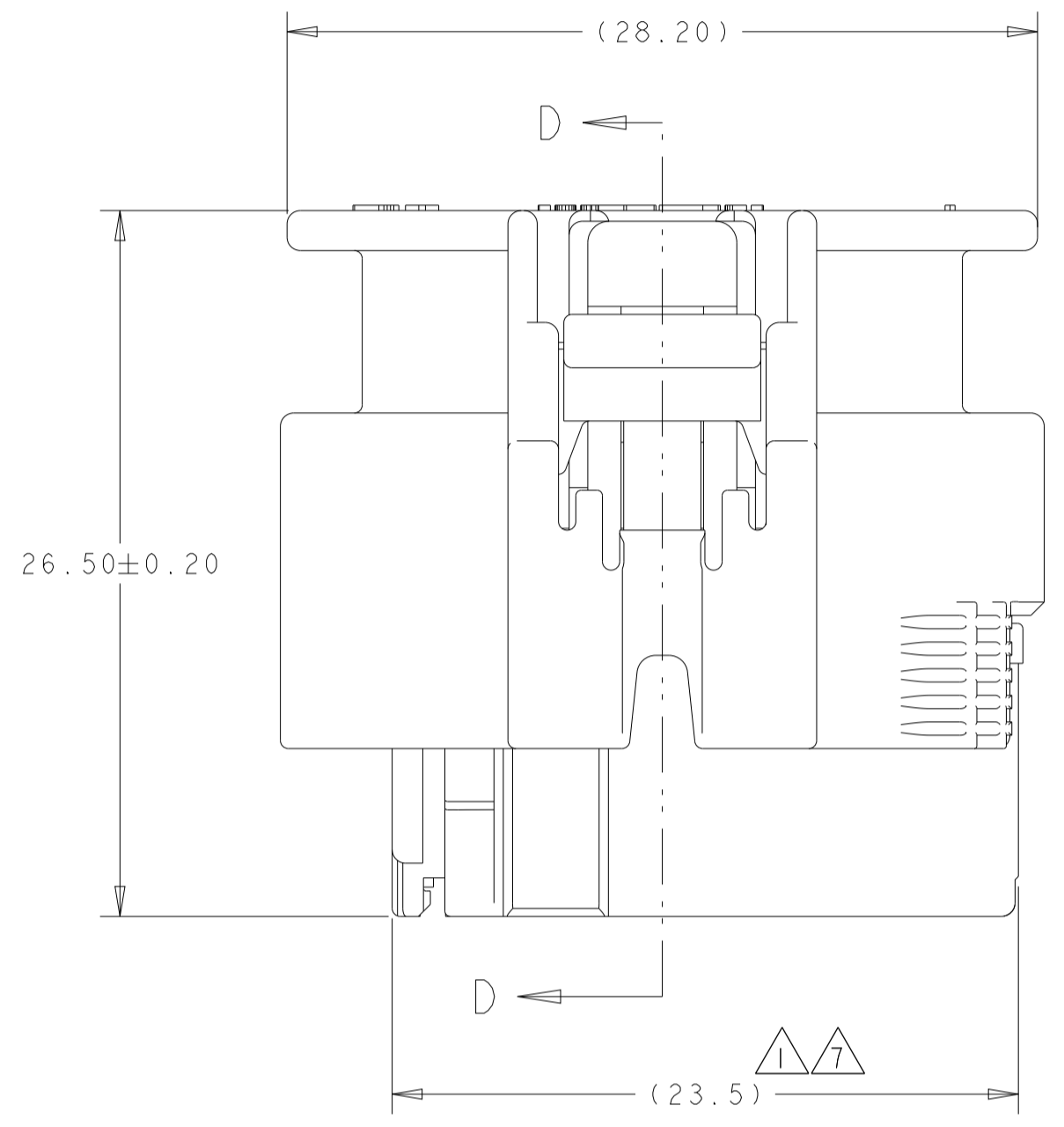
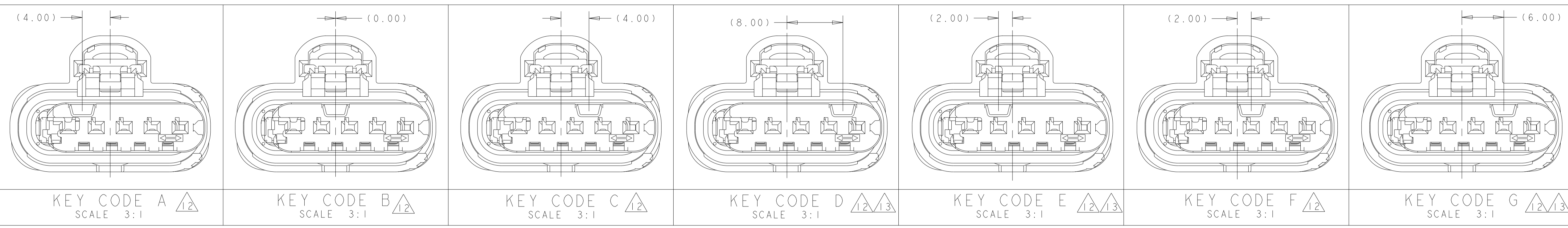
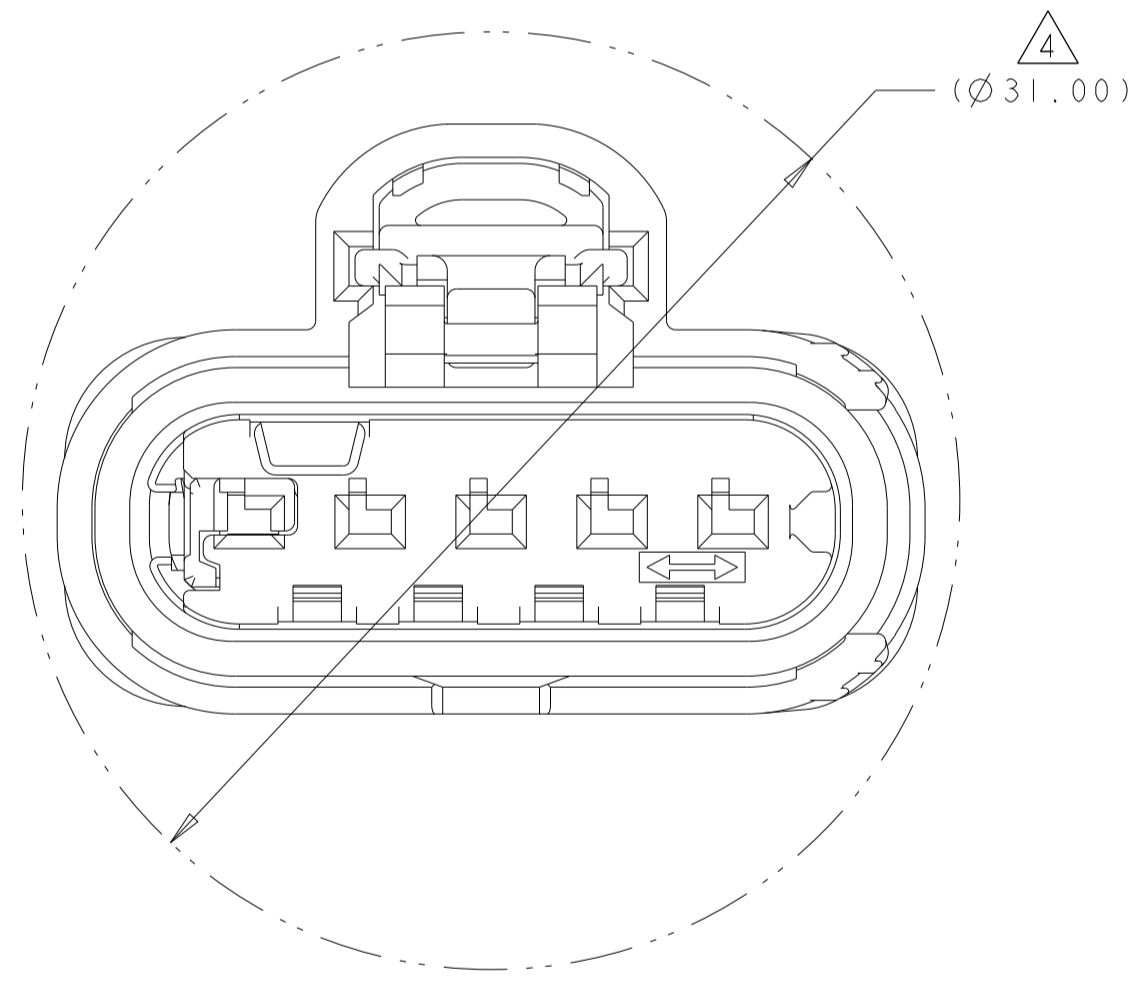

ISL SHOWN IN FINAL (LOCKED) POSITION - REF ONLY
 SCALE 4:1

ISL SHOWN IN PRE-LATCHED (AS-SHIPED) POSITION

SECTION D-D SHOWN WITH CPA IN PRE-LATCHED POSITION
 SCALE 4:1

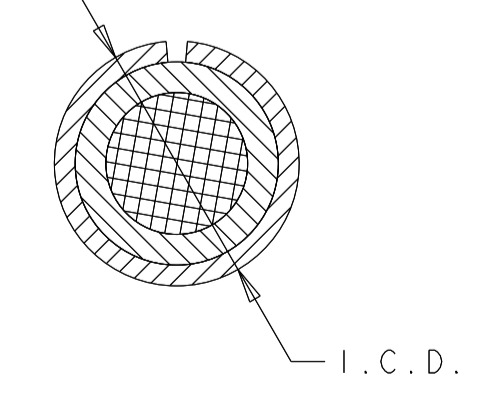
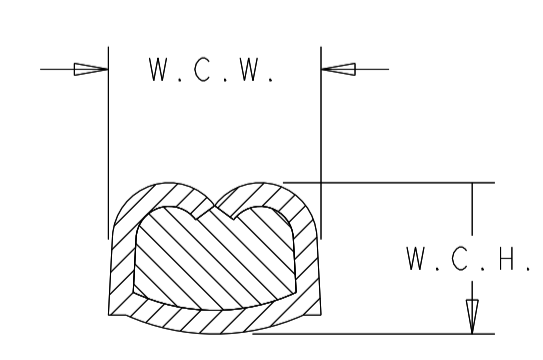

WIRE CRIMP DIMENSIONS

INSULATION CRIMP DIMENSIONS

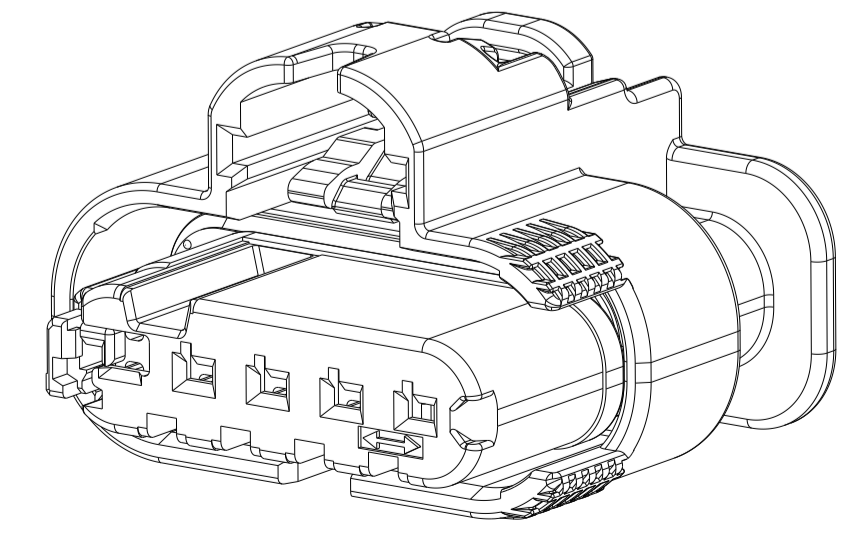

ISOMETRIC VIEW
 SCALE 3:1

TEMP	FEMALE TERMINAL P/N	W.C.H	W.C.W	I.C.D	WIRE SEAL PART NUMBER
150°C	1418844	△9	△9	△10	△8
△8	1670146				
	1418850				

THIS DRAWING IS A CONTROLLED DOCUMENT.

DIMENSIONS:	TOLERANCES UNLESS OTHERWISE SPECIFIED:	OWN: M. HARISH 12MAY2011	CHK: B. BUCHTER 12MAY2011	APV: B. BUCHTER 12MAY2011
mm	0 PLC ±0.3 1 PLC ±0.3 2 PLC ±0.15 3 PLC ±0.15 4 PLC ±0.15 ANGLES FINISH	NAME: PLUG ASSEMBLY, SEALED, 5 POSITION, MCON		
MATERIAL:		SIZE: A1	CAGE CODE: 00779	DRAWING NO: C=2203775
WEIGHT:		SCALE: 4:1	SHEET: 1	OF: 1
CUSTOMER DRAWING:		REV: A1		

TE Connectivity