

REVISIONS				
P.	LTN	DESCRIPTION	DATE	APPR
A		REVISED ECR-18-004662	16JUL2018	JC LSF
B		REVISED ECR-19-011320	29APR2020	JC TK
C		REVISED ECR-20-012182	03MAR2021	JC BK

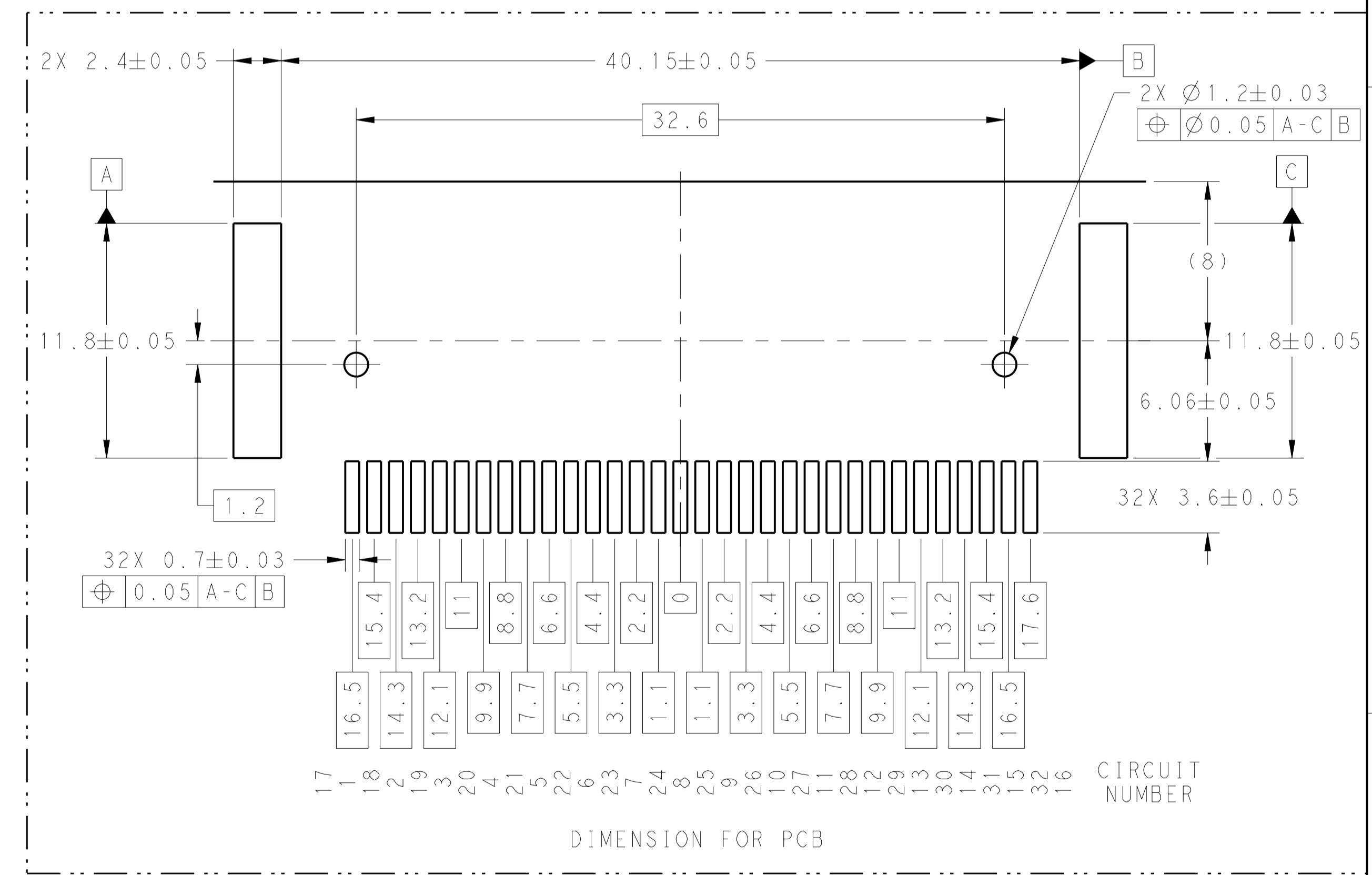

- NOTE:
- 1. COPLANARITY TO INCLUDE SOLDEDTAIL AND SOLDER PEG
  - 2. MATING PLUG PART NUMBER: 1717118-1
  - 3. WHEN MOUNTING, THICKNESS OF SOLDER PASTE: 0.15mm MIN
  - 4. RECOMMENDED AREA FOR CONNECTOR VACUUM PICK UP
  - 5. HANDLING THIS PART SHOULD FOLLOW INSTRUCTION SHEET: 411-51005

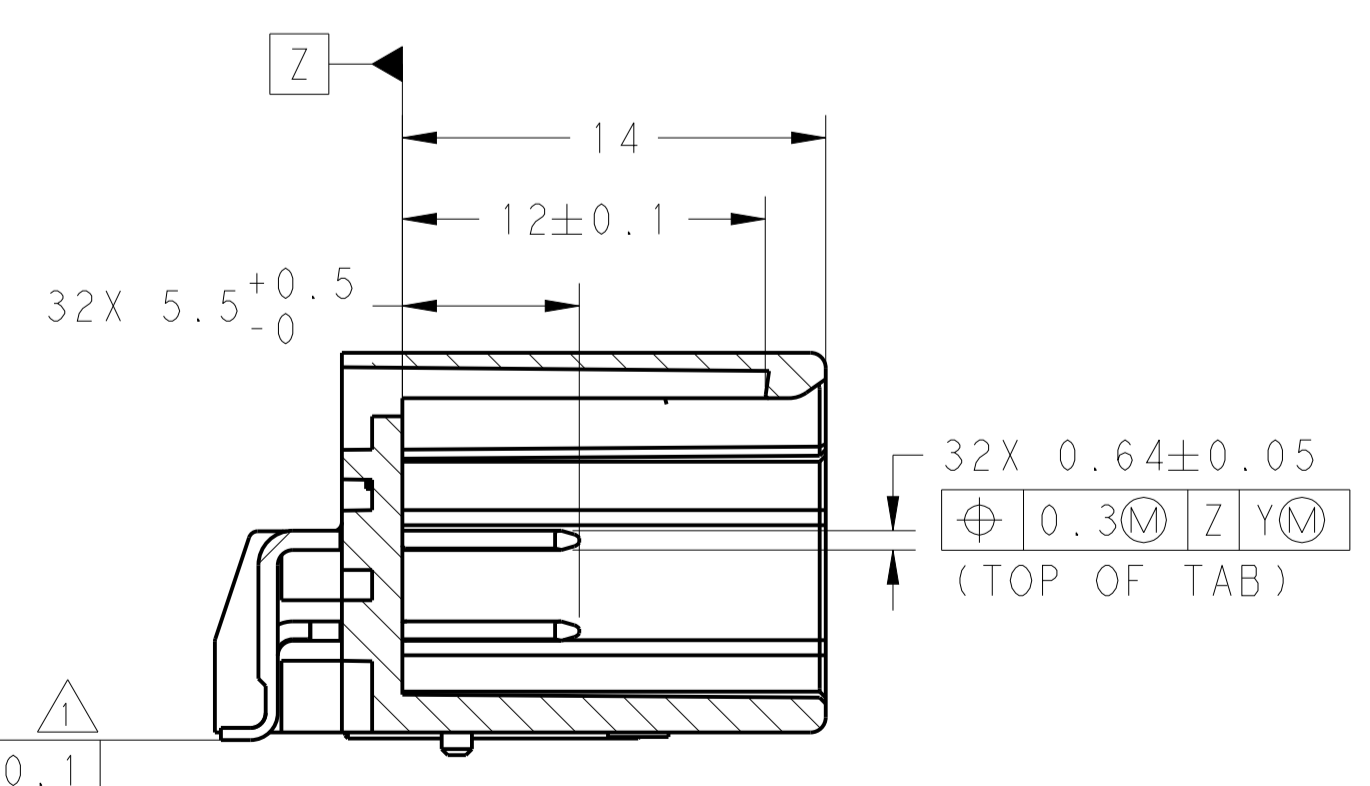
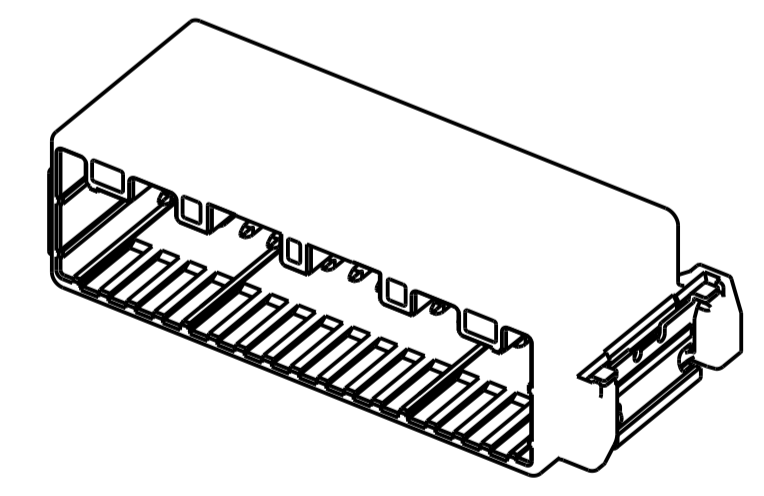
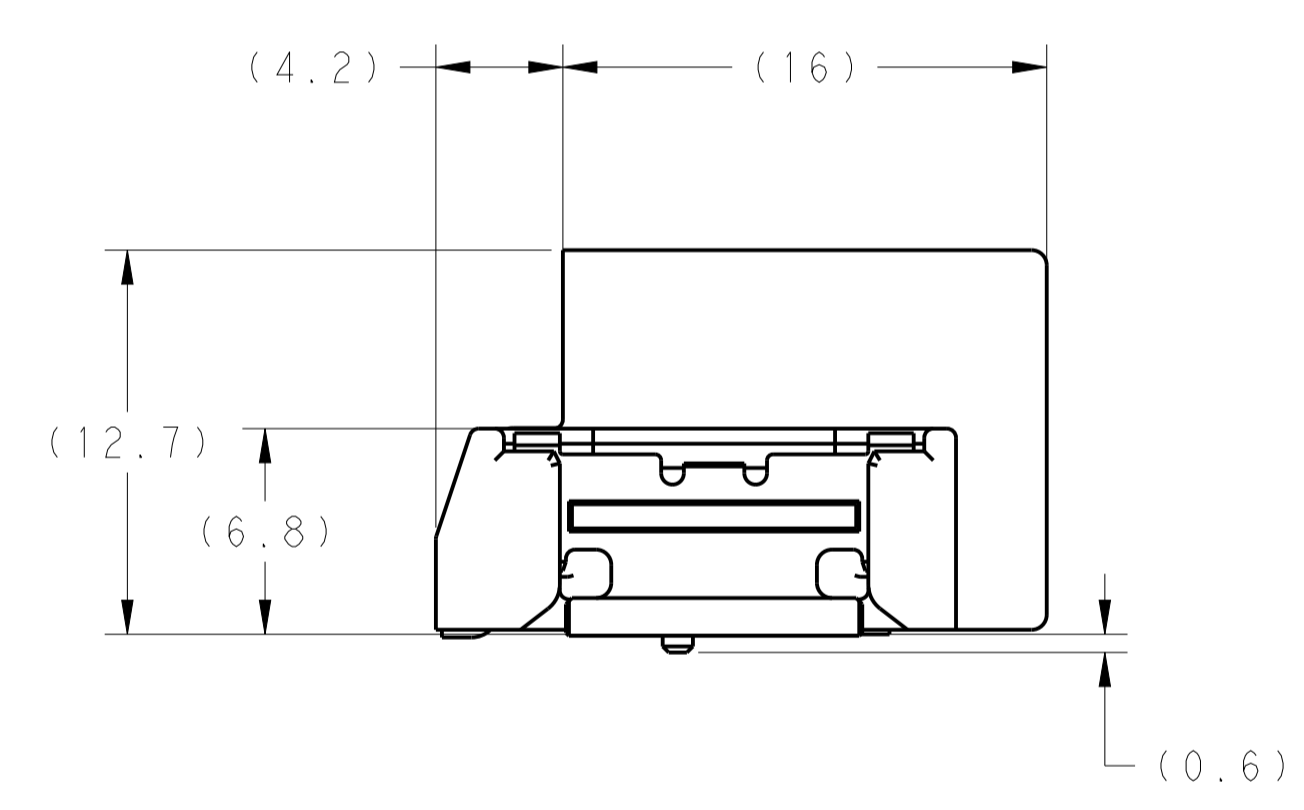
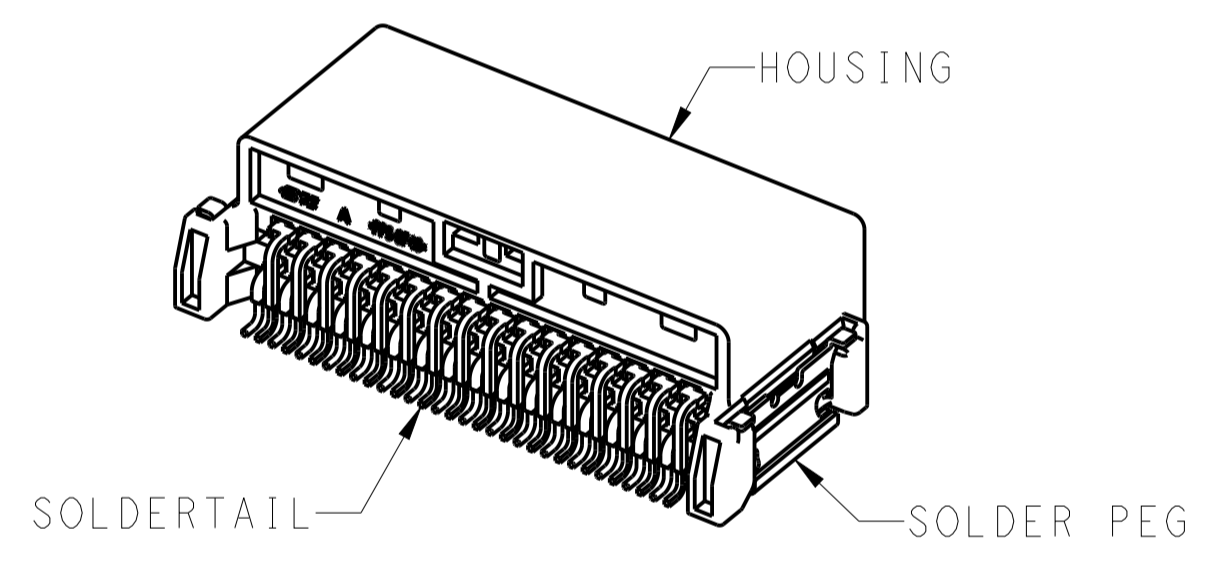
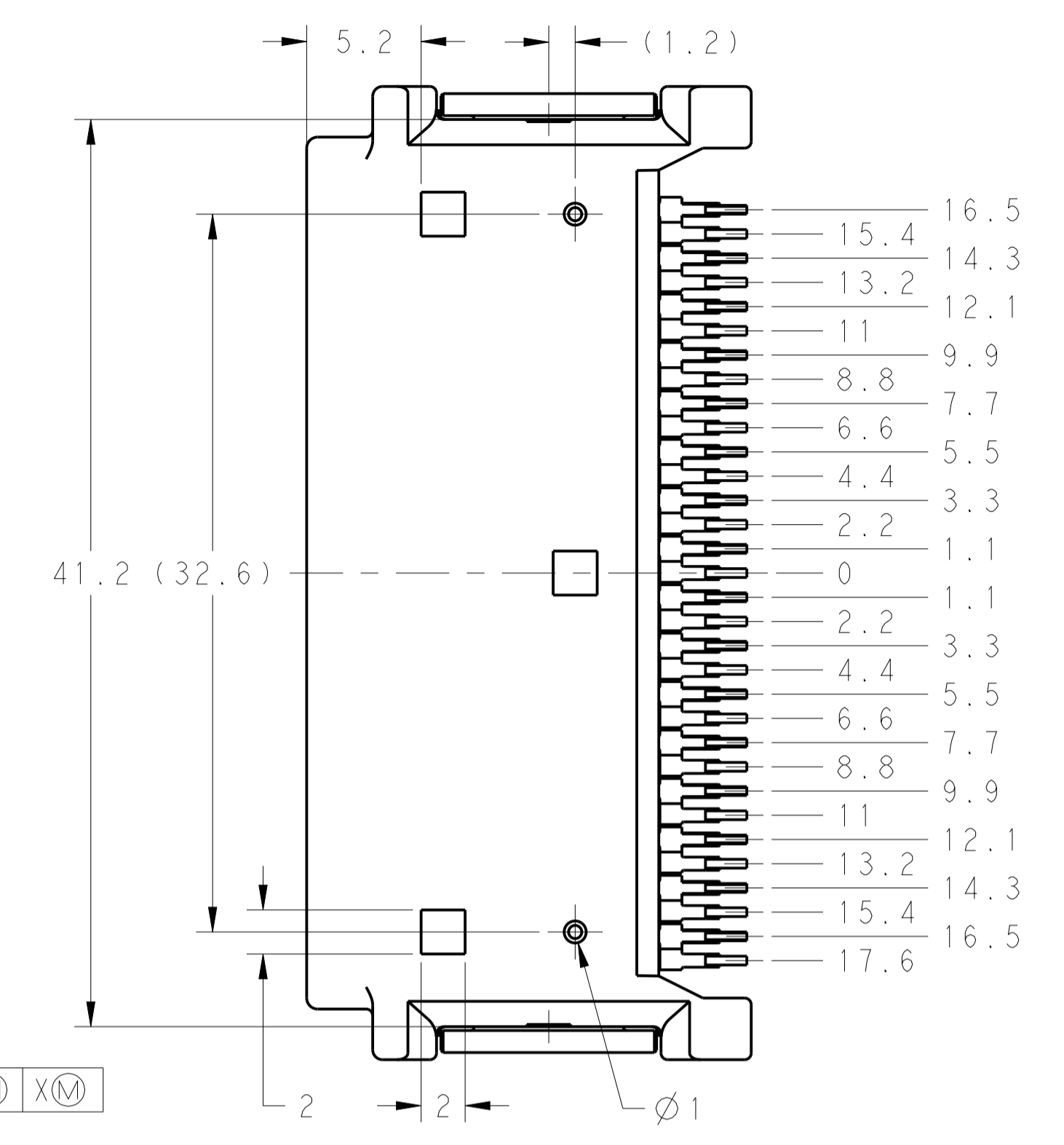
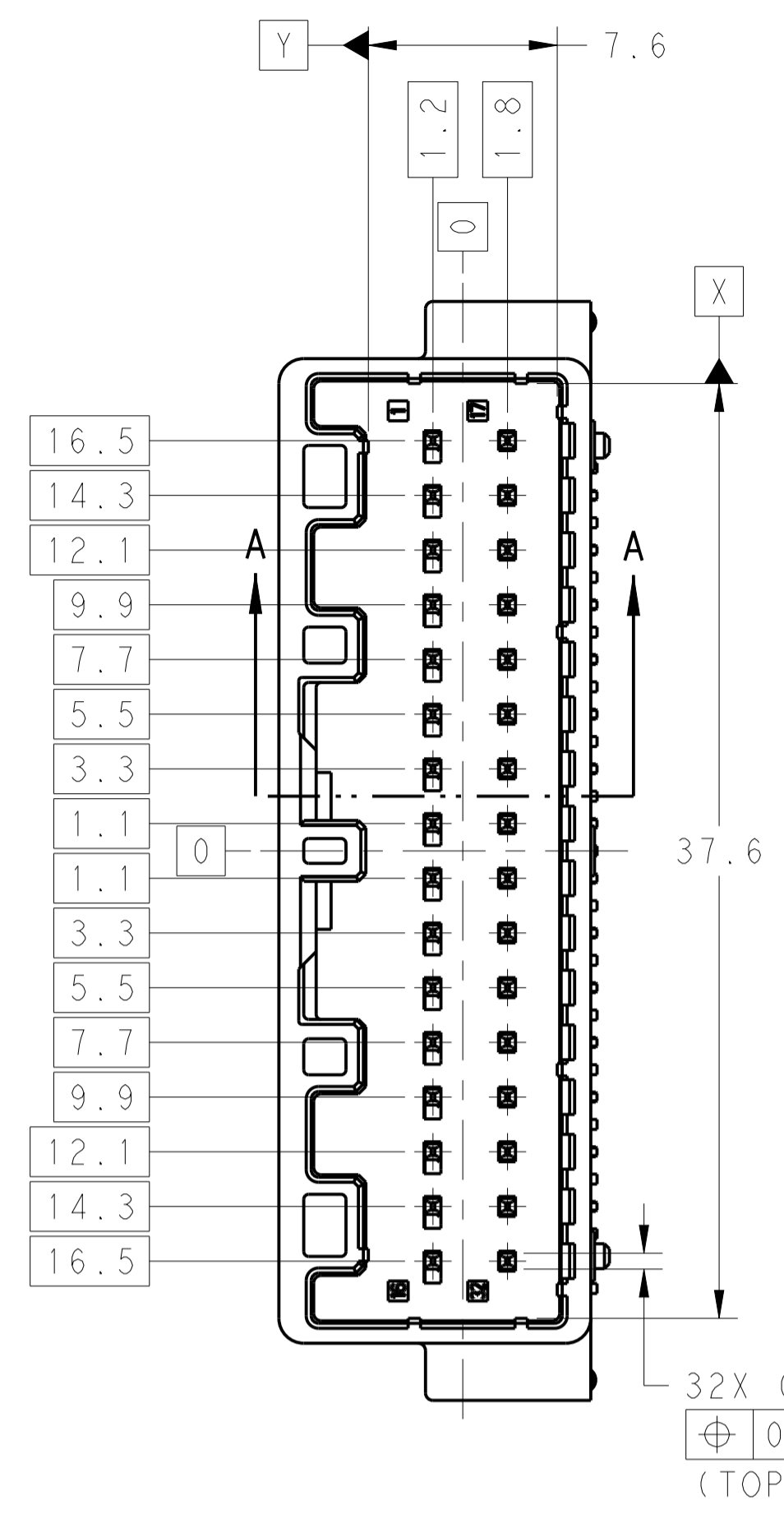
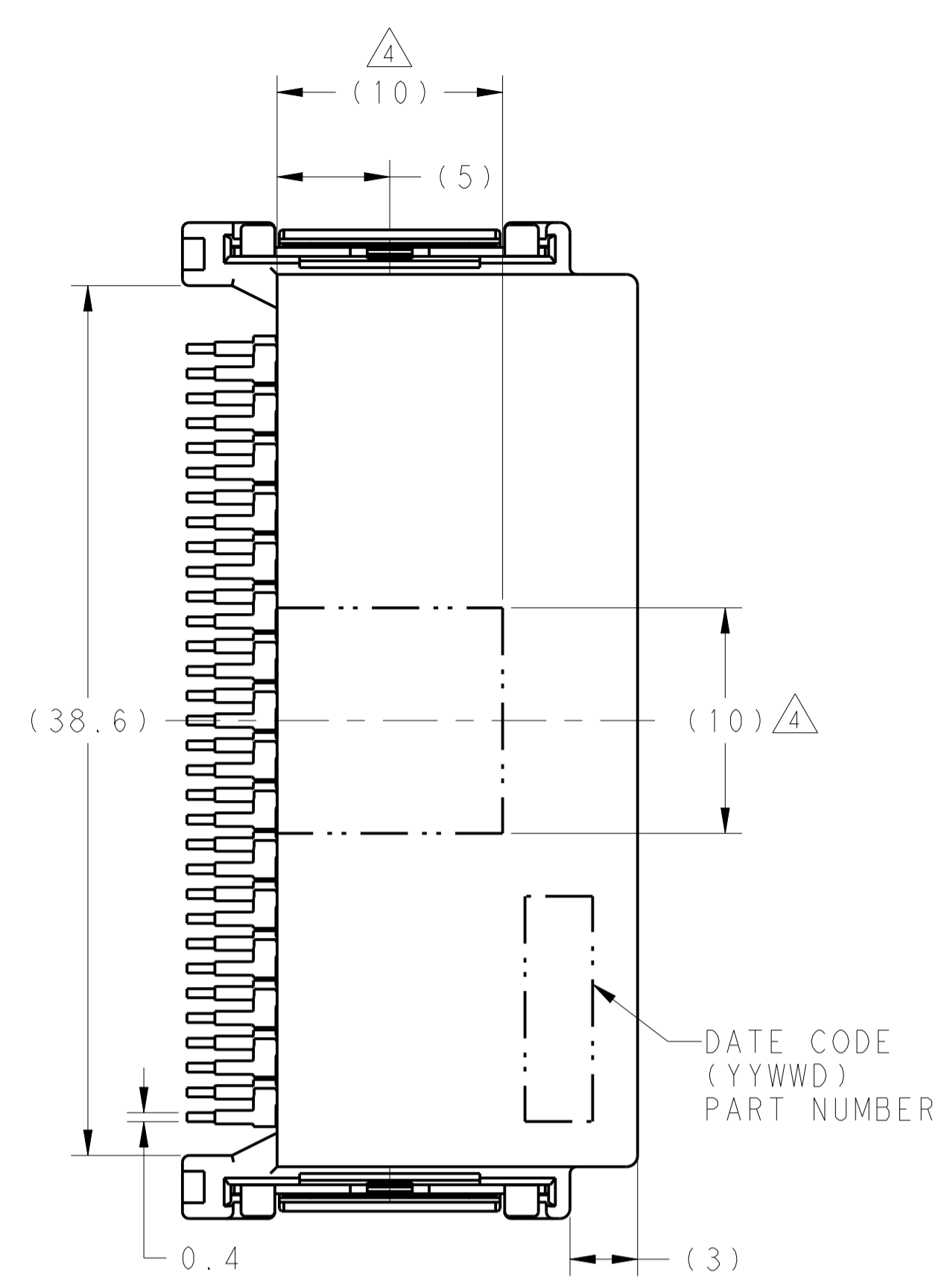
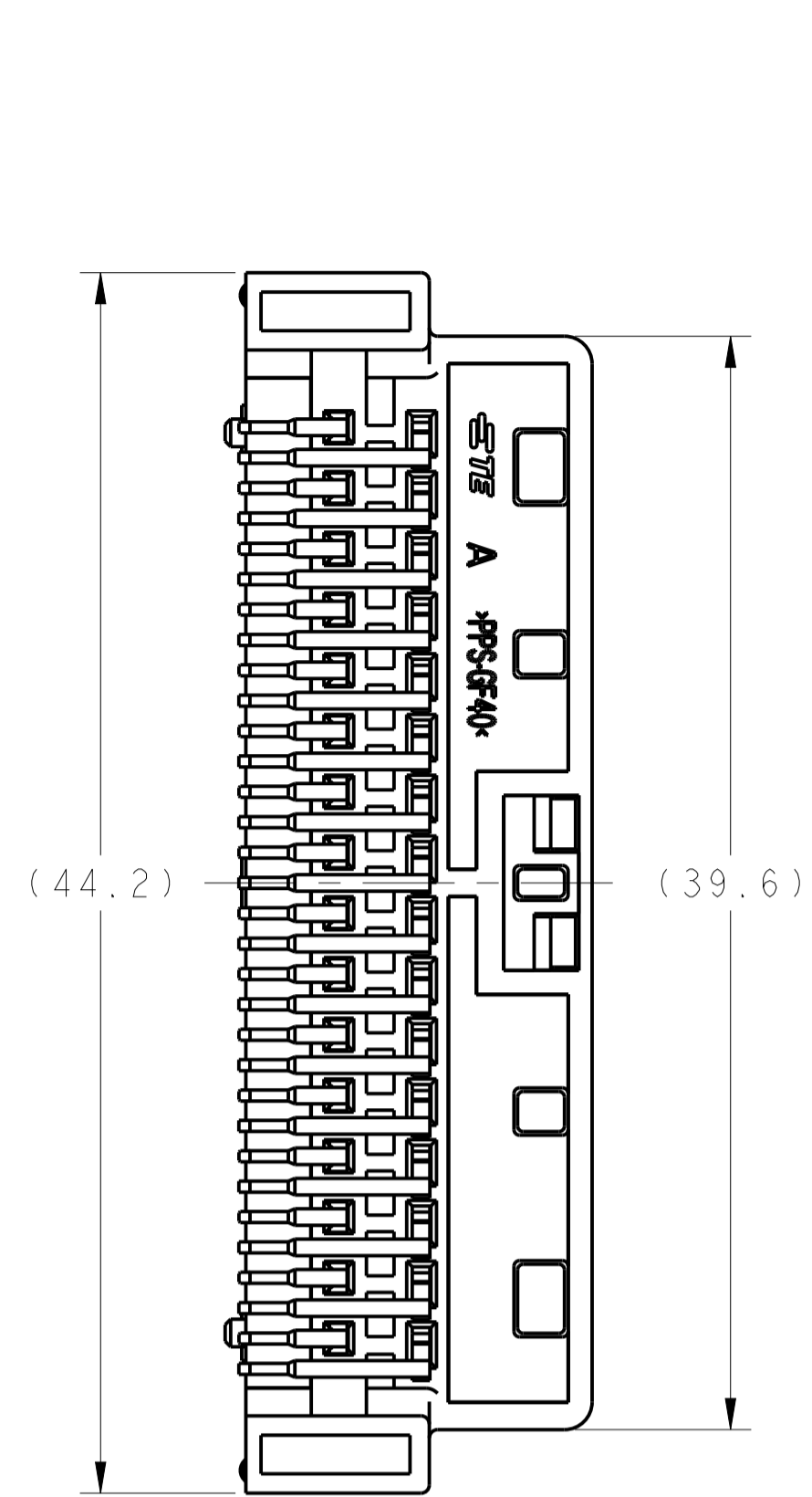
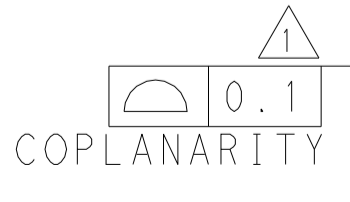

BRASS	POST TIN OVER Ni	BRASS	POST TIN OVER Ni	PPS	NATURAL	2237138-1
MATERIAL	PLATING	MATERIAL	PLATING	MATERIAL	COLOR	
SOLDER PEG		CONTACT		HOUSING		PART NUMBER

THIS DRAWING IS A CONTROLLED DOCUMENT. DWG: JASON CHOW 27JUN2017, CHK: SF LEONG 27JUN2017, APPR: SF LEONG 27JUN2017

TE Connectivity

NAME: 32P 025 CAP ASSEMBLY 90 DEG SMT WITH J-PEG

PRODUCT SPEC: 108-51110

APPLICATION SPEC:

SIZE: CAGE CODE: DRAWING NO: A100779C=2237138

RESTRICTED TO:

WEIGHT: 6.3g

CUSTOMER DRAWING

SCALE: 4:1 SHEET 1 OF 2 REV C

REVISIONS				
P.	LTN.	DESCRIPTION	DATE	APVD.
-	-	SEE SHEET 1	-	-

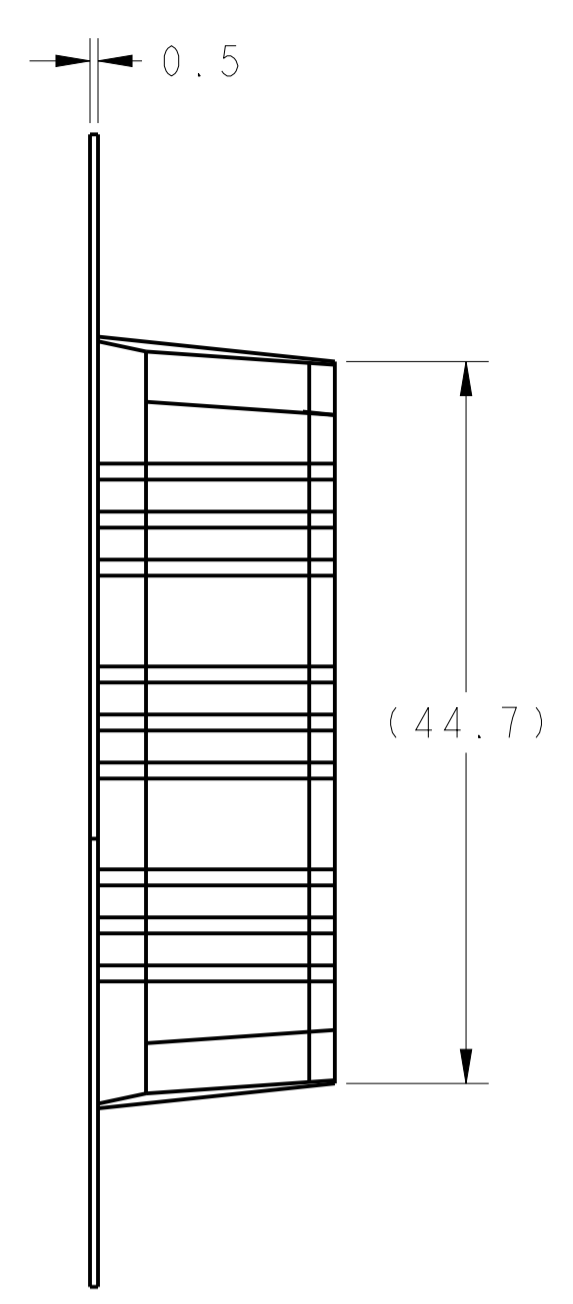
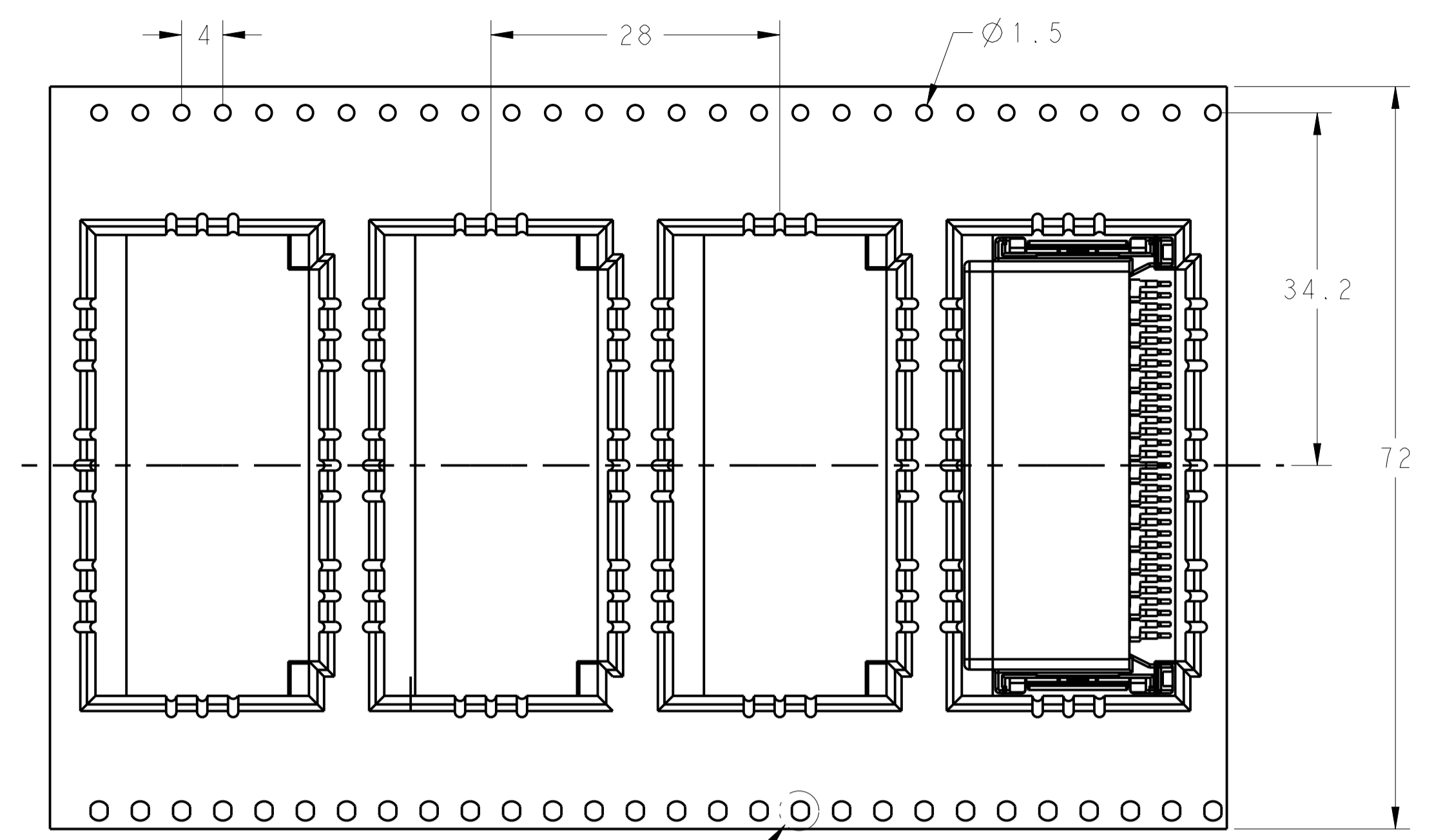

SEE DETAIL A  
CUSTOMER DE-REEL DIRECTION  
→

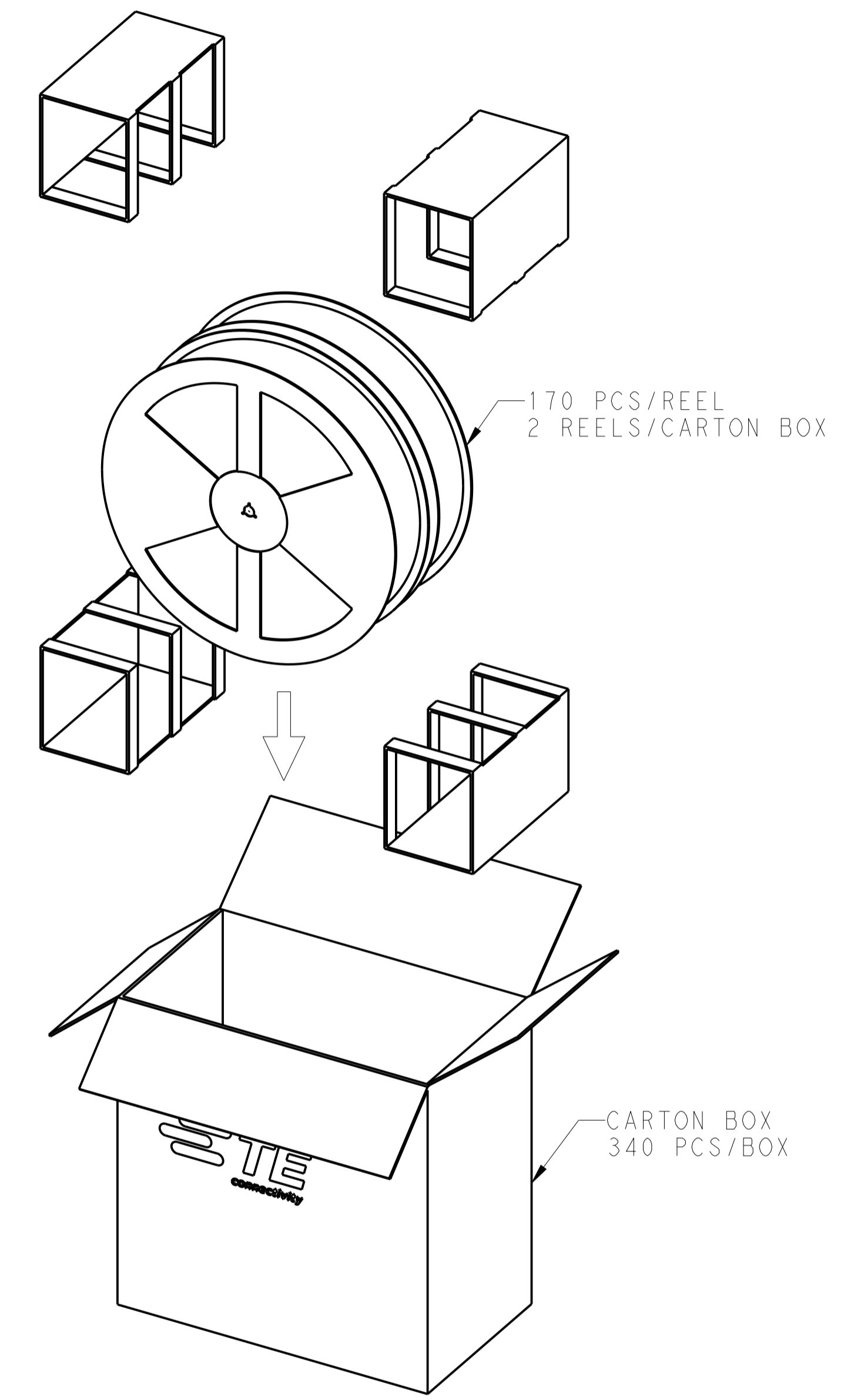
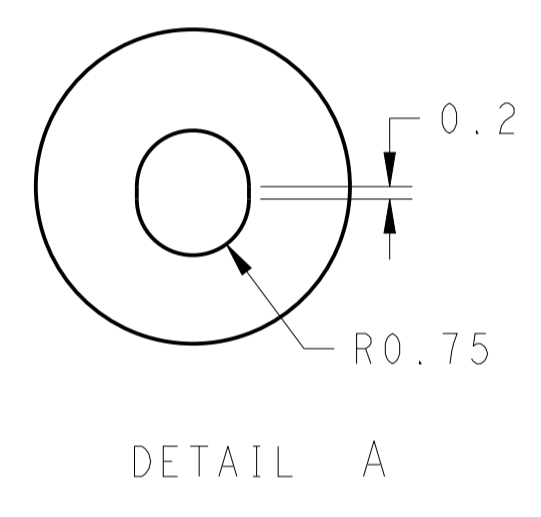
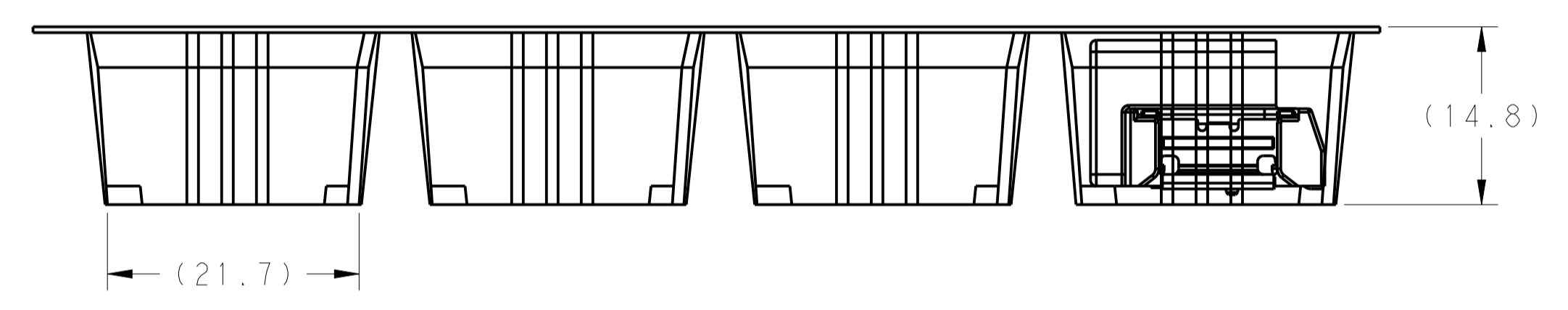

(74.4)  
(81.2)

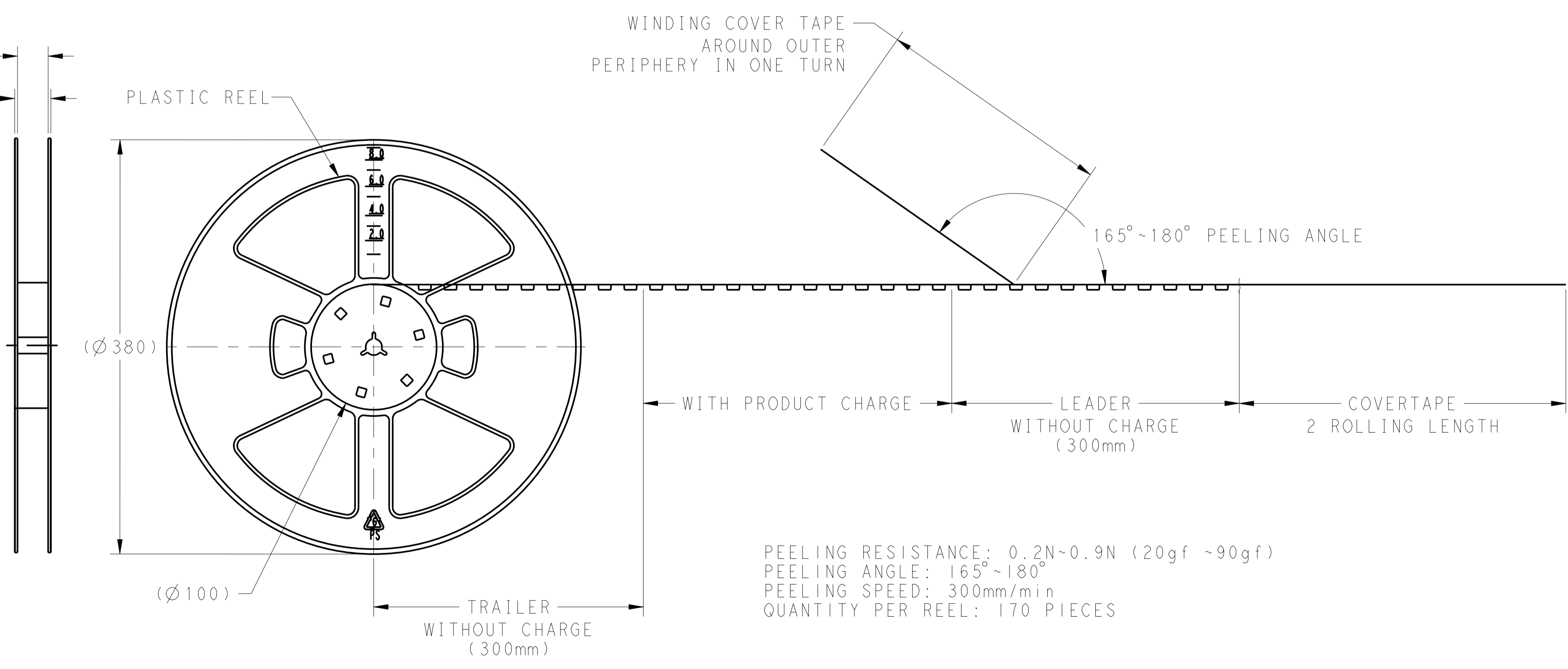

PEELING RESISTANCE: 0.2N~0.9N (20gf ~90gf)  
PEELING ANGLE: 165°~180°  
PEELING SPEED: 300mm/min  
QUANTITY PER REEL: 170 PIECES

THIS DRAWING IS A CONTROLLED DOCUMENT.		OWN: JASON CHOW 27JUN2017	TE Connectivity
DIMENSIONS: mm		CHK: SF LEONG 27JUN2017	
TOLERANCES UNLESS OTHERWISE SPECIFIED:		APVD: SF LEONG 27JUN2017	NAME: 32P 025 CAP ASSEMBLY 90 DEG SMT WITH J-PEG
0 PLC	±0.3	PRODUCT SPEC	SIZE: CAGE CODE DRAWING NO. RESTRICTED TO
1 PLC	±0.3	APPLICATION SPEC	A100779C=2237138
2 PLC	±0.3	WEIGHT	SCALE: NTS SHEET 2 OF 2 REV C
3 PLC	±0.3	CUSTOMER DRAWING	
4 PLC	±0.3		
ANGLES	±0.3°		
FINISH	±0.3		