

P	LTR	DESCRIPTION	DATE	DWN	APVD
	A1	REVISED PER ECR-20-012513	04SEP2020	BDA	KR

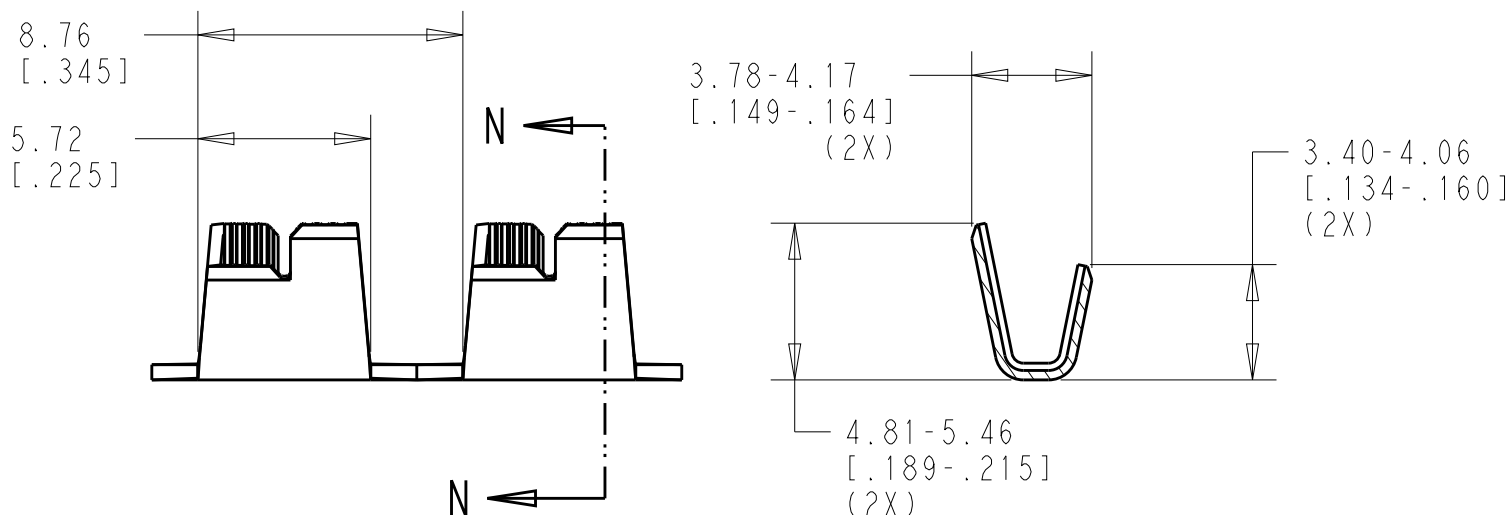

SECTION N-N

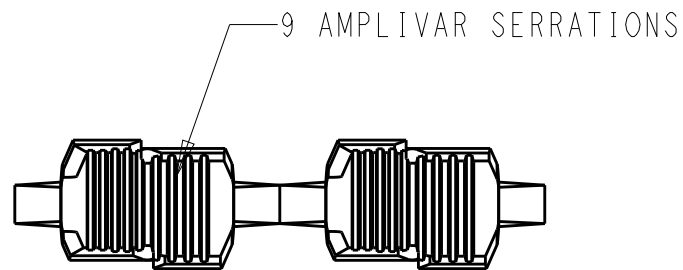
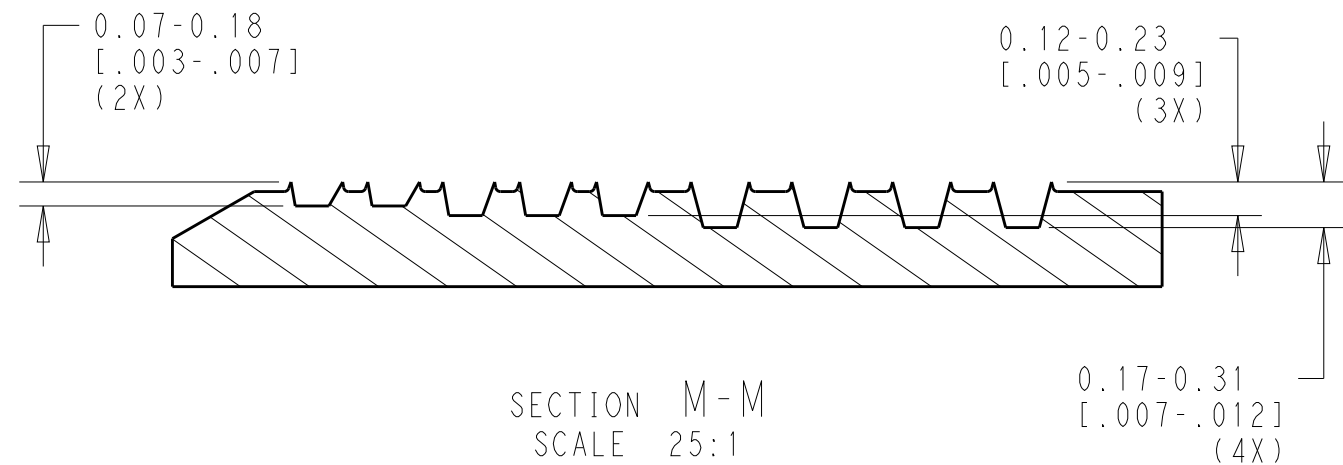

SECTION M-M
SCALE 25:1

1. PRODUCT PROVIDED IN STRIP FORM ON REELS; BREAKS MAY BE PRESENT.
2. DIMENSIONS IN BRACKETS ARE IN INCHES.
3. CRIMP WIDTH ($\pm 0.13\text{mm}$ [± 0.005 IN]): 3.30mm [.130 IN] (2D CRIMP FORM)
CRIMP HEIGHT ($\pm 0.05\text{mm}$ [± 0.002 IN]): (TOTAL CMA + 10,350) / 210,000

GENERAL APPLICATION GUIDELINES MUST BE FOLLOWED AS SPECIFIED IN CATALOG #TBD. FOR APPLICATOR INFORMATION CALL: 1-800-722-1111
FOR PRODUCT INFORMATION CALL: 1-800-522-6752
4. WIRE RANGE: 600 - 7000 CMA PERTAINS TO WIRE COMBINATIONS IN CUSTOMER'S DEVICE. IF CUSTOMER'S WIRE COMBINATION TOTALS 600 - 1699 CMA, THIS WILL REQUIRE THE INCLUSION OF A SHORT PIECE OF 18 AWG STRANDED WIRE INTO THE WIRE BBL VIA USE OF A TE AUTOMATIC WIRE STUFFER DEVICE. THIS BUILDS THE TOTAL CMA BEYOND A MINIMUM OF 1700 CMA REQUIRED FOR ACCURATE CQM (CRIMP QUALITY MONITORING) TO ASSURE PRESENCE OF ALL WIRES IN THE TERMINATIONS. APPLICATIONS WHERE TOTAL CMA FALLS BETWEEN 1700 - 7000 CMA WILL NOT REQUIRE INCLUSION OF THE 18 AWG STUFFER WIRE

2238236-1

PART NUMBER

THIS DRAWING IS A CONTROLLED DOCUMENT.		DWN B. WEAVER 27AUG2019														
DIMENSIONS: mm [IN]		CHK K. RANDOLPH 27AUG2019														
TOLERANCES UNLESS OTHERWISE SPECIFIED:		APVD S. KUMAR 27AUG2019	NAME SPLICE, PIGTAIL, AMPLIVAR, 9 SERRATIONS, 2D 600-7000 CMA													
<table border="0"> <tr> <td>0 PLC</td> <td>±-</td> </tr> <tr> <td>1 PLC</td> <td>±-</td> </tr> <tr> <td>2 PLC</td> <td>±0.38 [.015]</td> </tr> <tr> <td>3 PLC</td> <td>±-</td> </tr> <tr> <td>4 PLC</td> <td>±-</td> </tr> <tr> <td>ANGLES</td> <td>±1°</td> </tr> </table>		0 PLC	±-	1 PLC	±-	2 PLC	±0.38 [.015]	3 PLC	±-	4 PLC	±-	ANGLES	±1°	PRODUCT SPEC 108-143147	RESTRICTED TO	
0 PLC	±-															
1 PLC	±-															
2 PLC	±0.38 [.015]															
3 PLC	±-															
4 PLC	±-															
ANGLES	±1°															
MATERIAL 0.51±0.03 [.020±.001]BRASS		APPLICATION SPEC 114-143147	SIZE A3	CAGE CODE 00779	DRAWING NO C=2238236											
FINISH TIN PLATE		WEIGHT -	SCALE 4:1													
		CUSTOMER DRAWING	SHEET 1 OF 1													
			REV A1													