

REVISIONS				
P.	LTN	DESCRIPTION	DATE	APVD
A		ECR-18-009150	12JUN2018	GZ E.J

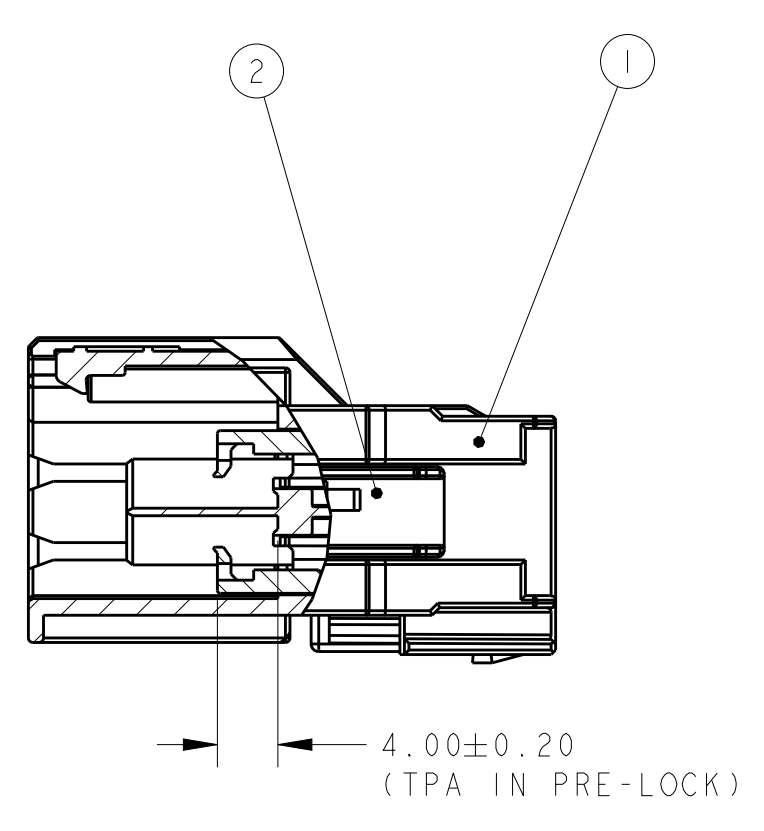

SECTION A-A

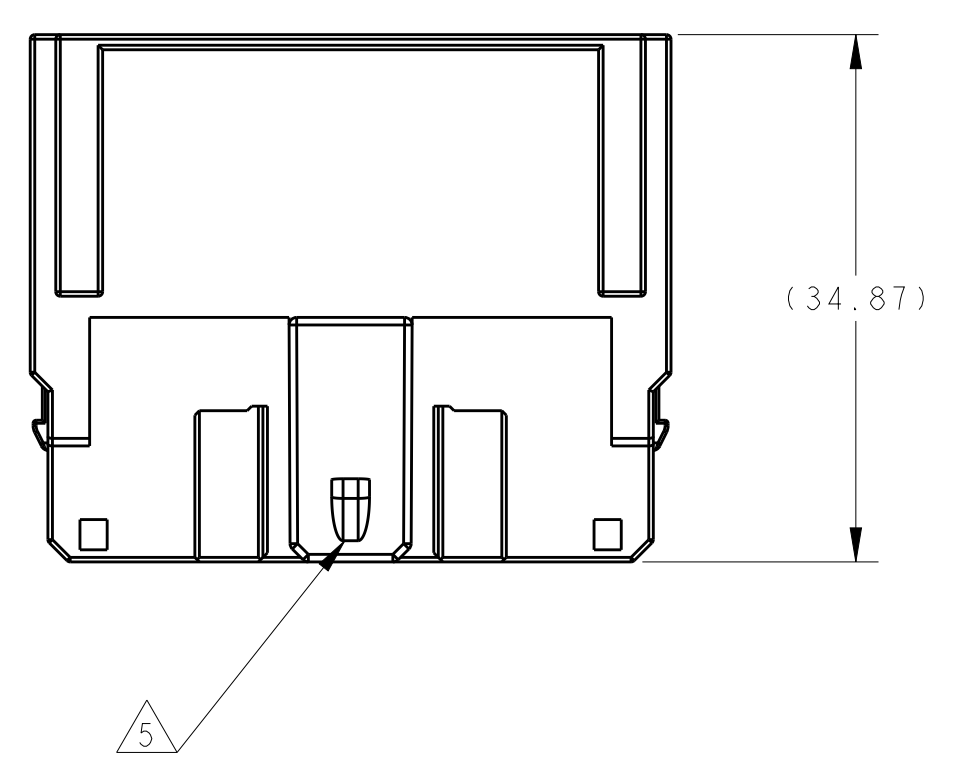
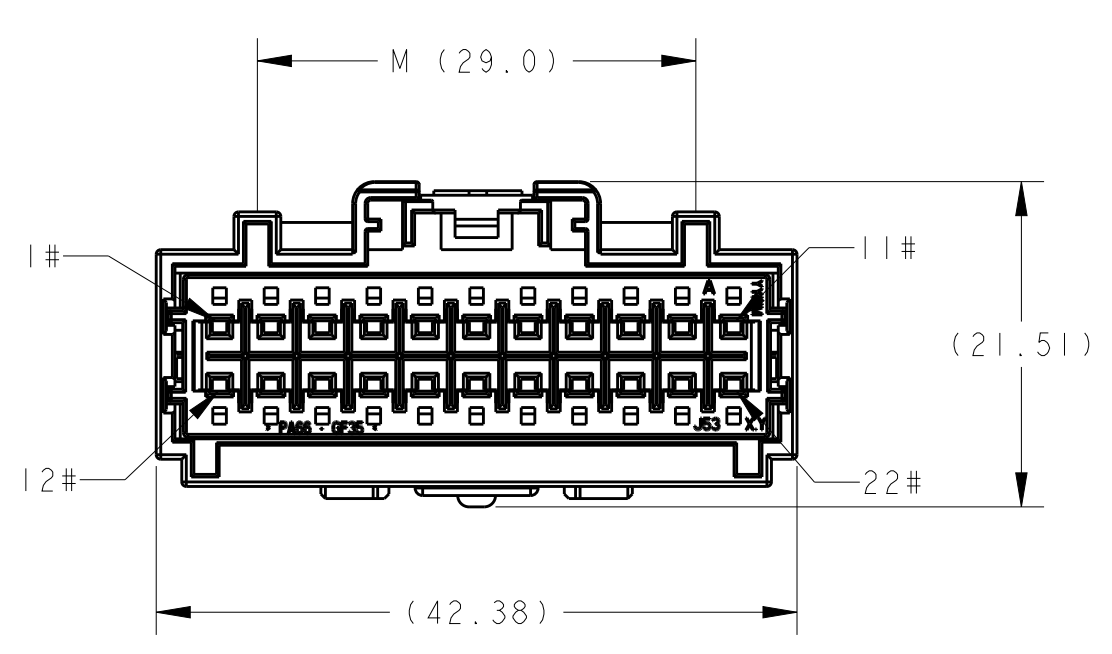
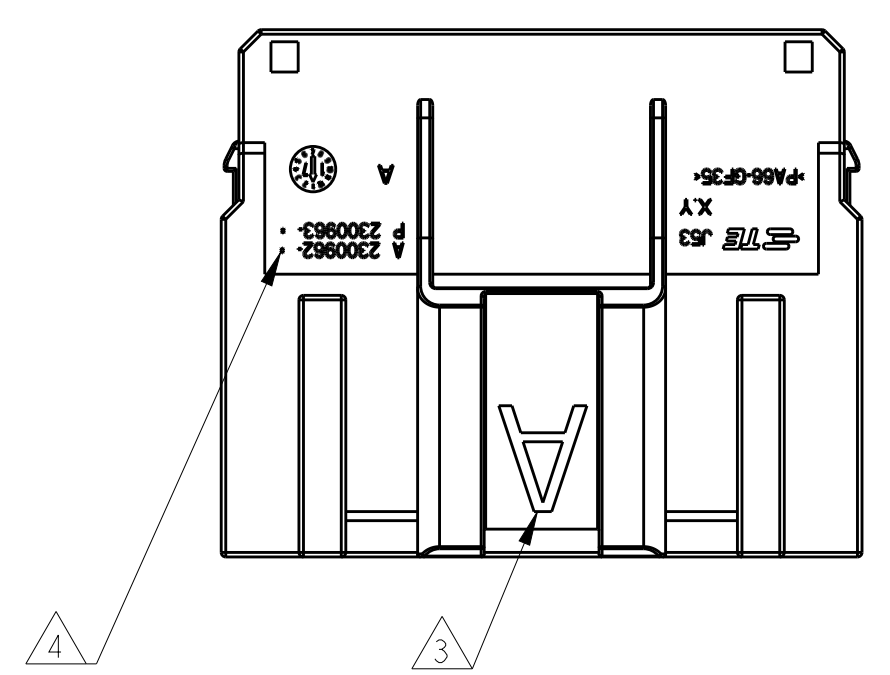
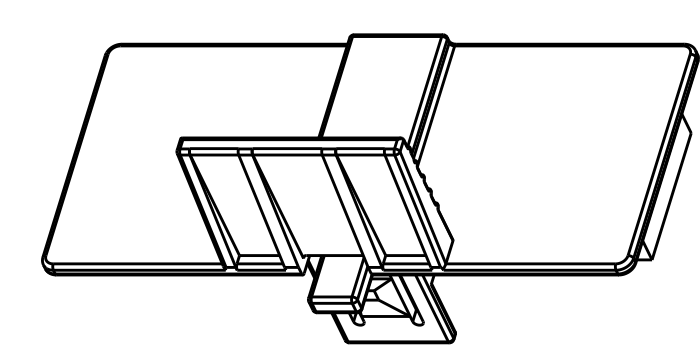

OPTIONAL COVER (NOT TOOLED)

1. BULK PACKAGING
2. TPA DELIVERY CONDITION: IN PRE LOCK POSITION
3. CODE INDICATED PRINT (OPTIONAL) AS SHOWN
4. ASSY PART NUMBER SHOWN WITH PREFIX "A"
5. CLIP FEATURE TO BE MATED WITH BRACKET 2301203 OR CLIP FROM MDP 3639/3640
6. TERMINAL RECOMMENDED AS TABLE SHOWN (1924275 FOR FORD ONLY)
7. SUITABLE TE PLUG: 2300979
7. DESIGN ACCORDING TO IEC 60664-1 2007-04, MAX ALTITUDE 5200M OVER SEA LEVEL
8. FOR HI VOLTAGE APPLICATION, PLEASE CHECK WITH TE ENGINEER
9. CONNECTOR VALIDATION PER USCAR-37 TI,VI,SI,MI
10. FINGER PROTECTION ACCORDING TO IEC60529 IPXXB
11. FOR ROUND WIRE APPLICAITON PLEASE REFER 114-13183
FOR FFC WIRE APPLICAITON PLEASE REFER 114-101069

TE PART NO	WIRE SIZE (mm2) (REF)	FINISH
1924968-2	0.75	PRE-TIN
1924968-1	0.35-0.50	
1924968-6	0.22-0.35	
1924968-5	0.13	
GENY TERMINAL (APPLICATION 114-13183/101069)		

STATUS	TE ASSY NO	CODE	DIMENSION M	DESCRIPTION	MATERIAL	COLOR	QTY	ITEM
NOT TOOLED	2300962-4	D	21.8	TPA HOUSING	PA66-GF35	GRAY	1	2
NOT TOOLED	2300962-3	C	24.2	TPA HOUSING	PA66-GF35	BLACK	1	2
	2300962-2	B	26.6	TPA HOUSING	PA66-GF35	WHITE	1	2
	2300962-1	A	29.0	TPA HOUSING	PA66-GF35	RED	1	2
					PA66-GF35	ORANGE	1	1

THIS DRAWING IS A CONTROLLED DOCUMENT. DWN: G. ZHU 11MAR2016
 CHK: G. ZHU 11MAR2016
 APVD: S. WANG 11MAR2016

STE TE Connectivity

NAME: 22POS CAP ASSY, GENY, UNSEALED
 PRODUCT SPEC: -
 APPLICATION SPEC: 108-101626
 114-101081

SIZE: A1 CAGE CODE: - DRAWING NO: C=2300962
 WEIGHT: -
 CUSTOMER DRAWING

SCALE: 2:1 SHEET 1 OF 1 REV A