

REVISIONS				
P	LTN	DESCRIPTION	DATE	APP'D
1		PRELIMINARY DRAWING	13NOV2019	LL DZ

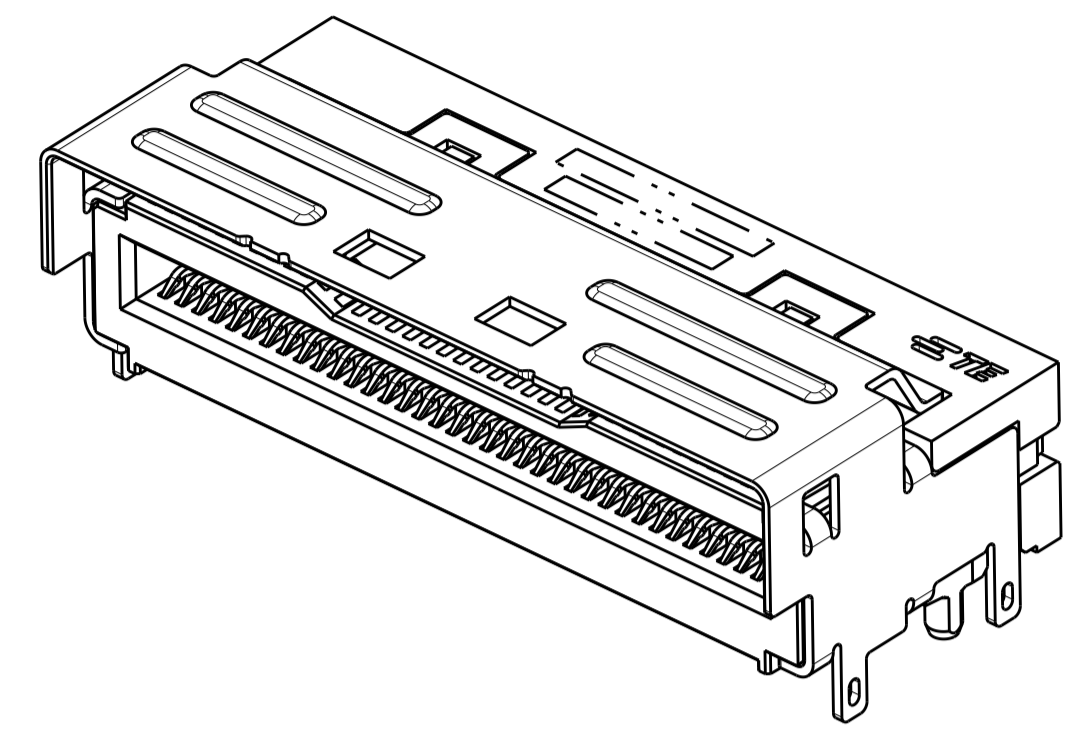

2360196-X
SCALE 5:1

- △ MATERIALS:
PLASTICS: HIGH TEMPERATURE THERMOPLASTIC UL94V-0, COLOR: BLACK.
SHELL: STAINLESS STEEL
CONTACT: COPPER ALLOY
- △ FINISH:
TERMINAL: CONTACT AREA: SELECTED GOLD PLATING, SEE TABLE.
SOLDER AREA: MATTE TIN PLATING 100u".
SHELL: UNDERPLATING: NICKEL PLATING 50u" MIN OVERALL.
- 3 HALOGEN REQUIREMENT MEET CODE 2: LOW BR/CL AS DEFINED IN TEC-138-72.
- △ TE CONNECTIVITY LOGO MARKED IN APPROXIMATE AREA SHOWN.
- △ PART NUMBER AND DATE CODE MARKED IN APPROXIMATE AREA SHOWN.

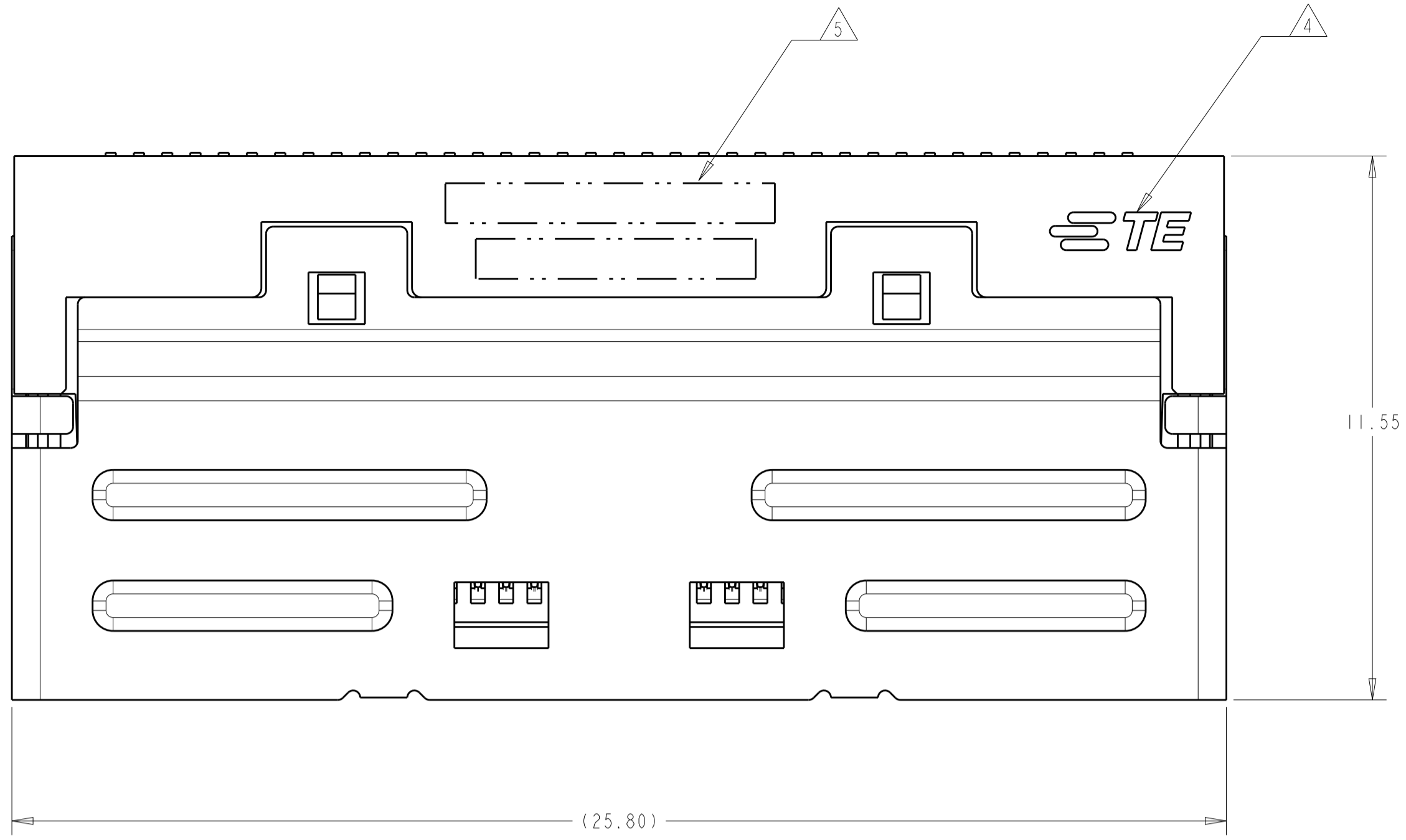
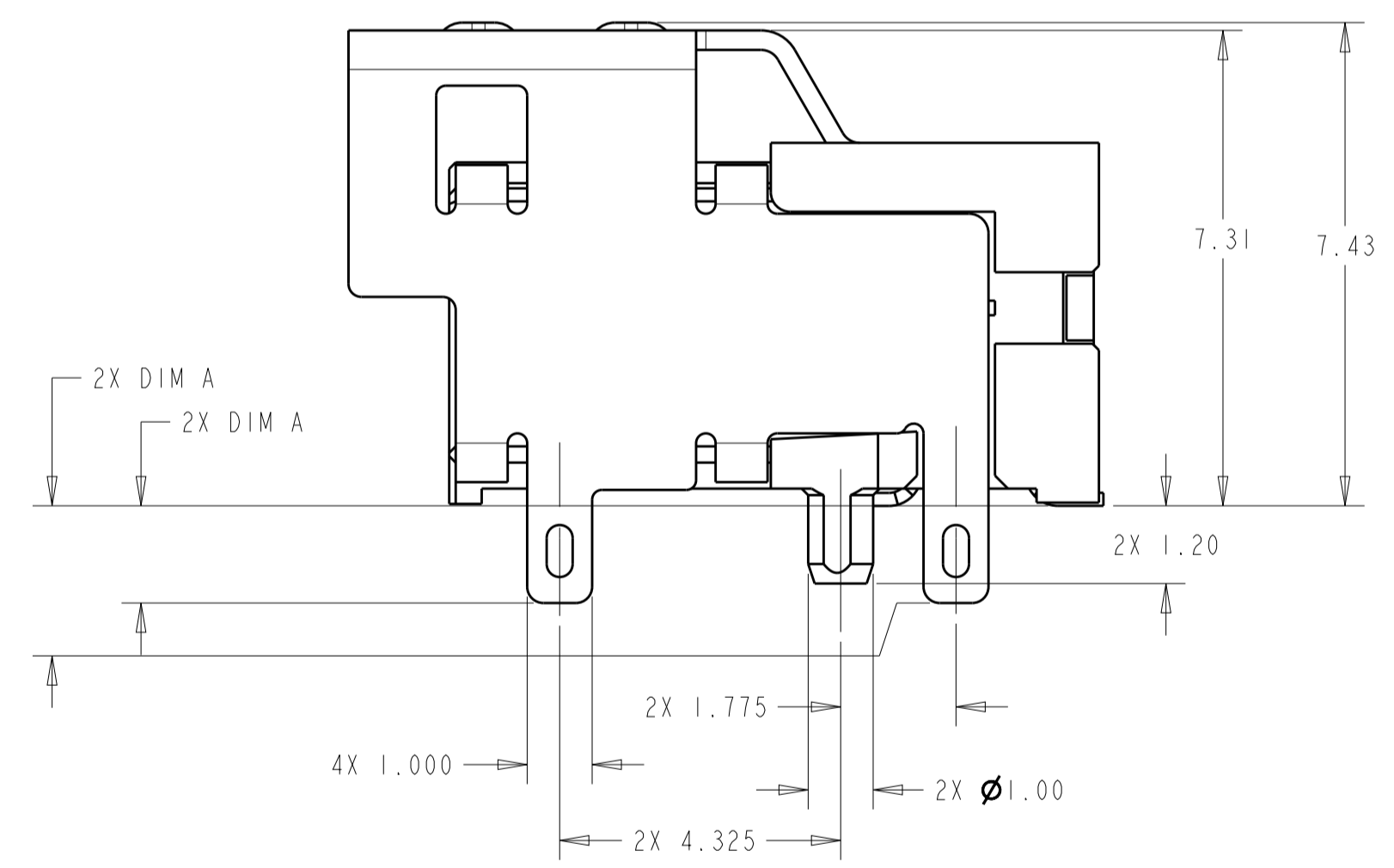
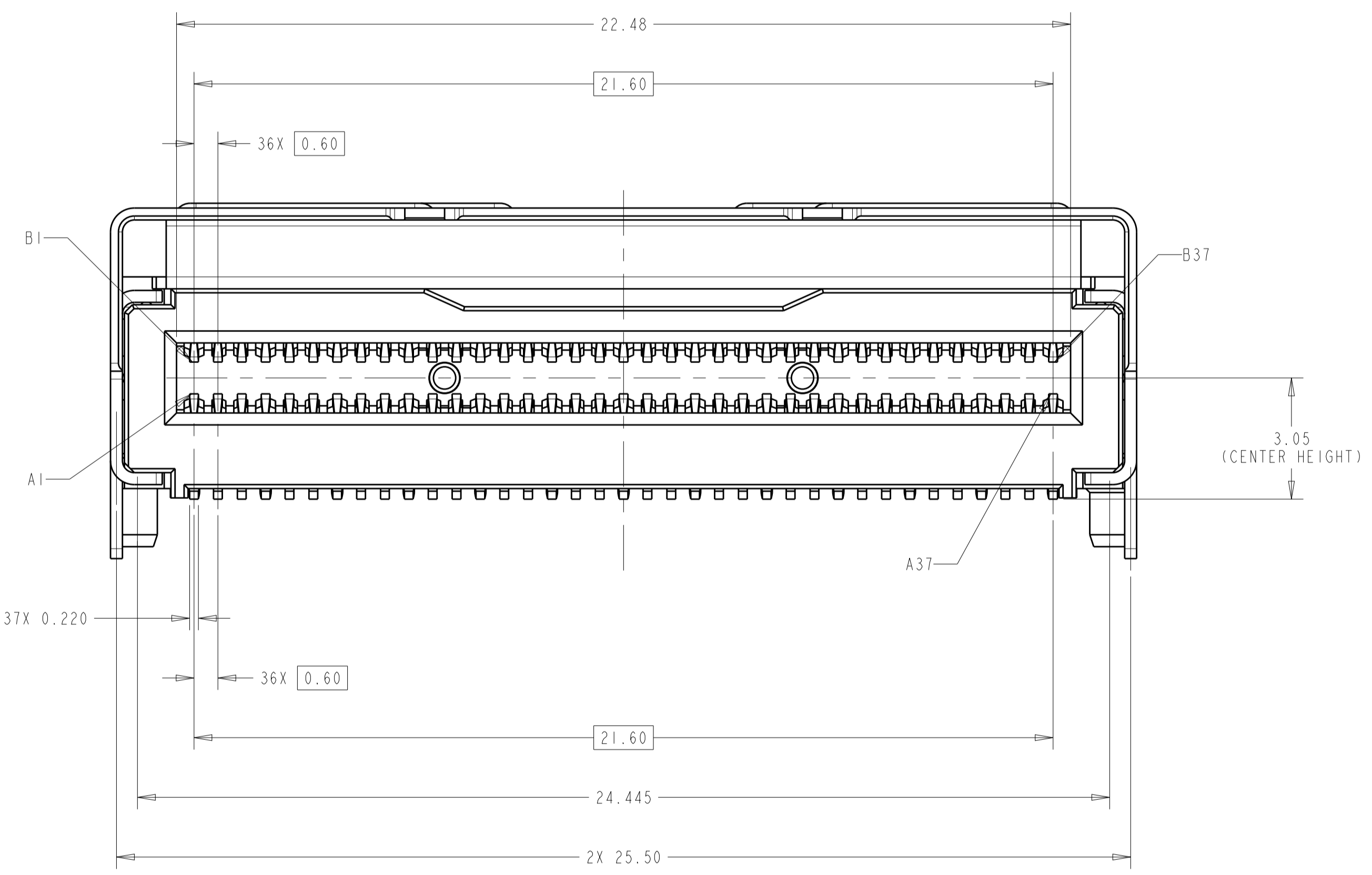

PROPOSED DESIGN
PRODUCT NUMBER WILL BE
ASSIGNED WHEN RELEASED
DESIGN IS SUBJECT TO
CHANGE WITHOUT NOTICE

30u" GOLD	4.20	2360196-5
	3.00	2360196-4
	2.20	2360196-3
	1.50	2360196-2
	1.20	2360196-1
CONTACT FINISH	DIM A	PART NUMBER

THIS DRAWING IS A CONTROLLED DOCUMENT.		DWN: LEO LI 12NOV2019	
DIMENSIONS: mm		CHK: DAVID ZHANG 12NOV2019	
TOLERANCES UNLESS OTHERWISE SPECIFIED:		APP'D: DAVID ZHANG 12NOV2019	NAME: MINI COOL EDGE 10 INTEGRATED CONN 0.6 PITCH, X8, R/A STANDARD SMT TPYE
0 PLC ±0.30 1 PLC ±0.20 2 PLC ±0.20 3 PLC ±0.10 4 PLC ±0.10 ANGLES ±0.25		PRODUCT SPEC	
MATERIAL: SEE NOTES		APPLICATION SPEC	SIZE: A 00779 C=2360196
		FINISH	RESTRICTED TO
		WEIGHT	SCALE: 10:1 SHEET 1 OF 2 REV 1
		CUSTOMER DRAWING	

REVISIONS				
P.	LTN	DESCRIPTION	DATE	APPROV
-	SEE SHEET 1			

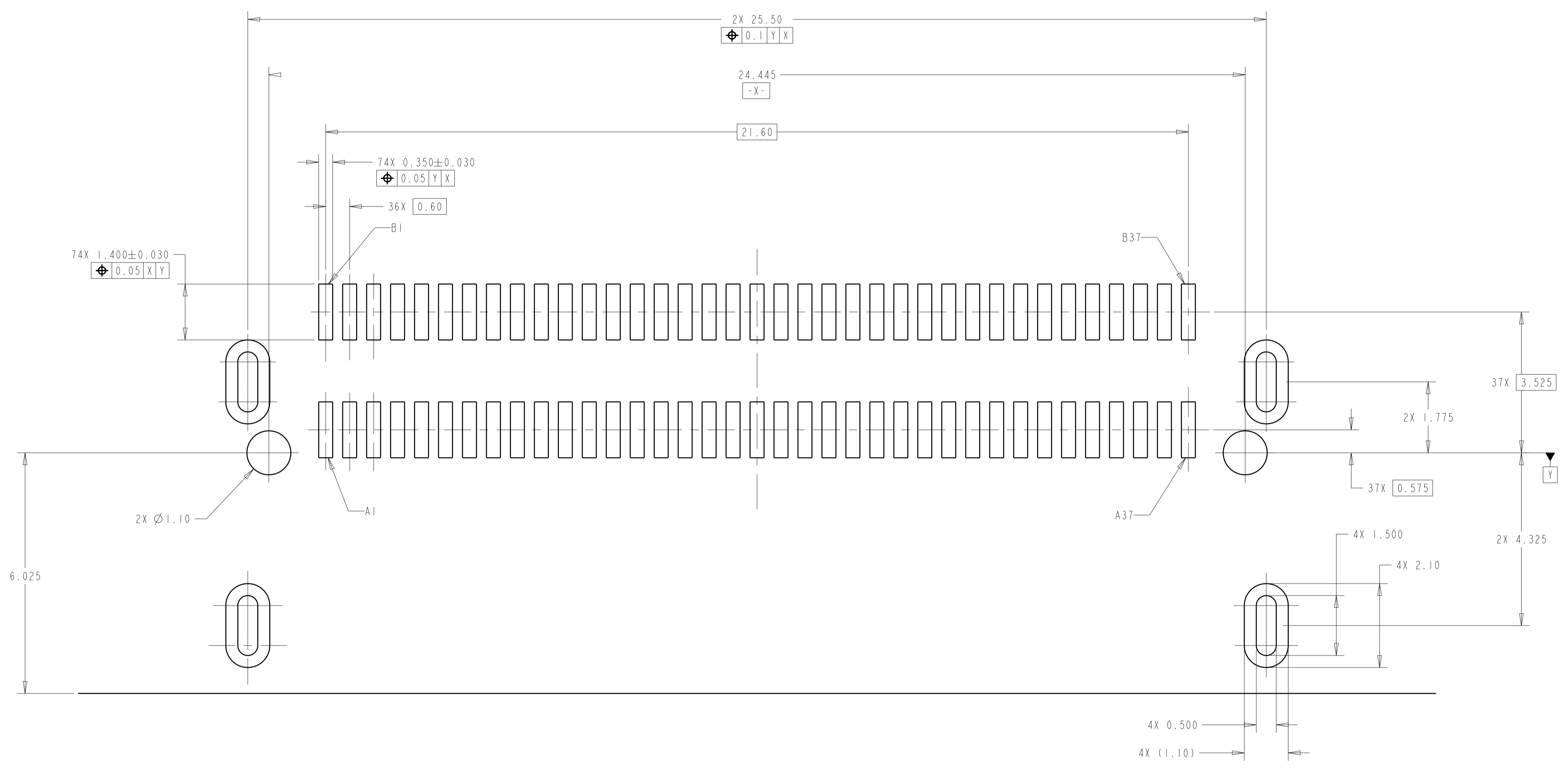

RECOMMENDED PCB LAYOUT
 (GENERAL TOLERANCE: ±0.05)
 SCALE 15:1

PROPOSED DESIGN
 PRODUCT NUMBER WILL BE
 ASSIGNED WHEN RELEASED
 DESIGN IS SUBJECT TO
 CHANGE WITHOUT NOTICE

THIS DRAWING IS A CONTROLLED DOCUMENT.		DWN: LEO LI 12NOV2019	
DIMENSIONS: mm		CHK: DAVID ZHANG 12NOV2019	
TOLERANCES UNLESS OTHERWISE SPECIFIED:		APPR: DAVID ZHANG 12NOV2019	NAME: MINI COOL EDGE 10 INTEGRATED CONN
0 PLC	±	PRODUCT SPEC	0.6 PITCH, X8, R/A STANDARD
1 PLC	±0.30	APPLICATION SPEC	SMT TPYE
2 PLC	±0.20	SIZE	A 00779 C=2360196
3 PLC	±0.10	WEIGHT	SCALE 5:1 SHEET 2 OF 2 REV 1
4 PLC	±	CUSTOMER DRAWING	
ANGLES	±*		
FINISH			
MATERIAL: SEE NOTES			