

P	LTR	DESCRIPTION	DATE	DWN	APVD
A		INITIAL RELEASE	27FEB23	N.J	Z.Z
B		Code C updated and Corner radius improved	23APR23	N.J	Z.Z
B1		The fork lock hole dimensions for recommend PCB layout updated	15MAY23	N.J	Z.Z
B2		Add PIN designation	22JUL24	N.J	Z.Z

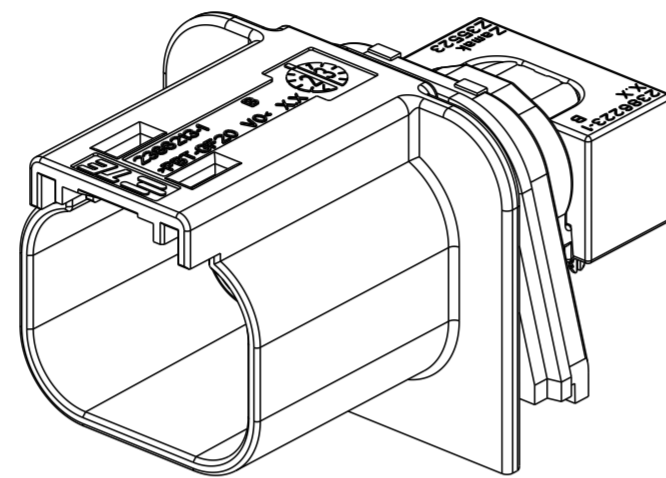

NOTES:

- 1 TIP OF SOLDER TAIL CAN BE INSERTED INTO RECOMMENDED PCB (T=1.6).
- 2 TRAY PACKAGING.
- 3 TO BE MATED WITH DT HIGHSPEED PLUG CONNECTOR 9-2367337-1/-2/-3/-4.
- 4 PRODUCTION DATE OF ASSEMBLY: DDMMYYYY. (2 DIGIT DAY, 3 LETTER MONTH, 4 DIGIT YEAR, E.G. 24JUN2022.)
ASSEMBLY PN: XXXXXXX-X.
- 5 DIFFERENT CODING.

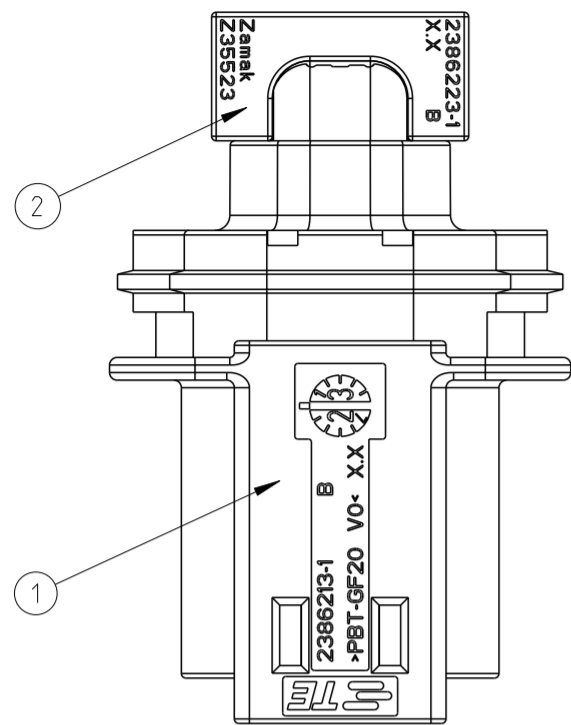
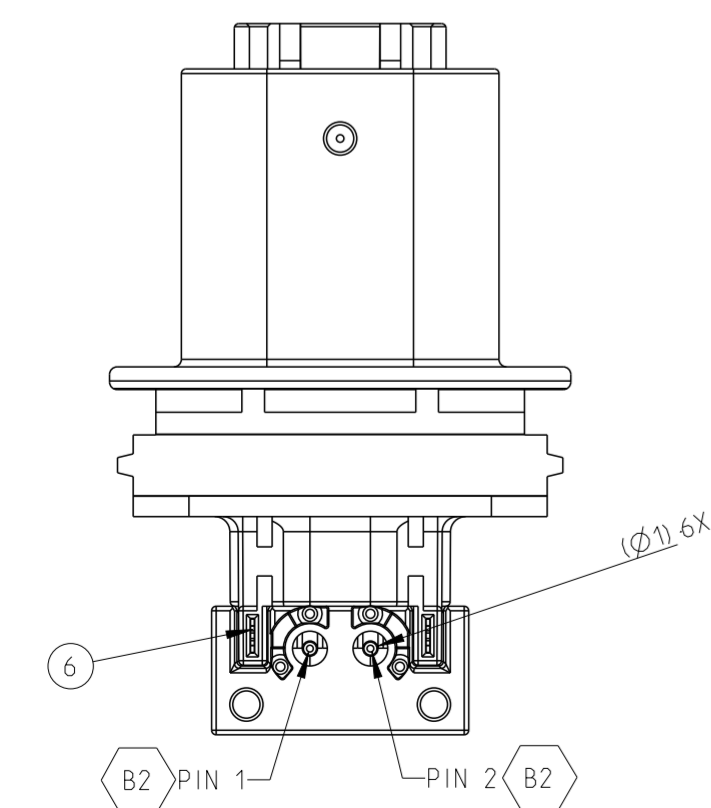
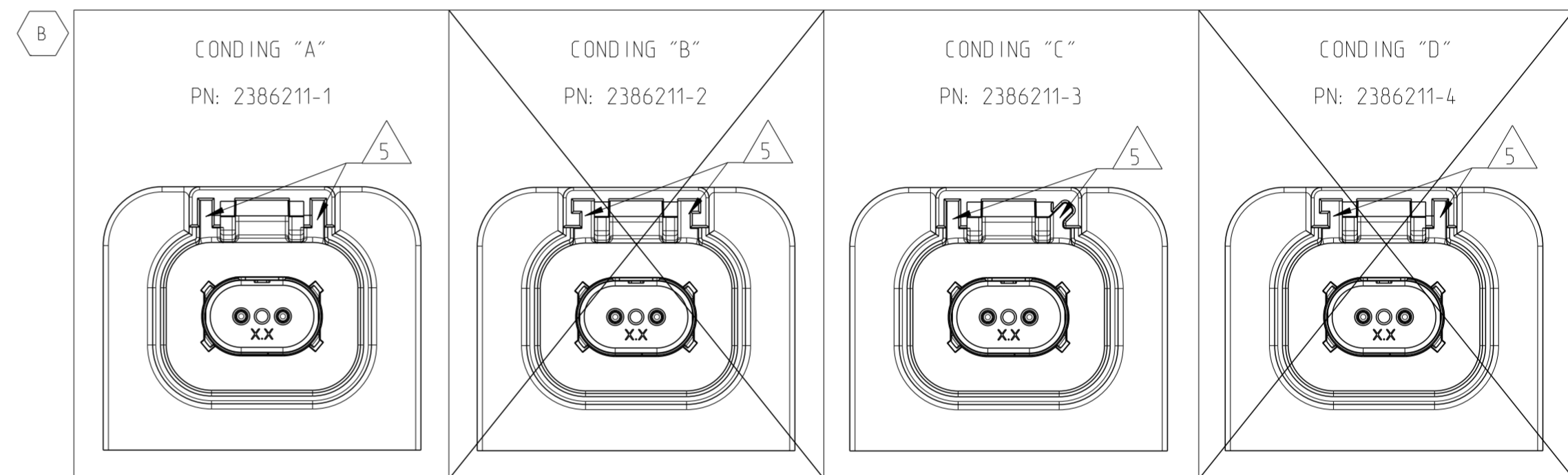
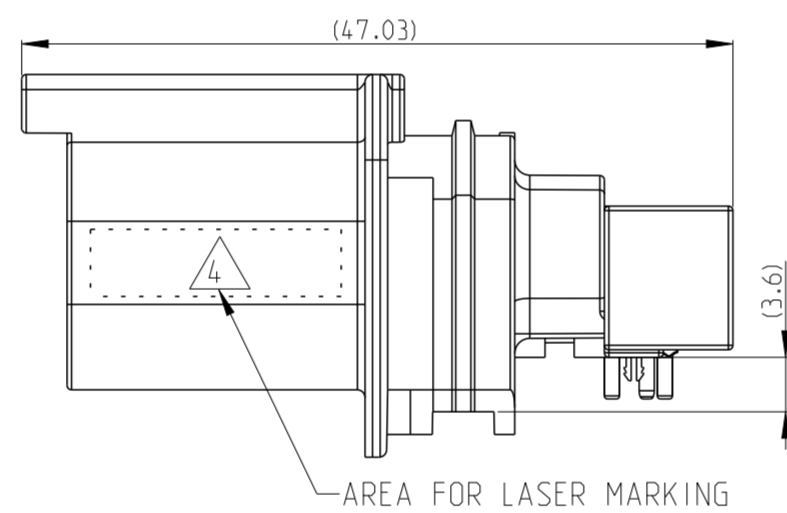
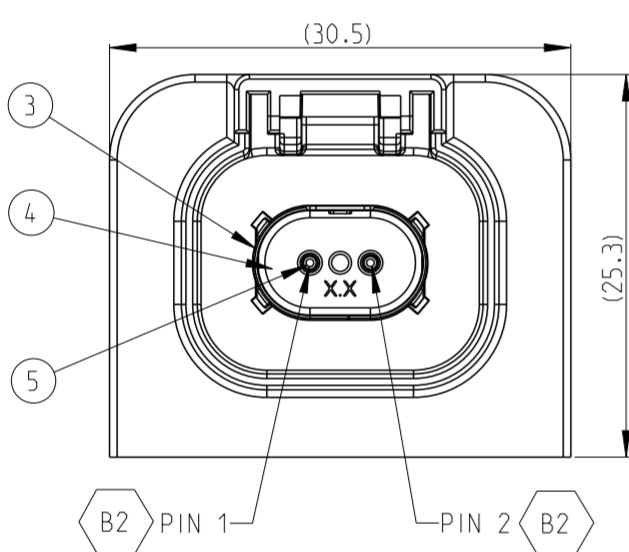

ITEM	DESCRIPTION	MATERIAL	FINISH & COLOR	CODING	QUANTITY
6	HOLD-DOWN	COPPER ALLOY	3µm MIN. MATTE TIN OVER Ni.	-	2
5	PIN	COPPER ALLOY	0.76µm MIN. Au OVER Ni ON INTERFACE END. 3µm MIN. TIN OVER Ni ON SOLDER END.	-	2
4	DIELECTRIC	LCP	BLACK	-	1
3	SHIELD	COPPER ALLOY	10µm MIN. Sn OVER Ni.	-	1
2	DIECAST	Zn ALLOY	3µm MIN. Sn OVER Ni AND Cu.	-	1
1	HOUSING	PBT	BLUE	D	1
			BLACK	C	1
			GREY	B	1
			BLACK	A	1
TE ASSEMBLY PRODUCT NO.					2386211-1 2386211-2 2386211-3 2386211-4
CODING					A B C D
REVISION					B / B /

B

THIS DRAWING IS A CONTROLLED DOCUMENT.

DWN	N.Ji	24 JUN2022
CHK	M.Chen	27 JUN2022
APVD	Zw.Zhou	28 JUN2022

TE Connectivity

DT HIGHSPEED 90DEG HEADER ASSEMBLY

SIZE	CAGE CODE	DRAWING NO	RESTRICTED TO
A2	00779	C-2386211	-

CUSTOMER DRAWING SCALE 2:1 SHEET 1 OF 2 REV B2

REVISIONS

P	LTR	DESCRIPTION	DATE	DWN	APVD
-	-	SEE SHEET1	-	-	-

RECOMMENDED ECU LAYOUT(ONLY FOR INFORMATION).
 CUSTOMER IS RESPONSIBLE FOR LAYOUT.

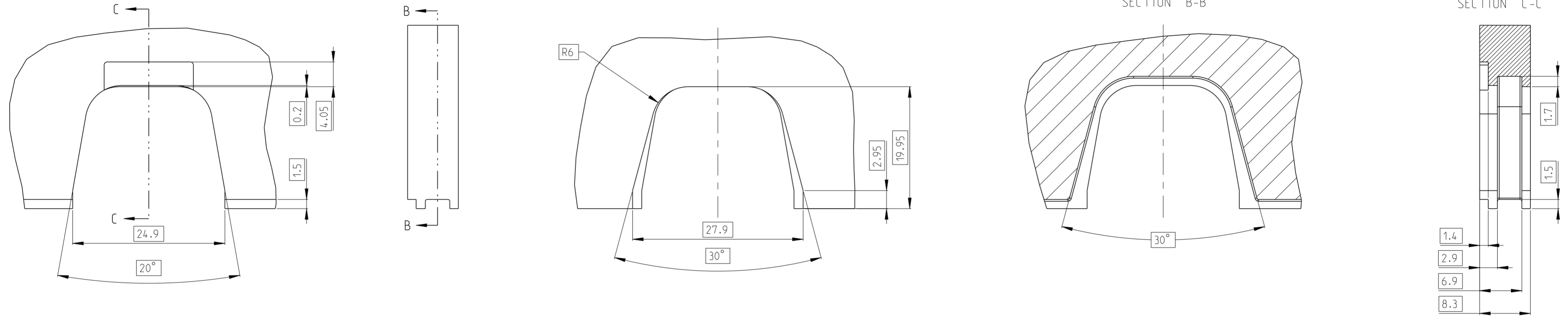

RECOMMENDED PCB LAYOUT(ONLY FOR INFORMATION).
 CUSTOMER IS RESPONSIBLE FOR LAYOUT.

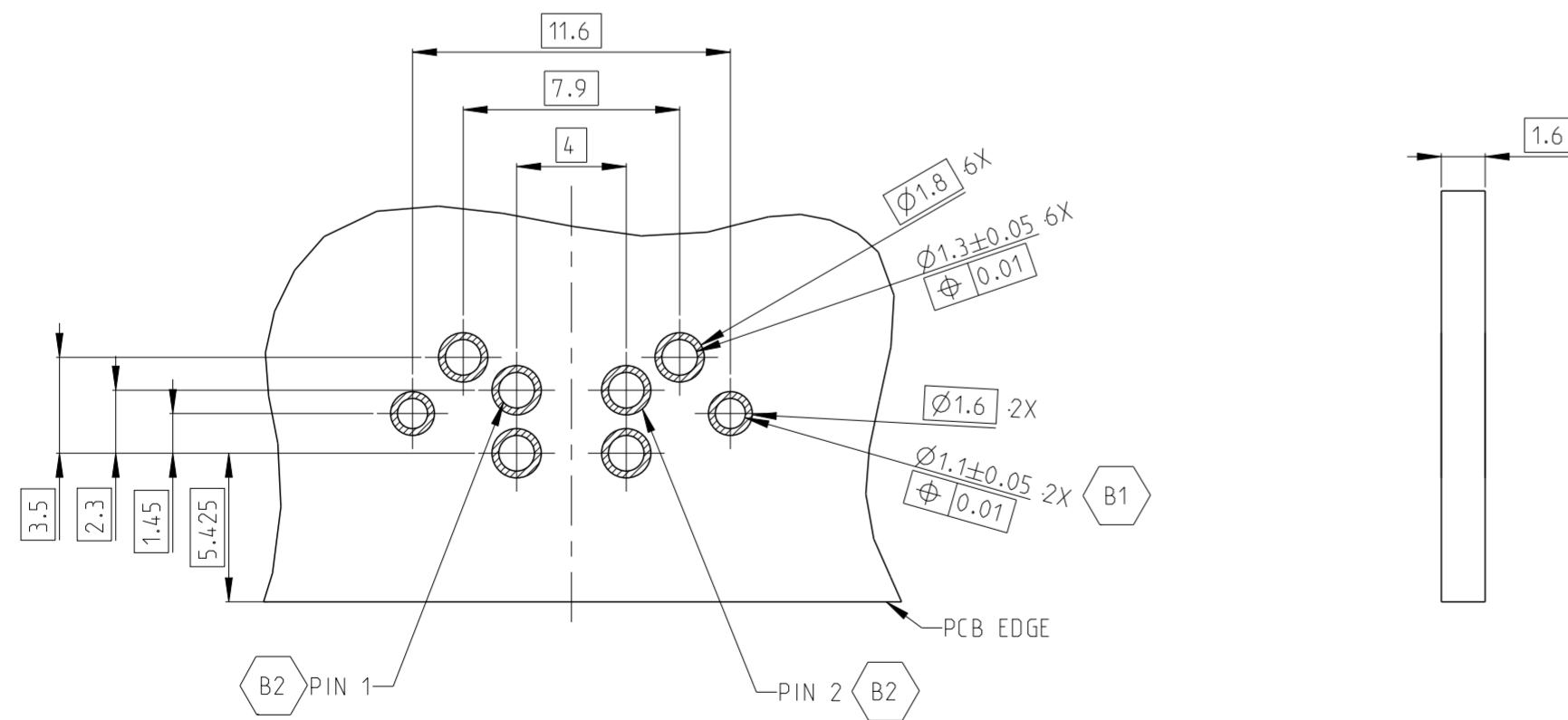

THIS DRAWING IS A CONTROLLED DOCUMENT.		DWN N.Ji 24 JUN2022	 TE Connectivity															
DIMENSIONS: mm		CHK M.Chen 27 JUN2022																
TOLERANCES UNLESS OTHERWISE SPECIFIED:		APVD Zw.Zhou 28 JUN2022	NAME DT HIGHSPEED 90DEG HEADER ASSEMBLY															
<table border="1"> <tr><td>0 PLC</td><td>±</td></tr> <tr><td>1 PLC</td><td>±</td></tr> <tr><td>2 PLC</td><td>±</td></tr> <tr><td>3 PLC</td><td>±</td></tr> <tr><td>4 PLC</td><td>±</td></tr> <tr><td>ANGLES</td><td>±</td></tr> <tr><td>FINISH</td><td>±</td></tr> </table>		0 PLC	±	1 PLC	±	2 PLC	±	3 PLC	±	4 PLC	±	ANGLES	±	FINISH	±	PRODUCT SPEC 108-160582	RESTRICTED TO	
0 PLC	±																	
1 PLC	±																	
2 PLC	±																	
3 PLC	±																	
4 PLC	±																	
ANGLES	±																	
FINISH	±																	
MATERIAL		APPLICATION SPEC 114-160720	SIZE A2	CAGE CODE 100779														
		WEIGHT -	DRAWING NO C-2386211	SCALE 2:1														
		CUSTOMER DRAWING	SHEET 2 OF 2	REV B2														