

REVISIONS					
P	LTR	DESCRIPTION	DATE	DWN	APVD
	-	SEE SHEET 1	-	-	-

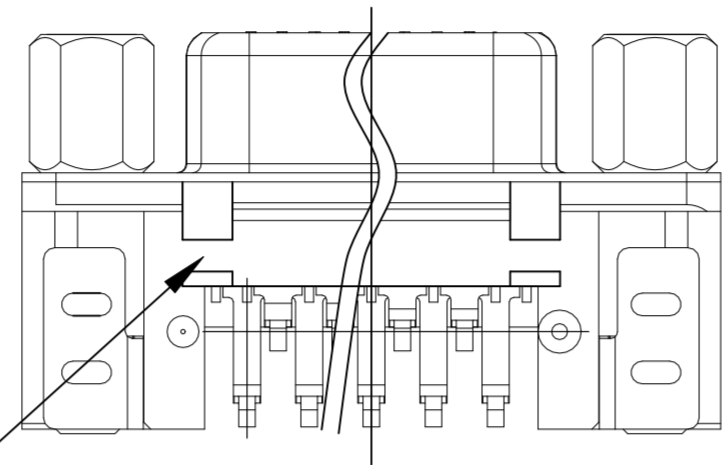

15pin Detail drawing

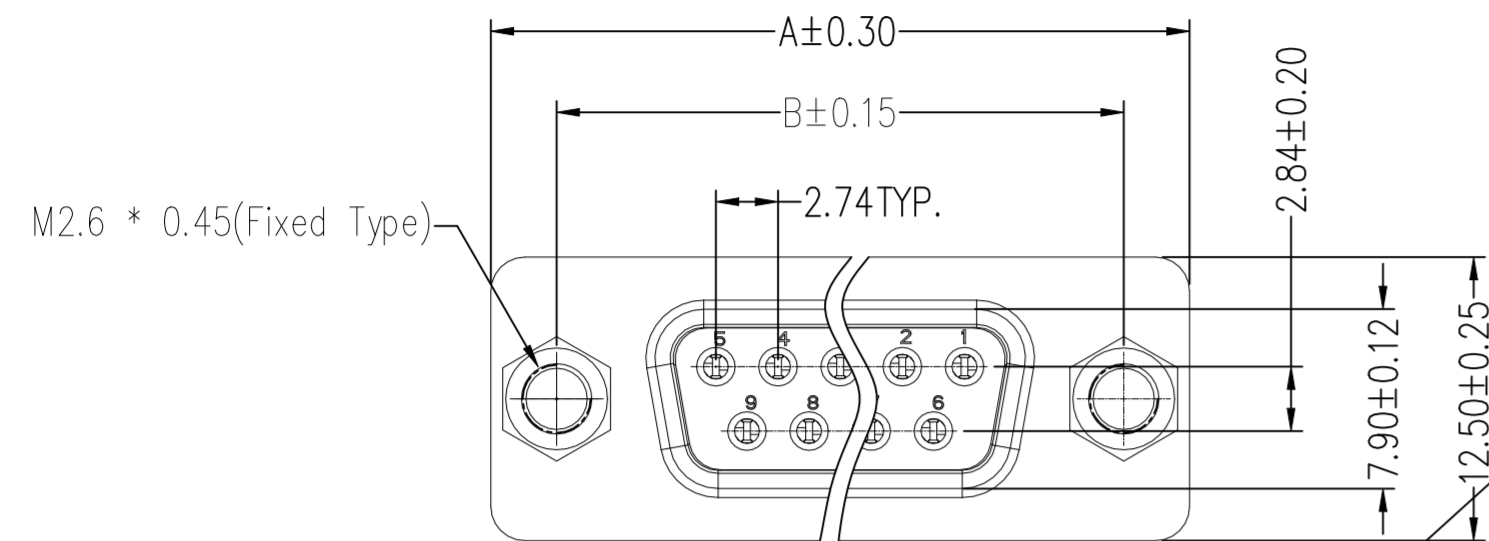
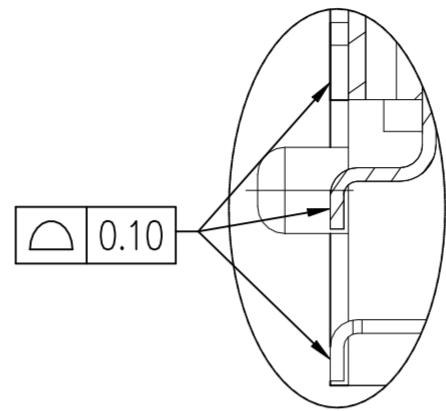

Detail A
Scale 2:1

- NOTES:
- 1,Current Rating: 3.0A
 - 2,Contact Resistance: 25mΩ Max
 - 3,Withstand Voltage: 500V AC
 - 4,Insulation Resistance: 1000MΩ Min
 - 5,Operation Temperature: -55°C to +105°C

- 6,Insulator Material:
High temperature plastics, UL94V-0, Black
 - 7,Contact Material: Copper alloy
 - 8,Contact Plating:
30u" Gold on contact area,
120~200u" Tin on solder area,
50u" Nickel underplating overall.
- Shell: Steel, Nickel plated
Revit/Fixed Plate:Brass,Tin over Nickel plated
Stud: Brass, Nickel plated

Recommended Process:
IR soldering,Peak temperature:260±5°C,5s

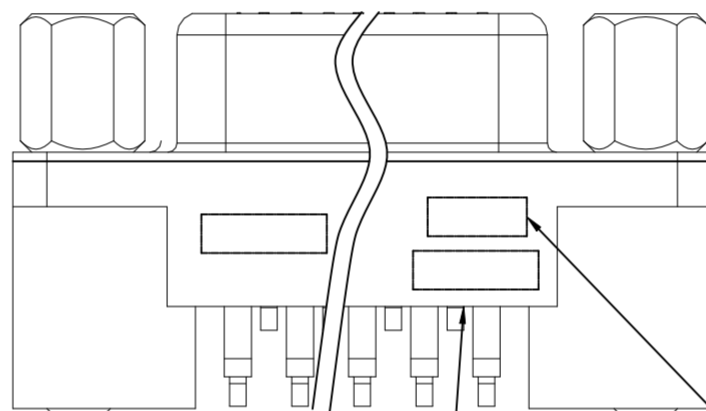
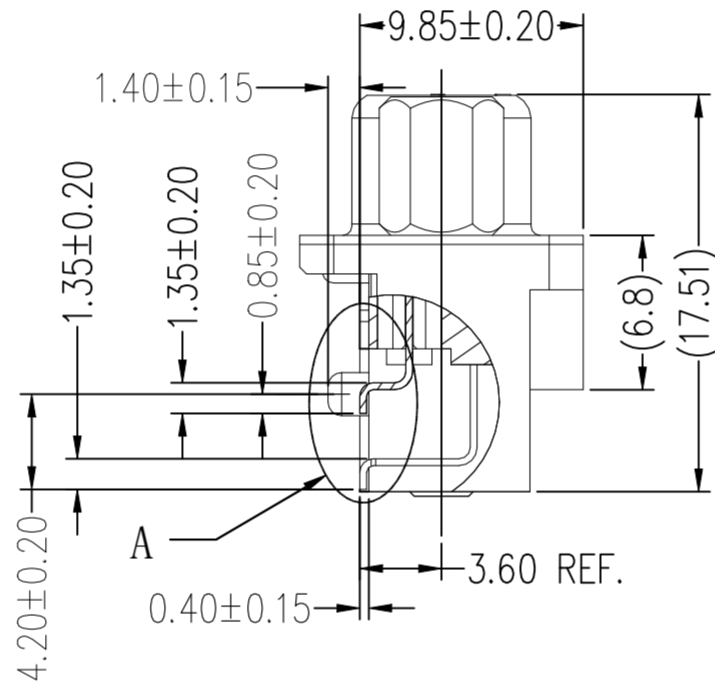
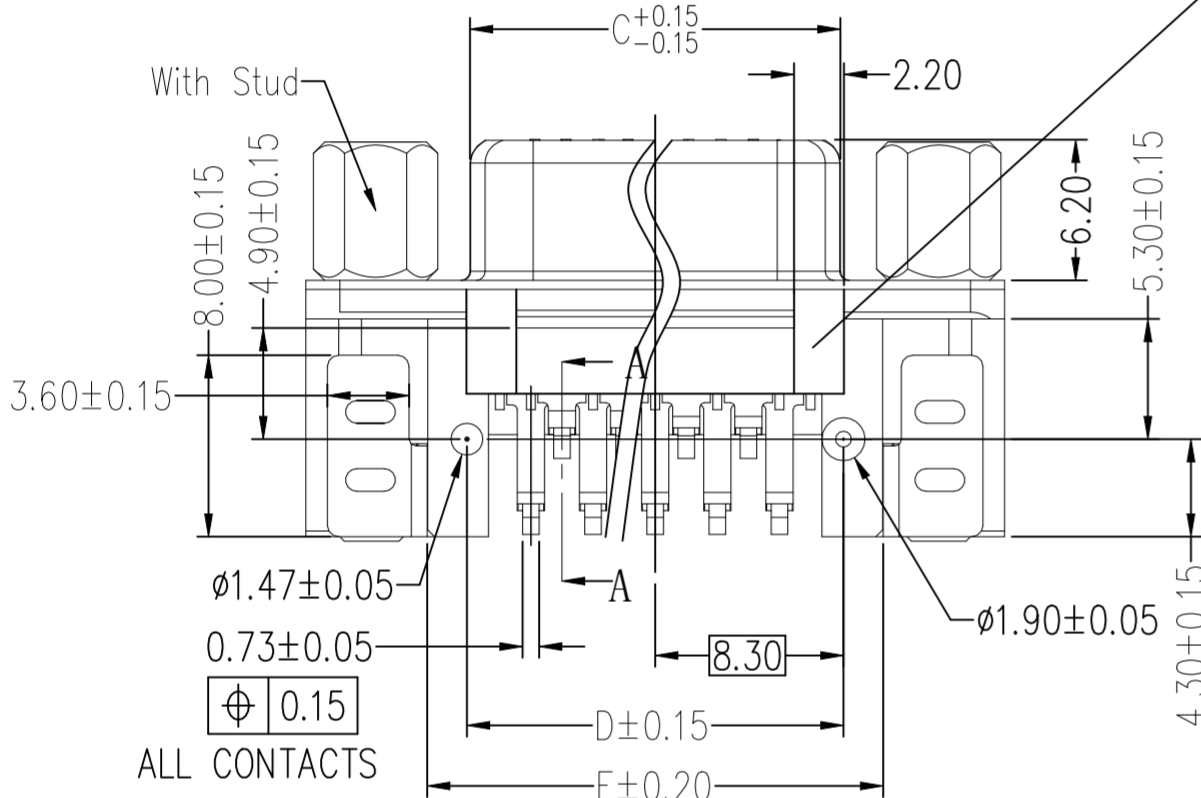

TE PART NO (X-2394032-X) DATE CODE (YYWW)

15P	39.20	33.32	24.66	24.90	28.40
9P	30.80	25.00	16.33	16.60	20.10
PINS	A	B	C	D	E

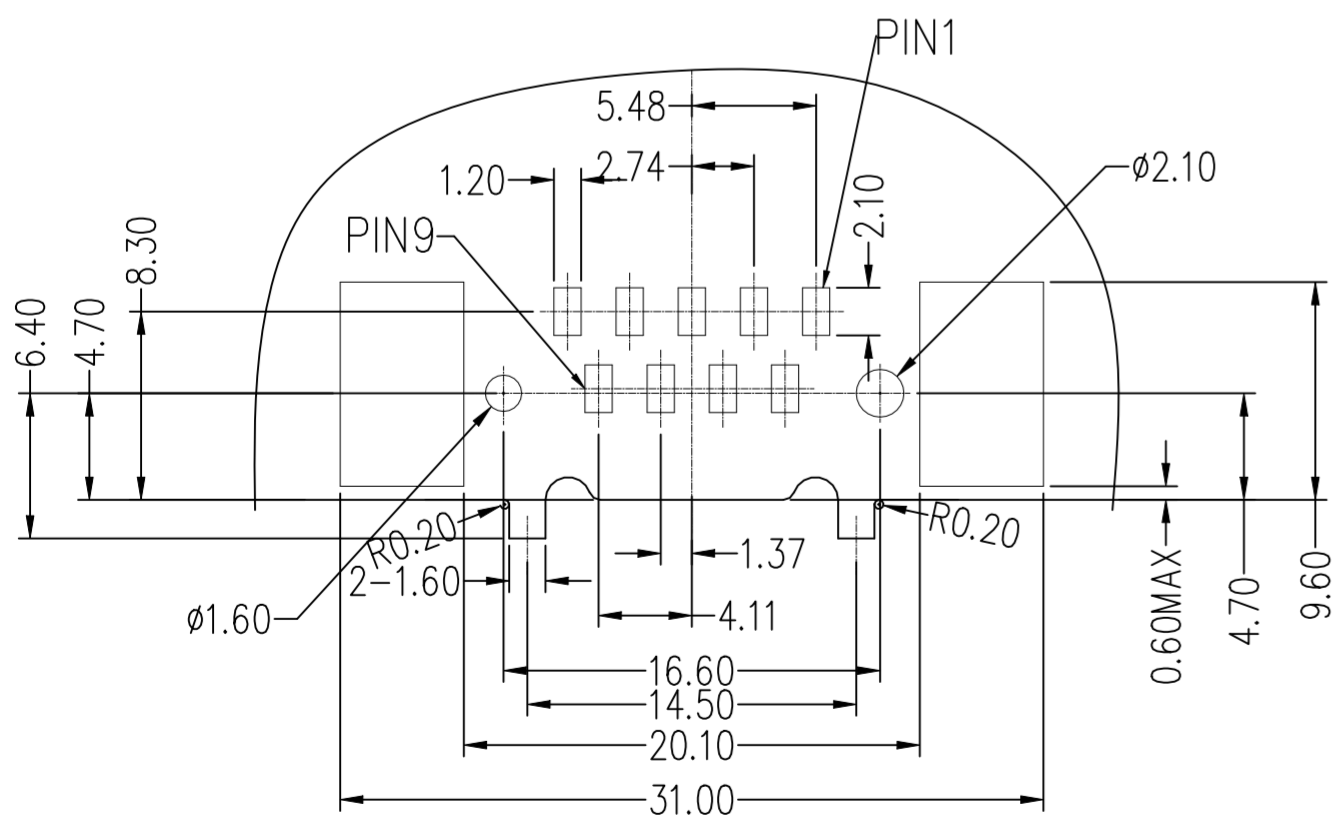

RECOMMENDED P.C.B LAYOUT For 9 position
(COMPONENT SIDE)

RECOMMENDED PCB LAYOUT 1
(COMPONENT SIDE VIEW)

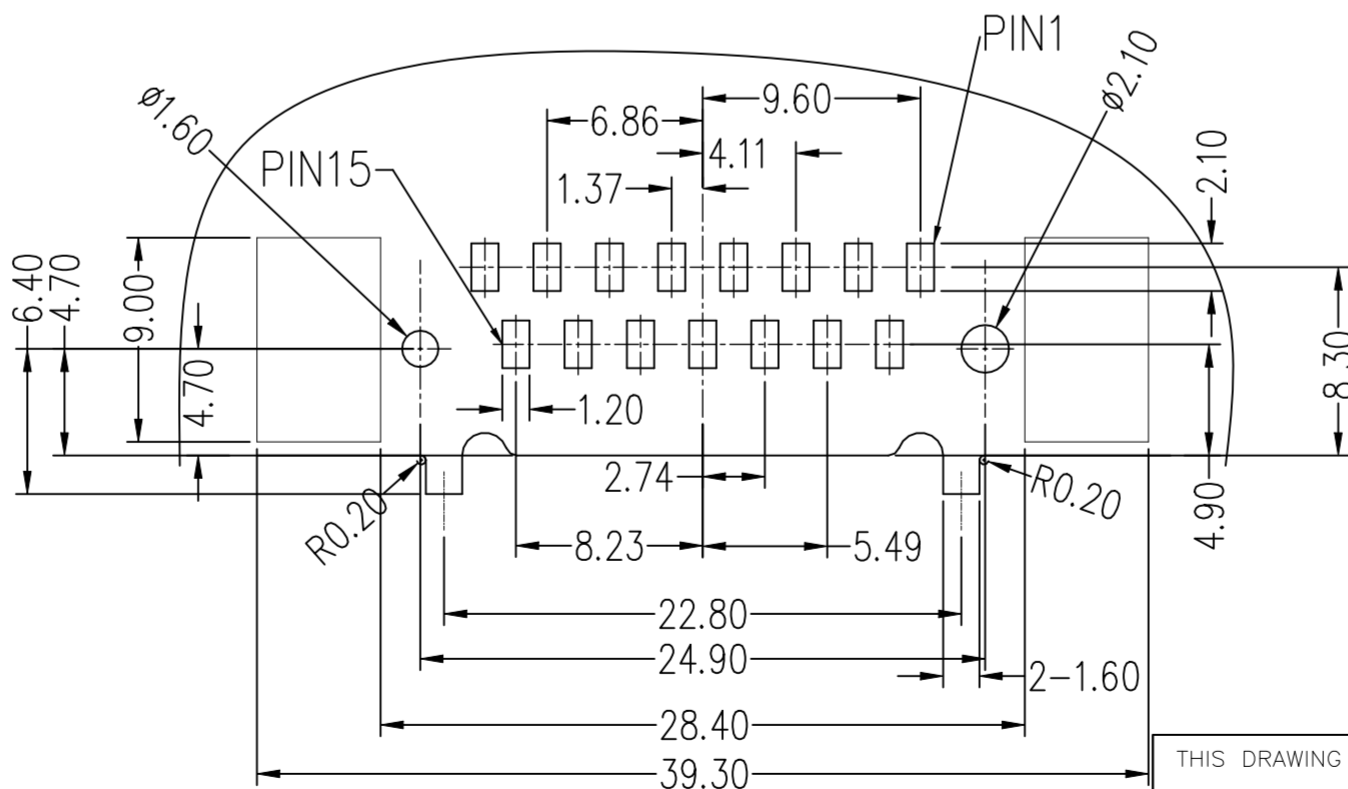

RECOMMENDED P.C.B LAYOUT For 15 position
(COMPONENT SIDE)

THIS DRAWING IS A CONTROLLED DOCUMENT.		DWN	-	TE Connectivity		
		CHK	-			
		APVD	-	NAME		
		PRODUCT SPEC	-	D-sub Header, Plug, SMT		
		APPLICATION SPEC	-			
		WEIGHT	-	SIZE	CAGE CODE	DRAWING NO
		CUSTOMER DRAWING		A2	00779	C=2394032
		SCALE	1:1	SHEET	3 of 5	REV A

REVISIONS					
P	LTR	DESCRIPTION	DATE	DWN	APVD
-	-	SEE SHEET 1	-	-	-

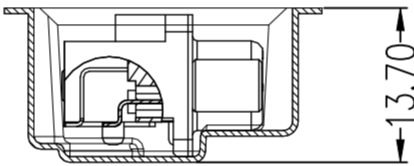
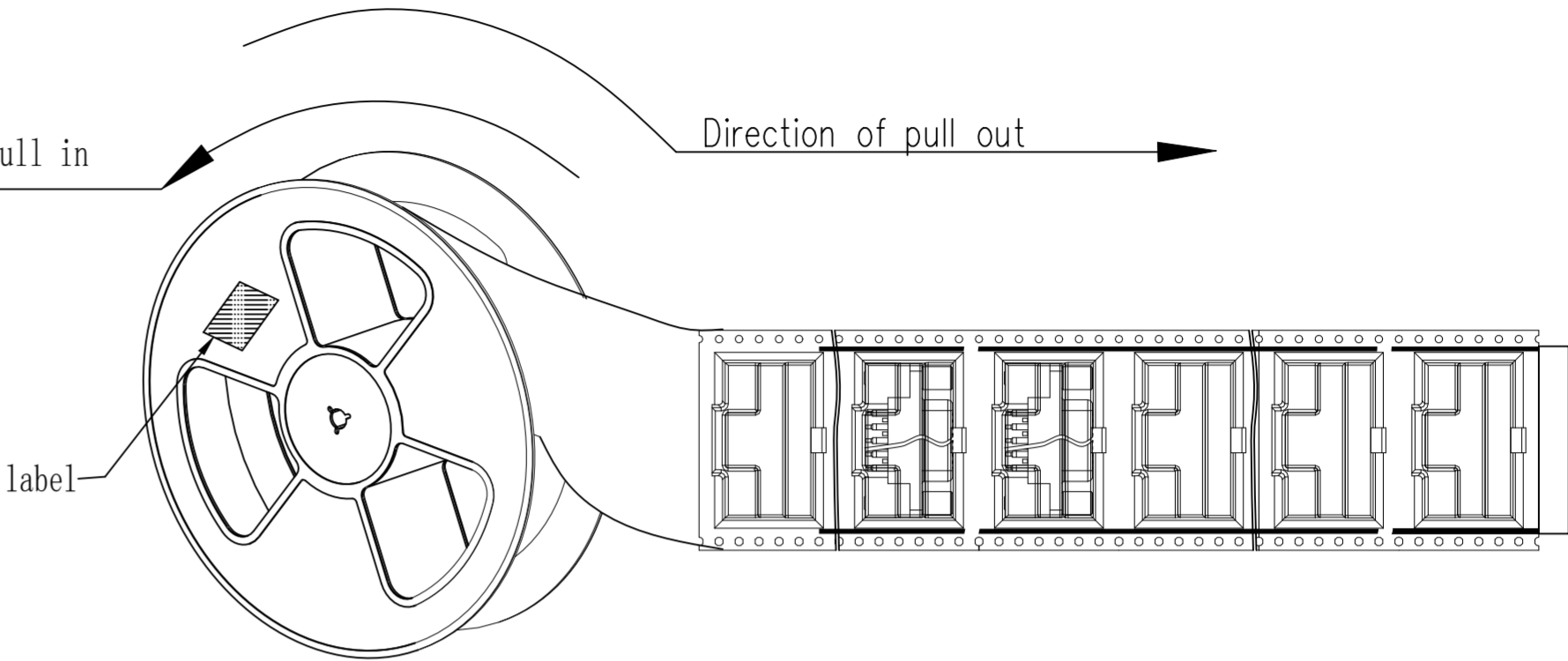
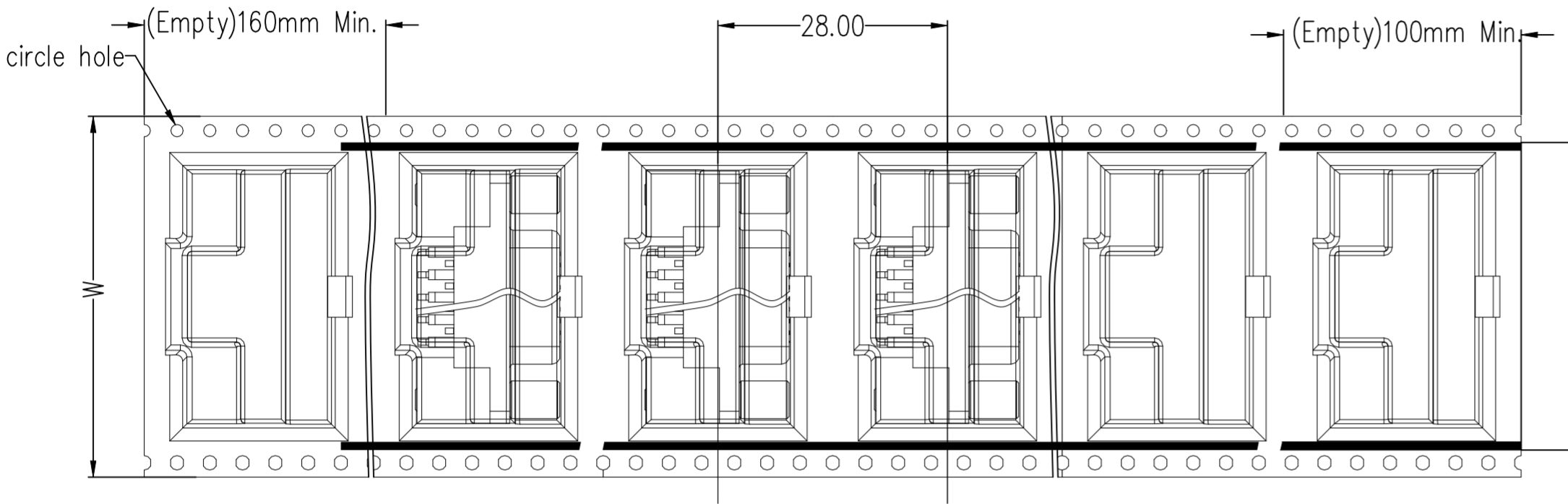

Cutaway view

PIN	W
9P	44.0±0.30
15P	56.0±0.30

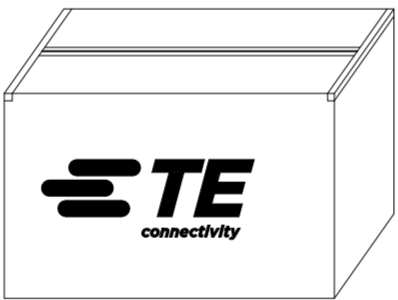

Seal, pack, label.

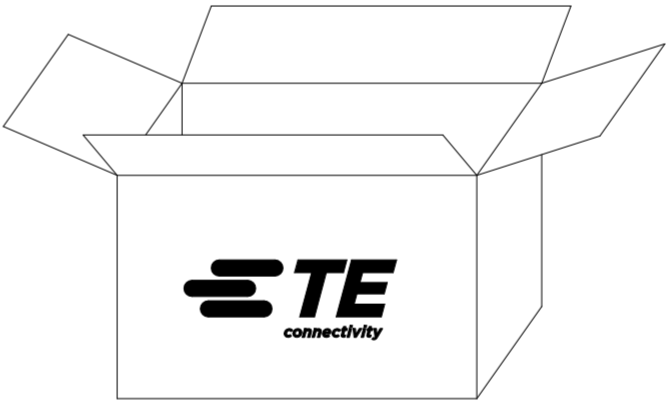

Put reel into outer box,
pay attention to the unified label direction.

THIS DRAWING IS A CONTROLLED DOCUMENT.		DWN	-	TE Connectivity	
		CHK	-		
		APVD	-	NAME	
		PRODUCT SPEC	-	D-sub Header, Plug, SMT	
		APPLICATION SPEC	-		
		WEIGHT	-	SIZE	CAGE CODE
		CUSTOMER DRAWING	-	A2	00779
		SCALE	1:1	SHEET	4 OF 5
		REV	A	RESTRICTED TO	

REVISIONS					
P	LTR	DESCRIPTION	DATE	DWN	APVD
-	-	SEE SHEET 1	-	-	-

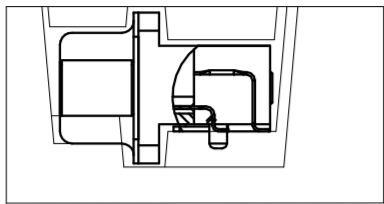

Product piping diagram

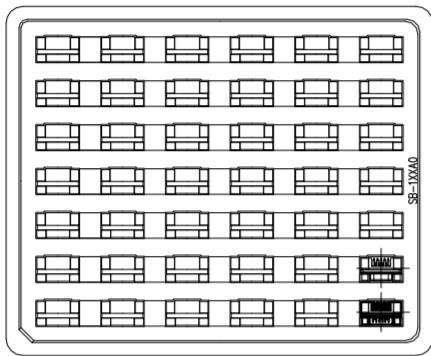

No. 1

put the product into the tray

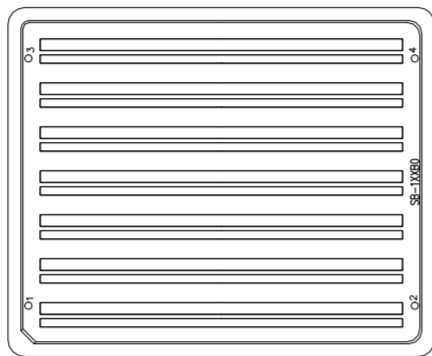
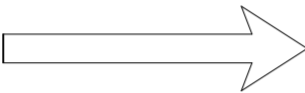

No. 2

Cover the tray

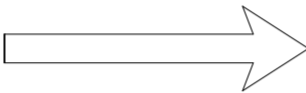

Quantity label

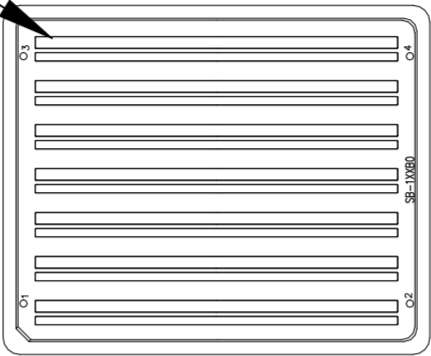

No. 3

Label on top left corner of tray

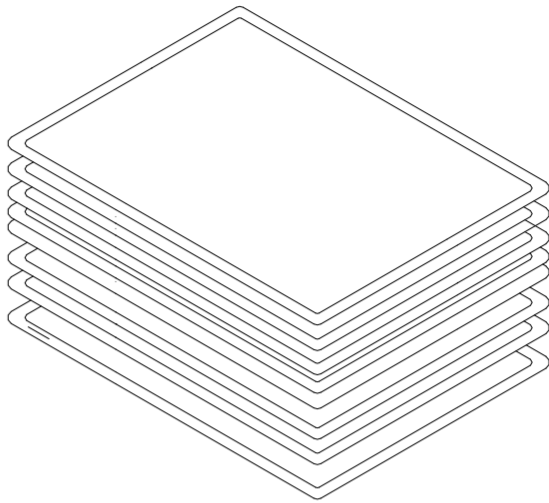
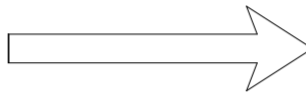

No. 4

the top and bottom of each put a piece of paper board,

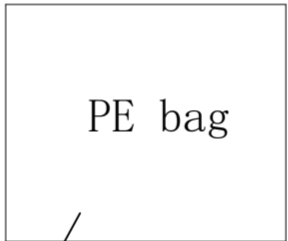
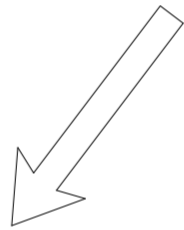

PE bag

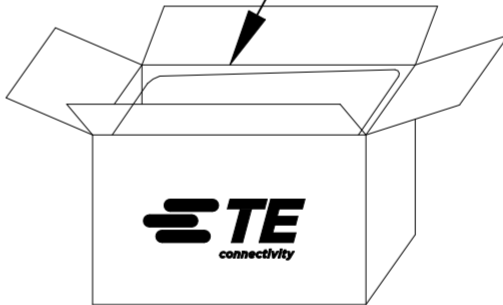

No. 5

A waterproof PE bag should be set inside the carton, and then the tray should be put into the carton Sealed with a bag of desiccant.

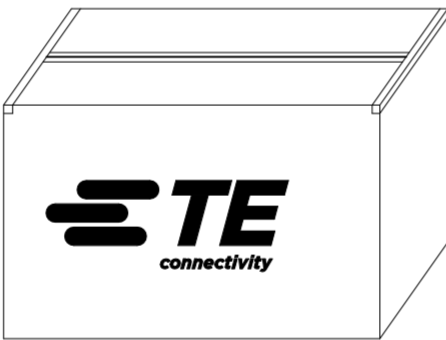

No. 6

Seal and label on the top left corner of the carton side

- Explain:
1. Put the product into the tray as shown in the figure
 2. Pay attention to the consistency of label style position and direction;

THIS DRAWING IS A CONTROLLED DOCUMENT.		DWN	-	TE Connectivity			
		CHK	-				
DIMENSIONS:		APVD	-	NAME			
mm		PRODUCT SPEC		D-sub Header, Plug, SMT			
		APPLICATION SPEC		-			
		WEIGHT		-			
		CUSTOMER DRAWING		SIZE	CAGE CODE	DRAWING NO	RESTRICTED TO
				A2	00779	C=2394032	-
MATERIAL		FINISH		SCALE 1:1 SHEET 5 of 5 REV A			
-		-					