

REVISIONS					
P	LTR	DESCRIPTION	DATE	DWN	APVD
A		INITIAL RELEASE	20DEC2023	G.C	H.L

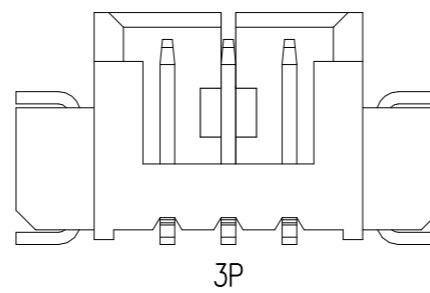

- NOTES:
- Current Rating: 1.0A
  - Contact Resistance: 20mΩ Max
  - Withstand Voltage: 500V AC
  - Insulation Resistance: 100MΩ Min
  - Operation Temperature: -25°C to +85°C
  - Housing: High temperature thermoplastic, UL94V-0, Natural
  - Contact: Brass (See Table) over 50u" nickel
  - Tab: Brass 100u" Matte tin over 50u" nickel

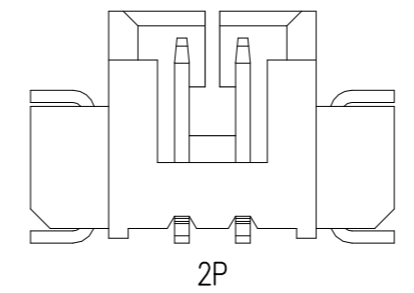
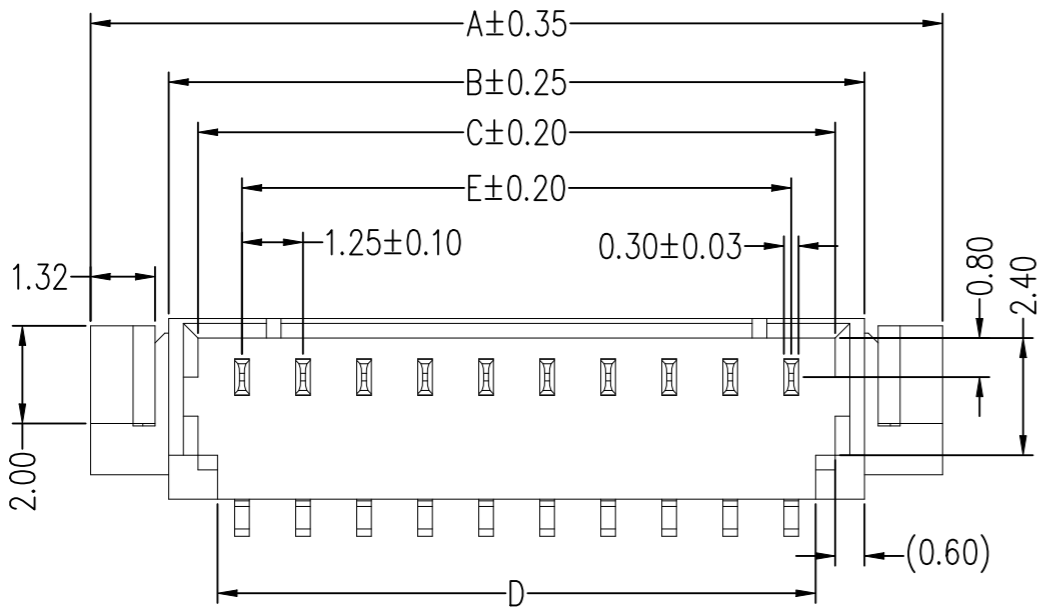
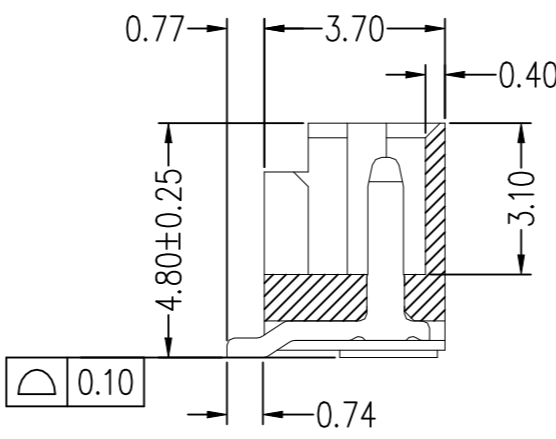
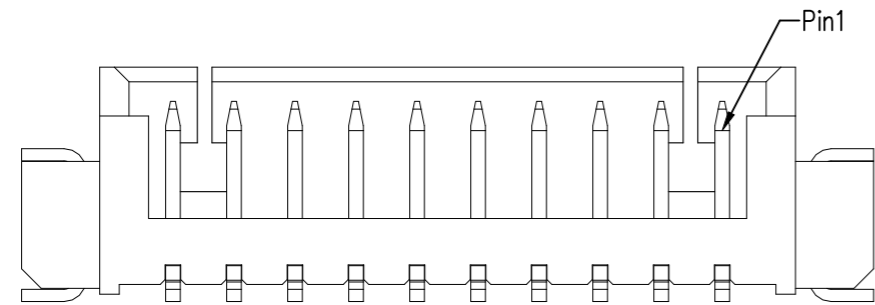

4~15P

CONTACT PLATING	PINS	DIM A	DIM B	DIM C	DIM D	DIM E	PN
30u" Gold	15	23.70	20.50	19.30	18.50	17.50	4-2473229-5
	14	22.45	19.25	18.05	17.25	16.25	4-2473229-4
	13	21.20	18.00	16.80	16.00	15.00	4-2473229-3
	12	19.95	16.75	15.55	14.75	13.75	4-2473229-2
	11	18.70	15.50	14.30	13.50	12.50	4-2473229-1
	10	17.45	14.25	13.05	12.25	11.25	4-2473229-0
	9	16.20	13.00	11.80	11.00	10.00	3-2473229-9
	8	14.95	11.75	10.55	9.75	8.75	3-2473229-8
	7	13.70	10.50	9.30	8.50	7.50	3-2473229-7
	6	12.45	9.25	8.05	7.25	6.25	3-2473229-6
	5	11.20	8.00	6.80	6.00	5.00	3-2473229-5
	4	9.95	6.75	5.55	4.75	3.75	3-2473229-4
	3	8.70	5.50	4.30	3.50	2.50	3-2473229-3
	2	7.45	4.25	3.05	2.25	1.25	3-2473229-2
	100u" Matte tin	15	23.70	20.50	19.30	18.50	17.50
14		22.45	19.25	18.05	17.25	16.25	1-2473229-4
13		21.20	18.00	16.80	16.00	15.00	1-2473229-3
12		19.95	16.75	15.55	14.75	13.75	1-2473229-2
11		18.70	15.50	14.30	13.50	12.50	1-2473229-1
10		17.45	14.25	13.05	12.25	11.25	1-2473229-0
9		16.20	13.00	11.80	11.00	10.00	2473229-9
8		14.95	11.75	10.55	9.75	8.75	2473229-8
7		13.70	10.50	9.30	8.50	7.50	2473229-7
6		12.45	9.25	8.05	7.25	6.25	2473229-6
5		11.20	8.00	6.80	6.00	5.00	2473229-5
4		9.95	6.75	5.55	4.75	3.75	2473229-4
3		8.70	5.50	4.30	3.50	2.50	2473229-3
2		7.45	4.25	3.05	2.25	1.25	2473229-2

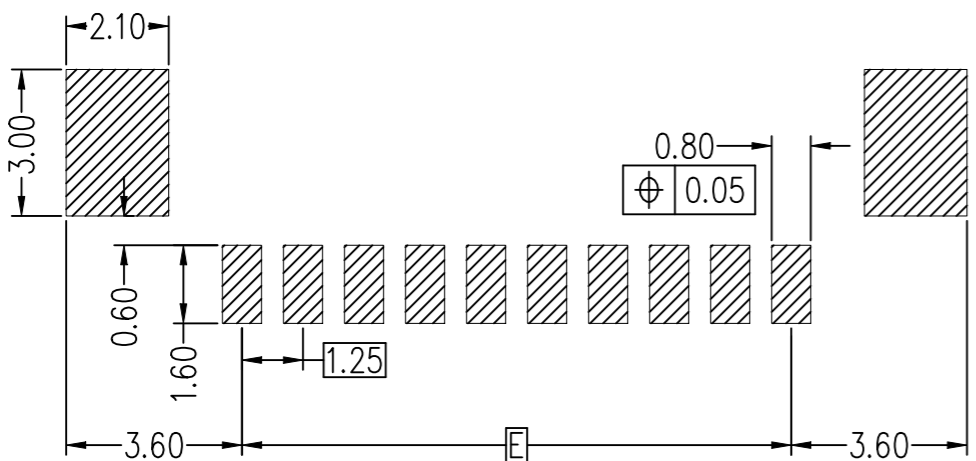

RECOMMENDED P.C.B LAYOUT (COMPONENT SIDE)(TOLERANCE: ±0.05)

THIS DRAWING IS A CONTROLLED DOCUMENT.		DWN GOWTHAM 20DEC23	TE Connectivity			
DIMENSIONS: mm		CHK CONNOR KANG 20DEC23				
TOLERANCES UNLESS OTHERWISE SPECIFIED:		APVD H.L 20DEC23	NAME			
0 PLC ± - 1 PLC ± - 2 PLC ± 0.25 3 PLC ± - 4 PLC ± - ANGLES ± -		PRODUCT SPEC 108-161193	WIRE TO BOARD MALE HEADER 1.25MM PITCH, SMT STRAIGHI TYPE			
MATERIAL		APPLICATION SPEC 114-160812	SIZE	CAGE CODE	DRAWING NO	RESTRICTED TO
FINISH		WEIGHT 0	A3	00779	C-2473229	-
CUSTOMER DRAWING			SCALE 1:1	SHEET 1 OF 2	REV A	

REVISIONS					
P	LTR	DESCRIPTION	DATE	DWN	APVD
-	-	SEE SHEET 1	-	-	-

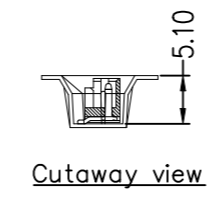
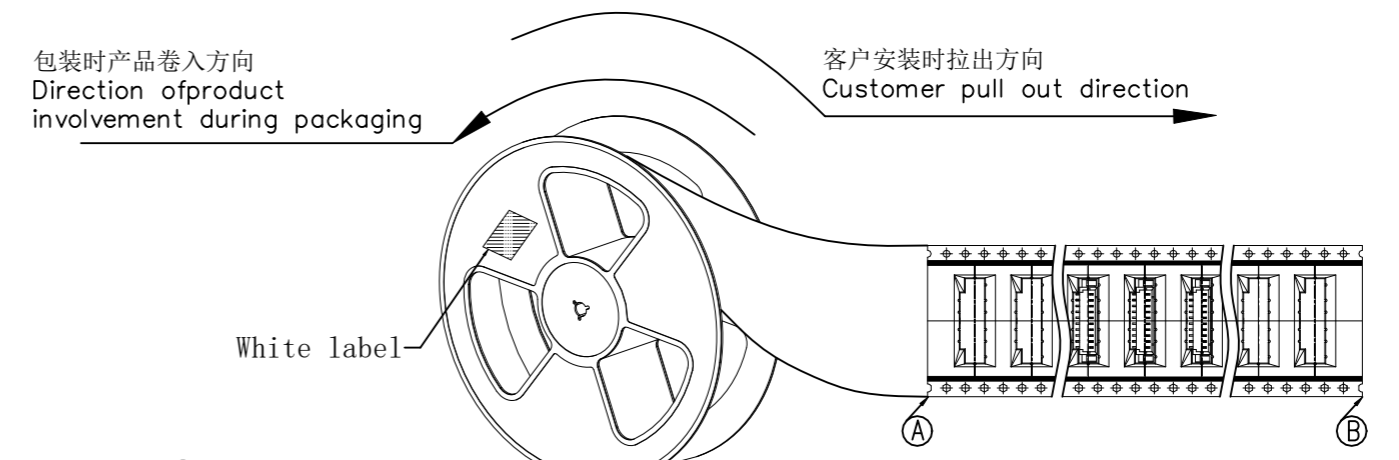
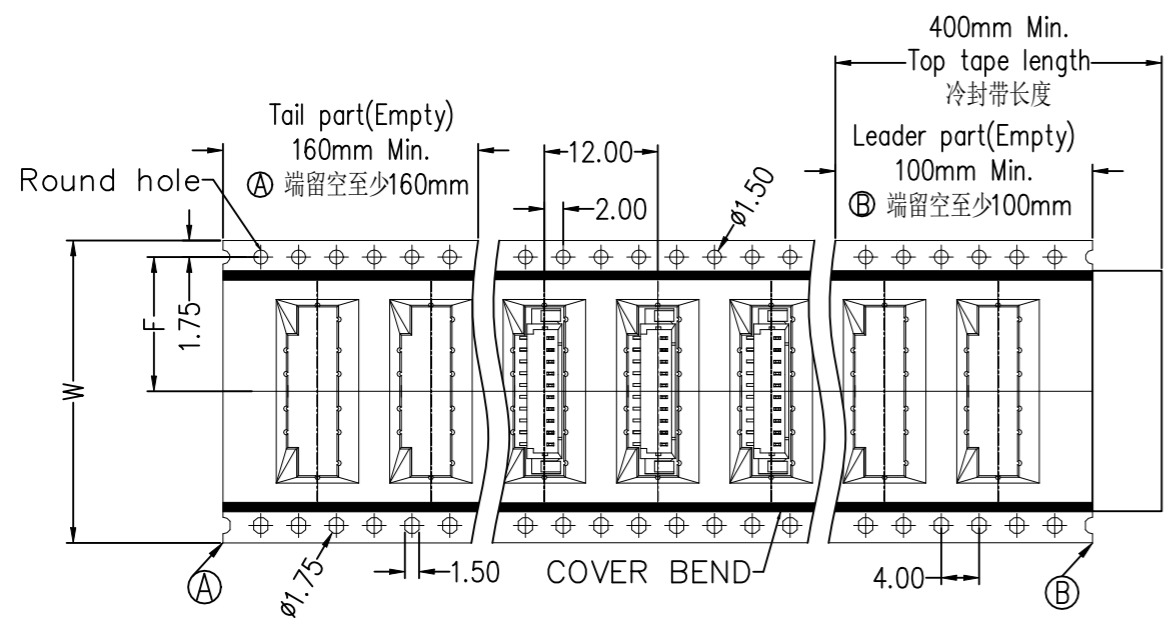

**No.1:**  
 Before package, pay attention to leave more than 160mm(min) empty, after put the products into the carrier groove, packing with the cover bend then,  
 Note: the tension between tape and cover bend is 10g~120g

**Note:**  
 1.  $W \leq 24$ , Only Round sprocket holes  
 2.  $W \geq 32$ , Round sprocket holes and Elongated sprocket holes

PIN	TE P/N	W	F	PCS/Reel	PCS/Inner Box	PCS/Outer Box
2	3-2473229-2	16.0 ± 0.30	7.50 ± 0.15	1050	4200	12600
	2473229-2					
3	3-2473229-3	24.0 ± 0.30	11.50 ± 0.15	1050	3150	9450
	2473229-3					
4	3-2473229-4	32.0 ± 0.30	14.20 ± 0.15	1050	2100	6300
	2473229-4					
5	3-2473229-5	44.0 ± 0.30	20.20 ± 0.15	1050	2100	6300
	2473229-5					
6	3-2473229-6	32.0 ± 0.30	14.20 ± 0.15	1050	2100	6300
	2473229-6					
7	3-2473229-7	44.0 ± 0.30	20.20 ± 0.15	1050	2100	6300
	2473229-7					
8	3-2473229-8	32.0 ± 0.30	14.20 ± 0.15	1050	2100	6300
	2473229-8					
9	3-2473229-9	44.0 ± 0.30	20.20 ± 0.15	1050	2100	6300
	2473229-9					
10	4-2473229-0	32.0 ± 0.30	14.20 ± 0.15	1050	2100	6300
	1-2473229-0					
11	4-2473229-1	44.0 ± 0.30	20.20 ± 0.15	1050	2100	6300
	1-2473229-1					
12	4-2473229-2	44.0 ± 0.30	20.20 ± 0.15	1050	2100	6300
	1-2473229-2					
13	4-2473229-3	44.0 ± 0.30	20.20 ± 0.15	1050	2100	6300
	1-2473229-3					
14	4-2473229-4	44.0 ± 0.30	20.20 ± 0.15	1050	2100	6300
	1-2473229-4					
15	4-2473229-5	44.0 ± 0.30	20.20 ± 0.15	1050	2100	6300
	1-2473229-5					

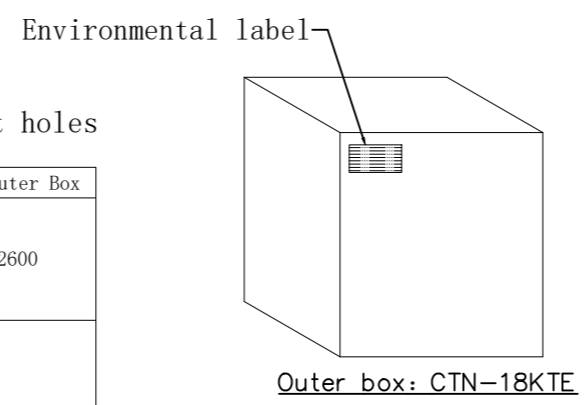

**No.4:**  
 Seal, pack, label.

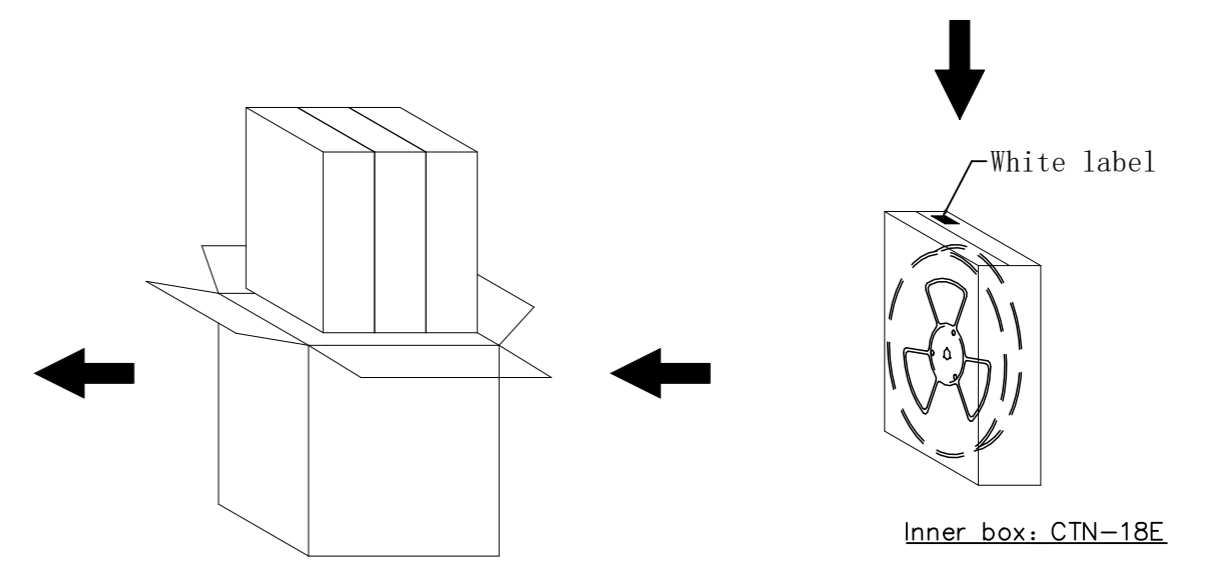

**No.3:**  
 Put inner box into outer box, (3pcs inner box/outer box) pay attention to the unified label direction.

**No.2:**  
 Pack the reel in the PE-33 waterproof bag packing, put 1pcs drying agent, seal it with vacuum machine and put it into the inner box, seal it with sealing glue, with labels.

THIS DRAWING IS A CONTROLLED DOCUMENT.		DWN GOWTHAM 20DEC23	TE Connectivity		
DIMENSIONS: mm		CHK CONNOR KANG			
TOLERANCES UNLESS OTHERWISE SPECIFIED:		APVD H.L 20DEC23	NAME		
0 PLC ± -		PRODUCT SPEC	WIRE TO BOARD MALE HEADER		
1 PLC ± -		APPLICATION SPEC	1.25MM PITCH, SMT STRAIGHI TYPE		
2 PLC ± 0.25		SIZE	CAGE CODE	DRAWING NO	RESTRICTED TO
3 PLC ± -		0	A3	00779	C-2473229
4 PLC ± -		CUSTOMER DRAWING			
ANGLES ± -		SCALE	SHEET	REV	
FINISH		1:1	2 OF 2	A	