

| P | LTR | DESCRIPTION | DATE | DWN | APVD |
|---|-----|---------------|-----------|-----|------|
| | A | ECN-24-249693 | 29JAN2024 | SS | RB |

NOTES

Bemerkungen

- 1 TE-CONNECTIVITY ORDER-NUMBER
TE-Connectivity Bestellnummer
- 2 CONNECTOR ISO 15170-A1-3.1-Sn/k1
Steckverbinder ISO 15170-A1-3.1-Sn/k1
- 3 DO NOT SWITCH UNDER LOAD!
Nicht unter Last schalten!

TECHNICAL DATA:
 MATERIAL: COVER.....VYNCOLIT BLACK
 BASE PLATE.....PA GF BLACK
 SWITCH LEVER.....PA GF RED
 MIN. INSULATION RESISTANCE.....100MΩ
 DIELECTRIC WITHSTAND RESISTANCE.....1050V-1min.
 MAX. CONTACT DROP DURING RESISTIVE LOAD.....150mV
 VOLTAGE.....UP TO 32VDC
 CONTINUOUS RATING.....500A
 OVERLOAD.....1500A-4min.
2000A-1.5min.
2500A-10sec.
 AUXILIARY CONTACT:
 CONTINUOUS CURRENT.....10A
 MAKE AND BRAKE.....24V L/R 5ms 10A
24V L/R 20ms 6A
 SEALING.....IP 67 / IEC 529
 VIBRATION.....4G / 50-2000Hz
 SHOCK.....6G / 11ms
 TEMPERATURE RANGE.....-40°C TO +85°C
 WIRE SECTION (AT NOMINAL LOAD).....MIN. 250mm²
 MOUNTING POSITION.....OPTIONAL
 SWITCH LEVER.....REMOVABLE
 MAX.TORQUE (MAIN CONTACTS).....18-22 Nm

Technische Daten:
 Werkstoff: Haube.....Vyncolit Schwarz
 Befestigungssockel.....PA GF Schwarz
 Schalthebel.....PA GF Rot
 Min. Isolationswiderstand.....100 MΩ
 Hochspannungsfestigkeit.....1050V-1Min.
 Max. Kontaktspannungsabfall bei Nennlast.....150mV
 Betriebsspannung.....bis 32 VDC
 Dauerstrom.....500A
 Überlast.....1500A-4min.
2000A-1,5min.
2500A-10 Sec.
 Hilfskontakt:
 Dauerstrom.....10A
 Schaltstrom.....24V L/R 5ms 10A
24V L/R 20ms 6A
 Schutzart.....IP67 / IEC 529
 Vibration.....4G / 50-2000Hz
 Schock.....6G / 11ms
 Umgebungstemperatur.....-40°C bis +85°C
 Anschlussquerschnitt bei Nennlast.....min. 250mm²
 Einbaulage.....beliebig
 Schalthebel.....abziehbar
 Max.Anzugsmoment (Hauptkontakte).....18-22Nm

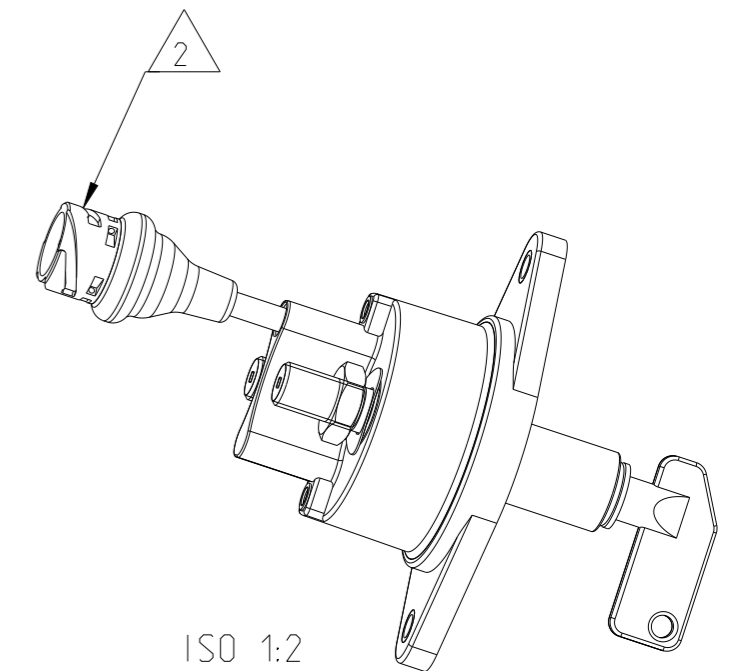

ISO 1:2

CIRCUIT Schaltbild

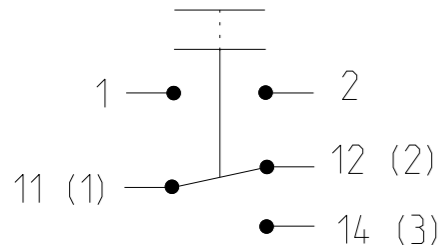

THIS DRAWING IS A CONTROLLED DOCUMENT.

| DIMENSIONS: | TOLERANCES UNLESS OTHERWISE SPECIFIED: |
|-------------|--|
| mm | DIN ISO 2768 cL |
| | 0 PLC ± |
| | 1 PLC ± |
| | 2 PLC ± |
| | 3 PLC ± |
| | 4 PLC ± |
| | ANGLES ± |
| | FINISH ± |

| | | | | | |
|----------------------|-------------|---|---|---|---------------------|
| K1155547 | 1 | A | BATTERY DISCONNECTOR 500A WITH AUX Batterietrennschalter 500A mit Hilfskontakt | 400 | 1 |
| TE ORDER-NO. | REV. | | DESCRIPTION | WEIGHT [g] | ITEM NO |
| DWN K.Seeger | 14 APR 2016 | | | BATTERY DISCONNECTOR 500A WITH AUX Batterietrennschalter 500A mit Hilfskontakt | |
| CHK K.Seeger | 28 APR 2016 | | | | |
| APVD U.Grindemann | 24 JUN 2019 | | | | |
| PRODUCT SPEC | | | NAME | | |
| APPLICATION SPEC | | | SIZE | CAGE CODE | DRAWING NO |
| WEIGHT | | | A3 | 00779 | 35-511-200-R-A5-900 |
| CUSTOMER DRAWING | | | SCALE | SHEET | REV |
| | | | 1:2 | 1 OF 1 | A |