

P	LTR	DESCRIPTION	DATE	DWN	APVD
	1	NEW LAYOUT	16MAR2020	RK	NJ

Part Number	Drawing	Dimensions (mm)										Weight (kg)	Terminals	Hexagon bolt	Washer
		a1	a2	b1	b2	b3	c1	c2	e	h					
ST2-250A/50MV	B	138	55	30	15	-	10	10	98	30	0.60	2 x 1	M12 x 40	13.0	
ST2-400A/50MV	B	138	55	40	20	-	10	10	98	30	0.85	2 x 1	M16 x 45	17.0	
ST2-600A/50MV	B	138	55	40	20	-	10	10	98	30	0.85	2 x 1	M16 x 45	17.0	
ST2-1000A/50MV	B	158	65	60	30	-	10	10	108	30	1.45	2 x 1	M20 x 50	21.0	
ST2-1500A/50MV	B	158	65	90	21	48	10	10	108	30	2.00	2 x 2	M16 x 45	17.0	
ST2-2000A/50MV	B	158	65	120	30	60	10	10	108	30	2.90	2 x 2	M20 x 50	21.0	
ST2-2500A/50MV	B	158	65	120	30	60	10	10	108	30	2.90	2 x 2	M20 x 50	21.0	
ST2-200A/60MV	B	145	55	30	15	-	10	10	105	30	0.60	2 x 1	M12 x 40	13	
ST2-250A/60MV	B	145	55	30	15	-	10	10	105	30	0.60	2 x 1	M12 x 40	13	
ST2-400A/60MV	B	145	55	40	20	-	10	10	105	30	0.85	2 x 1	M16 x 45	17	
ST2-600A/60MV	B	145	55	40	20	-	10	10	105	30	0.85	2 x 1	M16 x 45	17	
ST2-1000A/60MV	B	165	65	60	30	-	10	10	115	30	1.45	2 x 1	M20 x 50	21	
ST2-1500A/60MV	B	165	65	90	21	48	10	10	115	30	2.00	2 x 2	M16 x 45	17	
ST2-2000A/60MV	B	165	65	120	30	60	10	10	115	30	2.90	2 x 2	M20 x 50	21	
ST2-2500A/60MV	B	165	65	120	30	60	10	10	115	30	2.90	2 x 2	M20 x 50	21	
ST1-200A/75MV	B	160	55	30	15	-	10	10	120	30	0.63	2 x 1	M12 x 40	13	
ST2-250A/75MV	B	160	55	30	15	-	10	10	120	30	0.63	2 x 1	M12 x 40	13	
ST2-400A/75MV	B	160	55	40	20	-	10	10	120	30	0.92	2 x 1	M16 x 45	17	
ST2-600A/75MV	B	160	55	40	20	-	10	10	120	30	1.00	2 x 1	M16 x 45	17	
ST2-800A/75MV	B	180	65	60	30	-	10	10	130	30	1.75	2 x 1	M20 x 50	21	
ST2-1000A/75MV	B	180	65	60	30	-	10	10	130	30	1.75	2 x 1	M20 x 50	21	
ST2-1500A/75MV	B	180	65	120	30	60	10	10	130	30	2.30	2 x 2	M16 x 45	17	
ST1-200A/100MV	B	190	55	30	15	-	10	10	150	30	0.65	2 x 1	M12 x 40	13.0	
ST2-250A/100MV	B	190	55	30	15	-	10	10	150	30	0.65	2 x 1	M12 x 40	13.0	
ST2-400A/100MV	B	190	55	40	20	-	10	10	150	30	1.00	2 x 1	M16 x 45	17.0	
ST2-600A/100MV	B	190	55	40	20	-	10	10	150	30	1.11	2 x 1	M16 x 45	17.0	
ST2-1000A/100MV	B	210	65	60	30	-	10	10	160	30	2.00	2 x 1	M20 x 50	21.0	
ST2-1500A/100MV	B	210	65	120	30	60	10	10	160	30	2.50	2 x 2	M16 x 45	17.0	
ST2-200A/150MV	B	270	55	30	15	-	10	10	230	50	0.68	2 x 1	M12 x 40	13	
ST2-250A/150MV	B	270	55	30	15	-	10	10	230	50	0.68	2 x 1	M12 x 40	13	
ST2-400A/150MV	B	270	55	40	20	-	10	10	230	50	1.05	2 x 1	M16 x 45	17	
ST2-600A/150MV	B	270	55	40	20	-	10	10	230	50	1.16	2 x 1	M16 x 45	17	
ST2-1000A/150MV	B	290	65	70	35	-	10	10	240	60	2.15	2 x 1	M20 x 50	21	

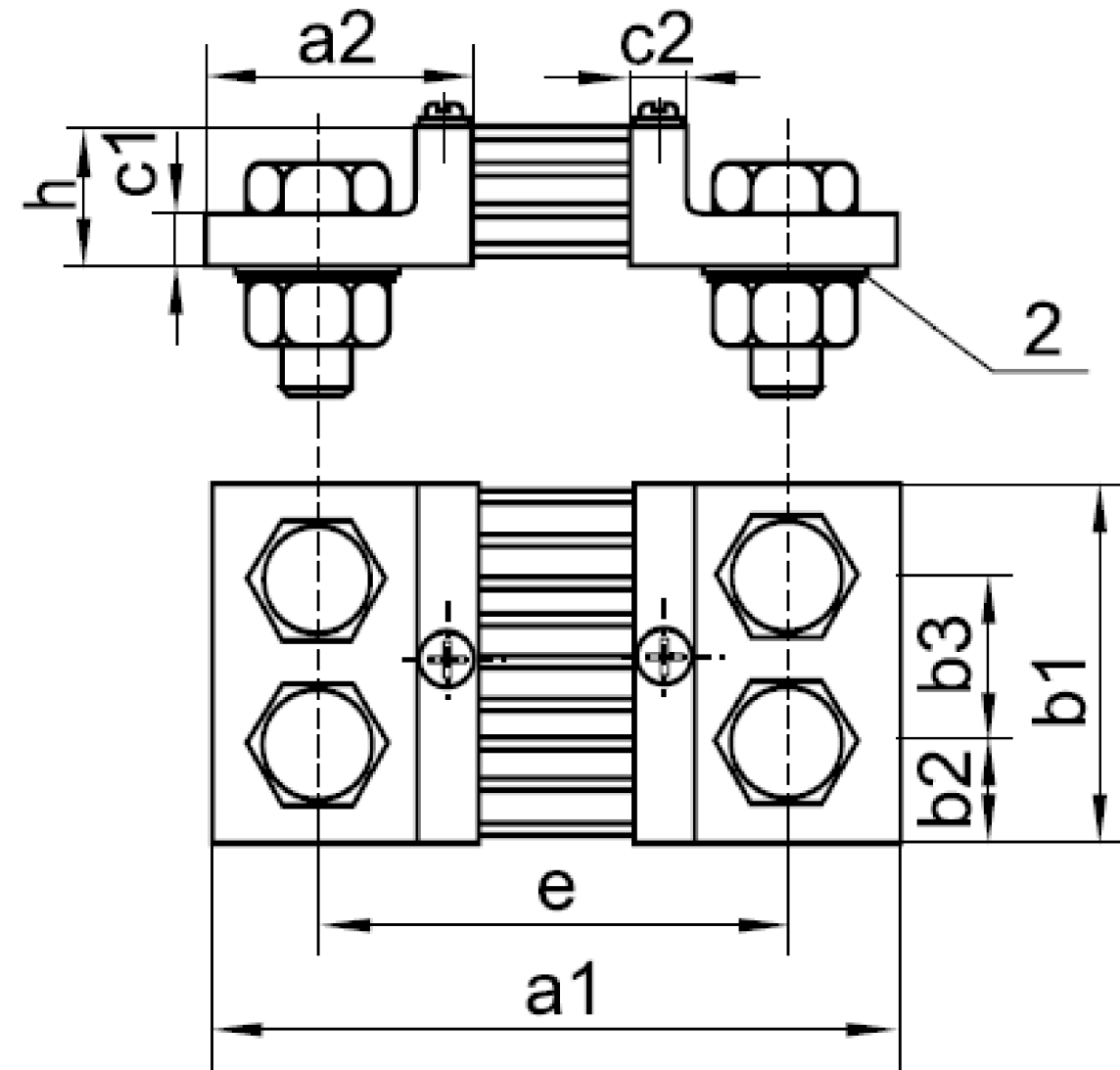

THIS DRAWING IS A CONTROLLED DOCUMENT.		DWN 16MAR2020 RAGHAVENDRA.K		TE Connectivity	
DIMENSIONS: mm		TOLERANCES UNLESS OTHERWISE SPECIFIED:			
		0 PLC	± -	NAME ST2 SHUNTS DIMENSIONAL DRAWING	
		1 PLC	± -		
MATERIAL		2 PLC	± -	PRODUCT SPEC -	
		3 PLC	± -		
FINISH		4 PLC	± -	APPLICATION SPEC -	
		ANGLES	± -		
-		-		SIZE	RESTRICTED TO
				A3	-
				CAGE CODE	DRAWING NO
				00779	3L44902
				WEIGHT	-
				CUSTOMER DRAWING	
				SCALE	1:1
				SHEET	1 OF 1
				REV	1