

PART NO	CABLE REF
93-3460-001-001-1	RAYCHEM 7528F5614

REV	DATE	APPRO	DESCRIPTION
0	7-93	CS	RELEASED; 93-299 CT

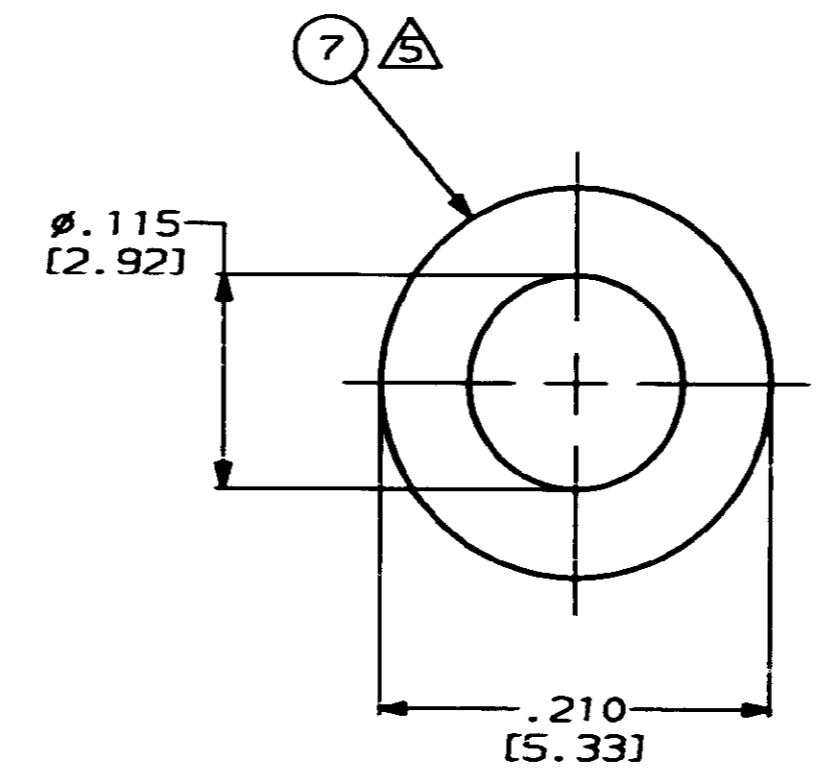

ASSEMBLED VIEW  
SCALE 5:1

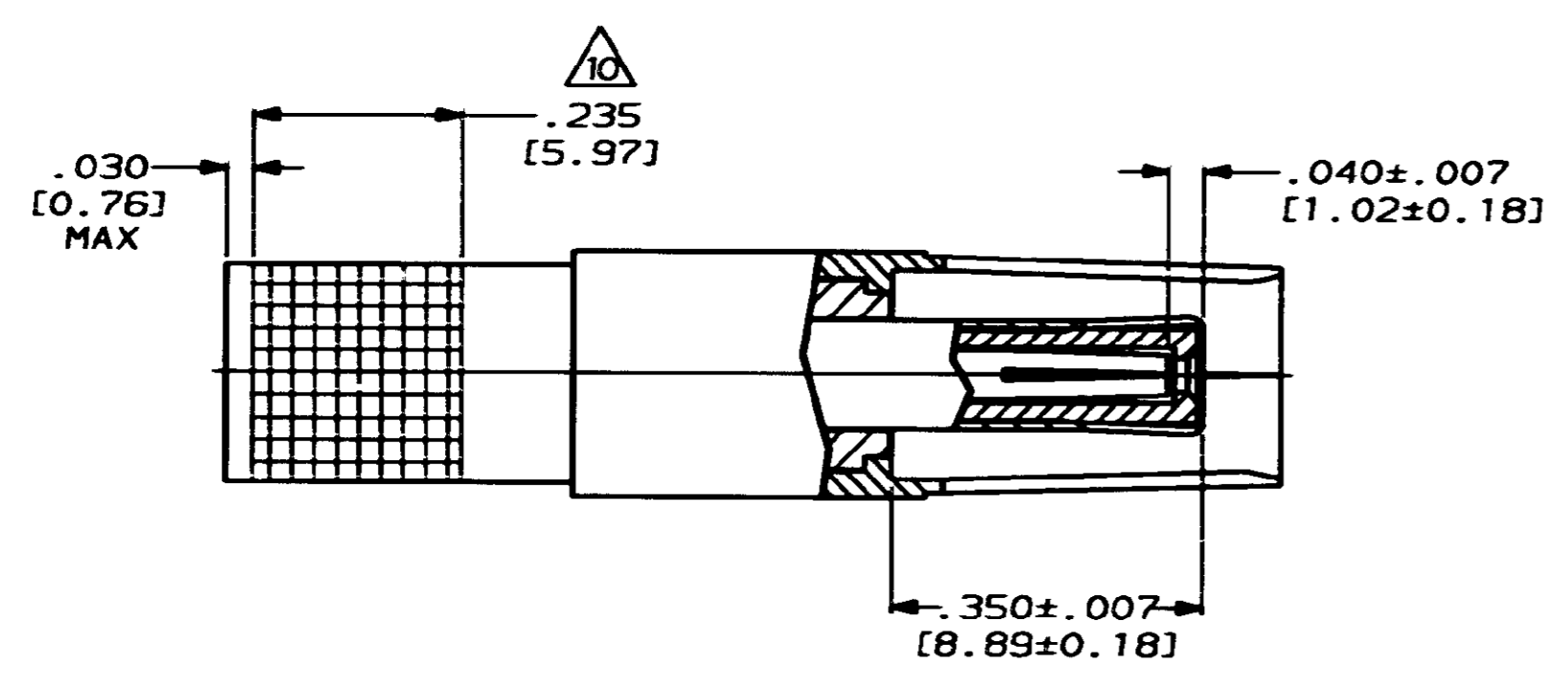
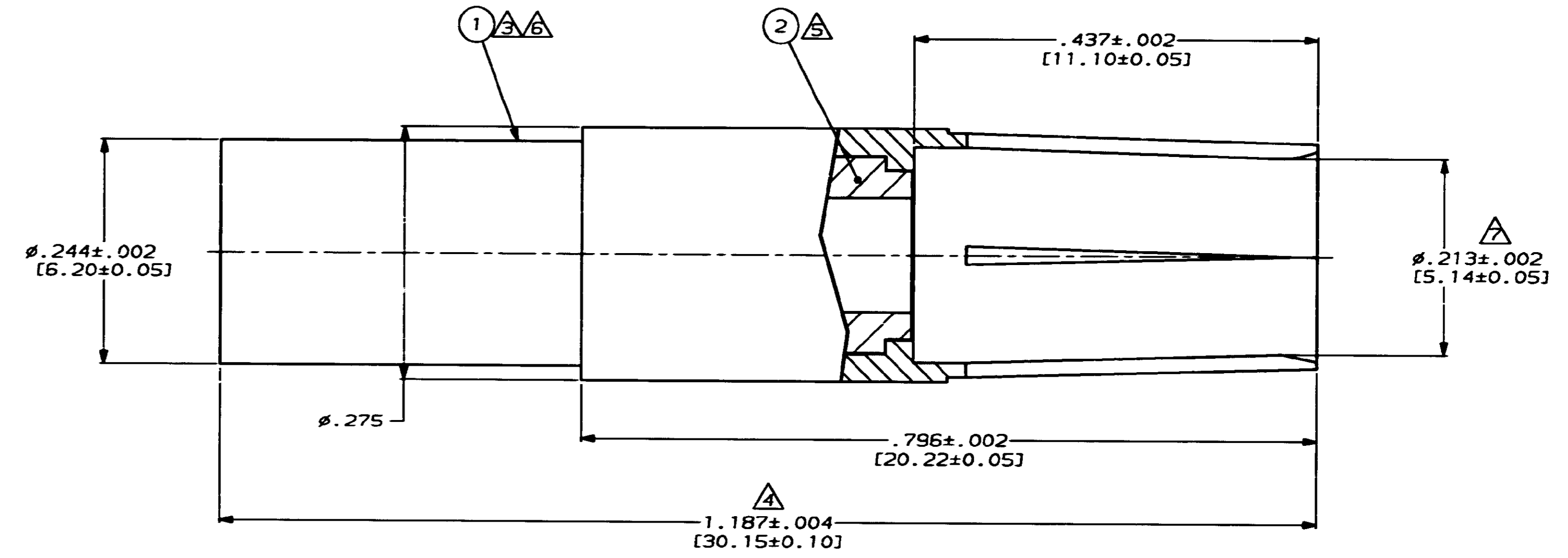
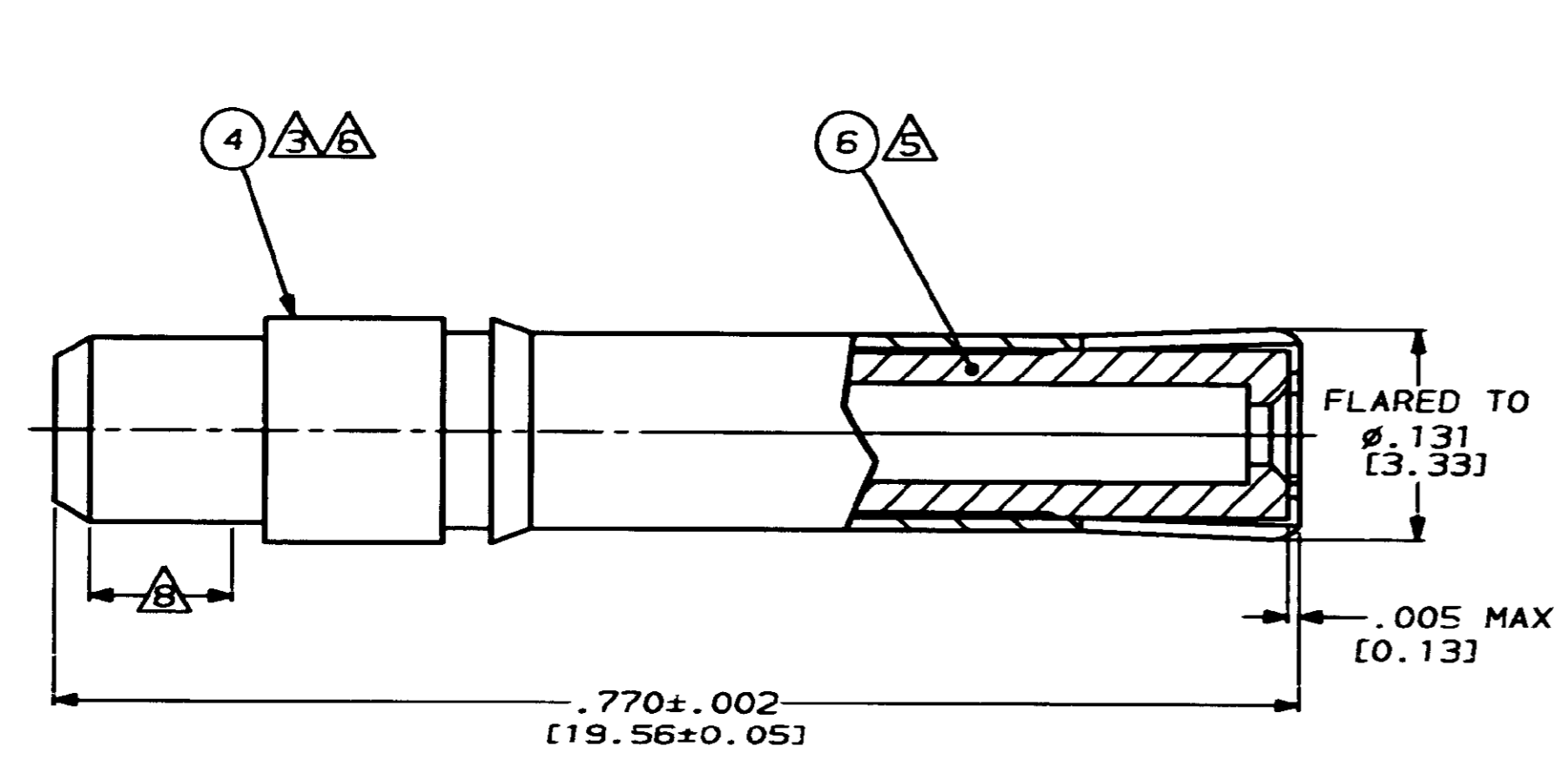
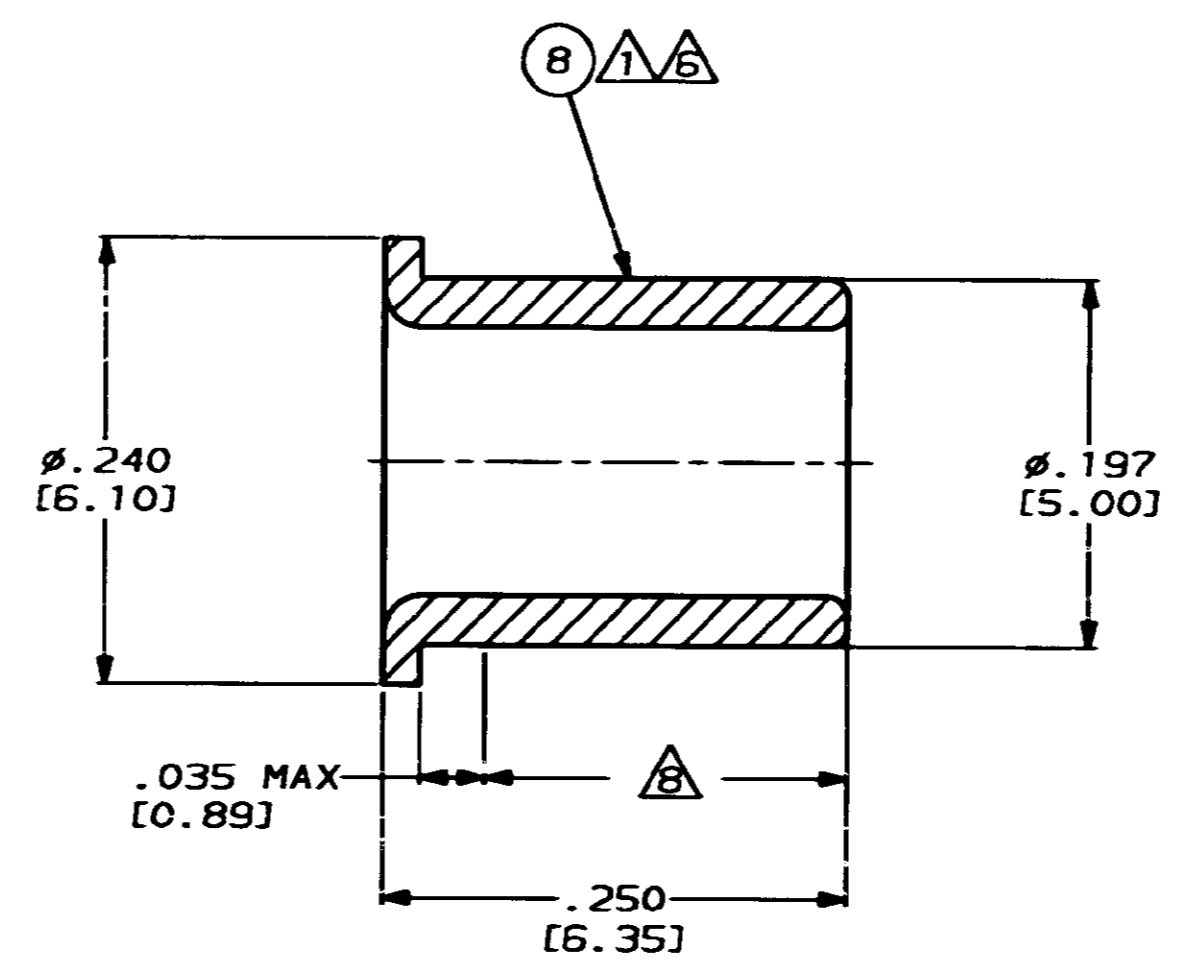
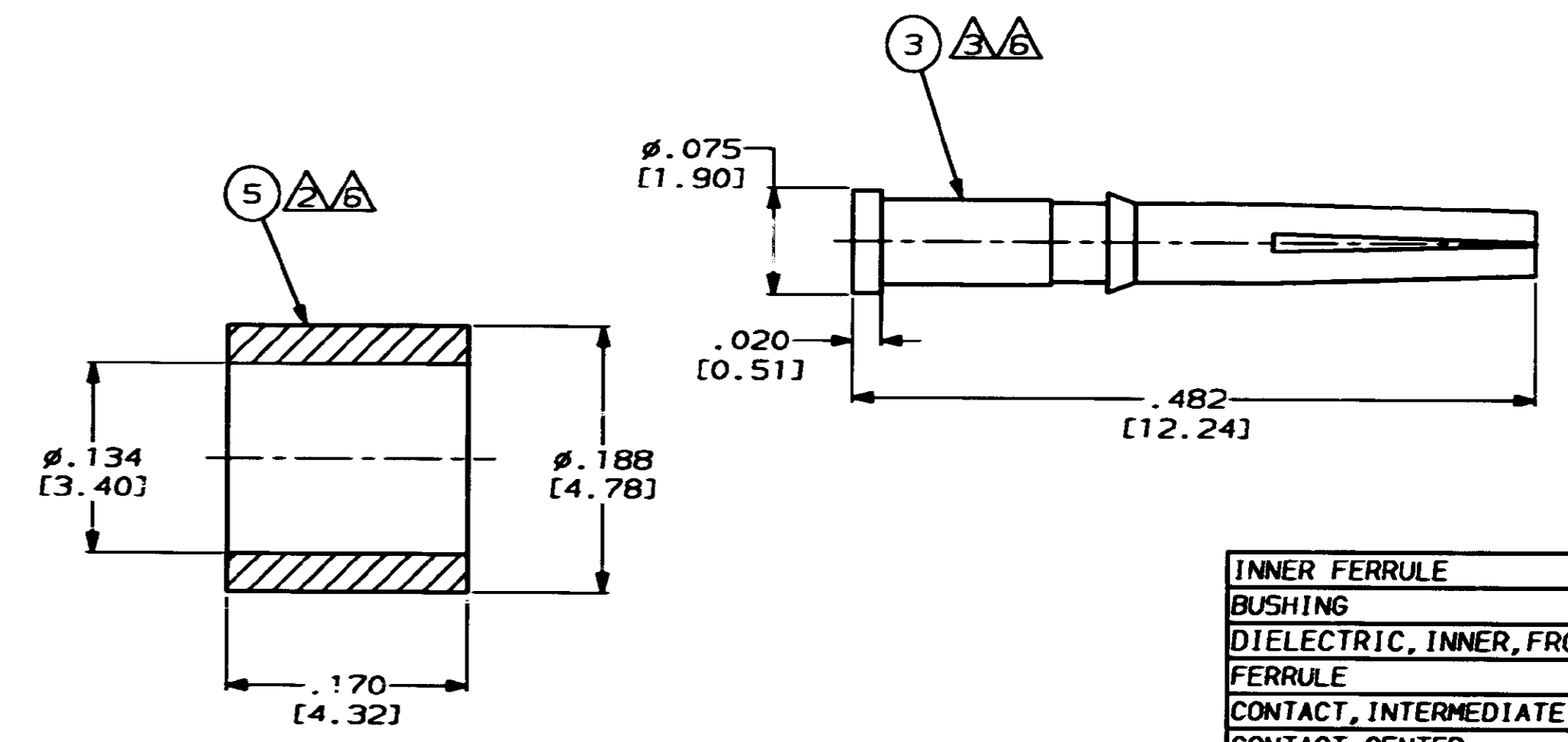

- ▲ MAT'L: BRASS PER ASTM-B-16
- ▲ MAT'L: COPPER PER ASTM-B-152.
- ▲ MAT'L: BERYLLIUM COPPER PER ASTM-B-196.
- ▲ 1.227 [31.17] MAX AFTER TERMINATION TO CABLE.
- ▲ MAT'L: PTFE PER ASTM-D-1710.
- ▲ FINISH: GOLD PLATE PER MIL-G-45204, TYPE 1, GRADE C, CLASS 1 OVER NICKEL .000050 [0.0013] THK PER QQ-N-290, CLASS 2.
- ▲ MATES WITH .220 ± .001 [5.59 ± 0.03] DIA PIN.
- ▲ 160 DP. FULL DIAMOND KNURL OVER THIS LENGTH.
- 9. USE HAND CRIMP TOOL #220066-2. POSITION 3 FOR CENTER CONTACT. DIE C FOR INTERMEDIATE CONTACT. DIE B FOR OUTER BODY.
- ▲ 10. CRIMP IN AREA SHOWN, DO NOT CRIMP .240 DIA OF ITEM #8 (FERRULE).

INNER FERRULE	8
BUSHING	7
DIELECTRIC, INNER, FRONT	6
FERRULE	5
CONTACT, INTERMEDIATE	4
CONTACT, CENTER	3
DIELECTRIC, OUTER, FRONT	2
SHELL	1
DESCRIPTION	ITEM NO

DO NOT SCALE PRINT. UNLESS SPECIFIED DIMENSIONS IN INCHES [mm]	OR 7-7-93 C.C. THOMAS	AMP Incorporated Harrisburg, PA 17105-3608
TOLERANCES ON: 2 PLC DEC ± .005 [0.13] ANGLES ±	CHK 7-7-93 C. SHELLY	
MATERIAL	APPD 7-7-93 C. SHELLY	NAME
SEE CALLOUTS	APPD 7-7-93 C.C. THOMAS	SOCKET ASSY, SIZE 5, TRIAX, ARINC-TRIAx
FINISH	PRODUCT SPEC 108-12092	SIZE
SEE CALLOUTS	APPLICATION SPEC	CAGE CODE
	WEIGHT	DRAWING NO
		00779
		SCALE
		10:1
		SHEET
		1 OF 1

THIS DRAWING IS A CONTROLLED DOCUMENT FOR AMP INCORPORATED. IT IS SUBJECT TO CHANGE AND THE CONTROLLING ENGINEERING ORGANIZATION SHOULD BE CONTACTED FOR THE LATEST REVISION.