

4

3

2

1

THIS DRAWING IS UNPUBLISHED.

RELEASED FOR PUBLICATION

© COPYRIGHT

ALL RIGHTS RESERVED.

LOC DIST

REVISIONS

P	LTR	DESCRIPTION	DATE	DWN	APVD

REPLACED BY OCEAN STYLE APPLICATOR PART NUMBER

FOR REPLACEMENT PARTS FOR APPLICATOR REFER TO ADDITIONAL PAGE(S). SPARE PARTS KIT (IF LISTED) WILL REMAIN AVAILABLE.

THE REPLACEMENT OCEAN STYLE APPLICATOR HAS THE SAME TERMINATOR/PRESS INTERFACE AS APPLICATOR

THIS DRAWING IS A CONTROLLED DOCUMENT.		DWN	 TE Connectivity		
DIMENSIONS:		CHK			
TOLERANCES UNLESS OTHERWISE SPECIFIED:		APVD	NAME		
 <ul style="list-style-type: none"> 0 PLC ± 1 PLC ± 2 PLC ± 3 PLC ± 4 PLC ± ANGLES ± 		PRODUCT SPEC	RESTRICTED TO		
		APPLICATION SPEC	SIZE	CAGE CODE	DRAWING NO
MATERIAL	FINISH	WEIGHT	A3	C-	
		SCALE	SHEET	OF	REV

THIS DRAWING IS A CONTROLLED DOCUMENT.

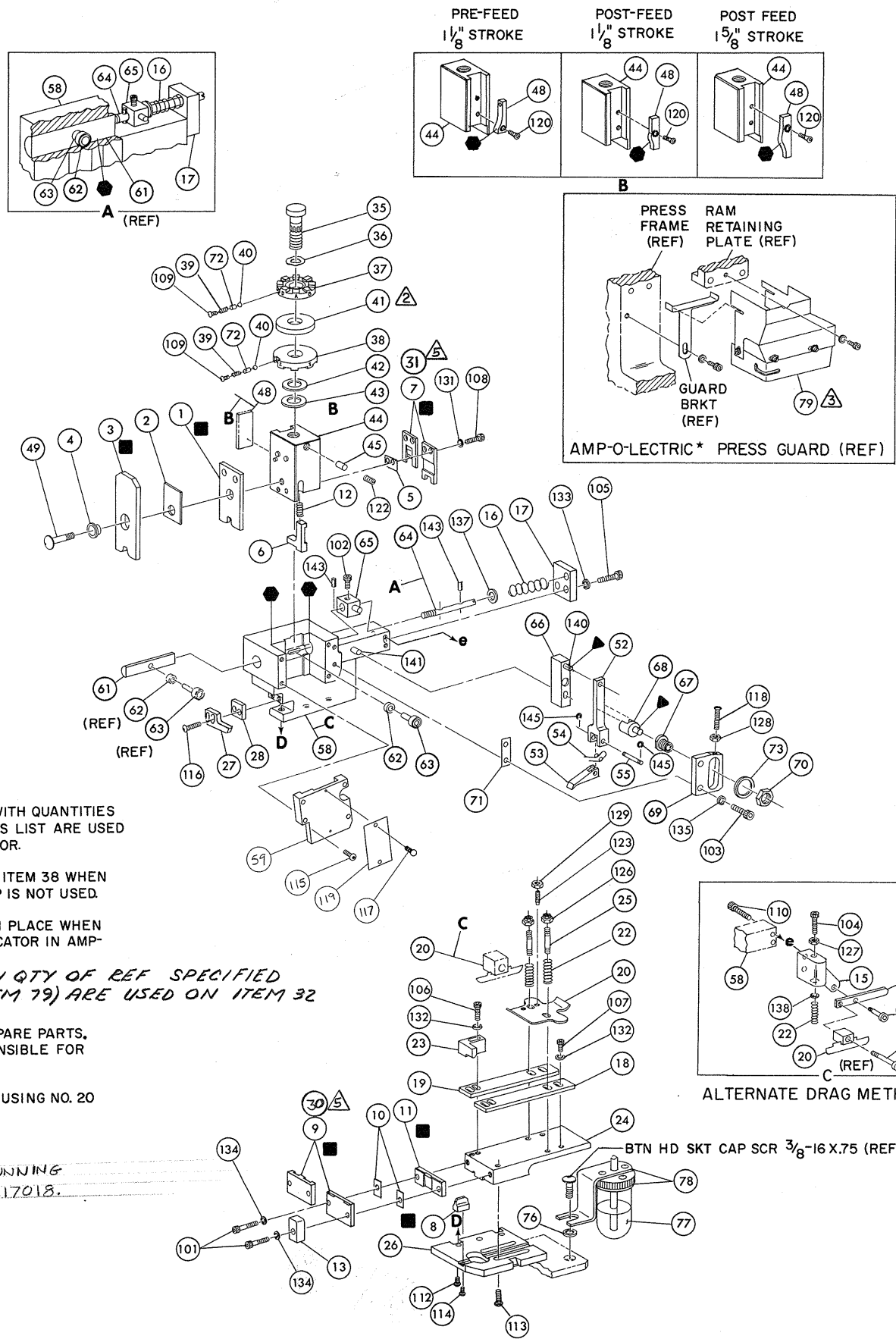

NOTES:

- 1. ONLY THE ITEMS WITH QUANTITIES SPECIFIED ON PARTS LIST ARE USED ON THIS APPLICATOR.
 - △ USED IN PLACE OF ITEM 38 WHEN INSULATION CRIMP IS NOT USED.
 - ▲ GUARD MUST BE IN PLACE WHEN OPERATING APPLICATOR IN AMP-O-LECTRIC PRESS.
 - 4. PARTS WITH QTY OF REF SPECIFIED (EXCEPT ITEM 79) ARE USED ON ITEM 32.
- KEY:
- RECOMMENDED SPARE PARTS, CUSTOMER RESPONSIBLE FOR REPLACEMENT.
 - ▲ LUBRICATE DAILY USING NO. 20 MACHINE OIL.
 - GREASE LIGHTLY.
 - △ USE WHEN RUNNING TERMINAL # 1217018.

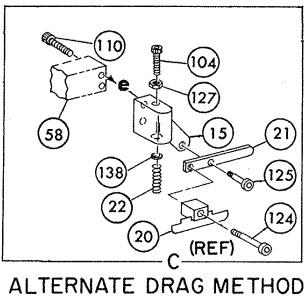

REF	21045-3	RING, RETAINING 'C' (.187 DIA) FEED PIN	145	REF	454220-1	CAP, RAM	59
REF	5-21028-1	PIN, SLOT SPG (.12 DIA X .50) FD ADJ ROD	143	REF	453736-1	HOUSING	58
REF	1-21030-7	PIN, DOWEL (.187 DIA X 1.50) HOUSING	142				57
REF	1-21030-1	PIN, DOWEL (.187 DIA X .50) LEVER	141	REF	240624-1	PIN, FEED FINGER	55
				REF	691499-1	SPRING, FEED FINGER	54
				REF	240635-1	FINGER, FEED	53
				REF	240634-3	LEVER, TERMINAL	52
							51
							50
REF	21024-5	WASHER, LOCK (NO 10) FEED ADJ PLATE	135	1	7-21002-9	BOLT, CRIMPER	49
2	21024-5	WASHER, LOCK (NO 10) SHEAR PLATES	134	1	690602-5	CAM, PRE FEED 1/8 STROKE	48
REF	21024-5	WASHER, LOCK (NO 10) FEED ROD GUIDE	133				47
4	21024-4	WASHER, LOCK (NO 8) STRIP GUIDE	132				46
2	21024-4	WASHER, LOCK (NO 8) SHEAR BLADE	131	1	690191-1	PLUG, NYLON	45
			130	1	455674-1	RAM	44
2	21018-4	NUT, HEX MACH (4-40) DRAG	129	1	690125-1	WASHER, LAMINATED	43
REF	21068-5	NUT, HEX MACH (6-32) FD ADJ PLATE	128	1	690124-1	WASHER, RAM	42
			127				41
2	21022-2	NUT, HEX SELF-LKG (8-32) DRAG STUD	126	2	23241-6	BALL, STEEL	40
			125	2	690170-1	SPRING, COMPRESSION	39
			124	/	690142-1	DISC, INSULATION	38
2	4-21078-8	SCR, SKT HD SHLD (250 DIA X .25) DRAG ARM	123	1	5-690141-6	DISC, WIRE	37
1	21009-2	SCR, SKT SET (1/4-20 X 25) (LOC-WEL) RAM	122	1	22480-5	WASHER, SPRING	36
			121	1	690212-1	POST, RAM	35
			120				34
1	461264-1	ID PLATE	119				33
REF	3-21064-2	SCR, RD HD MACH (6-32 X 1.50) FEED ADJ	118	/	458980-2	APPLICATOR, BASIC (SUB ASSY)	32
2	21017-2	SCR, DRIVE (#2 X .19) ID PLATE	117	1	690474-7	BLADE, SLUG	31
2	2-21002-2	SCR, BTN HD SKT CAP (8-32 X .50) STRIPPER	116	1	1-690496-0	PLATE, FRONT SHEAR	30
REF	2-21002-9	SCR, BTN HD SKT CAP (10-32 X .75) HSG CAP	115				29
1	22733-8	SCR, BTN HD SKT CAP (8-32 X .38) (LOC-WEL) ANVIL	114	/	3-690451-2	SPACER, STRIPPER	28
4	3-21002-3	SCR, BTN HD SKT CAP (1/4-20 X .50) STR GDE PL	113	/	240639-1	STRIPPER	27
REF	2-22733-9	SCR, BTN HD SKT CAP (1/4-20 X .75) BASE PL	112	REF	455676-1	PLATE, BASE	26
			111	2	22354-8	DRAG, STUD	25
			110	1	455678-2	PLATE, STRIP GUIDE	24
			109				23
2	23030-1	SCR, SKT HD CAP (6-32 X .25) (LOC-WEL) CP DISC	108	2	4-22281-1	SPRING, DRAG	22
2	2-21000-7	SCR, SKT HD CAP (8-32 X .50) SHEAR BLADE	107	-	240636-1	LEVER, DRAG	21
3	2-21000-6	SCR, SKT HD CAP (8-32 X .38) STRIP GUIDE	106	1	454177-1	DRAG, STOCK	20
1	2-21000-6	SCR, SKT HD CAP (8-32 X .38) STRIP GUIDE	105	1	1-458030-5	GUIDE, STRIP (REAR)	19
REF	3-21000-7	SCR, SKT HD CAP (10-32 X .75) FD ROD GUIDE	104	1	1-458031-5	GUIDE, STRIP (FRONT)	18
			103	REF	454178-1	GUIDE, FEED ROD	17
REF	3-21000-9	SCR, SKT HD CAP (10-32 X 1.00) DRAG SPRING	102	REF	4-22284-9	SPRING, FEED RETURN	16
REF	3-21000-4	SCR, SKT HD CAP (10-32 X .38) PIVOT BLK	101				15
2	3-21002-0	SCR, BTN HD CAP (10-32 X .88) SHEAR PLATE	100				14
REF	455745-1	GUARD, WINDOW	79				13
			78	1	690481-5	SPACER, HOLD DOWN	12
			77	1	23846-1	SPRING, HOLD DOWN	11
			76	1	240833-7	PLATE, REAR SHEAR	10
			75				9
			74	1	690496-7	SPACER, SHEAR PLATE	8
REF	458109-1	WASHER, FLAT (SPECIAL)	73	1	6-238005-7	PLATE, FRONT SHEAR	7
2	690603-1	SPRING, ASSIST	72	1	1-690474-9	ANVIL	6
REF	690517-1	SPACER	71	1	455892-3	BLADE, SLUG	5
REF	22594-8	NUT, HEX	70	1	2-240641-4	HOLD DOWN, TERMINAL	4
REF	240628-1	PLATE, ADJ	69	1	238009-1	SPACER, SHEAR BLADE	3
REF	240626-1	SHAFT, PIVOT	68	1	456134-1	SPACER, TUBULAR	2
REF	240633-1	BUSHING	67	1	455888-6	CRIMPER, INSULATION	1
REF	455680-1	LEVER, INTERMEDIATE	66	1	456421-2	SPACER, INSULATION	
REF	240629-1	BLOCK, PIVOT	65				
REF	240632-2	SCREW, ADJ	64				
REF	240659-3	PIN, CAM ROLLER	63				
REF	240658-1	CAM, ROLLER	62				
REF	454398-1	ROD, FEED	61				

CRIMPING DATA				APPLICATOR WILL APPLY	
PAD LTR	CRIMP HEIGHT	WIRE SIZE	WIRE STRIP LENGTH		
A	.069	18			640204
B	.065	20			640271
C	.063	22			1217018
D	NOT USED				
CRIMP	SIZE	TYPE	FEED	APPL INST	
WIRE	.100	F	.827	A1 8039	
INSUL	.180	F			
WIRE RANGE	18-22	INSULATION RANGE	0.080-0.120	PRESS NO	565435-5

REMARKS	NO	REV
	TO APPLY TERMINAL	SPEC 114-2084
APPL USED ON MACHINE PART NO	MACH SERIAL NO	DISTRIBUTION
CUSTOMER NAME	APPL SERIAL NO	ORIGINAL
ADDRESS	PURCHASE ORDER	CUSTOMER COPY
CITY	ENG APP	FIELD ENG COPY