

| REVISIONS | | | | | |
|-----------|-----|---------------------------|-----------|-----|------|
| P | LTR | DESCRIPTION | DATE | DWN | APVD |
| G3 | | REVISED PER ECR-22-139600 | 29NOV2022 | DB | FF |

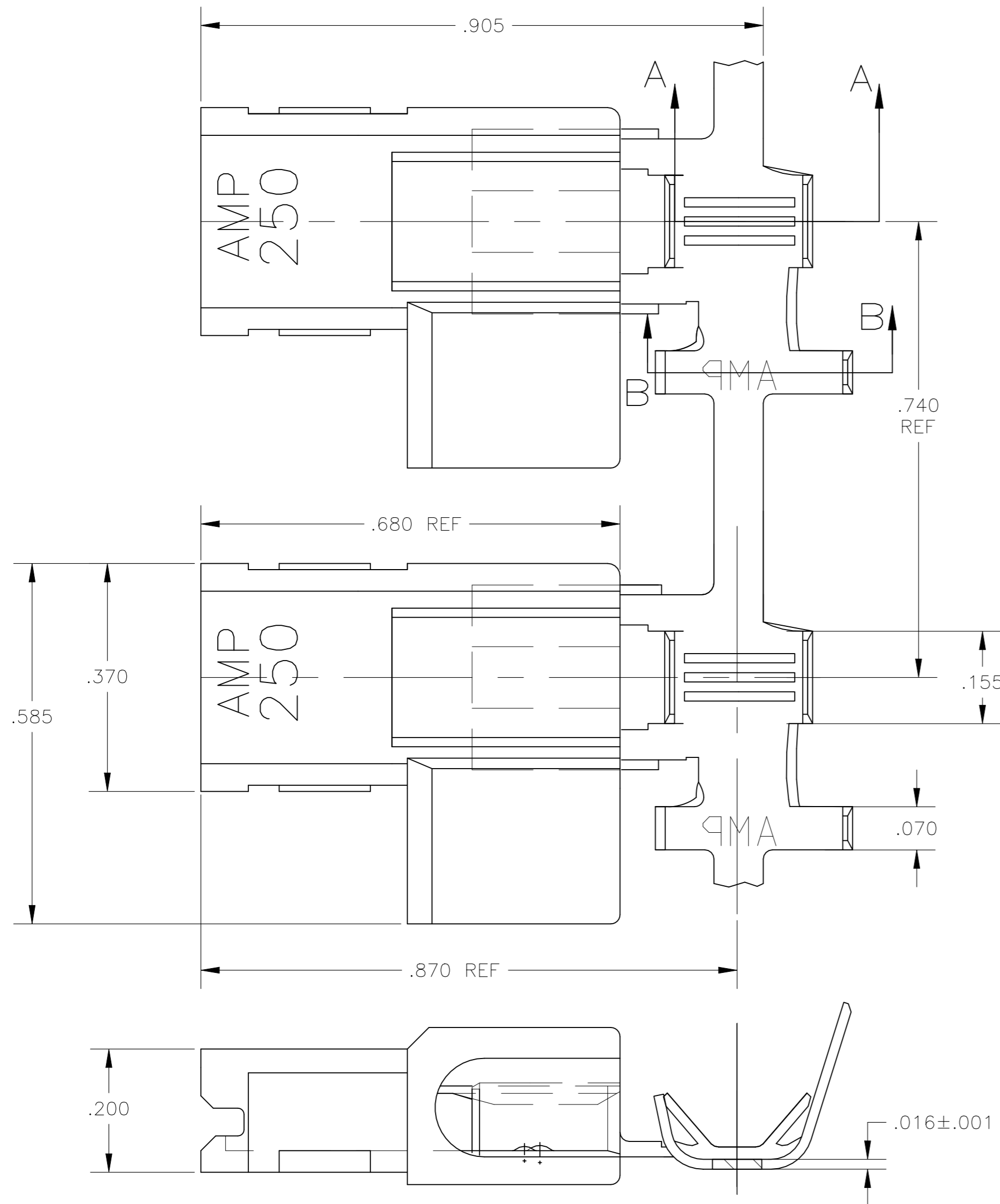

- 2 INSULATION RANGE TO BE .110-.160 OR TWO AT .110 MAX DIA.
- 3 WIRE SIZE IS [#18-#14 OR TWO #20'S OR TWO #18'S].
- △ ALTERNATE HOUSING FORM
- 5 FITS .250x.032 THICK FASTON TAB.

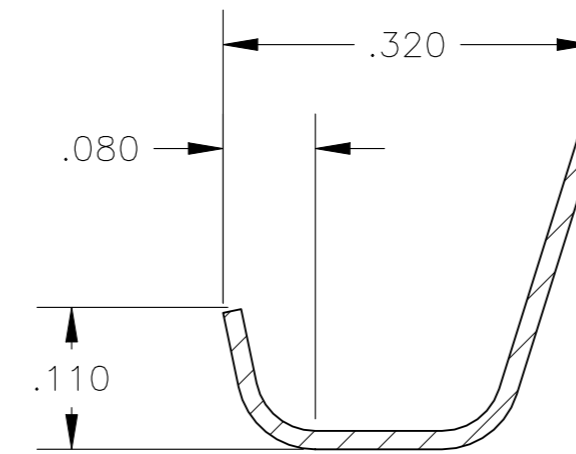

SECTION B-B

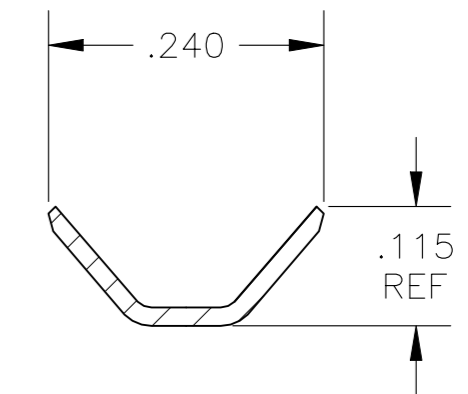

SECTION A-A

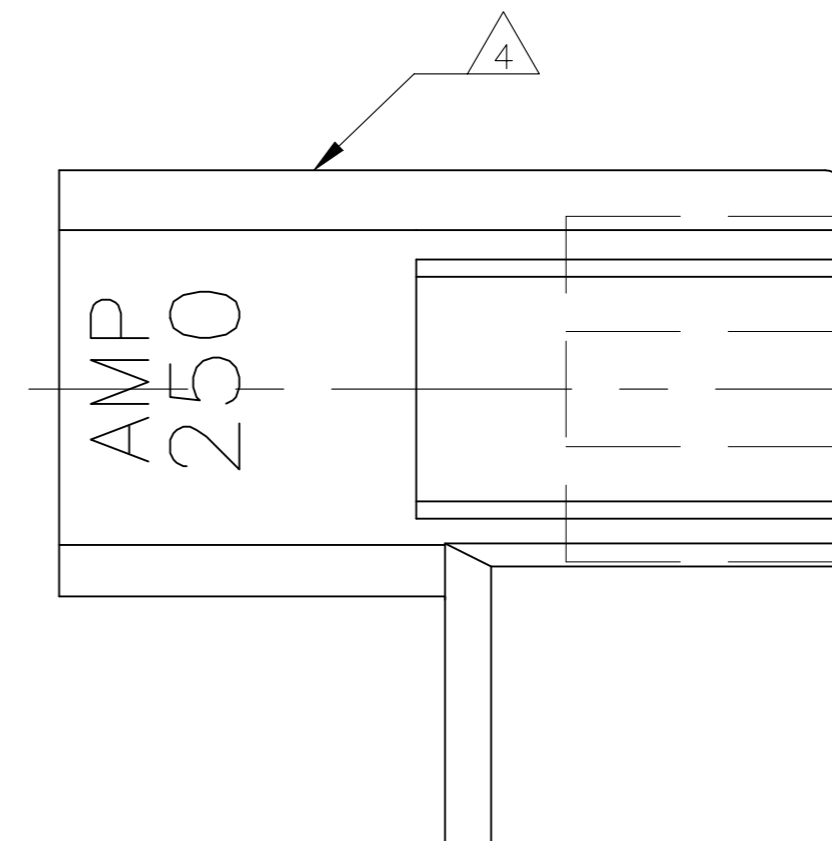

SUPERSEDED BY 521633-2

| | | | | | |
|--|--|----------------------------|-----------------------------|--|---------------------|
| 6/6 NYLON, VO / NATURAL | | BRASS / TIN PLATED | | 521633-2 | |
| 6/6 NYLON, VO / NATURAL | | BRASS / PLAIN | | 521633-1 | |
| HOUSING MATERIAL / COLOR | | TERMINAL MATERIAL / FINISH | | PART NO | |
| THIS DRAWING IS A CONTROLLED DOCUMENT. | | | DWN JR RUTH 08MAY03 | | |
| DIMENSIONS: INCHES | | | CHK J HUMMEL 08MAY03 | | |
| TOLERANCES UNLESS OTHERWISE SPECIFIED: | | | APVD J HUMMEL 08MAY03 | NAME | |
| 0 PLC ± - 1 PLC ± - 2 PLC ± - 3 PLC ± .010 4 PLC ± - ANGLES ± - | | | PRODUCT SPEC 108-1285 | ASSEMBLY, RECEPTACLE, FLAG, ULTRA-POD, .250 SERIES | |
| MATERIAL SEE TABLE | | | FINISH SEE TABLE | 114-2124 | RESTRICTED TO |
| WEIGHT 0.000000 | | | SIZE A2 | CAGE CODE 00779 | DRAWING NO C=521633 |
| CUSTOMER DRAWING | | | SCALE 6:1 | SHEET 1 of 1 | REV G3 |