

RECOMMENDED CIRCUIT PATTERN
 PER IPC-D300 TYPE II, CLASS C
 (COMPONENT SIDE)

- ① HOUSING MATERIAL: LIQUID CRYSTAL POLYMER, COLOR: NATURAL.
- ② CONTACT MATERIAL: PHOSPHOR BRONZE
- ③ CONTACT FINISH:(D)
 UNDERPLATE (ENTIRE CONTACT):
 0.00127 MIN NICKEL PER SAE-AMS-QQ-N-290
 ON MATING SURFACES:
 FLASH GOLD PER ASTM B 488, OVER
 0.00076 MIN PALLADIUM-NICKEL OVER UNDERPLATE, OR
 0.00076 MIN GOLD PER ASTM B 488 OVER UNDERPLATE.
 ON LEADS:
 0.00127 MIN MATTE TIN PER ASTM B 545 OVER UNDERPLATE.
 LUBRICATION (MIN MATING SURFACES):
 SURFACE CONDITIONER AFTER PLATING.
- ④ PART MARKING LOCATED APPROXIMATELY AS SHOWN.

ROW	D	AC		AC		
C		AB		AB		
B		AA		AA		
A		AC		AC		
	1	2	3	4	5	6
POWER POSITION						

CODE LETTER	MATING POST LENGTH ±0.1	LEAD LENGTH (REF)
AA	6.5	4.25
AB	7.25	4.25
AC	8	4.25

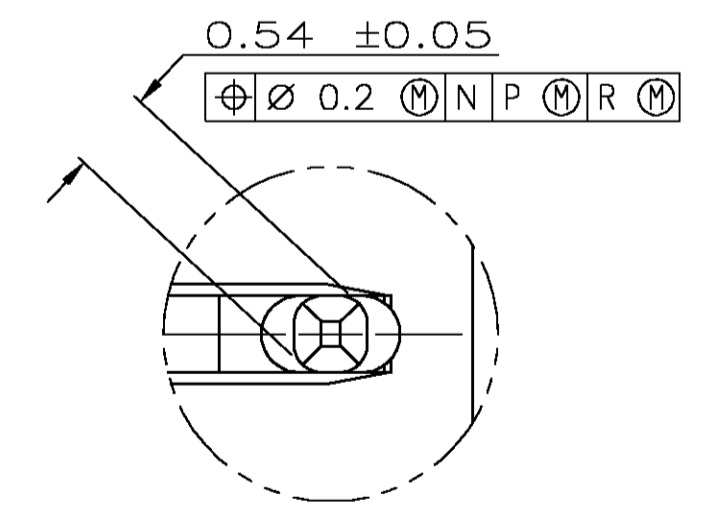

DETAIL Z
 SCALE 20:1

6	1	10	5	11.88	③	8	5536634-1
E	D	C	B	A	FINISH	NO OF POWER POSN	PART NUMBER
THIS DRAWING IS A CONTROLLED DOCUMENT.		DMN R. BUCHHEISTER 23/OCT/98	Tyco Electronics Corporation		Harrisburg, Pa 17105-3608		
DIMENSIONS: mm [INCHES]		CHK K. DUSCHA 23/OCT/98	APVD K. DUSCHA 23/OCT/98		NAME		
TOLERANCES UNLESS OTHERWISE SPECIFIED:		PRODUCT SPEC		ASSEMBLY, PIN, POWER, VERTICAL, Z-PACK 2mm FB, 4 ROW, PRESS FIT LEADS, SEQUENCED			
0 PLC ± -		APPLICATION SPEC		SIZE			
1 PLC ± -		MATERIAL		CAGE CODE			
2 PLC ± 0.13[.005]		FINISH		DRAWING NO			
3 PLC ± -		MATERIAL		WEIGHT			
4 PLC ± -		FINISH		A1 00779 C=5536634			
ANGLES ± -		MATERIAL		CUSTOMER DRAWING			
RESTRICTED TO		SCALE 4:1		SHEET 1 OF 1		REV 0	