

THIS DRAWING IS UNPUBLISHED. RELEASED FOR PUBLICATION, 19 .  
 © COPYRIGHT 19 BY AMP INCORPORATED. ALL INTERNATIONAL RIGHTS RESERVED.

LOC	DIST	P	F	REVISIONS				
EY	25			ZONE	LTR	DESCRIPTION	DATE	APPD
					D	REV; EC 0230-0067-95	3-28-95	WC DH

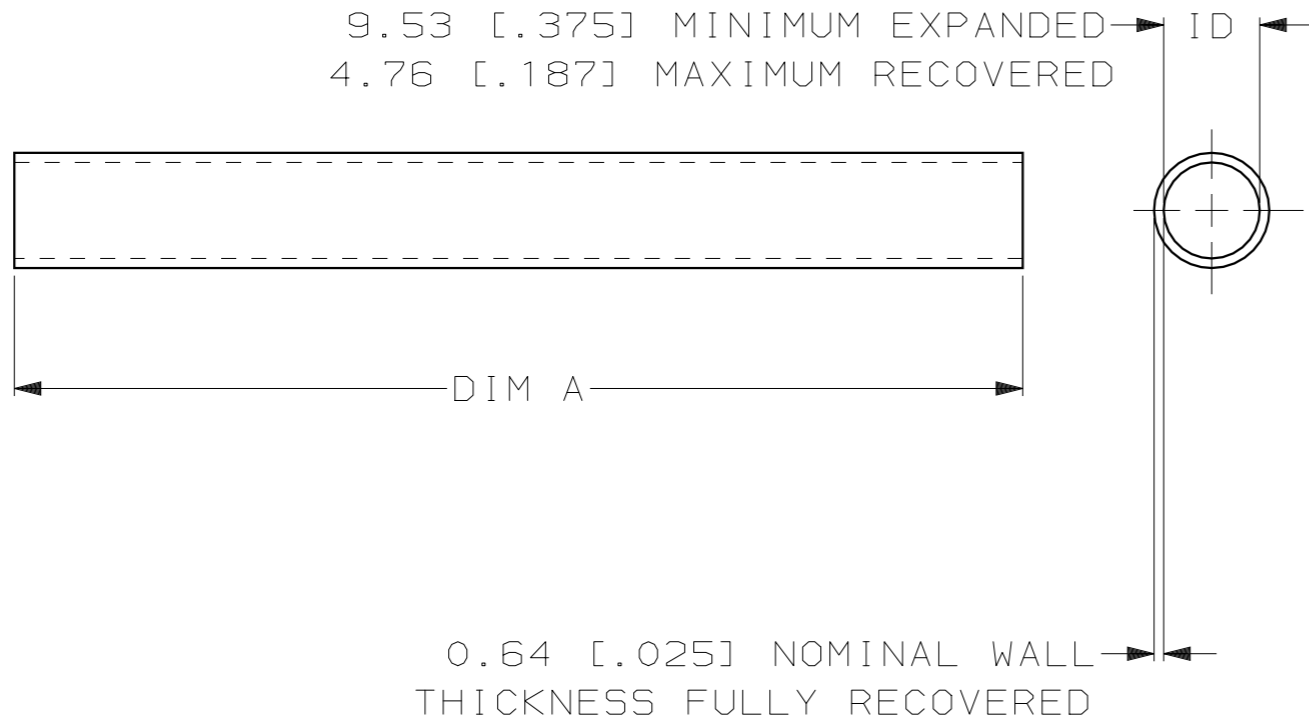

- TUBING MEETS REQUIREMENTS OF MIL-I-23053/5-207-C.
- WEIGHT PER LINEAR FOOT/304.8 mm: 2.522 GRAMS/ .0056 POUND.

60.96 M [200 FEET] MINIMUM		603346-2
1219.2 ±12.7 [48.00 ±.50]		603346-1
DIM A (LENGTH)		PART NO
DO NOT SCALE PRINT. UNLESS SPECIFIED DIMENSIONS IN mm [INCHES] TOLERANCES ON: 2 PLC DEC ± - 3 PLC DEC ± - ANGLES ± -	DR 7-18-94 W CHANDLER	AMP Incorporated Harrisburg, PA 17105-3608 NAME AMPSULATION FP21, 3/8 INCH ID, CLEAR
	CHK 10-13-94 D HUSSEY	
	APPD 10-13-94 D KAAT	
	APPD 10-13-94 F HARNED	
MATERIAL CLEAR POLYOLEFIN	PRODUCT SPEC -	SIZE B
FINISH -	APPLICATION SPEC -	CAGE CODE 00779
	WEIGHT $\triangle 2$	DRAWING NO C-603346
		SCALE NONE
		SHEET 1 OF 1

THIS DRAWING IS A CONTROLLED DOCUMENT FOR AMP INCORPORATED. IT IS SUBJECT TO CHANGE AND THE CONTROLLING ENGINEERING ORGANIZATION SHOULD BE CONTACTED FOR THE LATEST REVISION.