

REVISIONS					
P	LTR	DESCRIPTION	DATE	DWN	APVD
	J3	REVISED PER ECR-24-210890	22AUG2024	DB	BW
	J2	REVISED PER ECO-09-021826	21AUG09	KK	AEG

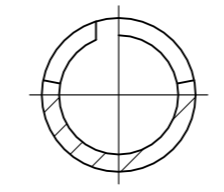

SECTION A-A

- 1 CONTINUOUS STRIP ON REELS.
- 2 0.00508[.000200] MIN SILVER OVER 0.00254[.000100] MIN COPPER UNDERPLATE OR 0.00127[.000050] MIN NICKEL UNDERPLATE.
- 3 WIRE RANGE: 18-14 AWG
- 4 INSULATION RANGE: 2.16-3.18 [.085-.125] DIA.
- 5 OBSOLETE PARTS: OBSOLETE CIS STREAMLINING PER D.RENAUD/D.SINISI

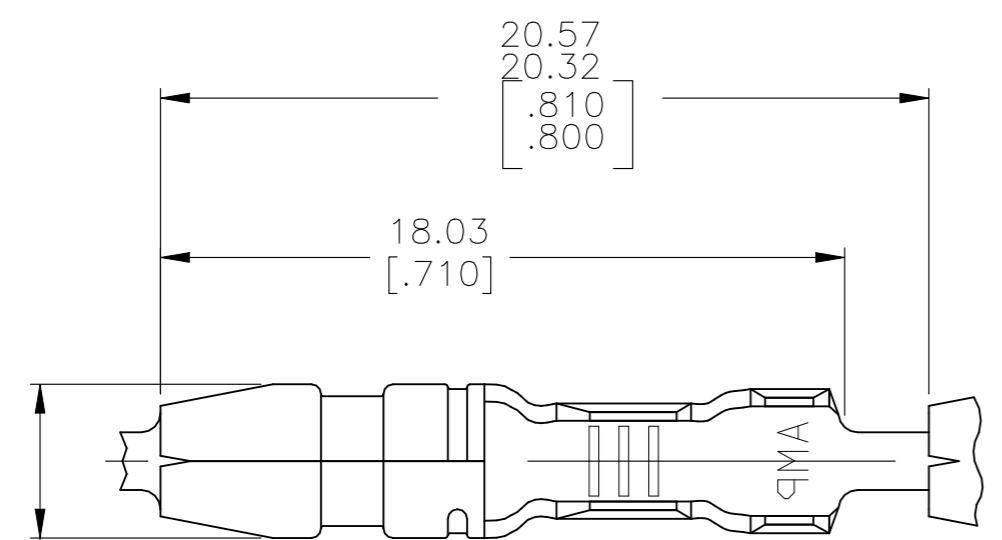
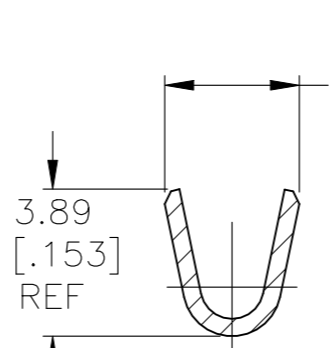
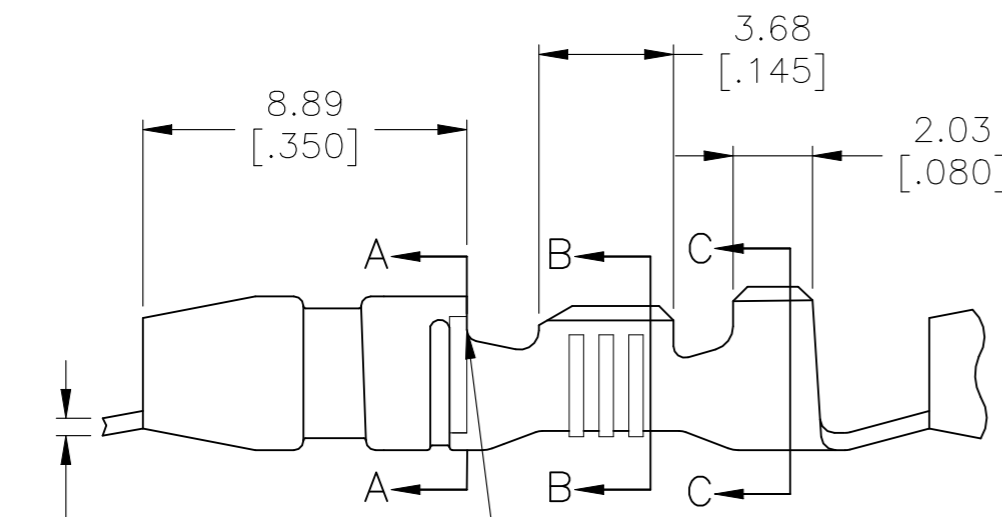

SECTION B-B

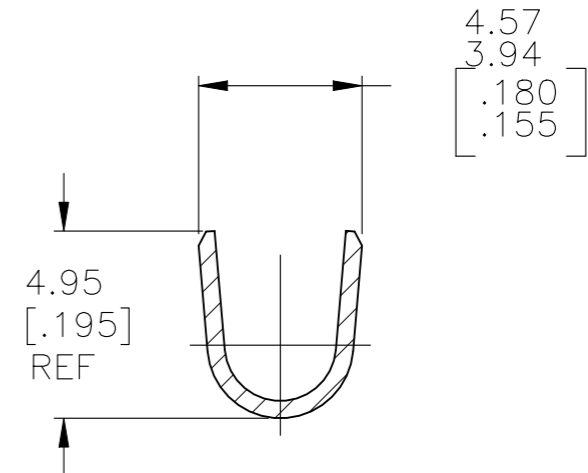

SECTION C-C

CLOSED FOR MOLDING PURPOSE

5	OBSOLETE	2	BRASS	-60766-4
			PRE-TIN	60766-2
			NONE	60766-1
			FINISH	MATERIAL

THIS DRAWING IS A CONTROLLED DOCUMENT.		DWN RAGHAVENDRA 05NOV2007	STE TE Connectivity		
DIMENSIONS: mm [INCHES]		CHK D DECKER 05NOV2007			
TOLERANCES UNLESS OTHERWISE SPECIFIED:		APVD D DECKER 05NOV2007	NAME SHUR PLUG 3.96[.156] DIA		
0 PLC ± -		PRODUCT SPEC	SIZE CAGE CODE DRAWING NO RESTRICTED TO		
1 PLC ± -		APPLICATION SPEC	A3 00779 C-60766		
2 PLC ± 0.38 [.015]		WEIGHT 0.000000	SCALE 5:1 SHEET 1 OF 1 REV J3		
3 PLC ± -		CUSTOMER DRAWING			
4 PLC ± -					
ANGLES ± 1°					
MATERIAL SEE TABLE					
FINISH SEE TABLE					