

P	LTR	DESCRIPTION	DATE	DWN	APVD
	A1	REVISED PER ECO-20-008483	29SEP2020	AP	WZ

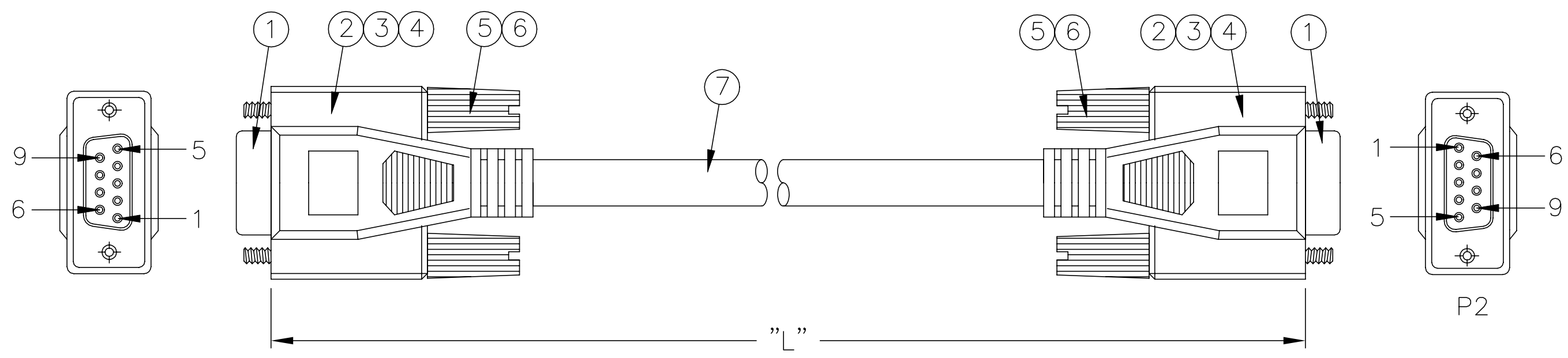

NOTES:

- PACKAGED IN PRINTED ZIPLOCK POLYBAG.
- LABEL ON POLYBAG TO READ AS FOLLOWS:

621803-__	XX' = LENGTH
XX' DB9 F/F EXTENSION	PER TABLE
- WRAP FOIL OVER PRE-MOLD 360° FROM CONNECTOR SHELL TO SHELL.
- IF USING ALUMINUM MYLAR FOIL, ALUMINUM MUST BE FACING INWARD.
- THIS PRODUCT IS PRODUCED IN COMPLIANCE WITH ANSI/ASQC Z1.4-1993, TO AN INSPECTION LEVEL III, WITH A NORMAL SAMPLING PLAN.
- TEST REQUIREMENT:
 CONTINUITY RESISTANCE: SEE TABLE.
 INSULATION RESISTANCE: 50 M ohm MIN.
 HI-POT TEST: DC 300V/0.01 Sec MIN.
- PRODUCT AND PROCESSING MUST MEET REQUIREMENTS OF TYCO ENVIRONMENTAL STANDARD 230-702.

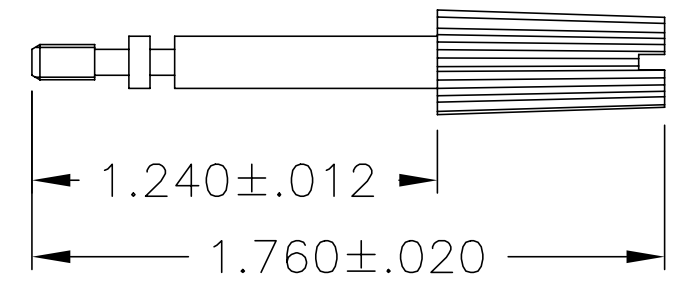

OBSOLETE	621803-3	180.0 ^{+6.00} / _{-2.00}	15	3 OHM MAX
	621803-2	120.0 ^{+6.00} / _{-2.00}	10	2 OHM MAX
OBSOLETE	621803-1	72.0 ^{+6.00} / _{-2.00}	6	1 OHM MAX
	TYCO P/N	"L" LENGTH	LABEL XX'	CONTINUITY RESISTANCE

PIN ASSIGNMENT :

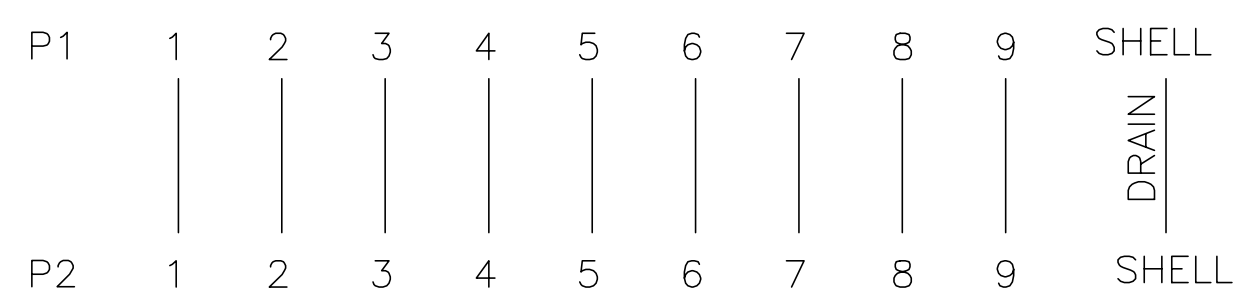

AR	MR	UL2464 28AWG*9C+DRAIN+AL/MYLAR, COLOR: BEIGE(BG01).	7
4	PC	#4-40 THUMBSCREW.	6
AR	KG	MOLD PVC, 30P, COLOR: BEIGE(BG01).	5
AR	MR	COPPER FOIL, W: 30.0MM, 360° SOLDERED.	4
AR	KG	INNER MOLD PE.	3
AR	KG	OVER MOLD PVC, 40P, COLOR: BEIGE(BG01).	2
2	PC	DB9 FEMALE, CONTACT: GOLD FLASH, SHELL: NICKEL PLATED, INSULATION COLOR: BLACK.	1
Q'TY	U/M	DESCRIPTION	ITEM

THIS DRAWING IS A CONTROLLED DOCUMENT.		DWN D.EISENTRAUT 11-20-96	TE TE Connectivity											
DIMENSIONS: INCHES		CHK R.CAPP 11-21-96												
TOLERANCES UNLESS OTHERWISE SPECIFIED:		APVD D.WILSON 11-21-96	CABLE ASSY, DB9 FEMALE TO FEMALE, OVERMOLDED											
<table border="0"> <tr><td>0 PLC</td><td>± -</td></tr> <tr><td>1 PLC</td><td>± -</td></tr> <tr><td>2 PLC</td><td>± -</td></tr> <tr><td>3 PLC</td><td>± -</td></tr> <tr><td>4 PLC</td><td>± -</td></tr> <tr><td>ANGLES</td><td>± -</td></tr> </table>		0 PLC			± -	1 PLC	± -	2 PLC	± -	3 PLC	± -	4 PLC	± -	ANGLES
0 PLC	± -													
1 PLC	± -													
2 PLC	± -													
3 PLC	± -													
4 PLC	± -													
ANGLES	± -													
MATERIAL		APPLICATION SPEC	SIZE	CAGE CODE	DRAWING NO	RESTRICTED TO								
		WEIGHT	A3	00779	C=621803									
CUSTOMER DRAWING			SCALE	SHEET	REV									
			N.T.S.	1 OF 1	A1									