

REVISIONS				
P	LTN	DESCRIPTION	DATE	APVD
E13		REVISED PER ECO-20-004256	26MAR2020	JM DS
E14		REVISED PER PCN E-20-016603	24NOV2020	PN DS
F		REVISED PER ECN-21-123056	08NOV2021	DK CB
F1		REVISED PER ECR-24-216938	16SEP2024	DK CB

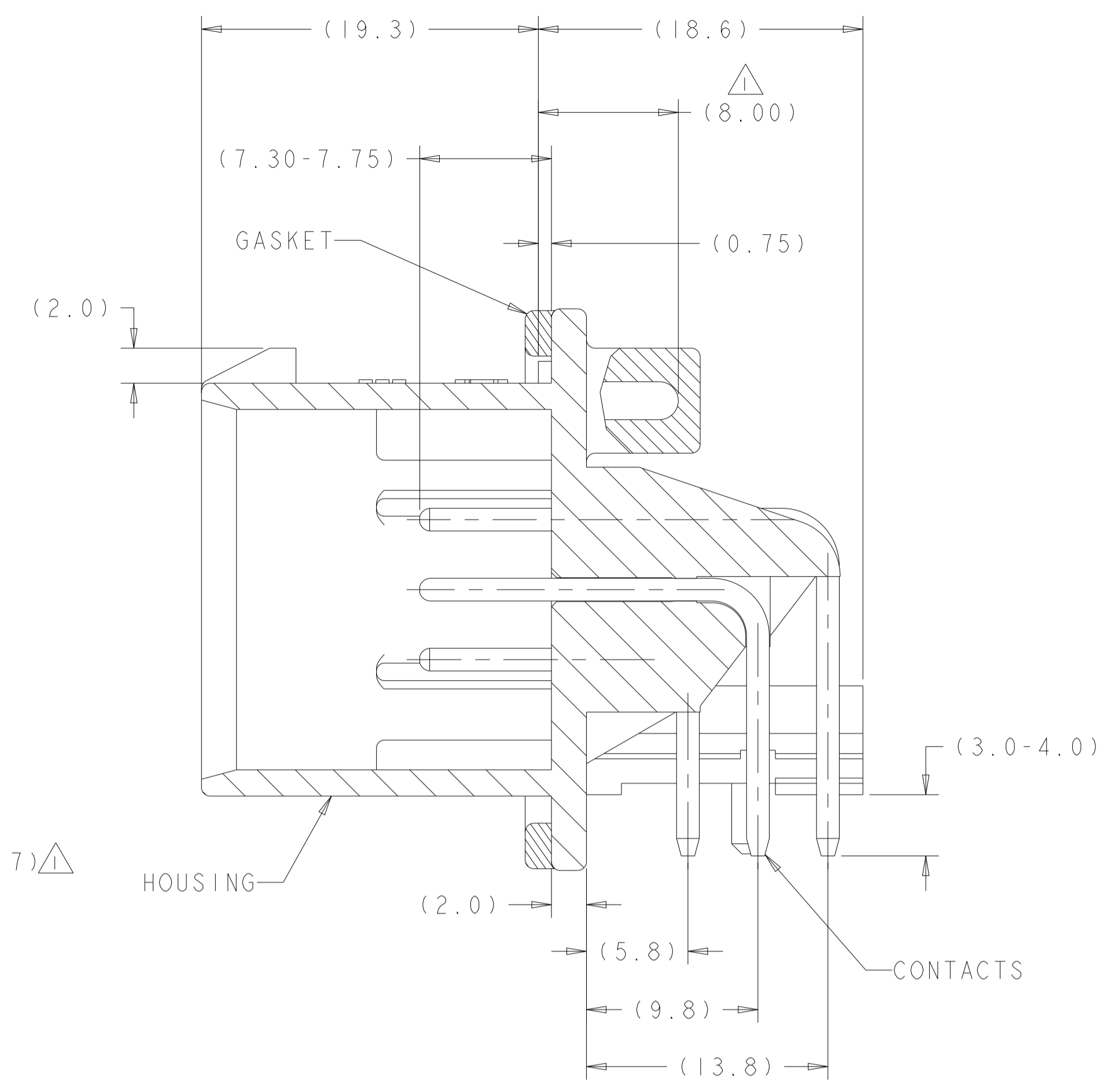
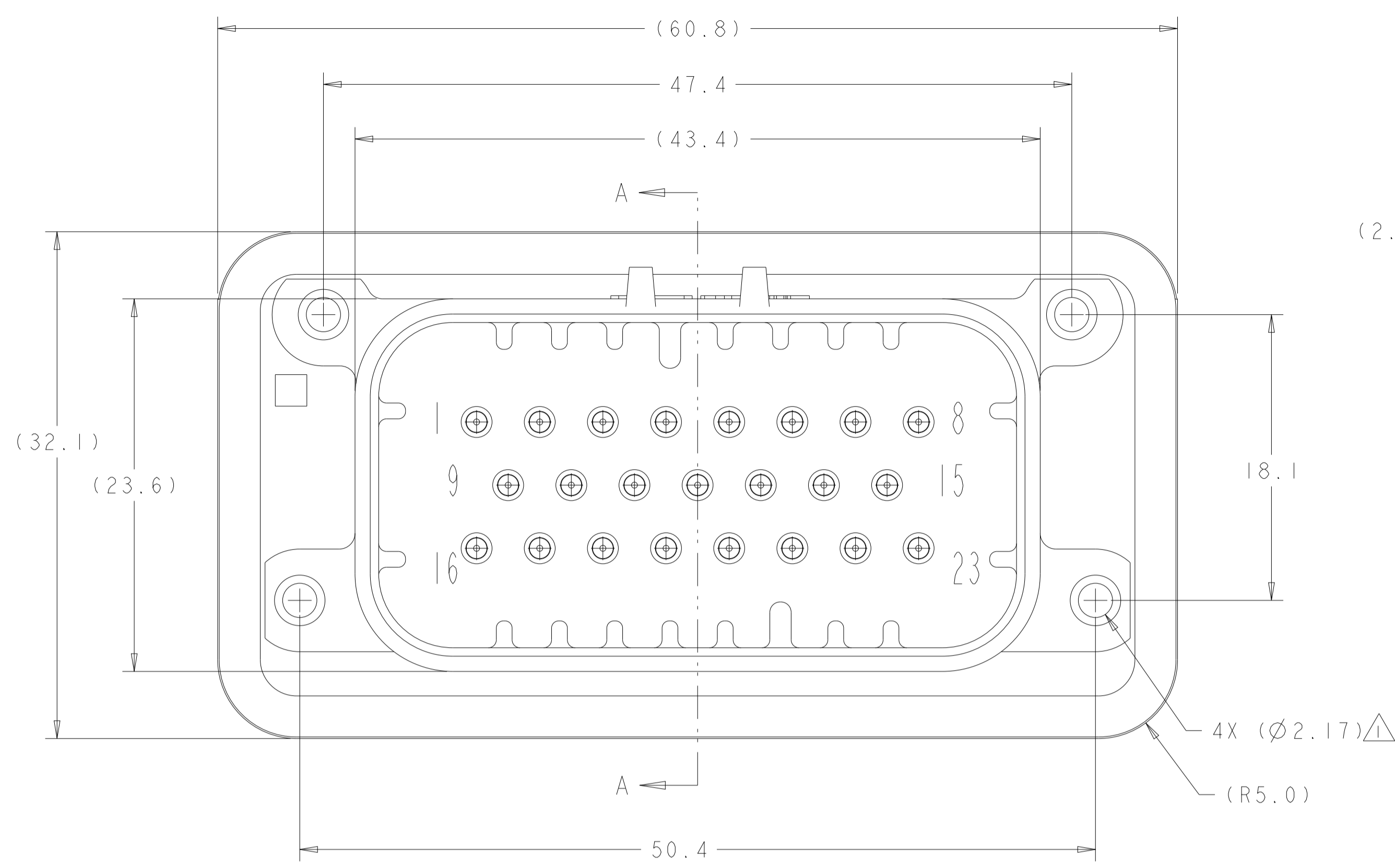

△ SUGGESTED MOUNTING SCREW SIZE IS Ø2.50mm [APPROX. 0.099 INCH] SELF TAPPING THREAD FORMING SCREW, SUCH AS DELTA PT, TO BE DRIVEN AT 0.6-0.8 N-m. THE CUSTOMER MUST TEST THE SCREW SIZE AND TYPE IN ORDER TO VERIFY THEIR SELECTION BEFORE USE IN APPLICATION

TO VALIDATE HEADER MOUNTING PERFORMANCE, TE CONNECTIVITY WILL CONTINUE TO UTILIZE THE FOLLOWING TORQUE VALIDATION PROCESS ACCORDING TO APPLICATION SPEC 114-16016: MOUNTING PANEL THICKNESS - 4.75 +/- 0.15mm SCREW - 2.5X12mm DELTA PT

CUSTOMERS MAY VALIDATE OTHER SCREW SIZES AND TYPES AT THEIR OWN DISCRETION

△ HOUSING COLORS ARE MECHANICALLY KEYS TO MATE ONLY WITH IDENTICALLY COLORED PLUG ASSEMBLIES.

△ MATERIALS: HEADER HOUSING - GLASS FIBERED PBT
 PINS - TIN OR GOLD PLATED BRASS
 GASKET - SILICONE

△ DATE CODE IN THIS LOCATION USING 5 DIGIT CODE
 FIRST 2 DIGITS = YEAR, SECOND 2 DIGITS = WEEK
 LAST DIGIT = DAY

5. HEADER MATES TO PLUG ASSEMBLY 776080 WHICH USES REELED TERMINAL 770520 AND LOOSE PIECE TERMINAL 770854

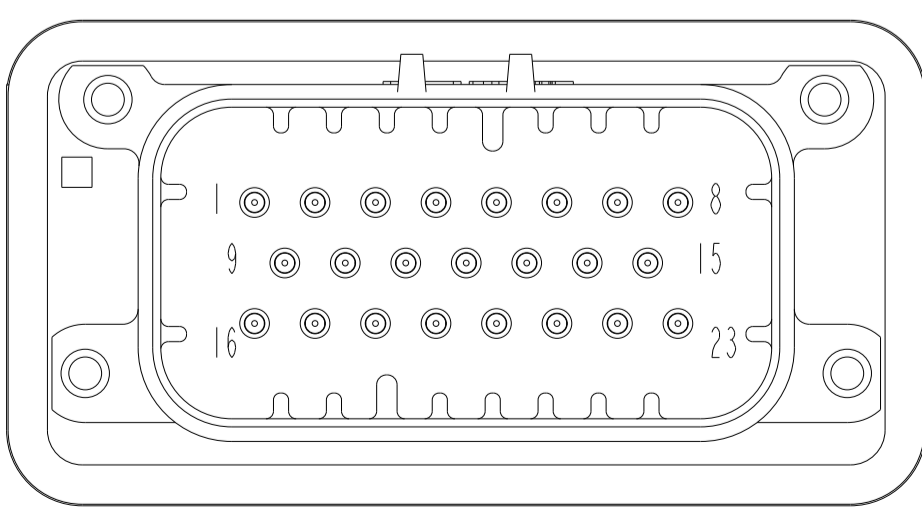
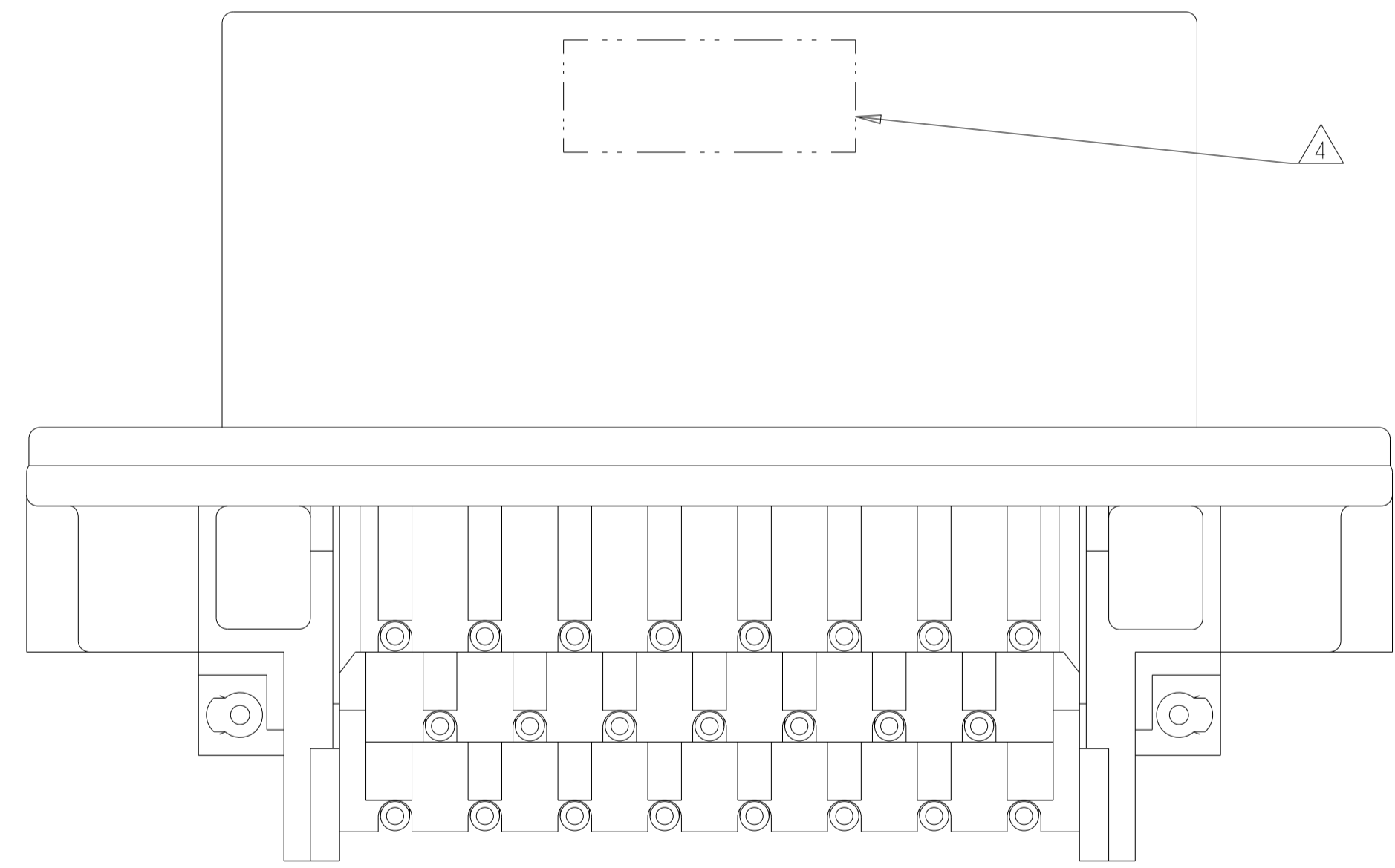

776087-2 & 1-776087-2
 KEY LOCATION AS SHOWN
 SCALE 2:1

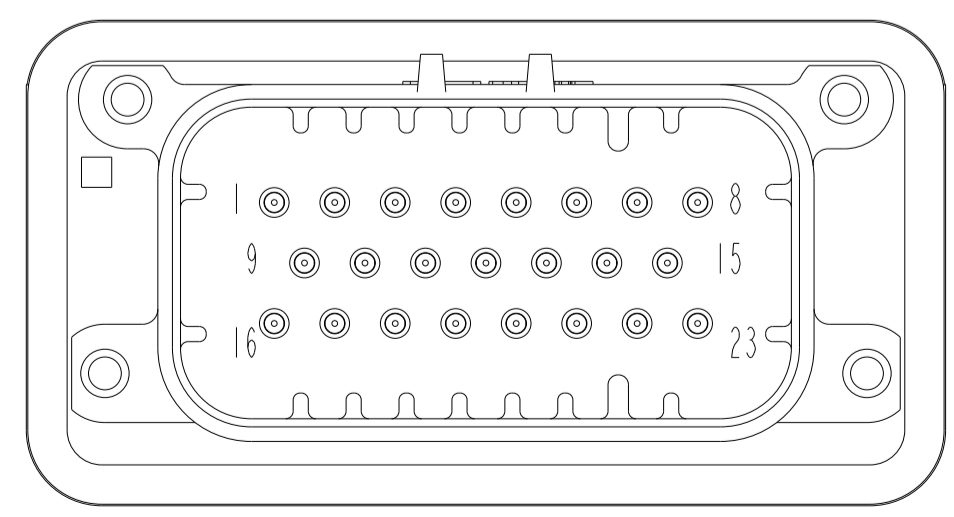

776087-4 & 1-776087-4
 KEY LOCATION AS SHOWN
 SCALE 2:1

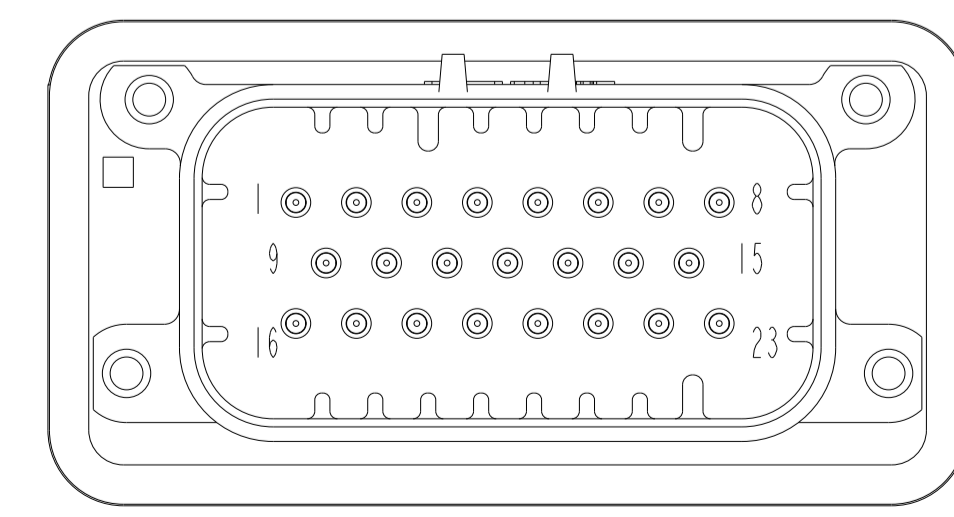

776087-5 & 1-776087-5
 KEY LOCATION AS SHOWN
 SCALE 2:1

776087-1 & 1-776087-1
 KEY LOCATION AS SHOWN

GOLD	BLUE	1-776087-5
GOLD	GRAY	1-776087-4
GOLD	NATURAL (WHITE)	1-776087-2
GOLD	BLACK	1-776087-1
TIN	BLUE	776087-5
TIN	GRAY	776087-4
TIN	NATURAL (WHITE)	776087-2
TIN	BLACK	776087-1
FINISH	COLOR	PART NUMBER

THIS DRAWING IS A CONTROLLED DOCUMENT.

DIMENSIONS:	TOLERANCES UNLESS OTHERWISE SPECIFIED:	OWN: R. VESTAL 31DEC2002	CHK: D. CROWE 31DEC2002	APVD: D. CROWE 31DEC2002
mm	0 PLC ±0.2	NAME: HEADER ASSEMBLY, 23 POSITION, RIGHT ANGLE, AMPSEAL		
	1 PLC ±	SIZE: 114-16016		
	2 PLC ±	WEIGHT: 29.04g		
	3 PLC ±	MATERIAL: 114-16016		
	4 PLC ±	CUSTOMER DRAWING		
	ANGLES ±	SCALE: 4:1		
	FINISH	SHEET 1 OF 2		

STC TE Connectivity

RESTRICTED TO

REVISIONS				
P.	LTN.	DESCRIPTION	DATE	APPV.
-	-	SEE SHEET 1	-	-

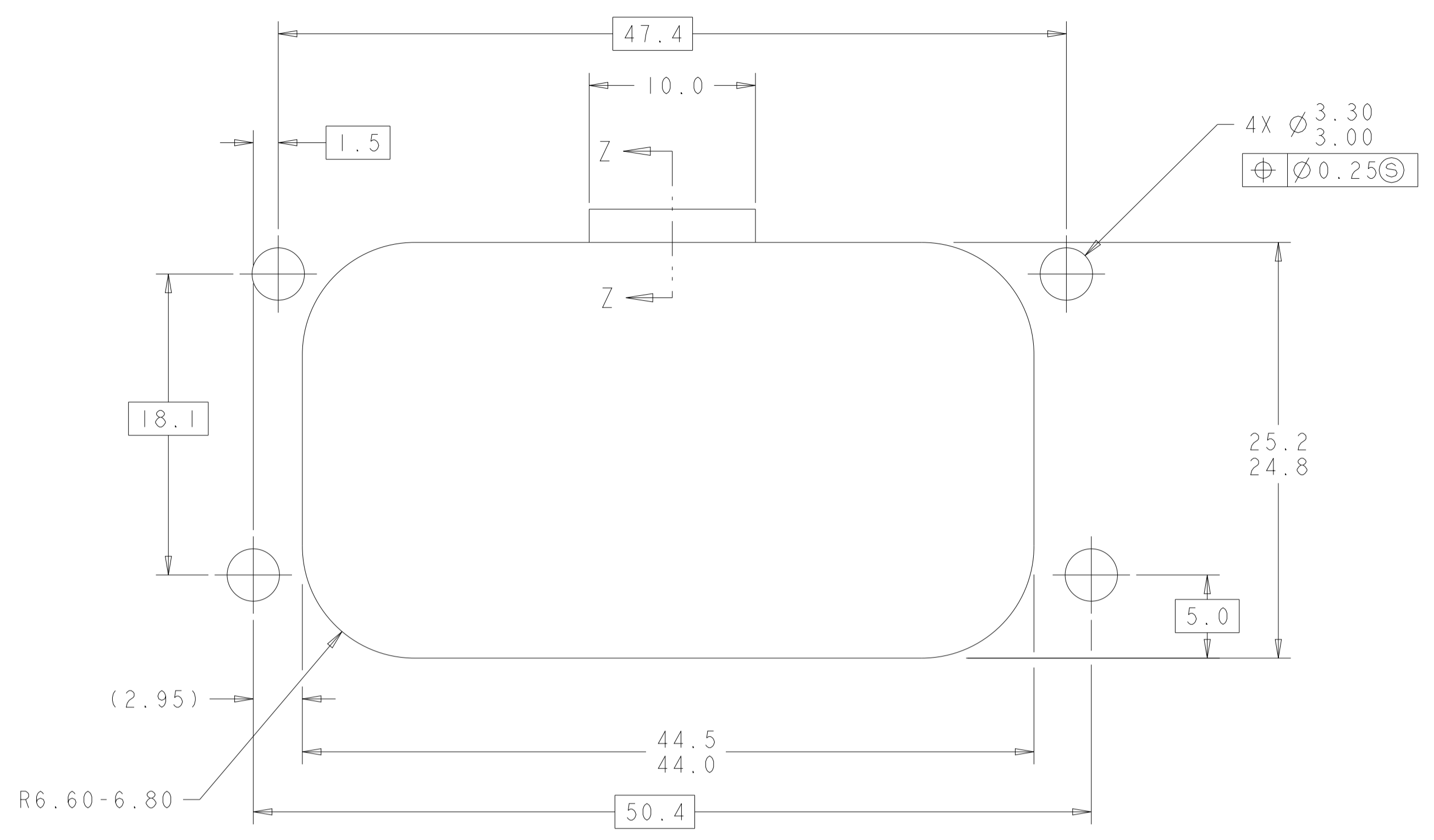

RECOMMENDED MOUNTING HOLE LAYOUT FOR 5.0 MAX THICK PANEL

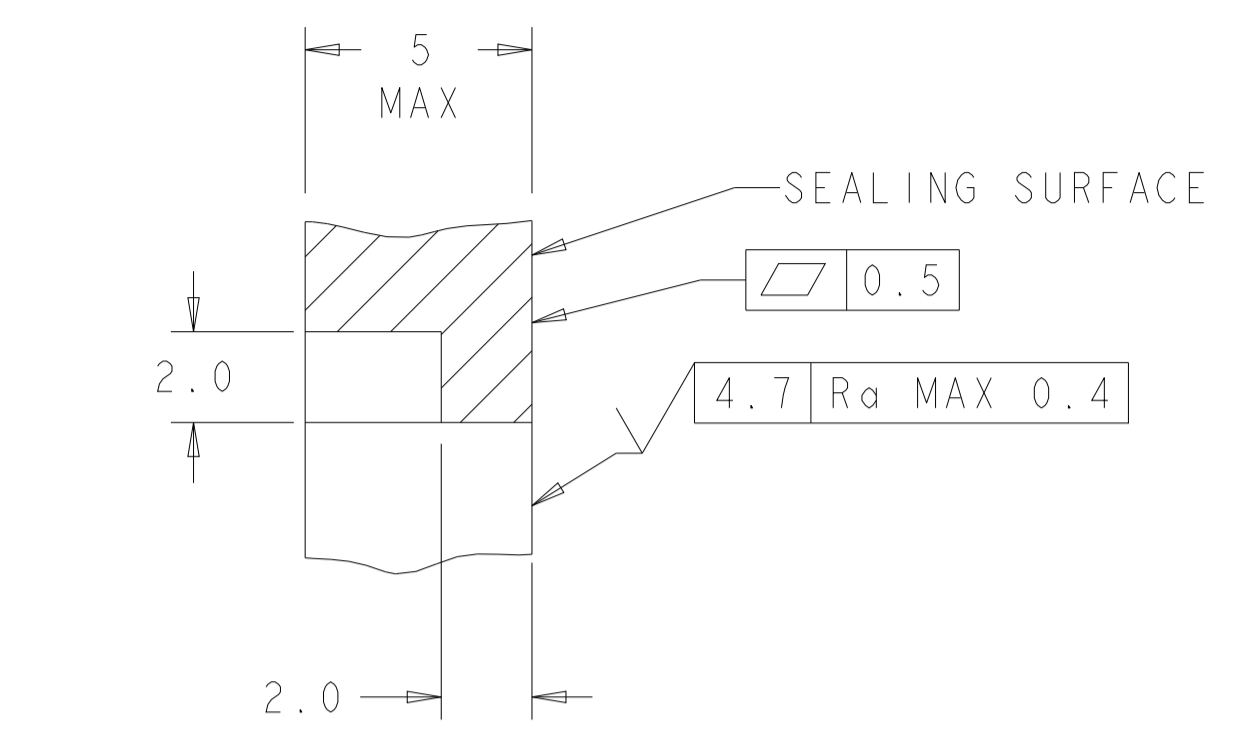

SECTION Z-Z
 OPTIONAL CONSTRUCTION IF THICKNESS IS GREATER THAN 2.0
 SCALE 6:1

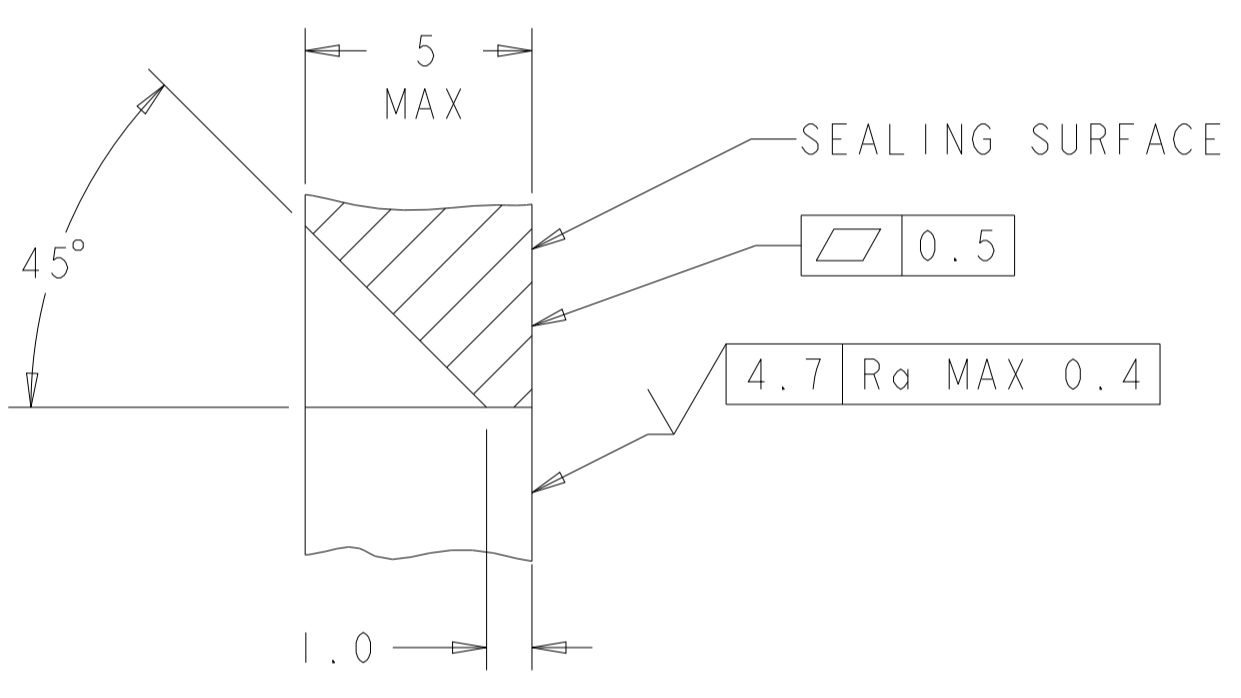

SECTION Z-Z
 OPTIONAL CONSTRUCTION IF THICKNESS IS GREATER THAN 2.0
 SCALE 6:1

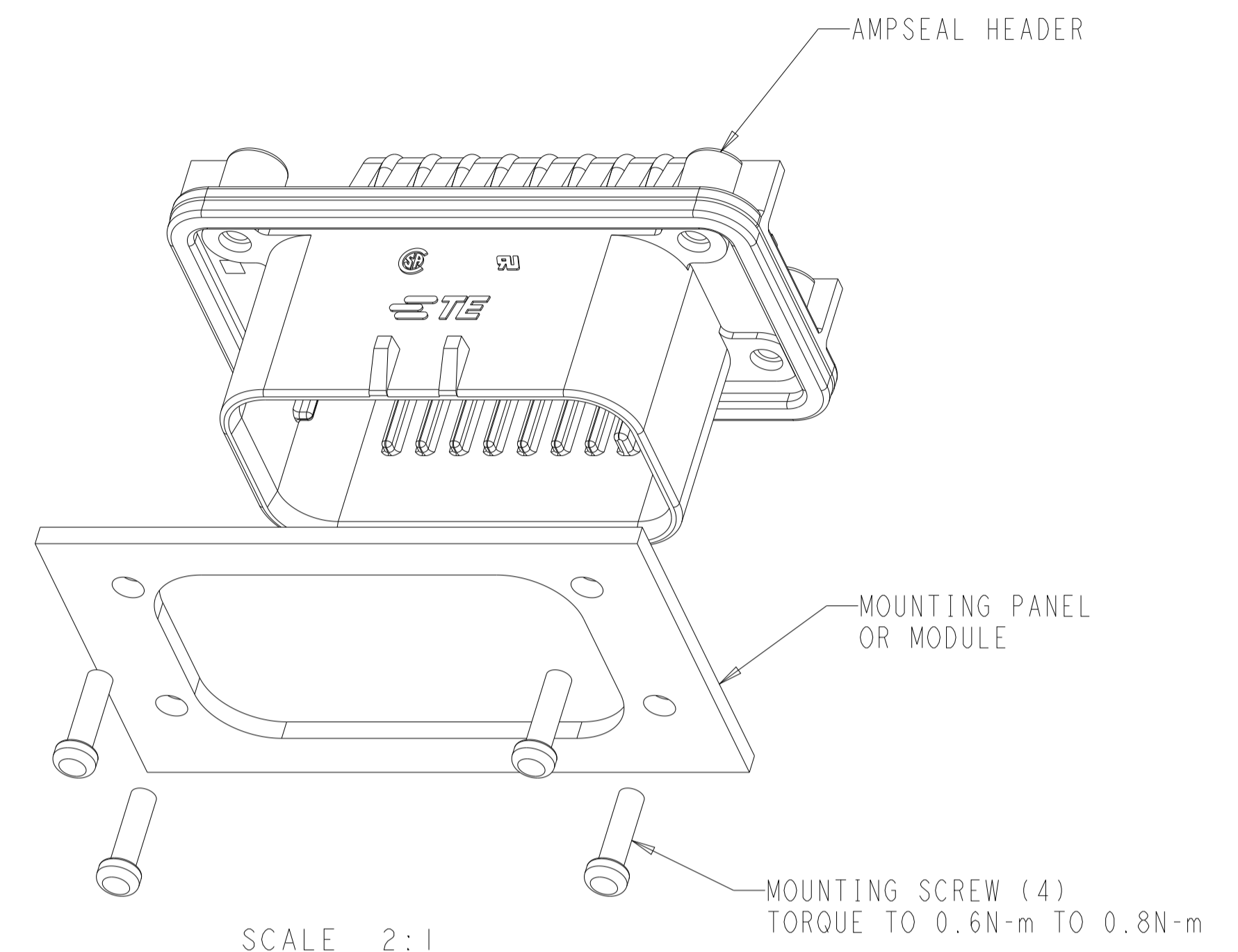

SCALE 2:1
 TORQUE TO 0.6N-m TO 0.8N-m

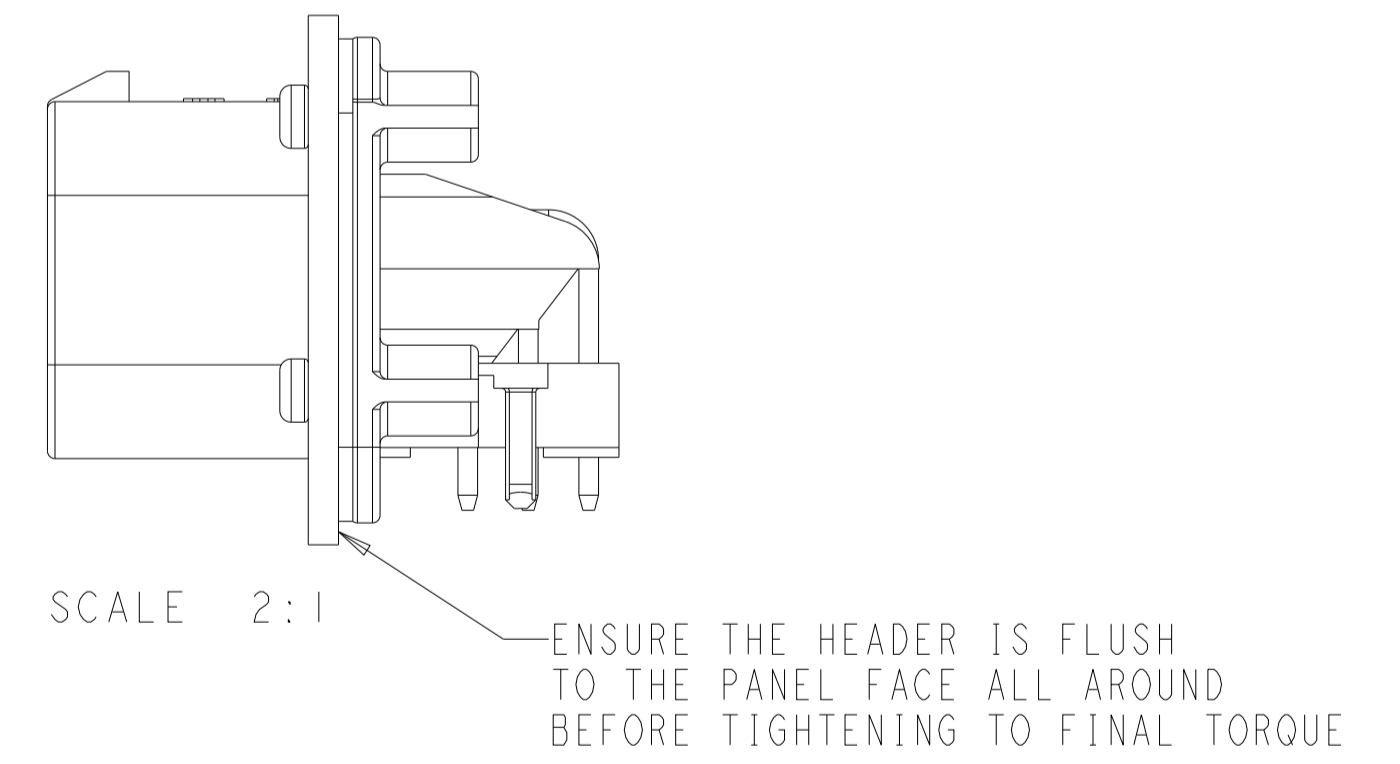

SCALE 2:1
 ENSURE THE HEADER IS FLUSH TO THE PANEL FACE ALL AROUND BEFORE TIGHTENING TO FINAL TORQUE

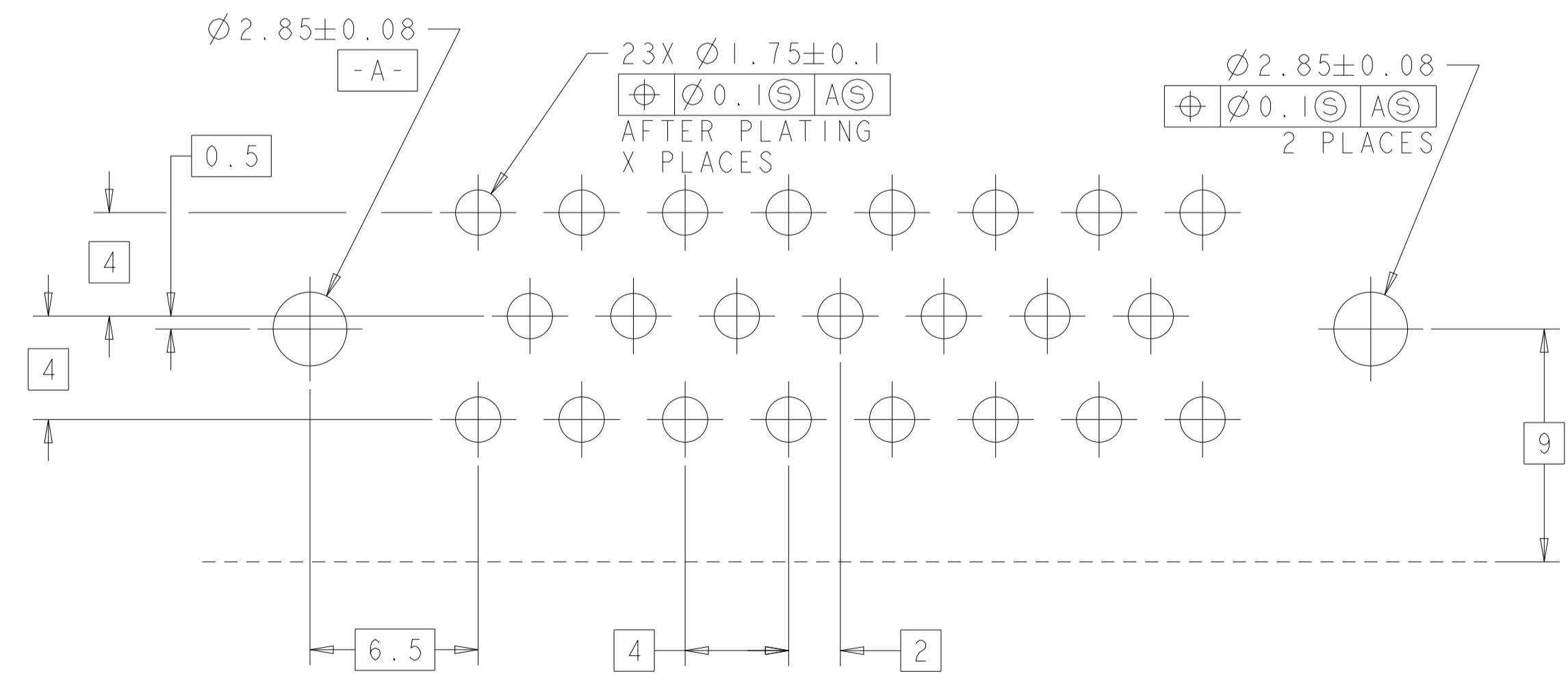

RECOMMENDED P.C. BOARD LAYOUT FOR 1.57 THICK P.C. BOARD

THIS DRAWING IS A CONTROLLED DOCUMENT.		OWN: R. VESTAL 31DEC2002	TE Connectivity
DIMENSIONS: mm		CHK: D. CROWE 31DEC2002	
TOLERANCES UNLESS OTHERWISE SPECIFIED:		APV: D. CROWE 31DEC2002	NAME: HEADER ASSEMBLY, 23 POSITION, RIGHT ANGLE, AMPSEAL PRODUCT SPEC: 108-1329 APPLICATION SPEC: 114-16016
0 PLC ±0.2		SIZE: CAGE CODE DRAWING NO	
1 PLC ±0.13		RESTRICTED TO	WEIGHT: 29.04g CUSTOMER DRAWING
2 PLC ±0.13		SCALE: 2:1	
3 PLC ±0.13		SHEET: 2 OF 2	
4 PLC ±0.13		REV: F1	
ANGLES ±0.5			
FINISH ±0.1			