

C 881703 1 OF 1

DO NOT SCALE
DIMENSIONS IN mm

METRIC



91-018

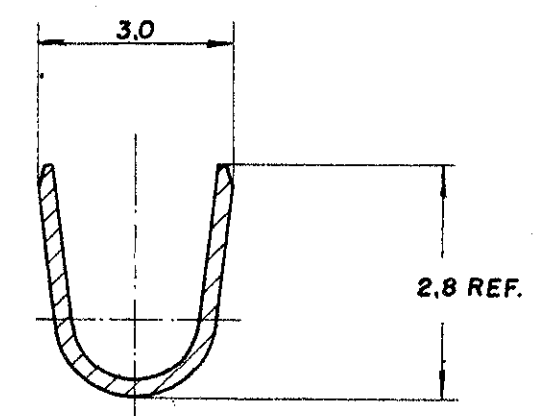
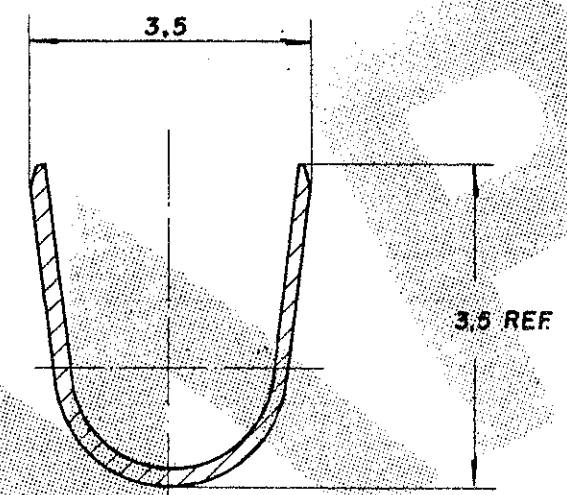
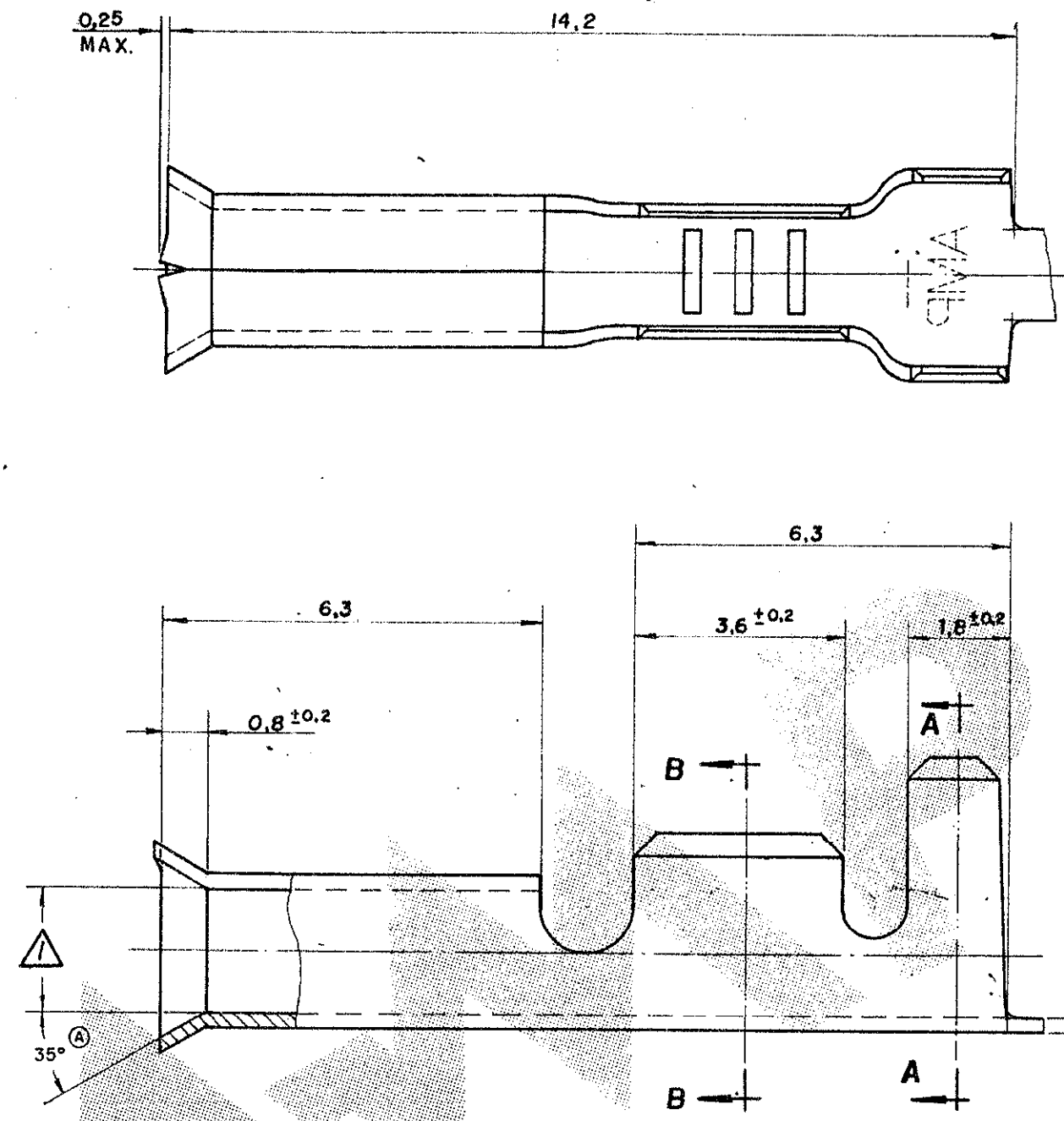

NOTAS:

① - ACEITA PINO DE $\varnothing 1,98 \pm 0,02$

② OBSOLETE PARTS: OBSOLETE CIS STREAMLINING PER D.RENAUD/D.SINISI

② OBSOLETE	PRÉ-ESTANHADO	LATÃO	881703 - 2
		LATÃO	881703 - 1
OTHER	FINISH	MATERIAL	PART NUMBER
CUSTOMER DWG for REFERENCE ONLY			
THIS DRAWING IS UNPUBLISHED RELEASED FOR PUBLICATION			
© COPYRIGHT 19 BY AMP DO BRASIL LTDA S.P. ALL INTERNATIONAL RIGHTS RESERVED AMP PRODUCTS MAY BE COVERED BY U.S. AND FOREIGN PATENTS AND/OR PATENTS PENDING.			
TOLERANCES UNLESS OTHERWISE STATED		INS. DIA. RANGE	WIRE RANGE
DEC ± 0,5		2,0 - 2,6 mm	20-18 AWG
ANGLES ± 1°		SCALE 1	
DR. H.C. Curitiba 20.05.91		AMP AMP do BRASIL LTDA. São Paulo, Brasil	
CHK. JLV12 22.05.91		DESCRIPTION	
D1 ECO-09-026444 KK AEG NOV09		1,98 DIA. PIN RECEPTACLE	
A REVISED BY ECN 2833 H.C. JLV12 18/12/91		DWG NO	
ISS REVISION RECORD DR CHK DATE APP		A3 C 881703	
		SHEET 1 of 1	