

B CTJ420E172

REVISIONS			
SYM	DESCRIPTION	DATE	APPROVED
N/C	NEW RELEASE PER E.O. A7423		
A	REVISED PER E.O. A7724		
B	REVISED PER E.O. A7840	3-31-88	PUL

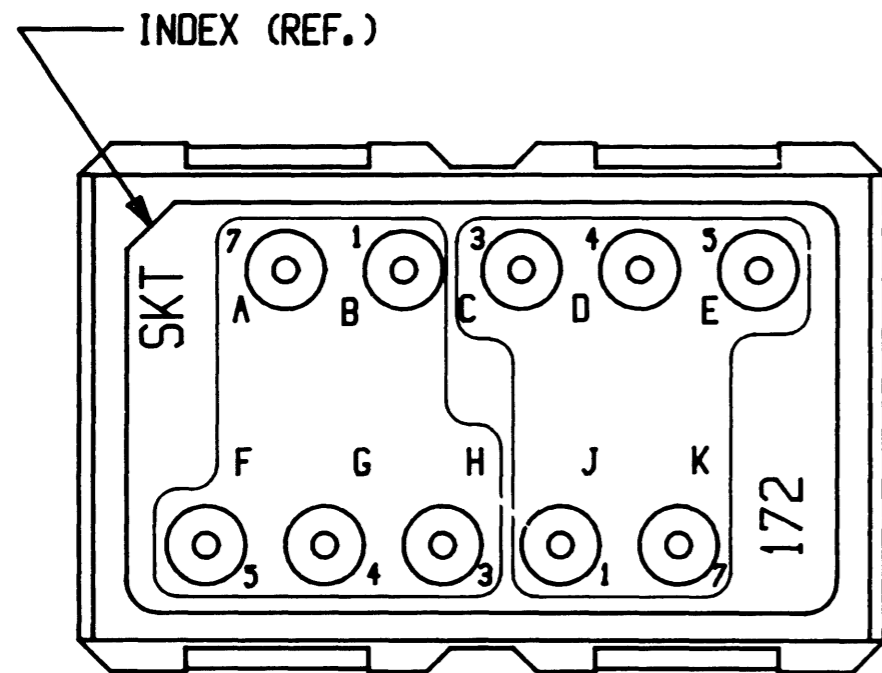

11. COMPONENTS: M93F-1
10. THIS ASSEMBLY CONFORMS TO AFLC 8027520-4 SPEC.
9. SOCKET CONTACTS MEET MIL-C-39029/22-192 REQUIREMENT.
8. JUNCTION ELECTRONIC COMPONENT TEMPERATURE RANGE: -67°F TO +257°F (-55°C TO +125°C).
7. MATERIALS AND FINISHES:
HOUSING - THERMO PLASTIC
GROMMET - SILICONE ELASTOMER
PIN CONTACTS - COPPER ALLOY PLATED GOLD
6. CONTACT TOOL NO. M15570-20 IS REQUIRED.
5. SEE ENVELOPE DRAWING NO. CTJ-3*** FOR SUITABLE RAIL ASSEMBLIES.
4. FOR CONTACT DATA SEE ENVELOPE DRAWING 1625-1-0000.

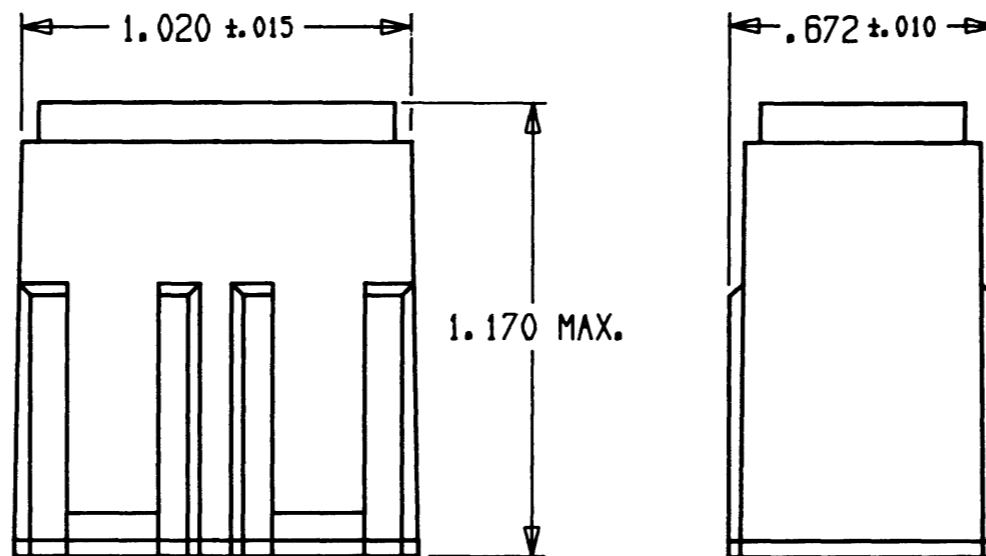

3. CTJ420E172-***
 - MODIFICATION
 - CIRCUIT ARRANGEMENT
 - BASIC IDENTIFIER
2. THE CIRCUIT IDENTIFICATION WILL BE SCREENED ON JUNCTION.
1. DIMENSIONS ARE IN INCHES UNLESS OTHERWISE SPECIFIED.

NOTE:

TOLERANCES UNLESS OTHERWISE SPECIFIED DECIMALS .XXX .005 ANGLES .0° .30' 0" TIR 010 PARTS TO BE FREE OF BURRS AND SHARP EDGES	SIGNATURE & DATE	
	DR	<i>J. Oberle</i> 10/5/87
MATERIAL	CHK	<i>N. LAZAROV</i> 3-31-88
	PE	<i>J. Oberle</i> 10/5/87
FINISH	APPD	
	SCALE	NONE WT

JUNCTION ASSEMBLY
ELECTRONIC COMPONENT
SIZE 12
SIZE 20 CONTACTS
172 ARRANGEMENT
ENVELOPE

CP	MATL CODE	16
DEUTSCH ENGINEERED CONNECTING DEVICES Municipal Airport Banning, California		
B	CTJ420E172	
DWG SIZE	CODE 11139	SHEET OF

CTJ420E172ENV