

DRAWING NUMBER:  
**610436-ENV**

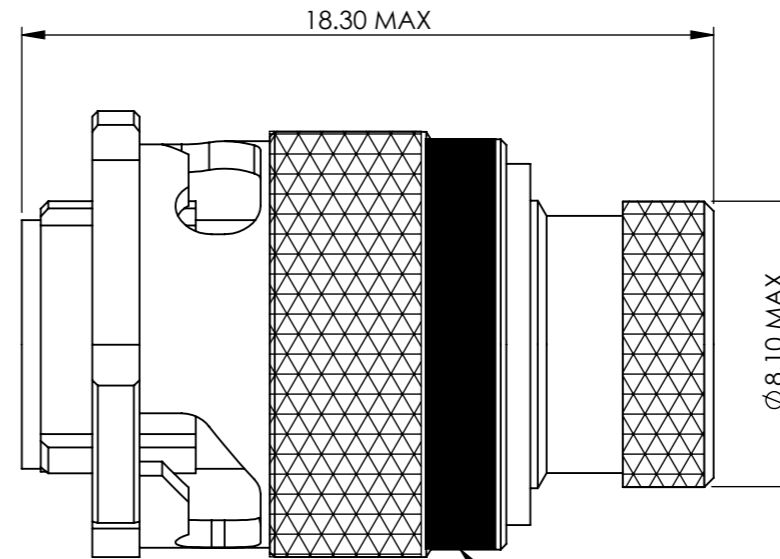
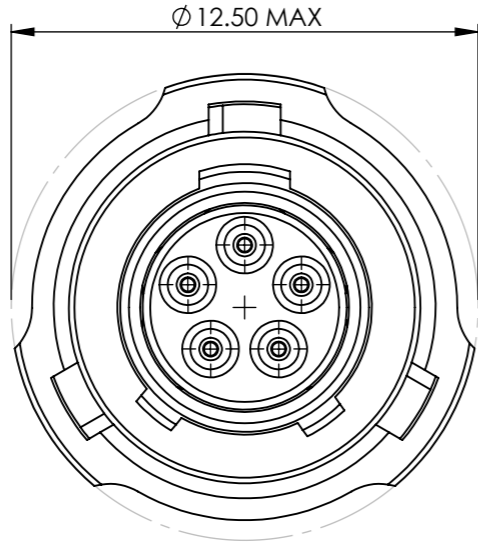

PART NO. & BATCH NO.  
MARKED OVER COLOUR BAND  
SEE NOTES 1 & 2.

NOTES

- CONNECTOR ORIENTATION IDENTIFIED BY COLOUR BAND COLOUR APPLIED. AS BELOW.  
N ORIENTATION - RED D ORIENTATION - GREEN  
A ORIENTATION - YELLOW E ORIENTATION - GREY  
B ORIENTATION - BLUE  
C ORIENTATION - ORANGE
- PART NUMBER SHORTENED FOR MARKING ONTO CONNECTOR. SEE NOTE 3 FOR FULL PART NUMBER STRUCTURE TO BE USED FOR ORDERING. SEE BELOW FOR SHORTENED PART NO.  
EXAMPLE FOR STANDARD VERSIONS:-

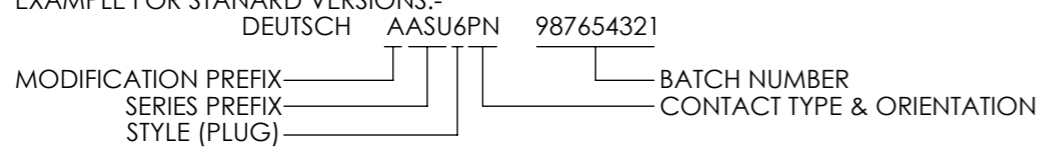

NOTES (CONTINUED)

- FULL PART NUMBER STRUCTURE TO BE USED FOR ORDERING, SEE BELOW  
EXAMPLE FOR STANDARD VERSIONS:-  
**A ASU603 05PN - HE 987654321**  

MODIFICATION PREFIX	A	BATCH NUMBER	987654321
SERIES PREFIX	ASU	HARSH ENVIRONMENT	HE
STYLE (PLUG)	603	KEYWAY ORIENTATION	05
SHELL SIZE	PN	CONTACT TYPE	
		CONTACT ARRANGEMENT	

  
EXAMPLE FOR UAV VERSIONS:-  
**UAV603 - 05PN 987654321**  

SERIES PREFIX	UAV	BATCH NUMBER	987654321
STYLE (PLUG)	603	KEYWAY ORIENTATION	05
SHELL SIZE	PN	CONTACT TYPE	
		CONTACT ARRANGEMENT	
- THIS PART IS RoHS COMPLIANT

THIS INFORMATION IS CONFIDENTIAL AND PROPRIETARY TO TYCO ELECTRONICS CORPORATION AND ITS WORLDWIDE SUBSIDIARIES AND AFFILIATES (TE). IT MAY NOT BE DISCLOSED TO ANYONE OTHER THAN TE PERSONNEL, WITHOUT AUTHORIZATION FROM TE (www.te.com).

AA	DUK-75481	JLM	JCB	NDL	PW	20/04/2023
ISSUE	CHANGE NOTE	DRAWN	CHECKED	APP. ENG.	APP. MARKETING	DATE

<b>BS8888</b>	MATERIAL:	FINISH:		 <b>DEUTSCH</b> TE CONNECTIVITY UK LTD., ST. LEONARDS-ON-SEA, TN38 9RF, UK.
THIRD ANGLE PROJECTION				
UNLESS OTHERWISE STATED: DIMENSIONS: mm [INCHES]		TITLE: <b>PLUG ENVELOPE DETAILS ASU 5 WAY</b>		TYPE: CUSTOMER DRAWING
IF IN DOUBT, ASK	SIZE: A3	SCALE: 5:1	DRAWING NUMBER: <b>610436-ENV</b>	SHEET: 1 OF 1
				ISSUE: AA