

P	LTR	DESCRIPTION	DATE	DWN	APVD
A		REVISED PER ECN-22-141923	03MAR2022	DC	JA

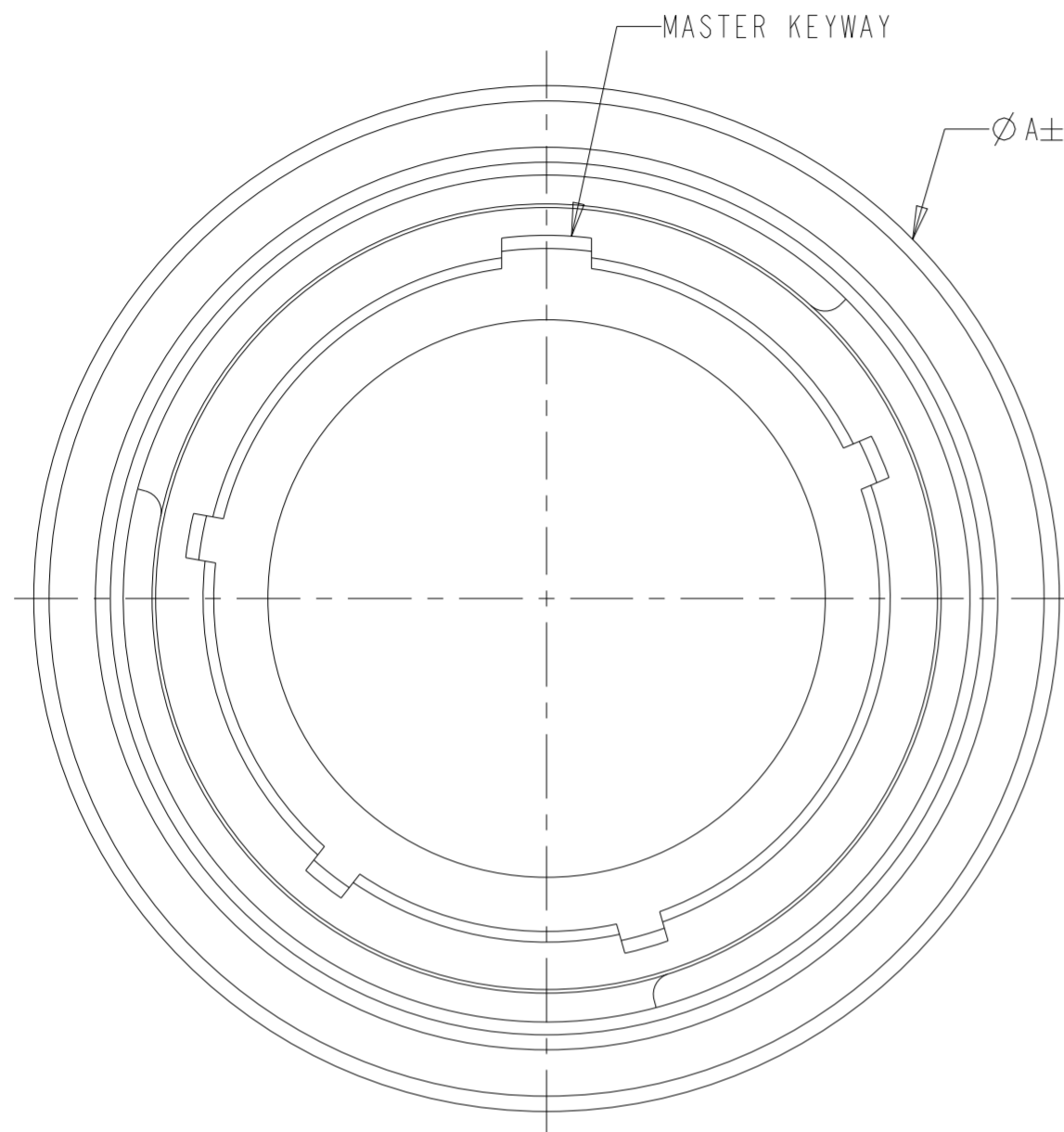

STUB 60° MOD  
TRIPLE START THREAD  
"D" - .1P-.3L CLASS 2A  
(SEE COLUMN "D THREAD")

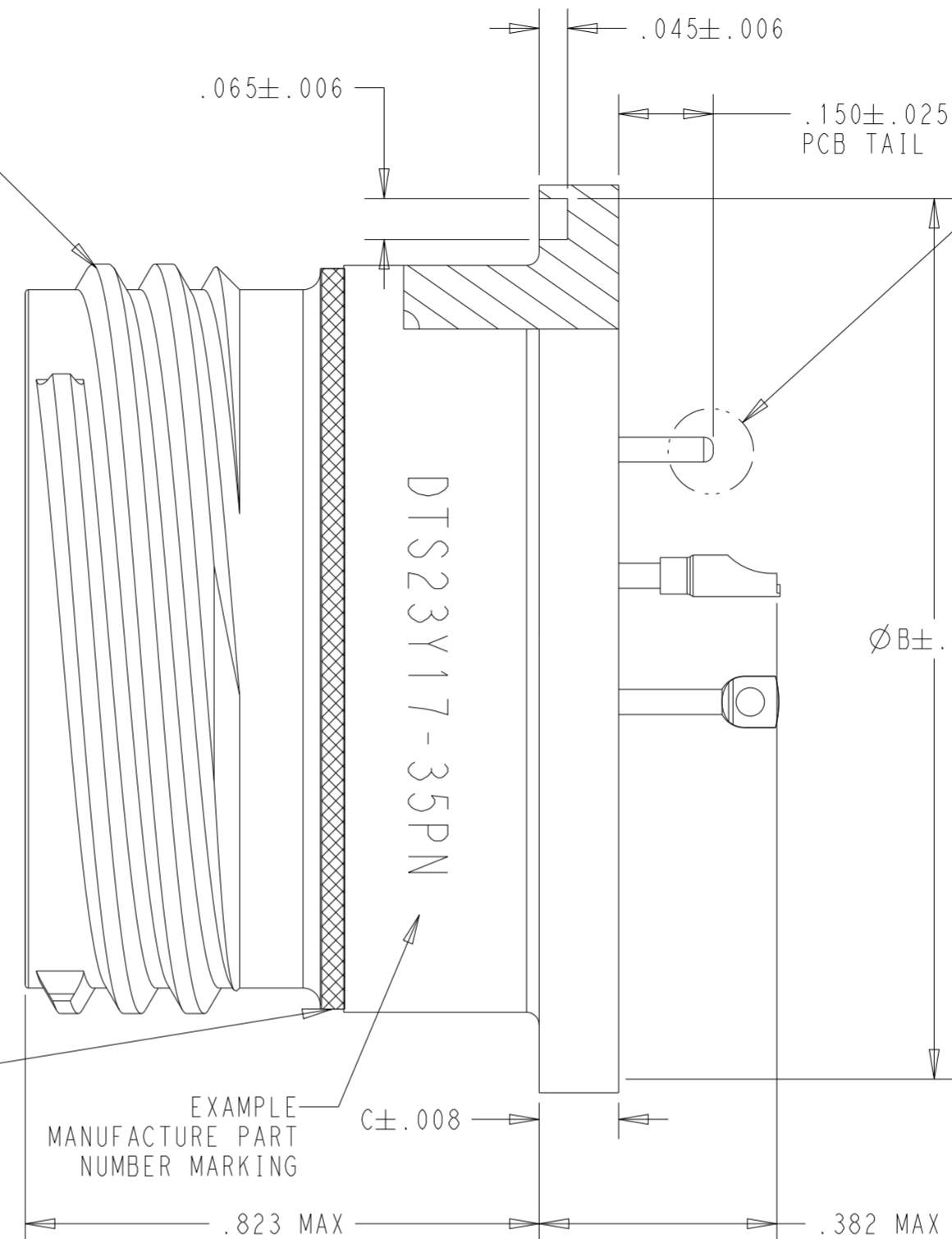

SEE DETAIL R

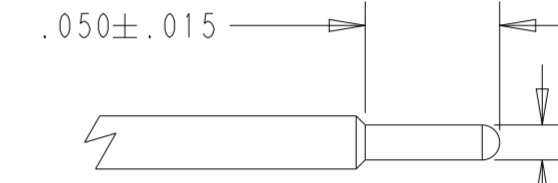

Ø.013±.002 SIZE 22  
Ø.026±.002 SIZE 20  
SIZE 16 & 12 STRAIGHT PIN

MATING INDICATOR STRIPE, COLOR RED

EXAMPLE MANUFACTURE PART NUMBER MARKING

SHELL SIZE	A	B	C	D THREAD
9	.978	.935	.126	.6250
11	1.100	1.057	.126	.7500
13	1.226	1.183	.126	.8750
15	1.352	1.309	.126	1.0000
17	1.439	1.396	.126	1.1875
19	1.585	1.541	.126	1.2500
21	1.726	1.683	.126	1.3750
23	1.892	1.848	.157	1.5000
25	1.978	1.935	.157	1.6250

9. PART NUMBER BREAKDOWN: DTS 23 Y 17-35 P N

- SHELL KEYING POSITIONS: N, A, B, C, D OR E
- CONTACT PIN STYLE: P = SOLDERCUP, X = EYELET, C = PCB PIN  
CONTACT SOC STYLE: S = SOLDERCUP, Z = EYELET, D = PCB PIN
- INSERT ARRANGEMENT
- SHELL SIZE: 9, 11, 13, 15, 17, 19, 21, 23 OR 25
- CLASS: N = NICKEL PLATE OVER STAINLESS STEEL  
Y = ELECTRO-POLISHED STAINLESS STEEL  
H = ELECTRO-POLISHED STAINLESS STEEL (SPACE GRADE)
- SHELL MOUNTING STYLE: 23 = WELD FLANGE MOUNT
- BASIC IDENTIFER: 38999 SERIES III HERMETIC RECEPTACLE

1. DIMENSIONS ARE IN INCHES UNLESS OTHERWISE NOTED.
2. INSERT ARRANGEMENT CONFORMS TO MIL-STD-1560.
3. LEAK RATE: <math>1E-8</math> cc/sec He @ 1 atm.
4. FINISH: SHELL - ELECTRO-POLISH  
PIN CONTACTS - GOLD OVER NICKEL
5. MATERIAL: SHELL - STAINLESS STEEL  
PIN CONTACTS - HIGH NICKEL IRON ALLOY OR EQUIVALENT  
GLASS: - COMPRESSION GLASS  
INTERNAL SEAL - FLUOROSILICONE ELASTOMER
6. MATES WITH DTS26 PLUG CONNECTOR.
7. CONNECTOR MEETS REQUIREMENTS OF MIL-DTL-38999 SERIES III.
8. CONSULT SALE STAFF FOR ARRANGEMENT AVAILABILITY.

NOTE(S):

MC: 72	FINISH: SEE NOTE 4
DESCRIPTION: CONNECTOR, RECEPTACLE	
HERMETIC WELD FLANGE MOUNT THREAD COUPLING MIL-DTL-38999/27	
ENVELOPE	
CP	CAGE CODE 11139
FOR BEST WORKMANSHIP PRACTICES, REFERENCE TE SPEC 101-32119	

THIS DRAWING IS A CONTROLLED DOCUMENT.		DWN 03MAR2022 DAVID CALVARIO	TE Connectivity	
DIMENSIONS: in		CHK 03MAR2022 JOSE APODACA		
TOLERANCES UNLESS OTHERWISE SPECIFIED:		APVD 03MAR2022 JOSE APODACA	NAME CONNECTOR, RECEPTACLE HERMETIC	
0 PLC ±.1 1 PLC ±.02 2 PLC ±.005 3 PLC ±.0005 4 PLC ±.0005		PRODUCT SPEC	SIZE CAGE CODE DRAWING NO RESTRICTED TO	
MATERIAL SEE NOTE 5		FINISH SEE NOTE 4	A2 00779 C-DTS23xxx-xxxx	
CUSTOMER DRAWING		SCALE 5:1	SHEET 1 OF 1 REV A	