

Project NR		REVISIONS			
P	LTB	DESCRIPTION	DATE	EDN	APPR
E		Création ; DM16-130 ; Diffusion 331955	10OCT2016	EL	MV

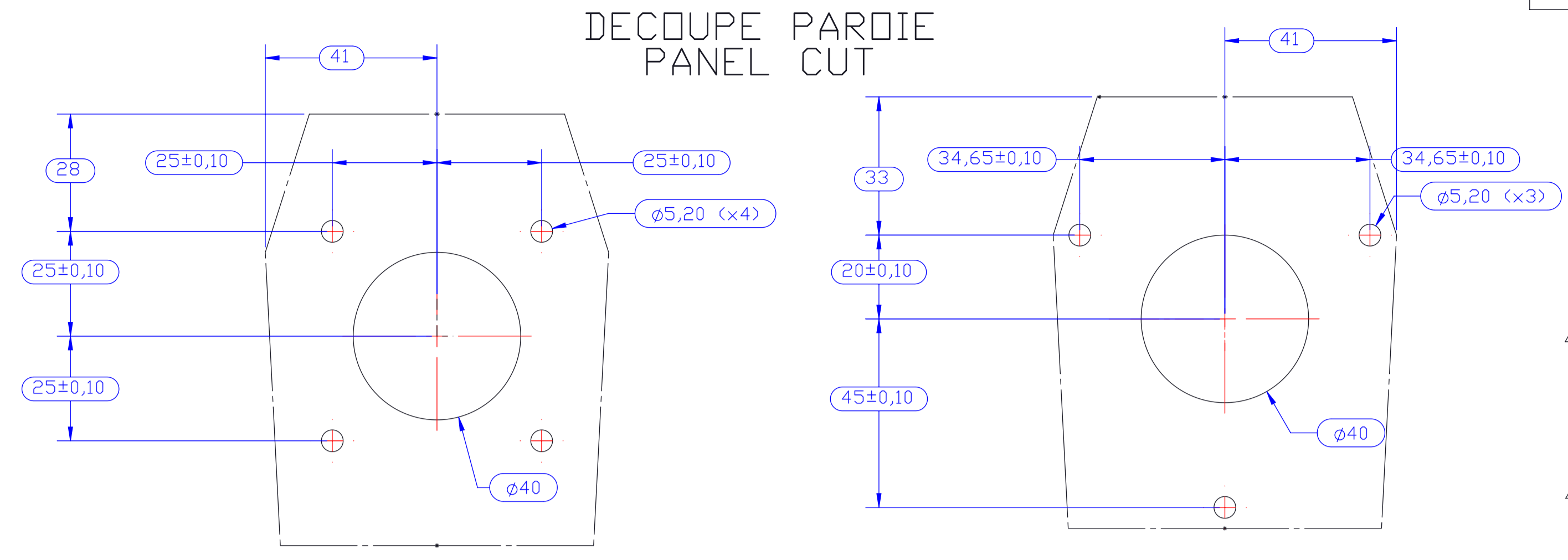

- 1 () : cotes pour information / dimensions for information
 () : cotes de controle / inspection dimensions
- 2 Instructions de mise en oeuvre à appliquer par le client
 Customer instructions to be applied by the customer
- 3 Marquage: CKB référence commerciale - année - semaine
 Marking: CKB Commercial reference - year - week
- 4 Cette boîte de repos peut recevoir une fiche 13 ou 18 points
 This dummy socket could be used with a 13 or 18 contacts plug
- 5 Clavette principale
 Principal key

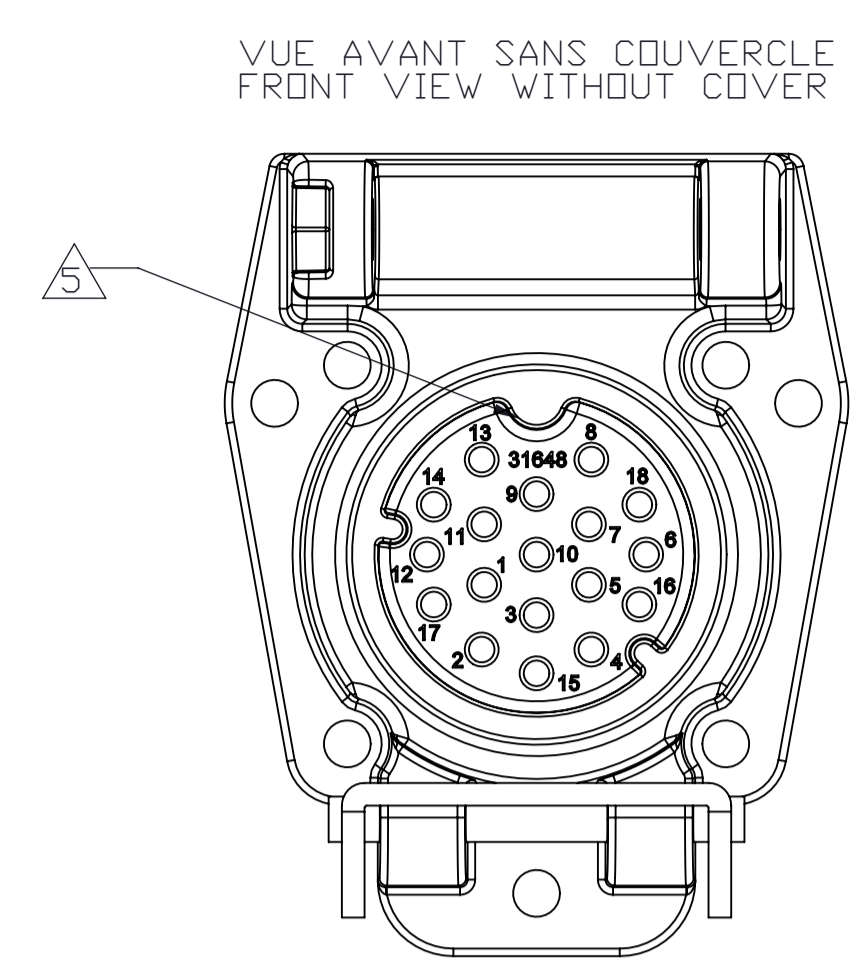
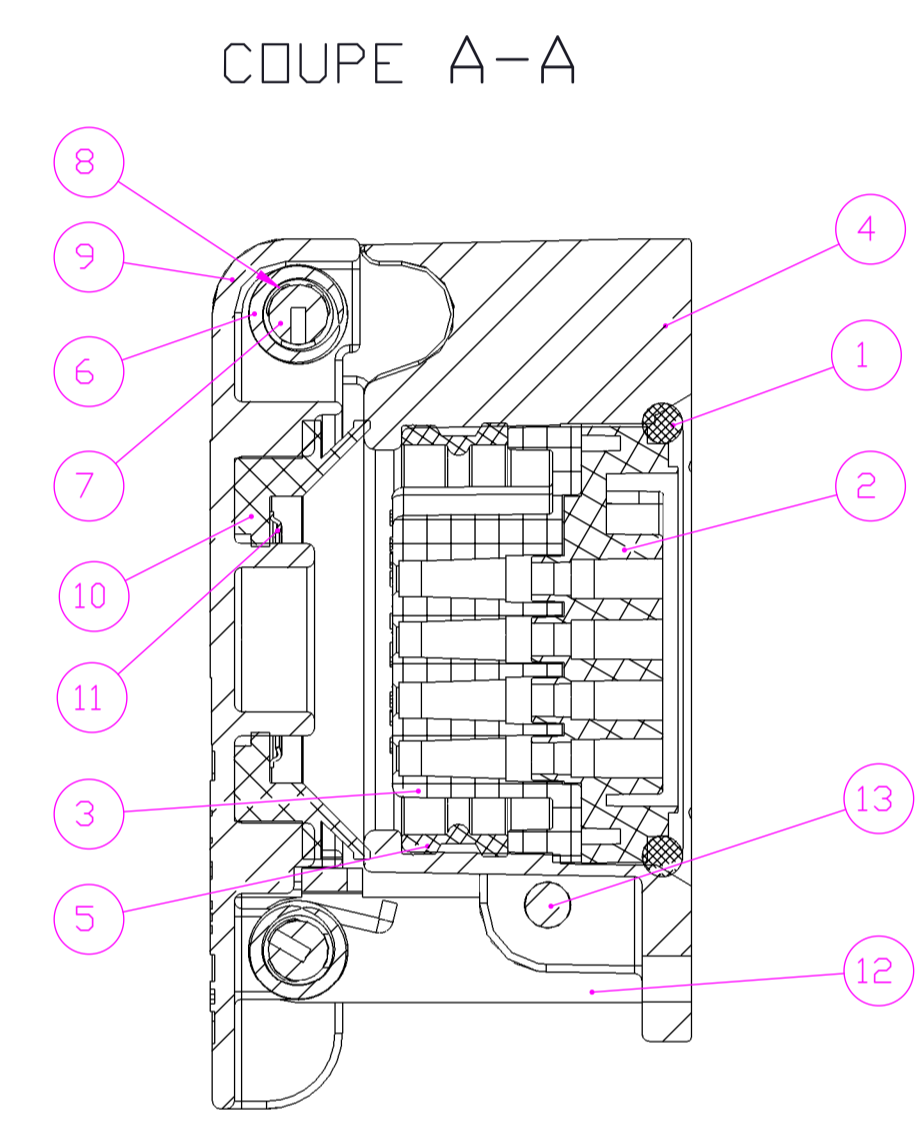
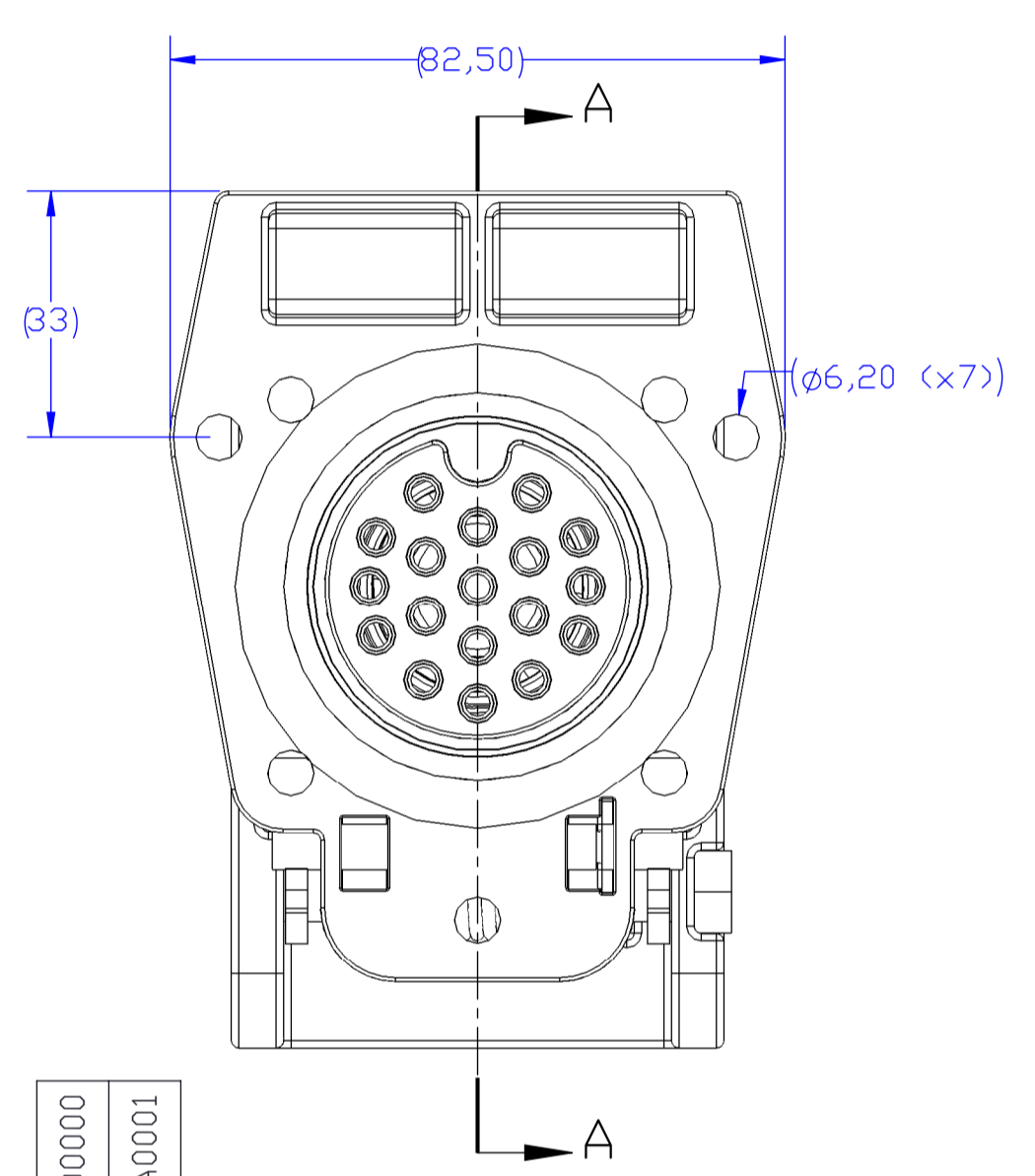
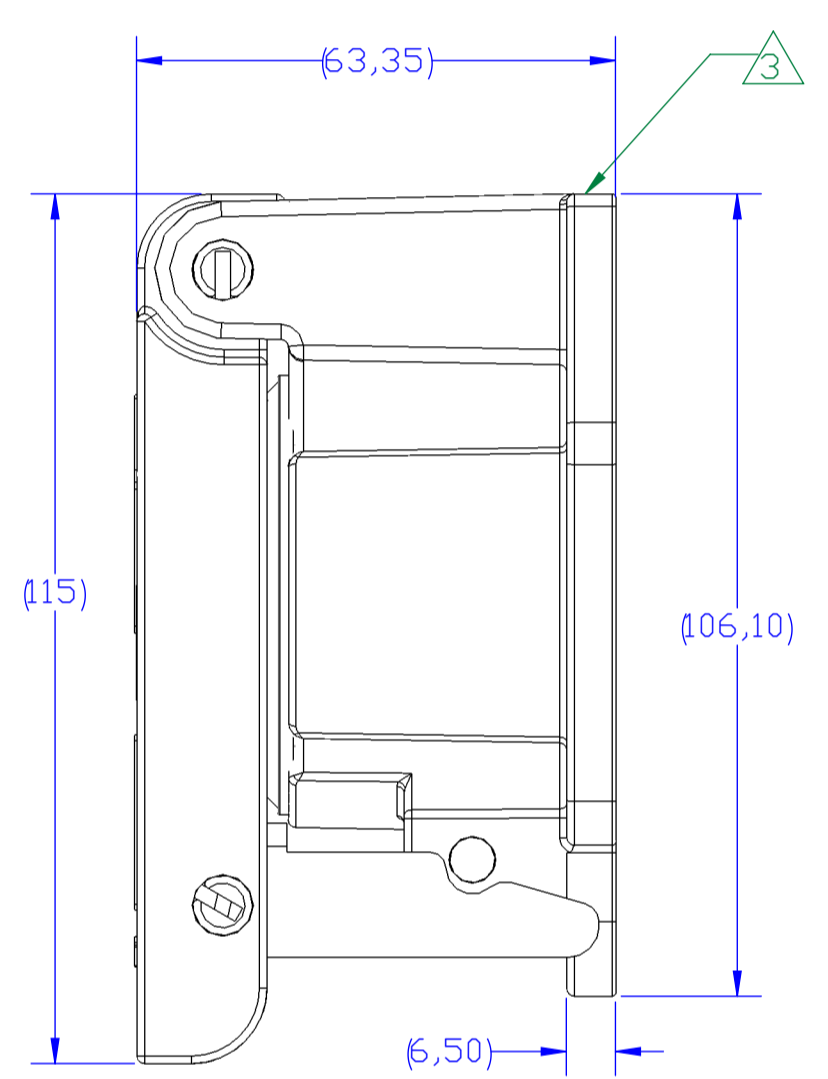
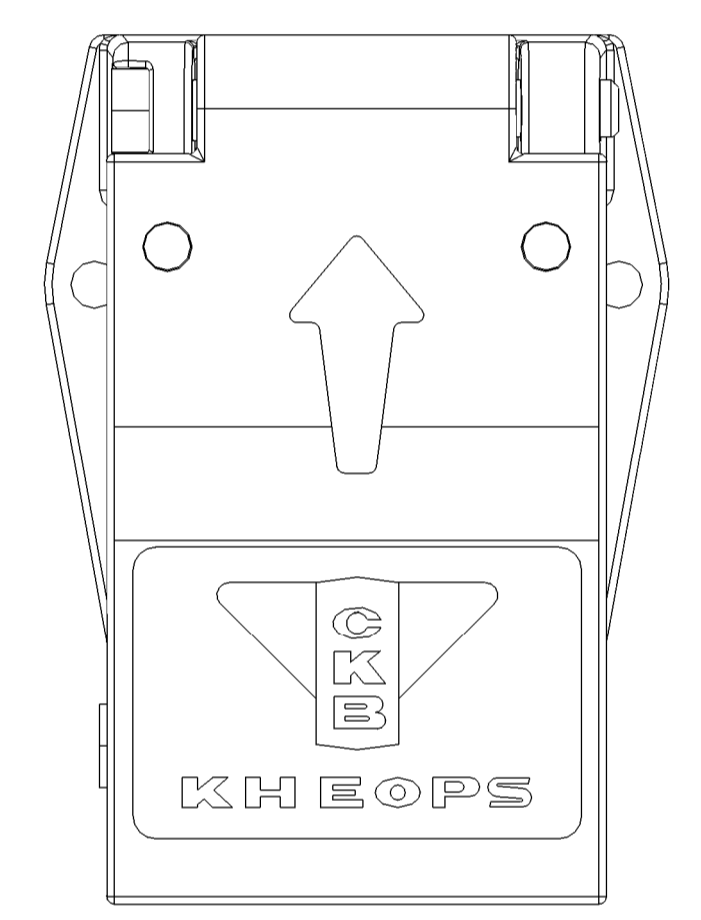

Observations	Protection	Fiche matière	Matière	Masse (g)	Nbr	Codification	Désignation	REP
Remarks	Plating	Data sheet	Material	Weight (g)	Qty	Part number	Designation	Item
-	-	-	Carton	40.08	1	Y00000-0206-0342AS	Boîte en carton	14
-	-	-	Carton				Box	X X
-	-	-	INDX	12.31	1	19208-000A4	Axe d'étrier	13
-	-	-	Stainless steel				Clamp axis	X X
-	-	-	INDX	36.74	1	24337-000A3	Etrier	12
-	-	-	Stainless steel				Clamp	X X
-	-	-	Acier	1.44	1	7115/25-34Y	Anneau self locking	11
-	-	-	Steel				Self locking ring	X X
-	-	-	Elastomère	14.38	1	24048-000A3	Joint de couvercle	10
-	-	-	Elastomere				Lid gasket	X X
-	-	-	Alodine 1200	152,7	1	31644-000L2	Couvercle	9
-	-	-	Alodine				Lid	X
-	-	-	Aluminium	152.66	1	31644-000A2	Couvercle	9
-	-	-	Aluminium				Lid	X
-	-	-	Acier	0.21	3	7133-06-W	Anneau truarc	8
-	-	-	Steel				Truarc ring	X X
-	-	-	Inox	24.20	2	19312-000A4	Axe de couvercle	7
-	-	-	Stainless steel				Cap axis	X X
-	-	-	Inox	11.30	2	19295-000A4	Ressort	6
-	-	-	Steel				Spring	X X
-	-	-	Elastomère	5.47	1	24235-000B3	Joint d'interface	5
-	-	-	Elastomer				Interfacial seal	X X
-	-	-	Alodine 1200	215,8	1	31645-000U1	Embase	4
-	-	-	Alodine				Socket	X
-	-	-	Aluminium	215.78	1	31645-000A1	Embase	4
-	-	-	Aluminium				Socket	X
-	-	-	Polyamide	48.66	1	31648-000A2	Isolant avant	3
-	-	-	Polyamide				Front insulator	X X
-	-	-	Polyamide	39.36	1	31647-000A2	Isolant arriere	2
-	-	-	Polyamide				Rear insulator	X X
-	-	-	Elastomère	3.81	1	0301-0228AS	Joint torique	1
-	-	-	Elastomere				O ring	X X

Commerciale reference	Part number
CSF1680-0003-00000	Y-E1680-0003-00000
CSF1680-0003-A0001	Y-E1680-0003-A0001

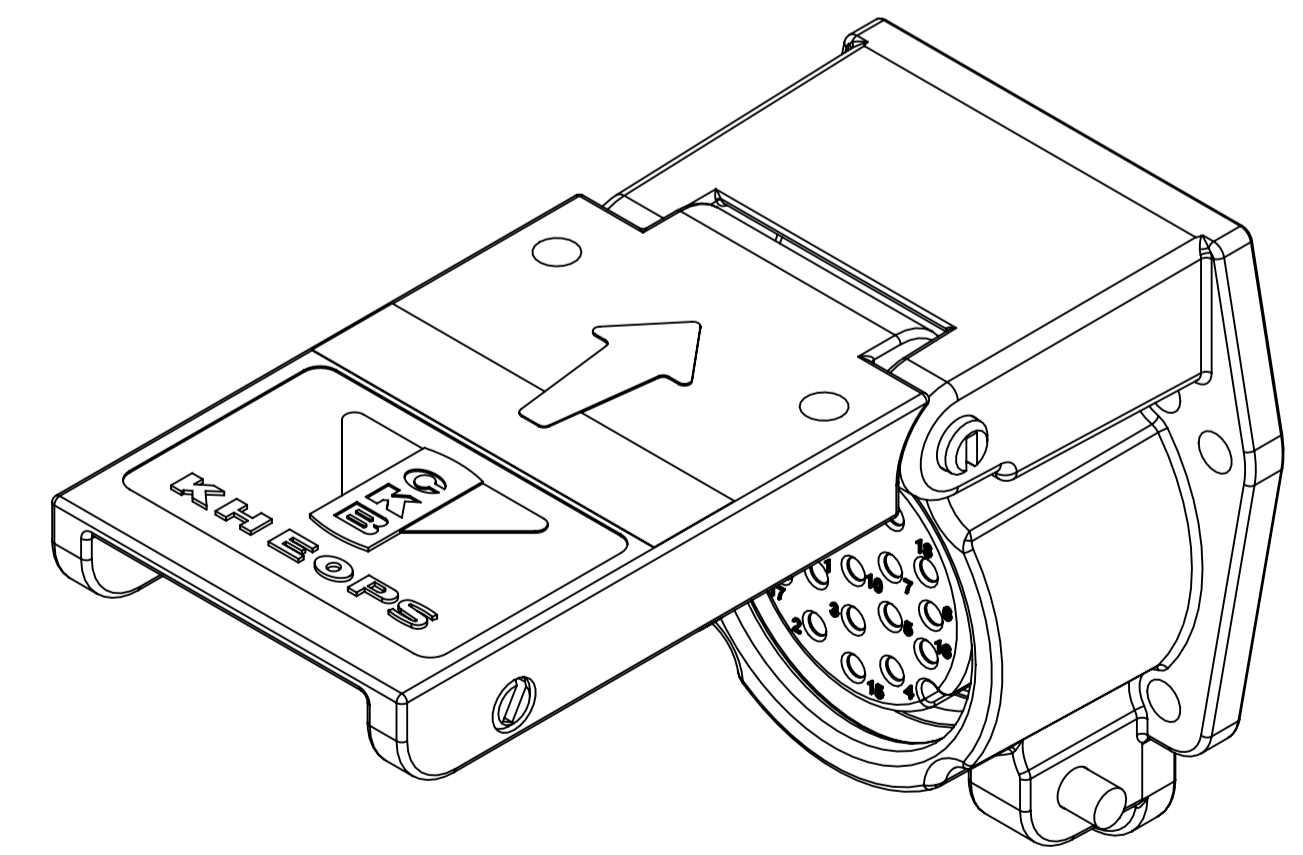

Référence commerciale / Commercial reference : See table

See table
PART NO

THIS DRAWING IS A CONTROLLED DOCUMENT.

DATE: 10OCT2016
 CHK: GLEMOINE
 APPR: M. VIMARD

TE Connectivity

Boîte de repos 18 point UIC558
 Dummy socket 18 point UIC558

WEIGHT: 642.45 g
 SCALE: 1:1
 SHEET: 1 OF 1
 REV: E