

REVISIONS					
P	LTR	DESCRIPTION	DATE	DWN	APVD
A		ORIGINAL ISSUE	01SEP2020	RS	KP

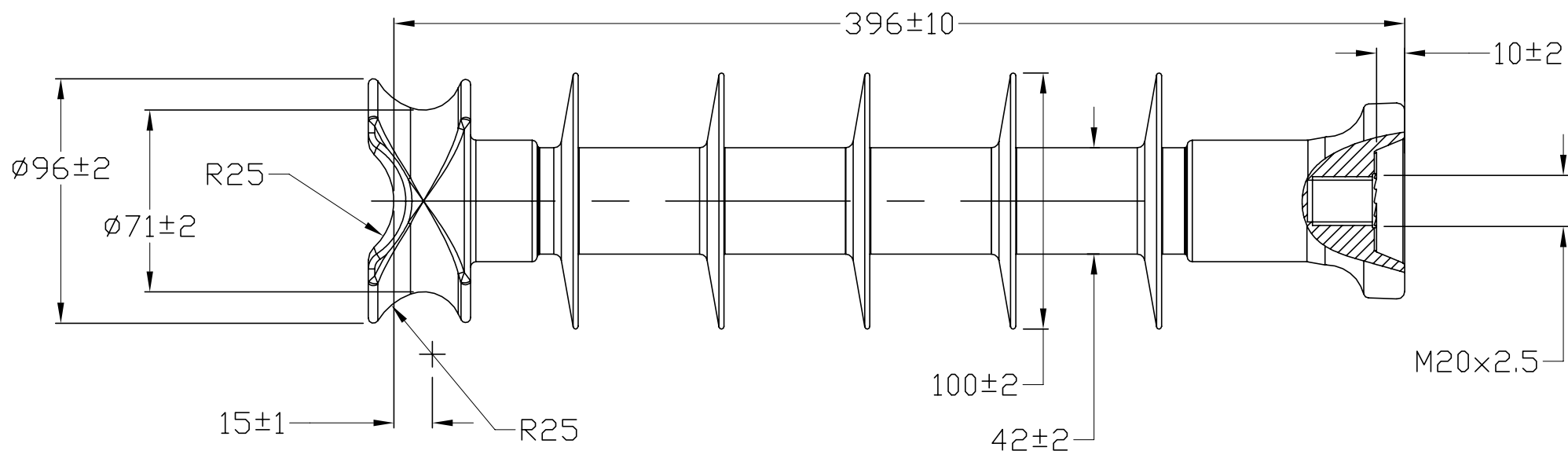

PHYSICAL PROPERTIES:

- 1. MINIMUM CREEPAGE DISTANCE : 515 mm
- 2. NOMINAL DRY ARCING DISTANCE : 285 mm

ELECTRICAL PROPERTIES:

- 1. DRY AC WITHSTAND VOLTAGE : 110 kV
- 2. WET AC WITHSTAND VOLTAGE : 100 kV
- 3. LIGHTNING IMPULSE WITHSTAND VOLTAGE : 190 kV

MECHANICAL PROPERTIES:

- 1. SPECIFIED CANTILEVER LOAD (SCL) : 9 kN
- 2. SPECIFIED TENSILE LOAD (STL) : 25 kN

MATERIALS:

- 1. CORE : ECR FIBERGLASS REINFORCED POLYMER
- 2. HOUSING : SILICONE RUBBER
- 3. END FITTINGS : HOT DIP GALVANISED STEEL
- 4. STANDARDS : IEC 61109 & IEC 61952

PRODUCT MARKINGS:

- 1. TE LOGO
- 2. DATE DIAL
- 3. SCL XX kN
- 4. BATCH NO #

EP4975-000
PART NO.

NOTES:

- UNSPECIFIED TOLERANCE
- 1) ±(0.04 x d + 0.06)inches WHEN d ≤ 11.8 inches
- 2) ±(0.025 x d + 0.23)inches WHEN d > 11.8 inches
- WITH MAX. TOLERANCE OF ±2 inches

THIS DRAWING IS A CONTROLLED DOCUMENT.		DWN	R.VI.S	01SEP2020	TE Connectivity		
		CHK	A.MIT.S	01SEP2020			
DIMENSIONS: mm		TOLERANCES UNLESS OTHERWISE SPECIFIED:			NAME CLP-09-FM20-190-515-M		
		0 PLC ± -			APVD		
		1 PLC ± -			K.PUSTHAY		
		2 PLC ± -			PRODUCT SPEC		
		3 PLC ± -			APPLICATION SPEC		
		4 PLC ± -			SIZE		
		ANGLES ± -			CAGE CODE		
MATERIAL SEE NOTES		FINISH -			DRAWING NO		
		WEIGHT APPROX. 3.3 kg			RESTRICTED TO		
		CUSTOMER DRAWING			A3 00779 ©=INS1823		
		SCALE NTS			SHEET 1 OF 1		
		REV A					