

PART AS SUPPLIED

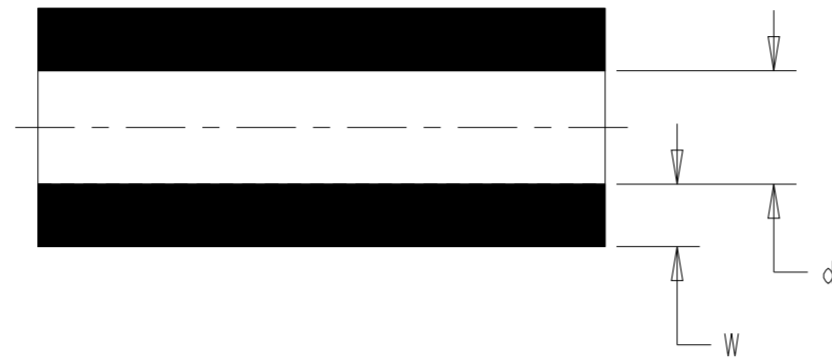

PART FULLY RECOVERED



ISOMETRIC VIEW (NTS)

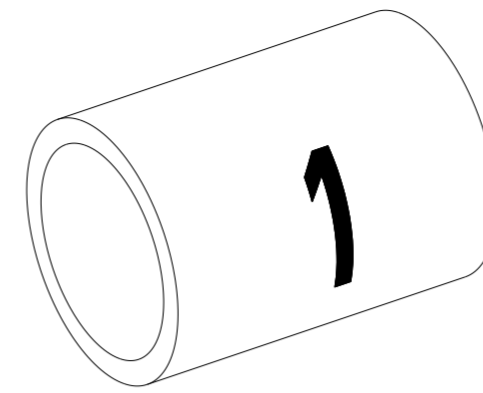

REVISIONS

P	LTR	DESCRIPTION	DATE	DWN	APVD
	A	INITIAL RELEASE	18AUG2023	BDA	VN

PRODUCT DIMENSIONS

PRODUCT SIZE	PRODUCT SIZE CODE	AS SUPPLIED		AS RECOVERED			
		MINIMUM INSIDE DIAMETER (D)		MAXIMUM INSIDE DIAMETER (d)		WALL THICKNESS (W)	
		mm.	in.	mm.	in.	mm.	in.
TRSA-1.5/0.5	A	1.50	0.059	0.50	0.020	0.45±0.10	0.018±0.004
TRSA-3/1	C	3.00	0.118	1.00	0.039	0.55±0.10	0.022±0.004
TRSA-6/2	E	6.00	0.236	2.00	0.079	0.65±0.10	0.026±0.004
TRSA-12/4	G	12.00	0.472	4.00	0.157	0.75±0.12	0.030±0.005

PRODUCT INFORMATION

1. FLAME RETARDANT
2. MATERIAL: HEAT-SHRINKABLE, FLEXIBLE POLYOLEFIN SLEEVING
3. COLOUR: SEE COLOUR CODE TABLE
4. SHRINK RATIO: 3:1
5. TUBING CUT TO SPECIFIC LENGTHS CAN BE SUPPLIED FROM THE PRODUCT SIZES REFERENCED WITHIN THIS DRAWING
6. FOR UNIQUE INDIVIDUAL SYMBOLS PLEASE CONTACT PRODUCT MANAGEMENT

CUT LENGTH CODE

CODE	CUT LENGTH (NOM), MM			
	A	C	E	G
1	5	5	7	9
2	8	8	11	-

COLOUR CODE

1010 BLACK	1013 ORANGE	1016 BLUE	1019 WHITE
1011 BROWN	1014 YELLOW	1017 VIOLET	1111 MULTI COLORED-ONLY AVAILABLE AS CC-KIT
1012 RED	1015 GREEN	1018 GREY	

KIT CODES	PACK QUANTITY (PIECES)	
AU-KIT	A-Z LETTERS IN UPPER CASE, AVAILABLE IN SIZES A,C & E.	26,000 (1000 PER LETTER)
AL-KIT	a-z LETTERS IN LOWER CASE, AVAILABLE IN SIZES A,C & E.	26,000 (1000 PER LETTER)
N-KIT	NUMBER 0-9, AVAILABLE IN SIZES A,C & E.	10,000 (1000 PER NUMBER)
CC-KIT	TEN RESISTOR COLOURS PRINTED WITH THE RESPECTIVE NUMERIC CODES, AVAILABLE IN SIZES C & E ONLY.	10,000 (1000 PER NUMBER)

ORDERING INFORMATION:
 TRSA PRODUCT DESCRIPTIONS ARE BUILT UP FROM A SERIES OF CODES AS FOLLOWS:
 TRSA-COLOUR CODE/PRODUCT SIZE CODE/CUT LENGTH CODE/KIT CODE OR LEGEND TO BE PRINTED.

EXAMPLES OF TRSA DESCRIPTIONS:
 TRSA-1014/C/1/AU-KIT KIT OF UPPER CASE LETTERS PRINTED ON YELLOW 3.0/1.0 SIZE SLEEVES
 TRSA-1015/A/1/1 NUMBER 1 PRINTED ON GREEN 1.5/0.5 SLEEVES

STANDARD CUTTING TOLERANCES(mm)	
CUT LENGTH	TOLERANCE
UPTO TO 9.90mm	±1.50mm
10mm TO 24.90mm	±1.50mm
25mm TO 54.90mm	±1.50mm
55mm TO 99.90mm	±3.00mm
100mm TO 149.90mm	±4.00mm
150mm TO 499.90mm	±5.00mm
500mm AND GREATER	±25.40mm

THIS DRAWING IS A CONTROLLED DOCUMENT.

DIMENSIONS:
mm(inches)

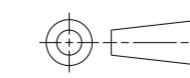

MATERIAL
SEE NOTE

TOLERANCES UNLESS OTHERWISE SPECIFIED:
 0 PLC ±0.5
 1 PLC ±0.13
 2 PLC ±0.13
 3 PLC ±0.013
 4 PLC ±0.001
 ANGLES ±
 FINISH -

DWN	18AUG2023
CHK	BASAVARAJA D A
CHK	SELVAPANDIAN B
APVD	18AUG2023
APVD	VLADIMIR NEMEC
PRODUCT SPEC	RK-6743
APPLICATION SPEC	-
WEIGHT	-
CUSTOMER DRAWING	



NAME TRSA SLEEVING

SIZE	CAGE CODE	DRAWING NO	RESTRICTED TO
A2	-	G-TRSA	-

SCALE 5:1 SHEET OF REV A