



intercontec
products

958 Receptacle

8-pin
Earth-to-Housing Connection according to VDE 0627
flange mount / Flange 56x56

Technical Data

number of pins 8
power 4 (3+PE)
signal 4
temperature range -20 °C to 130 °C
protection type when connected IP 66/67

Electrical Data

	power	signal
rated current	max. 150 A*	max. 12 A*
rated voltage	630V (AC/DC)	250 V (AC/DC)
rated insulation voltage (L-L)	6000 V	4000 V

mating cycles 500

Data according to VDE 0110/EN61984, Paragraph 6.19.2.2

pollution degree 3
over voltage category III
max. height for operation 2000 m

Material

housing zinc diecast / nickel plated
insulation insert PBT, UL 94 / V0
seals FKM
contacts brass / silver plated
contacts brass / gold plated

Contacts

Item / TCPN: 61.112.23 / 61-0112-023-000
type Contact Pin \varnothing 10.0 mm
cross section crimp/ 10.00mm²
contact resistance < 90 μ Ohm

Item / TCPN: 61.117.11 / 61-0117-011-000
type Contact Pin \varnothing 1.6 mm
cross section crimp/ 0.35 - 1.50 mm²
contact resistance < 5 mOhm

Tools (not part of product contents)

Battery crimp tool
Item / TCPN: C0.207.00 / C0-0207-000-000

Crimping Inserts
Item / TCPN: C0.211.00 / C0-0211-000-000

analog crimping tool for 1 mm-/2 mm- contacts
Item / TCPN: C0.201.00 / C0-0201-000-000

D EG A 003 MR 01 00 0001 000
D E A 003 M 01 00 0001 000



Contact Arrangement

mating view



Contact Pin \varnothing 10.0 mm

crimp/ 10.00mm²
Item: 61.112.23
TCPN: 61-0112-023-000



Contact Pin \varnothing 1.6 mm

crimp/ 0.35 - 1.50 mm²
Item: 61.117.11
TCPN: 61-0117-011-000



© 2018 TE Connectivity

TE Connectivity, TE connectivity (logo), intercontec (logo) and speedtec are trademarks.

While TE Connectivity (TE) has made every reasonable effort to ensure the accuracy of the information in this presentation, TE does not guarantee that it is error-free, nor does TE make any other representation, warranty or guarantee that the information is accurate, correct, reliable or current. TE reserves the right to make any adjustments to the information contained herein at any time without notice. TE expressly disclaims all implied warranties regarding the information contained herein, including, but not limited to, any implied warranties of merchantability or fitness for a particular purpose. The dimensions in this article are for reference purposes only and are subject to change without notice. Specifications are subject to change without notice. Consult TE for the latest dimensions and design specifications.

TE Connectivity Industrial GmbH
Bernrieder Straße 15
94559 Niederwinkling, Deutschland
Tel.: +49 9962 2002-0
Fax: +49 9962 2002-70
E-Mail: intercontec@te.com
Web: www.intercontec.biz

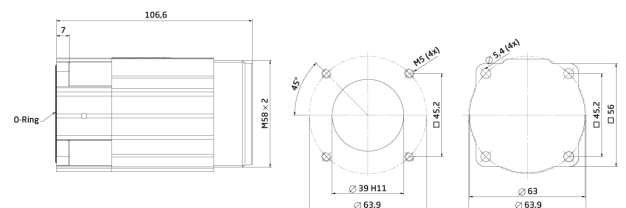

Main Dimensions

Receptacle

*for max. wire cross-section pay attention to the cross-section of used contacts

issue: 03.09.2018