



KISSLING HIGH PERFORMANCE RELAYS

Series 26 / 350A|500A - from TE Connectivity (TE)

KISSLING 26 series dual coil relays are developed using our competence and expertise gathered over decades of manufacturing to meet demanding operating requirements.

This dual coil system relay features extremely high shock and vibration resistance predominantly from careful design and an optimized magnetic circuit. The sealing technology used in these relays meet both the IP67 and IP69K (Steam pressure cleaning) protection standard. This relay series is well suited for various applications in severe commercial, military and aviation applications.

Other important advantages are low heat generation in the contact area based on low contact voltage drop, a compact design, low holding current, silver alloy contact material and the use of mechanical and high thermal stability insulating compounds. Both the terminals and housing is corrosion resistant.

These relays are available with a wide variety of configuration options including contact configurations (NO, NC) coil voltages (12V, 24/28V) and various bracket styles to meet your installation conditions. Also available are optional suppression devices to eliminate electromagnetic interference at the coils and optional auxiliary contacts.

Features

- Sealed housing conforms to IP6K9K
- Dual-Coil monostable high performance relay with optional auxiliary contact
- Up to 30G shock & 10G vibration resistant
- Military grade performance
- Wide variety of configuration options for individual needs
- Meets the requirements of MIL-R-6106

Applications

- Truck
- Bus
- Ground support vehicles
- Construction and agricultural vehicles
- Power Distribution
- Aviation industry
- Military

SERIES 26

350A/500A

Specification

Technical Data	350A	500A
Temperature range	-55°C to +130°C	-55°C to +74°C
Max. Altitude rating	50.000 ft	
Protection	IEC 60529 & DIN 40050-9, IP67 (0,2 bar; 1min) & IP6K9K	
Shock	30G - 11msec MIL-STD-202	
Vibration	10G (10-2000Hz) MIL-STD-202	
Acceleration	15G	
Thread sizes	M4 = 2.0-2.2Nm / M12 = 18-22Nm	
Wire section	min. 150mm ² / 0.233 sq.inch / MCM 300	min. 240mm ² / 0.372 sq.inch / MCM 500
Mounting position	optional	

Electrical Characteristics	350A	500A
Min. Insulation Resistance	100MΩ	100MΩ
After llve or environmental	50MΩ	50MΩ
Dielectric withstanding voltage	1050VAC / 1min at 50Hz	1050VAC / 1min at 50Hz
Max. Contact drop, initial	150mV	150mV
Contact drop after life test	175mV	175mV
Continuous current	350A	500A
Overload	2400A - 1sec / 800A - 60sec / 600A - 300sec	4000A - 1sec / 1000A - 20sec
Rupture current	3500A	5000A
Auxiliary contacts	Continuous current 8A / Make and Brake 16A	

Coil Data	12VDC	24 / 28 VDC
Voltage range	9-16VDC	18-32VDC
Nominal voltage	12VDC	24/28VDC
Pick up voltage max.	9VDC	18VDC
Drop out voltage	≤ 4VDC	≤ 7VDC
Coil resistance	20Ω ± 10%	82Ω ± 10%
Coil current max.	0.60A	0.35 / 0.40A

Rated contact load (24/28VDC)	350A	500A
Resistive load	50.000 cycles - 350A	50.000 cycles - 500A
Mechanical Life	100.000 cycles - 85A	100.000 cycles - 125A

Operating times	NO Contact	Operating times	NC Contact
Operate	max. 25msec	Break time	max. 20msec
Bounce	max. 5msec	Make time inc. bounce	max. 40msec
Release	max. 80msec		

Available Types

	Type Ordering key	Contact		UNC threads	Side mounting	2-hole bot- tom mount.	4-hole bot- tom mount.	Suppression device	Polarity protection	Auxiliary contact	Weight kg / pound
		NO	NC								
24V / 28V 350A	26..06.01	x			x			x	x		1.20 / 2.70
	26..06.03	x			x			x	x	x	1.20 / 2.70
	26..06.11	x				x		x	x		1.25 / 2.80
	26..06.13	x				x		x		x	1.25 / 2.80
	26..06.21	x					x	x	x		1.30 / 2.90
12V 500A	26..05.251	x			x			x			1.20 / 2.70
24V / 28V 500A	26.05.01	x			x			x	x		1.20 / 2.70
	26.05.03	x			x			x	x	x	1.20 / 2.70
	26.05.11	x				x		x	x		1.25 / 2.80
	26.05.21	x					x	x	x		1.30 / 2.90
	26.05.51	x			x			x			1.20 / 2.70
	26.05.52	x		x	x			x			1.20 / 2.70
	26.05.61	x				x		x			1.25 / 2.80
	26.05.62	x		x		x		x			1.25 / 2.80
	26.05.63	x				x		x		x	1.25 / 2.80
	26.05.71	x					x	x			1.25 / 2.80
	26.25.01		x			x		x	x	x	1.20 / 2.70
	26.25.11		x				x	x	x	x	1.20 / 2.70
	26.25.21		x					x	x	x	1.25 / 2.80

Other types and customer specified types upon request

Circuits

NO-Contact

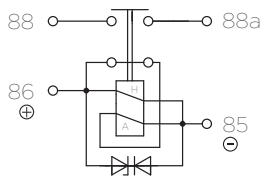

NO-Contact with polarity protection

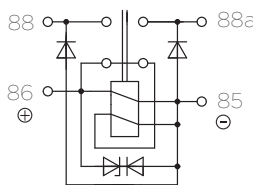

NO-Contact with auxiliary contact

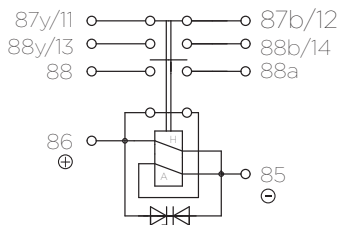

NO-Contact with auxiliary contact and polarity protection

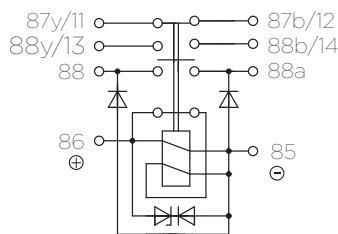

NO-Contact with auxiliary contact and polarity protection

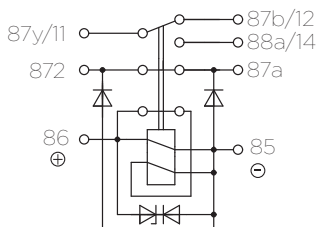

NO-Contact UNC-version with US-Termination

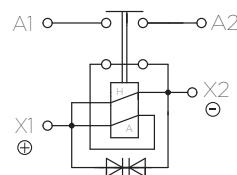

Accessories

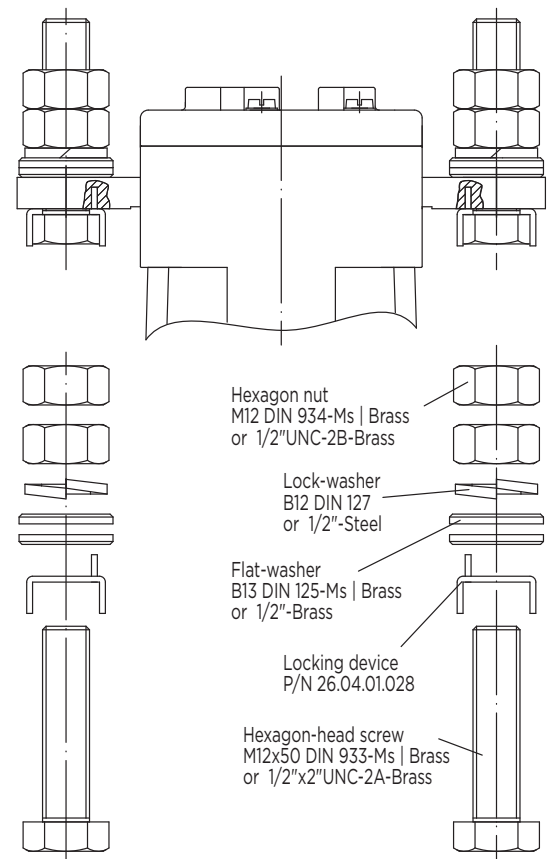

Technical drawings

Side mounting

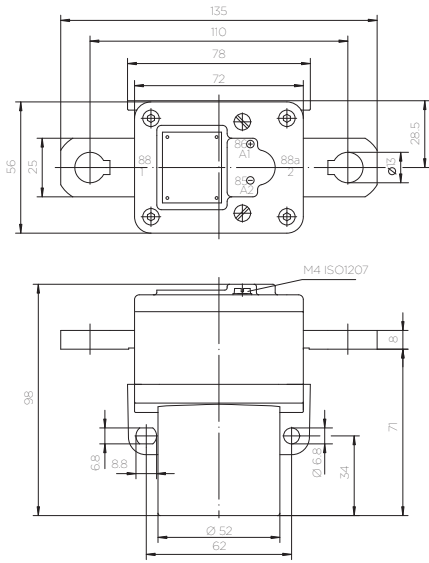

Side mounting NO-Contact with auxiliaries

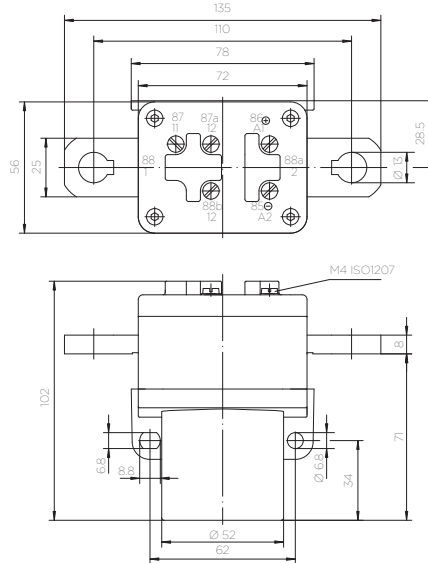

2-hole bottom mounting

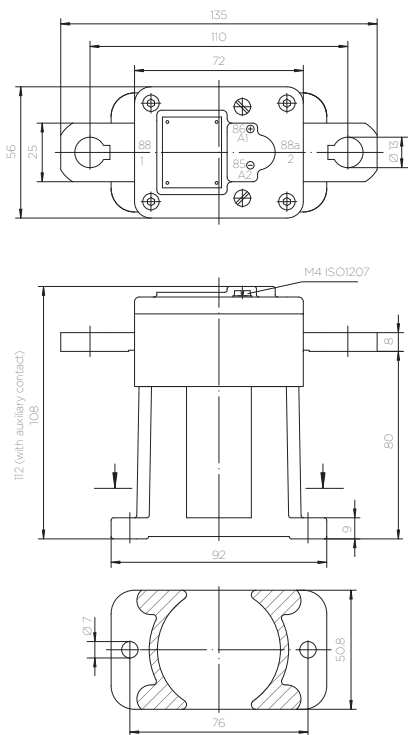

4-hole bottom mounting

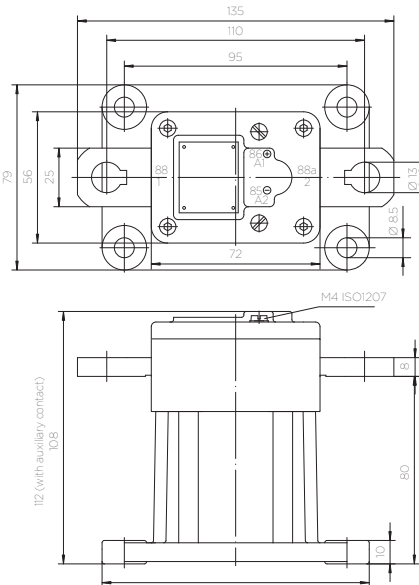

te.com

TE Connectivity, TE, TE connectivity (logo), KISSLING (logo) and KISSLING (word) are trademarks owned or licensed by the TE Connectivity family of companies. All other logos, products and/or company names referred to herein might be trademarks of their respective owners.

The information given herein, including drawings, illustrations and schematics which are intended for illustration purposes only, is believed to be reliable. However, TE Connectivity makes no warranties as to its accuracy or completeness and disclaims any liability in connection with its use. TE Connectivity's obligations shall only be as set forth in TE Connectivity's Standard Terms and Conditions of Sale for this product and in no case will TE Connectivity be liable for any incidental, indirect or consequential damages arising out of the sale, resale, use or misuse of the product. Users of TE Connectivity products should make their own evaluation to determine the suitability of each such product for the specific application.