

UPDATES

Date	INDICE	Description
22/04/99	A1	Creation
13/01/2000	B1	Update after attach modification

DIFFUSION		
Date	INDICE	RECIPIENTS
22/04/99	A1	R. Giacomello, J.J. Lefevre L. Baratto, N. Gérin
13/01/2000	B1	R. Giacomello, J.J. Lefevre L. Baratto, N. Gérin

SUMMARY

NOMENCLATURE	Page 3/8
MECHANICAL INTERFACES	Page 4/8
PACKAGING	Page 5/8
CONNECTORS UNPACKAGING	Page 6/8
CONNECTORS SPLITTING	Page 7/8

NOMENCLATURE

DESIGNATION	TE PN	Proner
Multiways female connector	1544388-x	3905 C 001
Insulator		3905 D 001
Contact		3905 D 002

MECHANICAL INTERFACES

The multiways female connector enables the connexion from a PCB to a molded frame.

The geometrical requirements for a proper interface are detailed on drawing 3905 R001 attached.

PACKAGING : Following GALIA NORM

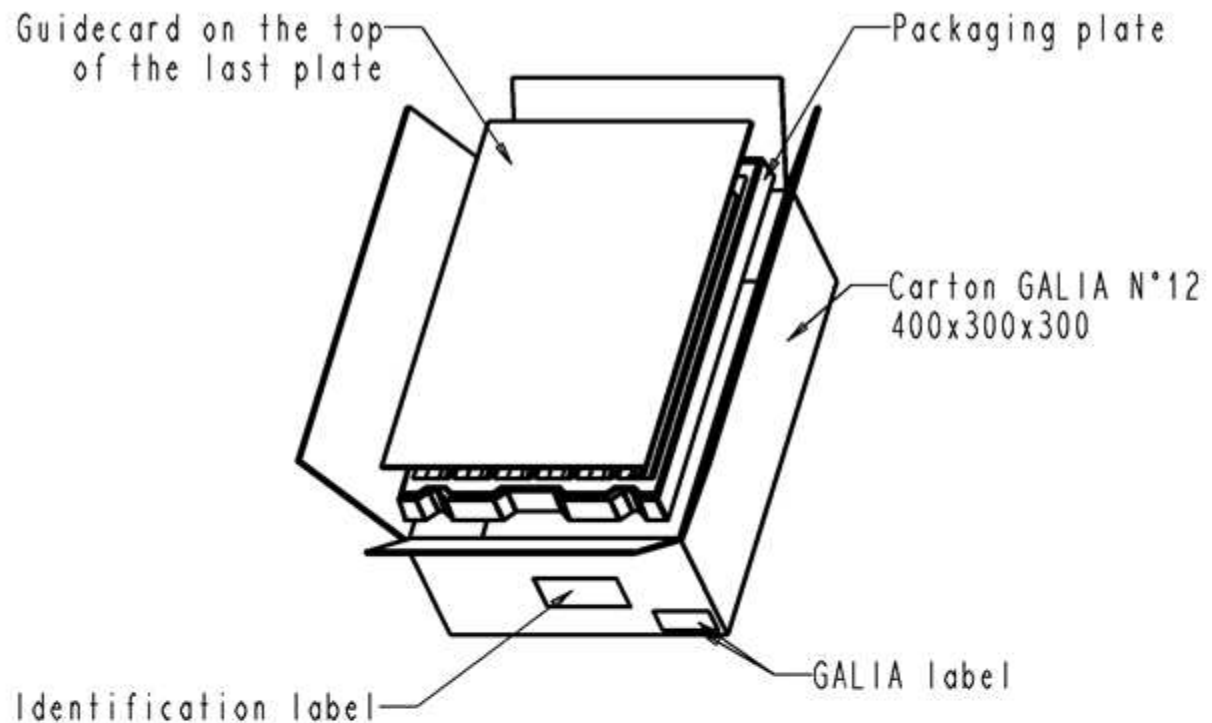

DESIGNATION	Multiways female connector
GALIA carton type	N° 12
Number of connectors by plate	90
Number of plate by carton	29
Carton weight	11 Kg

IMPORTANT:

- Connectors shall be removed from the packaging just before usage.
- Plates must be unpacked one by one.

CONNECTORS UNPACKAGING

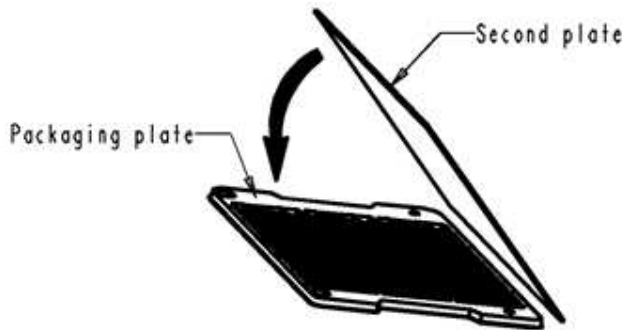

- ① - Take one packaging plate out of carton.
 - Put the second plate on the top of the packaging one.



- ② - Return both plates.



- ③ - Remove the packaging plate carefully.

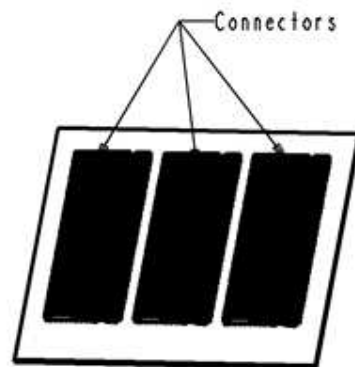

- ④ - Take connectors, one by one, as described on page 7/8.

CONNECTORS SPLITTING 1/2

The sketch here after shows how to handle the connector in order to split it without damage.

FIRST OPERATION :

Split the connector as shown

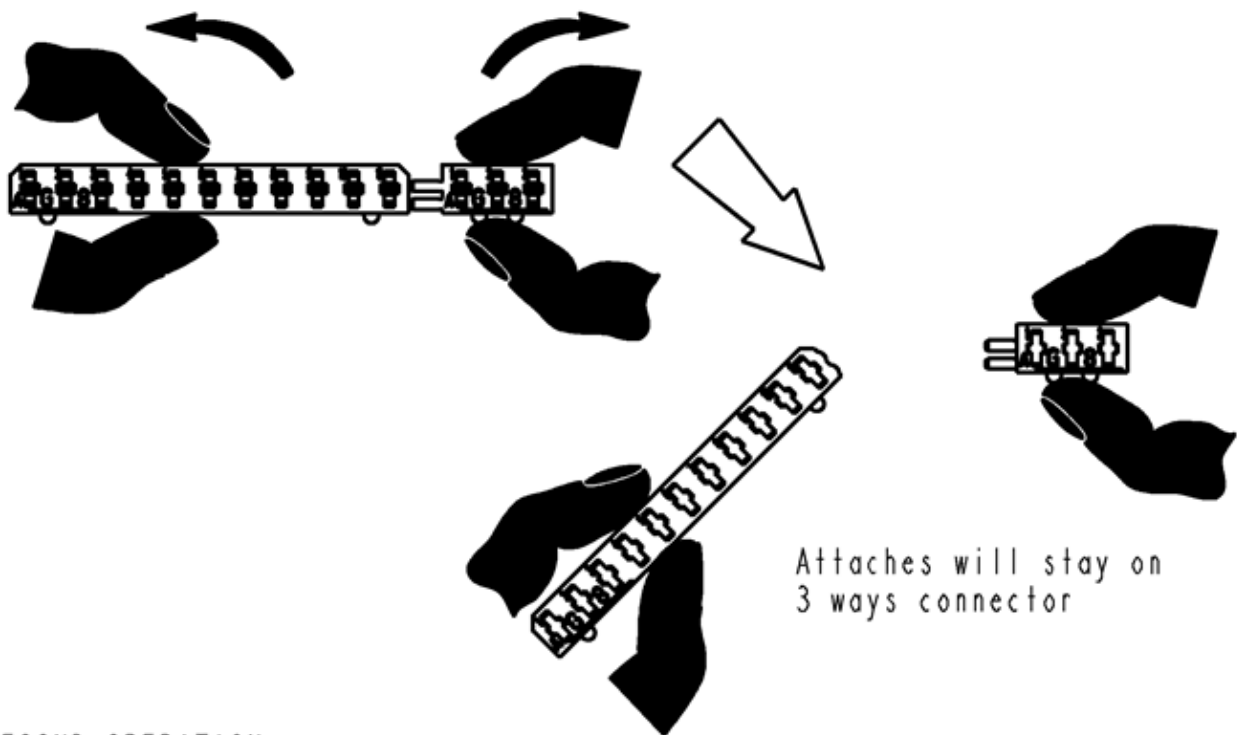

SECOND OPERATION :

Removing of the remaining attaches may be done easily as shown here after

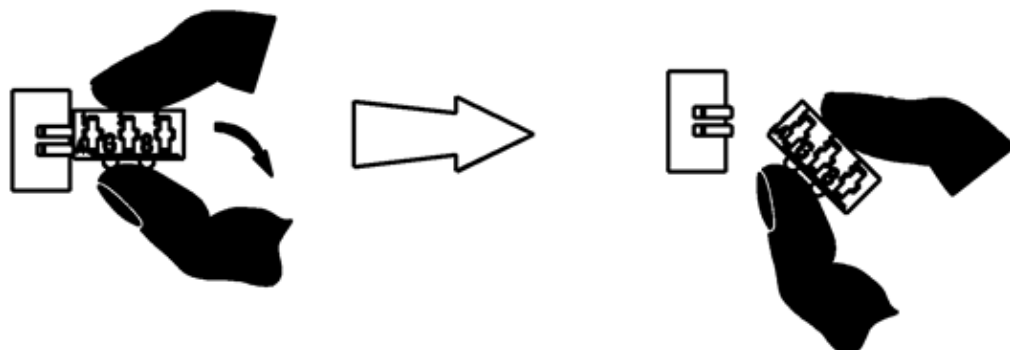

CONNECTORS SPLITTING 2/2

One have to pay attention to NOT TOUCH
the contact pins which are fragile.

