

REVISIONS			
REV.	DESCRIPTION	DATE	BY
A	SEE PCK EG00-0549-98-6	03.09.98	Me...

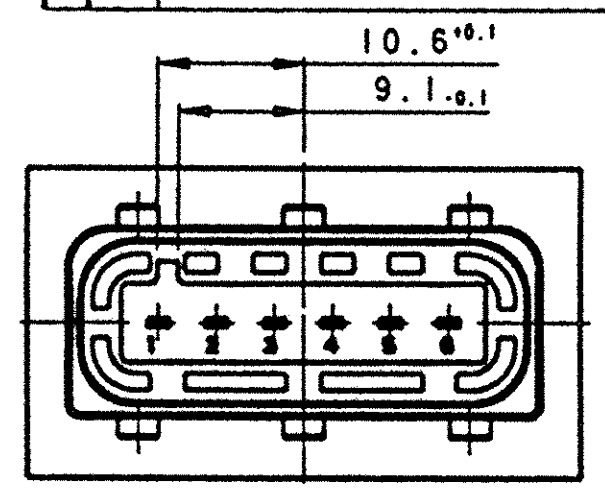

CODING A
Kodierung A

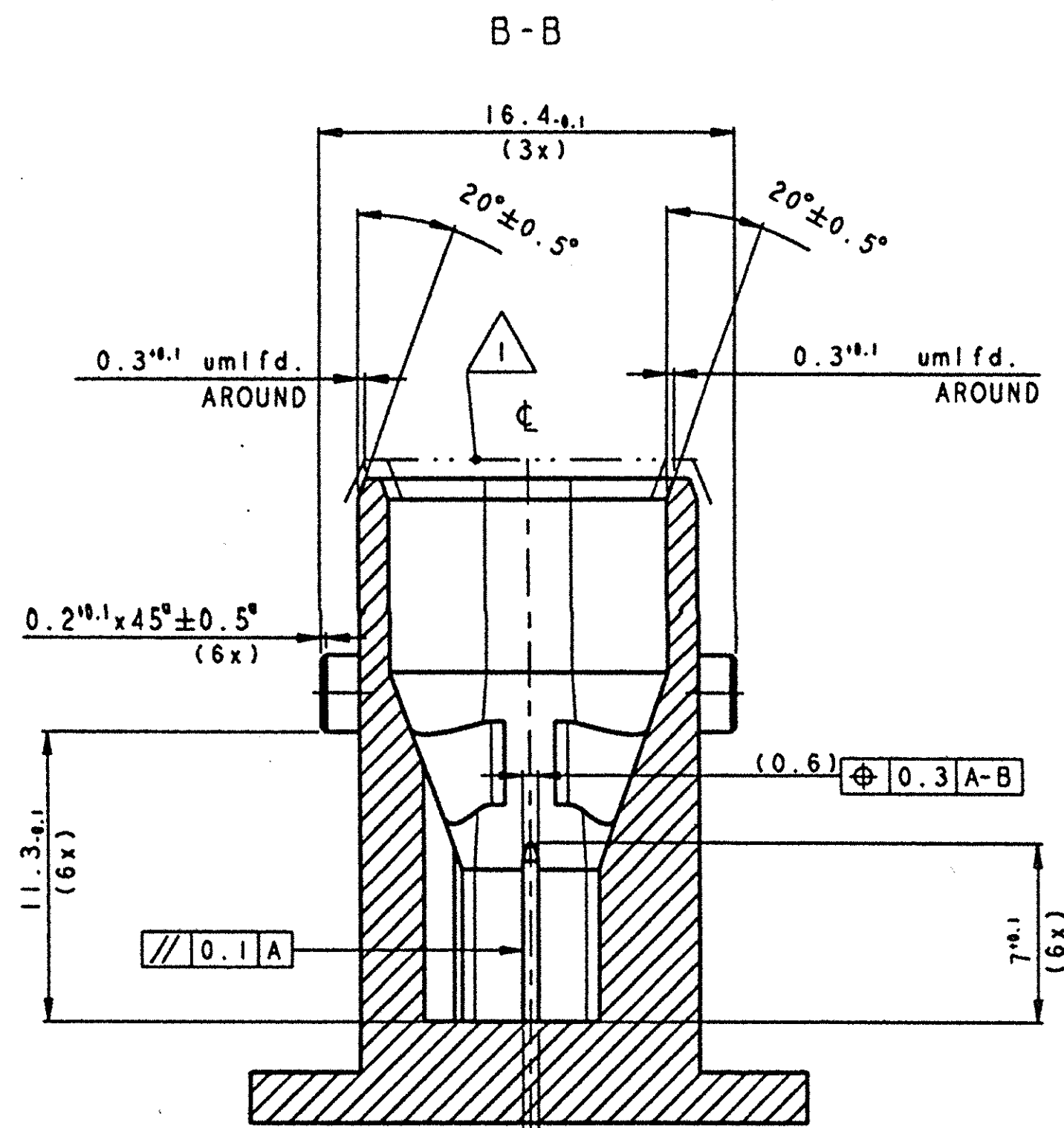
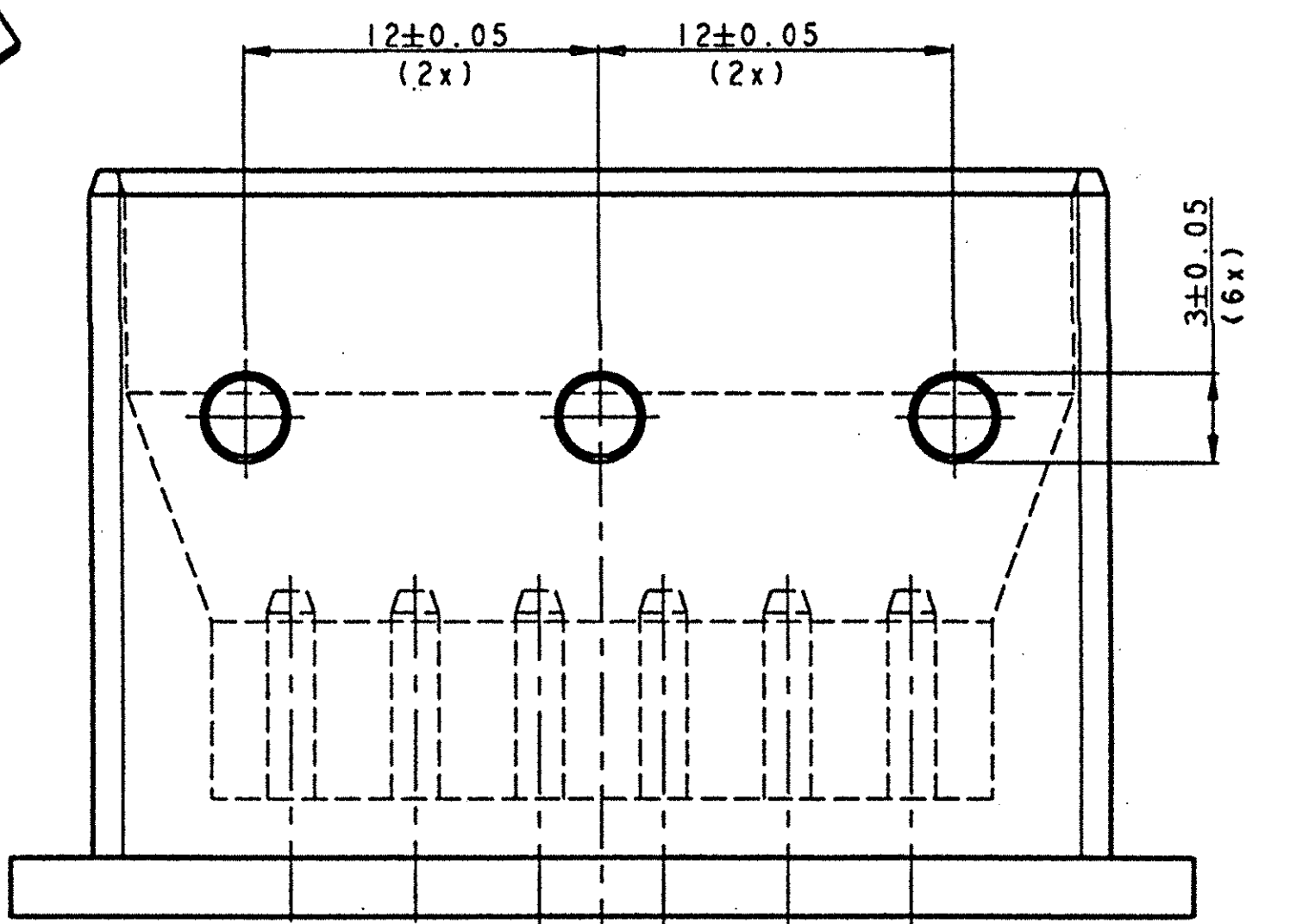
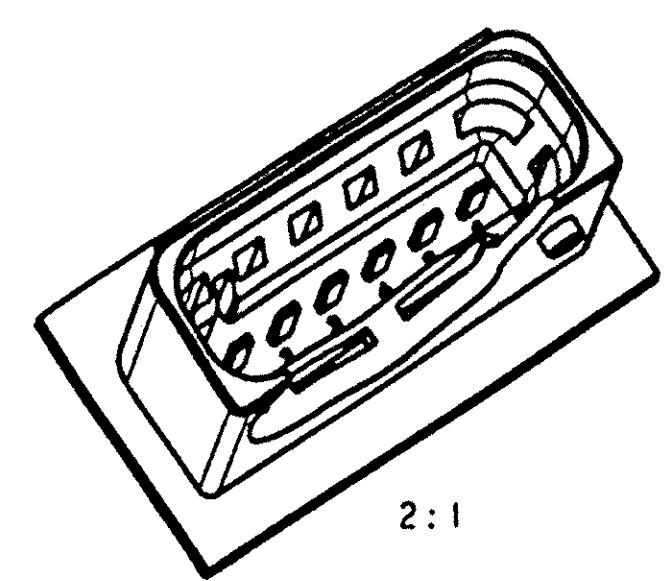
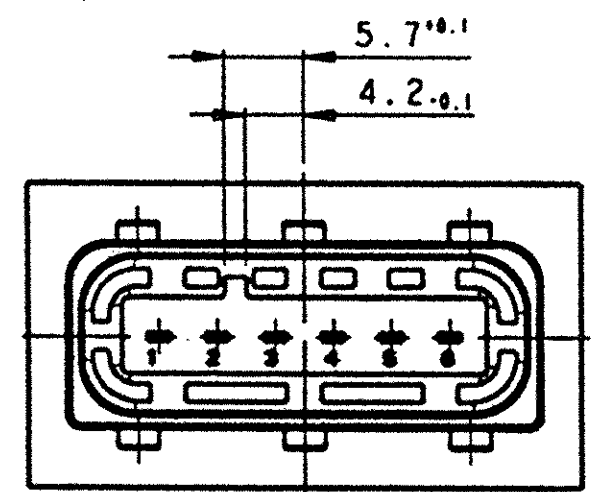

CODING B
Kodierung B

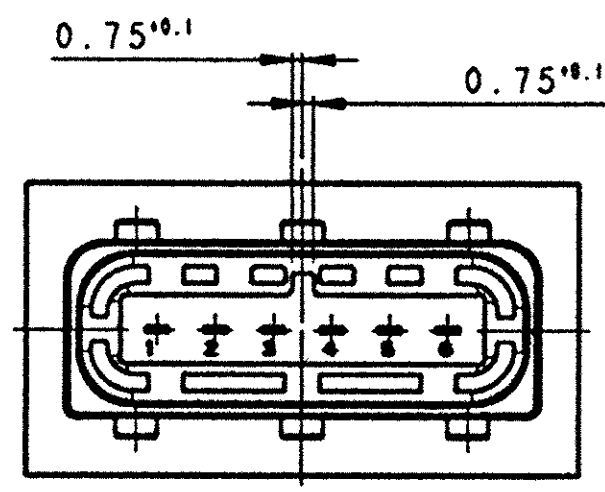

CODING C
Kodierung C

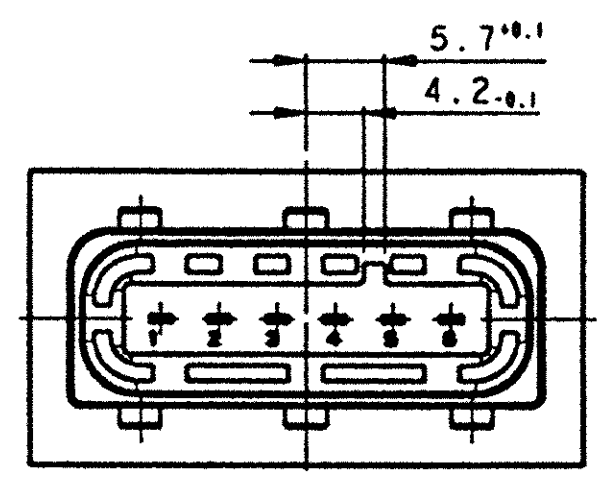

CODING D
Kodierung D

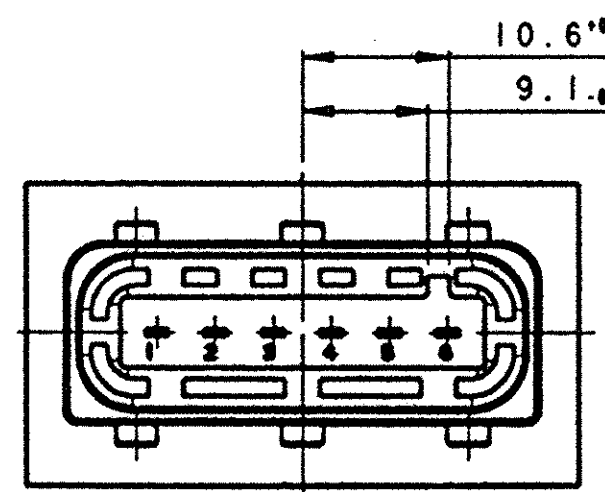

CODING E
Kodierung E

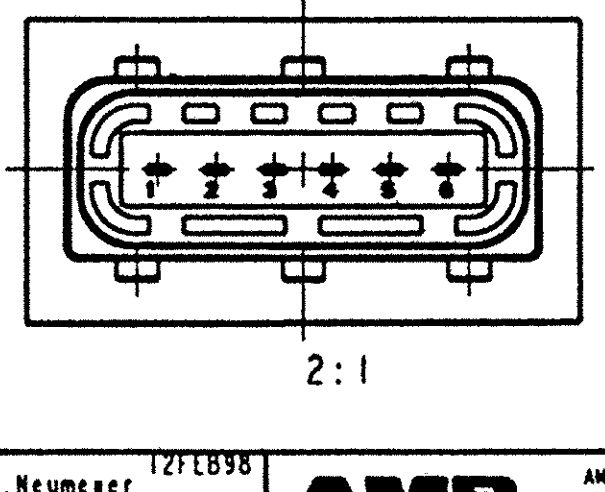

CODING N
Kodierung N

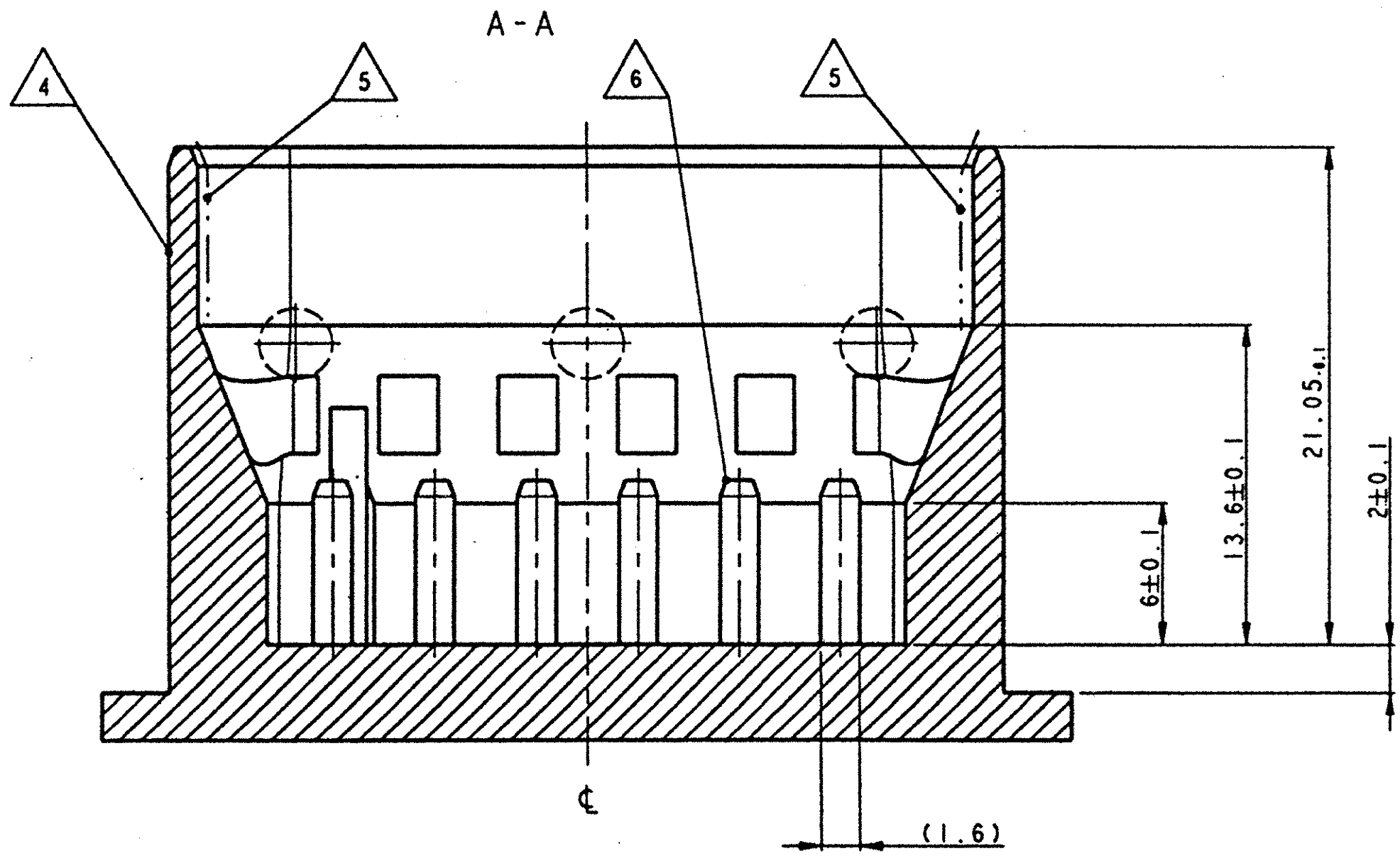
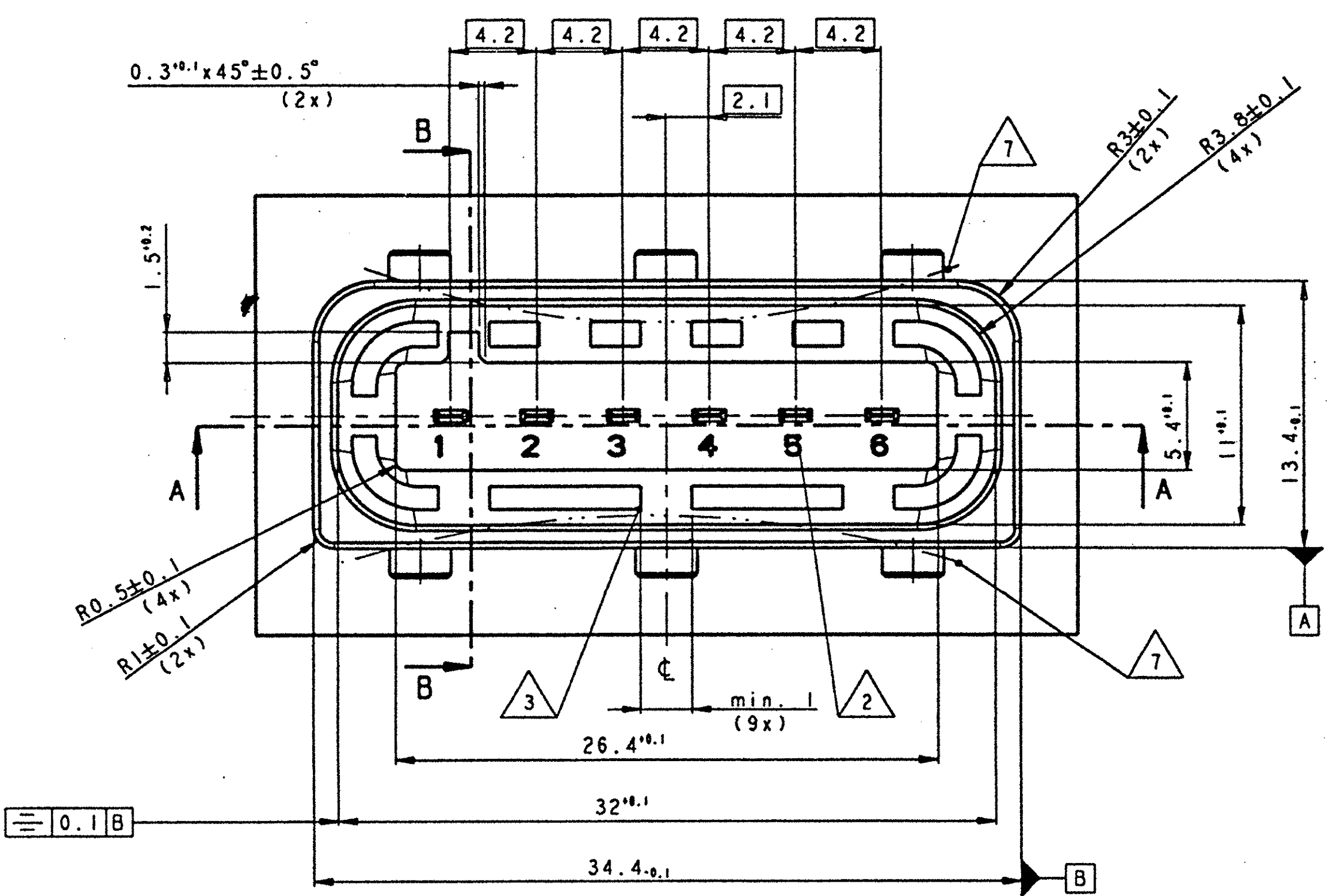

- NOTES**
Bemerkungen
- 1 NO BURRS PERMITTED
Kein Grat oder Spitzen zulässig
 - 2 TAB-ALLOTMENT, TEXT SUNK
Tab-Belegung, Schrift vertieft
 - 3 OPTIONAL SUIT OF CORES FOR MATERIAL TAKE-OFF
Mögliche Materialentnahmen
 - 4 PLASTIC GLAS FIBER FILLED (IN DIALOGUE WITH AMP)
Kunststoff glasfaserverstärkt (im Dialog mit AMP)
 - 5 POLISH MOULD SURFACE, ROUGHNESS RA=0.15µm MAX.
Polierte Werkzeugoberfläche, Rauheit Ra0.15µm max.
 - 6 TAB-MATERIAL: BY ARRANGEMENT WITH ADAM OPEL AG
TAB TIP TO AMP-SPEC. 114-18195-1, VARIANT A
Tab-Material: In Absprache mit Adam Opel AG
Tab-Spitze nach AMP-Spec. 114-18195-1, Variante A

- 1 KONCAVE: MAX. COLLAPSE ONLY INSIDE OF MENTIONED TOLERANCES PERMISSIBLE
Konker: Einfall nur innerhalb der angegebenen Toleranzen zulässig
- 6 MATED WITH AMP-COUNTERPART:
Passend zu AMP-Gegenstück:
- FOR CODING A, AMP P/N 1-929264-1, AND P/N 1-929271-1
Für Kodierung A, AMP Teile-Nr. 1-929264-1, und Teile-Nr. 1-929271-1
 - FOR CODING B, AMP P/N 2-929264-1, AND P/N 2-929271-1
Für Kodierung B, AMP Teile-Nr. 2-929264-1, und Teile-Nr. 2-929271-1
 - FOR CODING C, AMP P/N 3-929264-1, AND P/N 3-929271-1
Für Kodierung C, AMP Teile-Nr. 3-929264-1, und Teile-Nr. 3-929271-1
 - FOR CODING D, AMP P/N 4-929264-1, AND P/N 4-929271-1
Für Kodierung D, AMP Teile-Nr. 4-929264-1, und Teile-Nr. 4-929271-1
 - FOR CODING E, AMP P/N 5-929264-1, AND P/N 5-929271-1
Für Kodierung E, AMP Teile-Nr. 5-929264-1, und Teile-Nr. 5-929271-1
 - FOR CODING N, AMP P/N 6-929264-1, AND P/N 6-929271-1
Für Kodierung N, AMP Teile-Nr. 6-929264-1, und 6-929271-1

THIS DRAWING IS UNCLASSIFIED RELEASED FOR PUBLICATION BY AMP INCORPORATED, ALL RIGHTS RESERVED. COPYRIGHT 1996		DATE: 12FEB98 DRAWN BY: H. Schmitt CHECKED BY: H. Schmitt	AMP AMP Deutschland GmbH D - 83225 Leuggen
DIMENSIONS: UNIT: mm	TOLERANCES UNLESS OTHERWISE SPECIFIED: 1. PLC ±0.1 2. PLC ±0.1 3. PLC ±0.1 4. PLC ±0.1 5. HOLE ±0.1	PRODUCT SPEC: 108-18633-1 APPLICATION SPEC: 114-18272-1	INTERFACE FOR 6POS. MT2 CONNECTOR Schnittstelle f. 6pol. MT2 Stecker SIZE: A CASE CODE: 00779 DRAWING NO: C-114-18273-001 RESTRICTED TO: GM SCALE: 5:1 SHEET: 1 of 1 REV: A