

FOR GM "DOOR-LATCH"  
 APPLICATION ONLY

LOC	DISP	REV	DESCRIPTION	DATE	DWN	APPV
A1	-	A	NEW DRW. SEE PCN EGO0-2188-99-01	11NOV99	B. M.	H. B.
		B	SEE PCN EGO0-2260-00-01	30AUG2000	M. K.	T. K.
		B1	DRAWING REWORKED	26SEP2005	Y. A.	T. K.

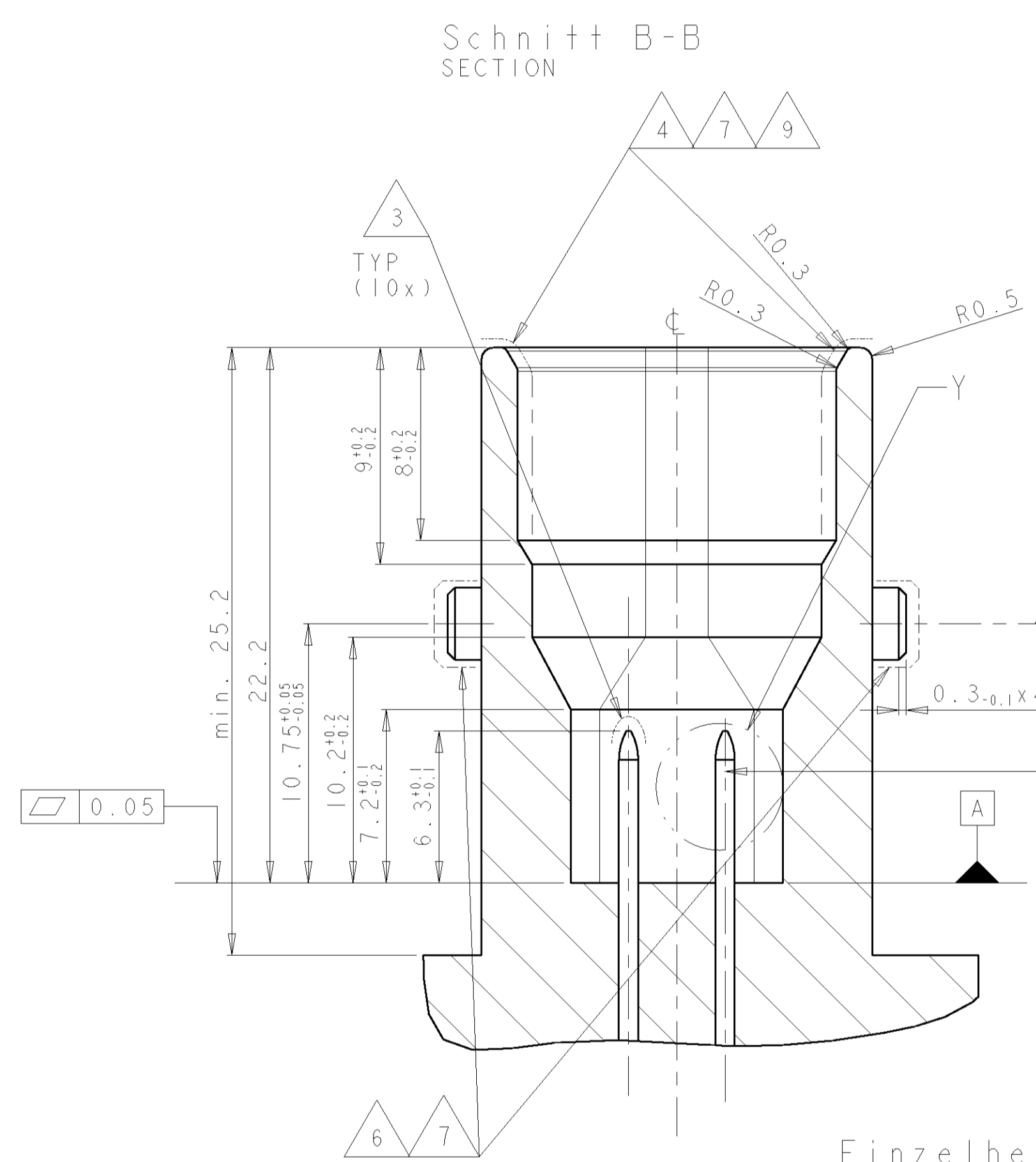

- Bemerkungen  
 Notes
- Unbemaßte Radien R 0.5  
 All RADII EXCEPT AS NOTED
  - Alle Symmetriemaße  $\equiv 0.05 \text{mm} \text{ } \perp$   
 All SYMMETRICAL DIM.
  - kein Grat zulässig  
 NO FLASH PERMITTED
  - Dichtfläche, in diesem Bereich keine Auswerfer oder Erhebungen zulässig  
 SEALING LEVEL, IN THIS AREA NO EJECTORS OR ELEVATIONS PERMITTED
  - Anschlußbauteil siehe Kundenzeichnung 1355688  
 KODIERVARIANTEN siehe Übersicht  
 MATING PART, SEE CUSTOMER DWG. 1355688  
 CODING VARIANTS SEE OVERVIEW
  - In diesem Bereich keine Auswerfer oder Erhebungen zulässig  
 IN THIS AREA NO EJECTORS OR ELEVATIONS PERMITTED
  - Polierte Werkzeugoberfläche  
 POLISHED MOULD SURFACE
  - Materialempfehlung: PBT-GF30%  
 RECOMMENDED MATERIAL: PBT-GF30%
  - keine Formtrennung zulässig  
 NO TOOL DIVIDING PERMITTED
  - Durchgehende Rippen erlaubt  
 CONTINUOUS RIBS ALSO PERMITTED

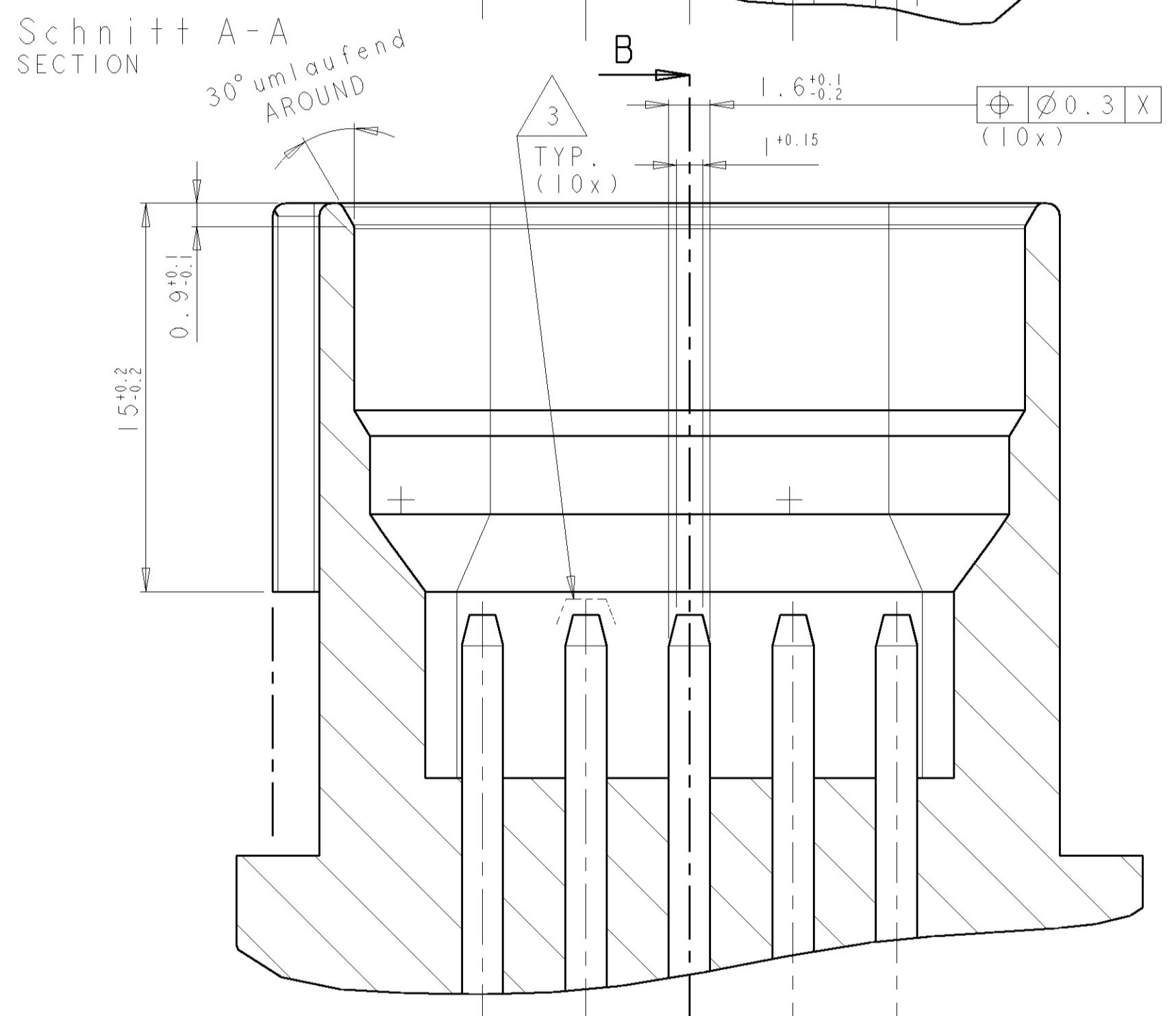
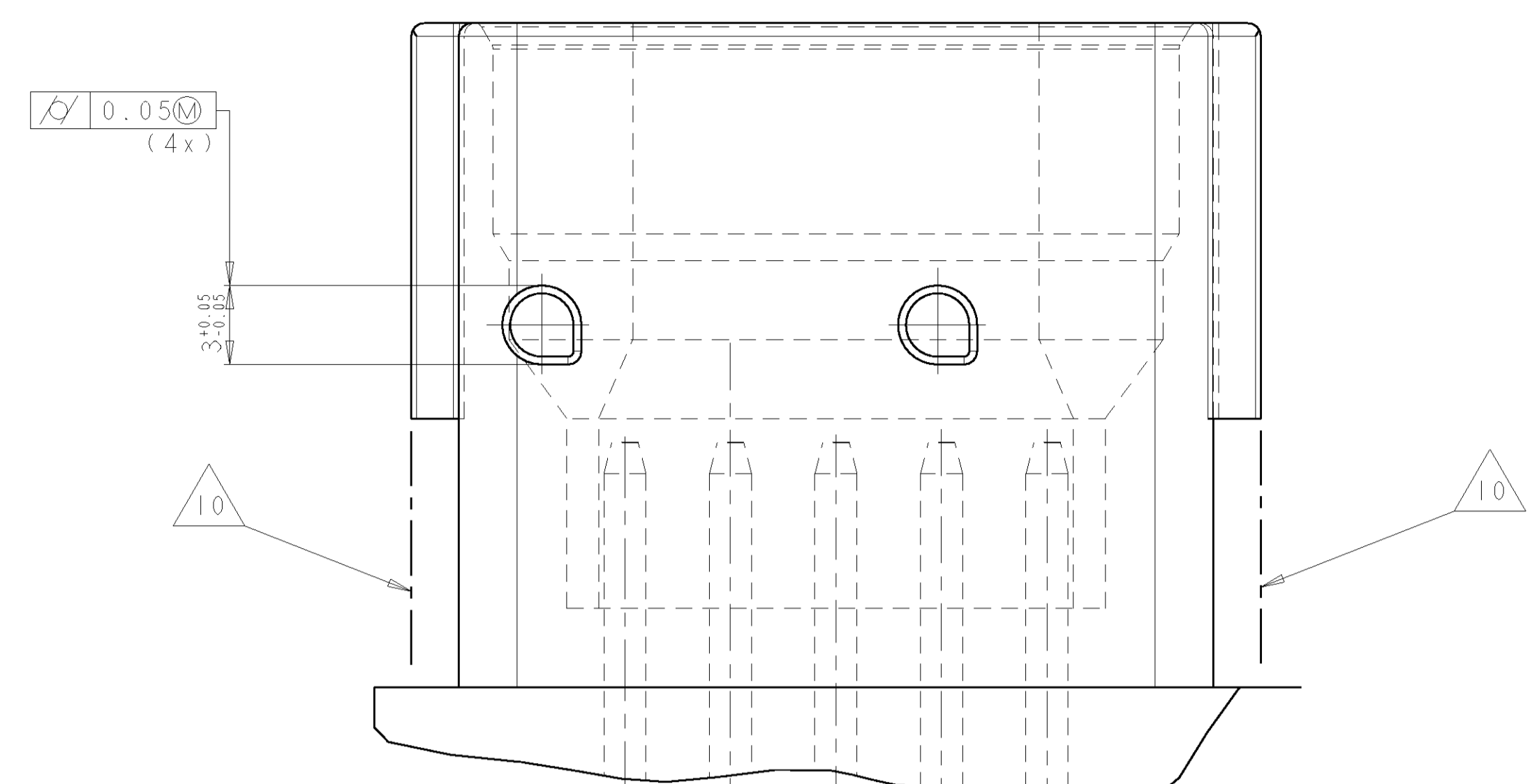
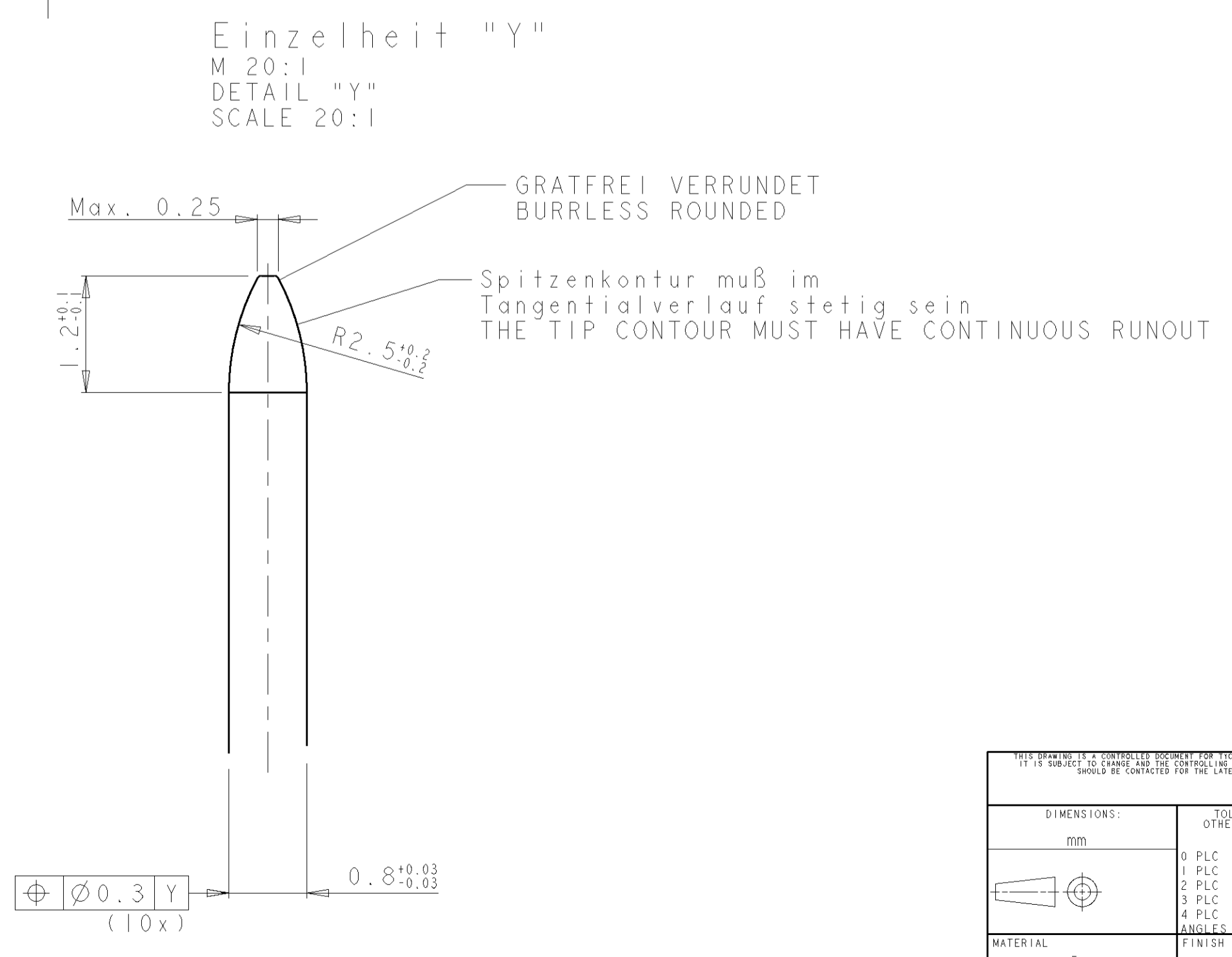
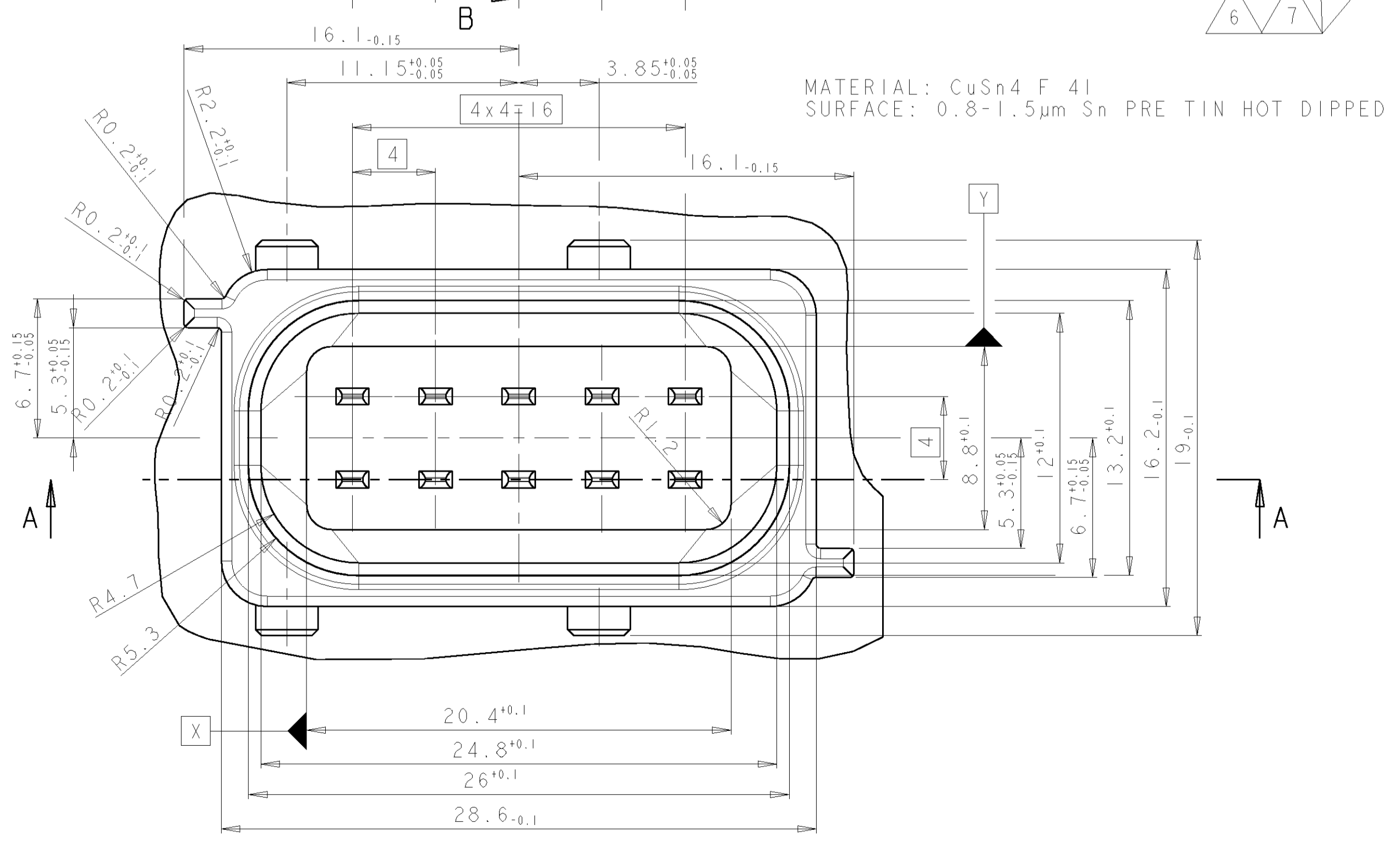
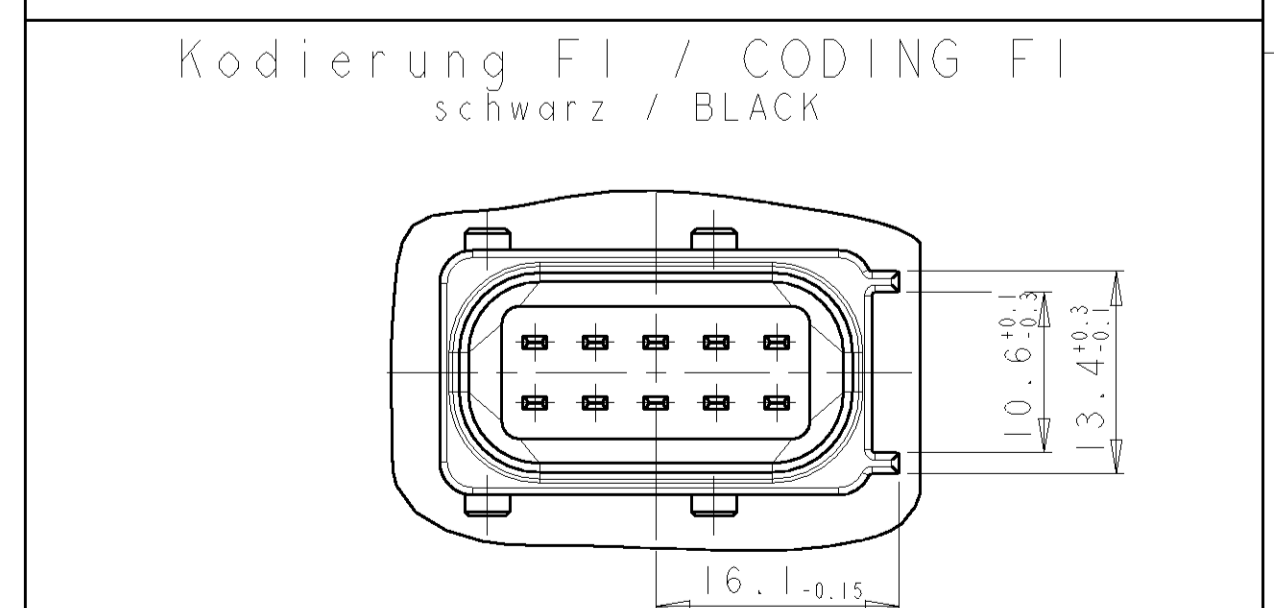
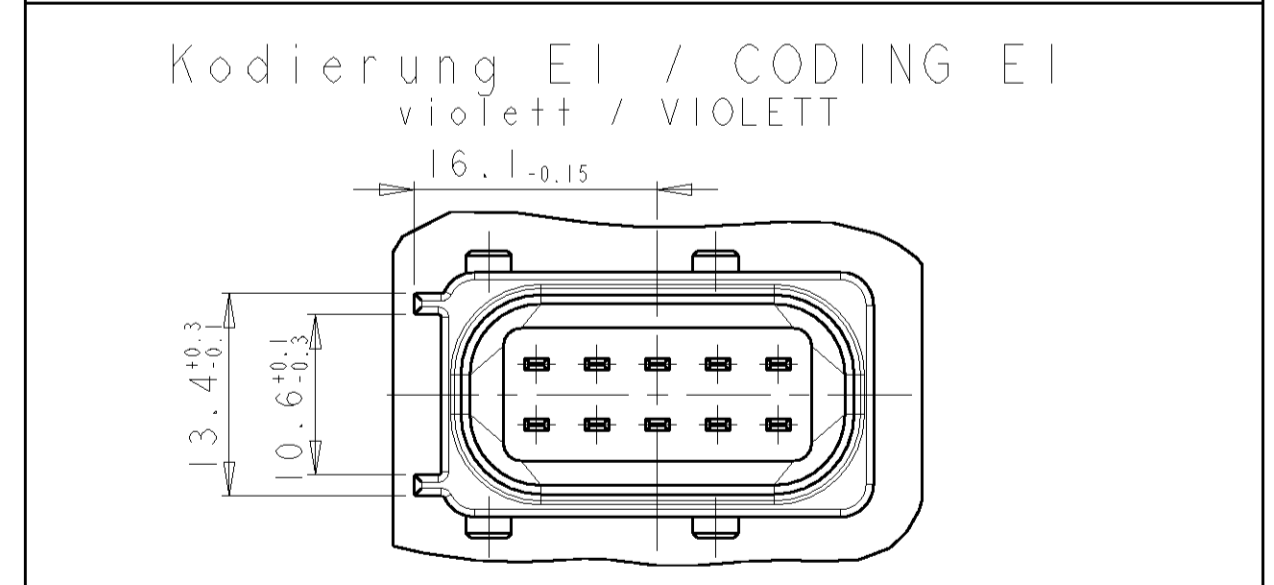
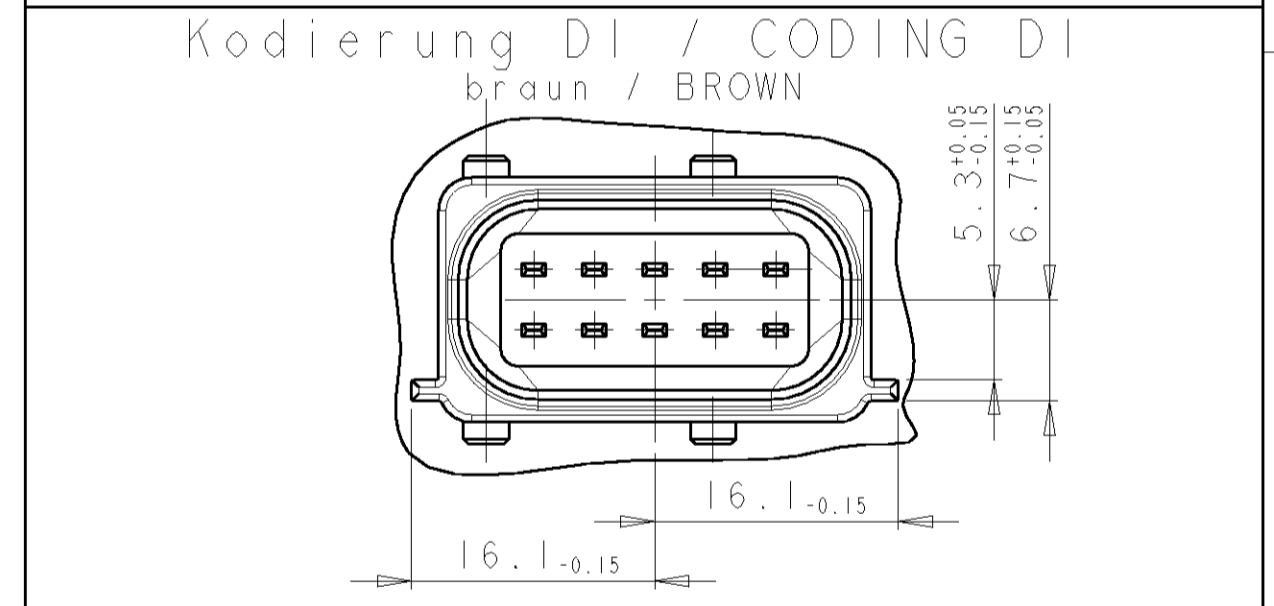
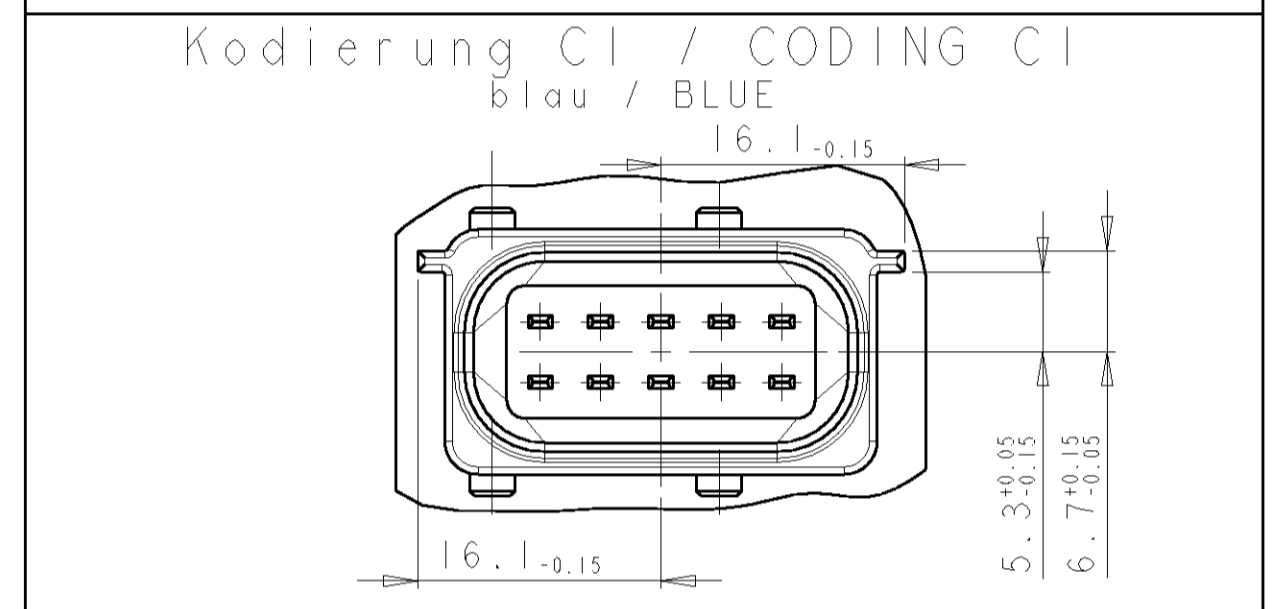
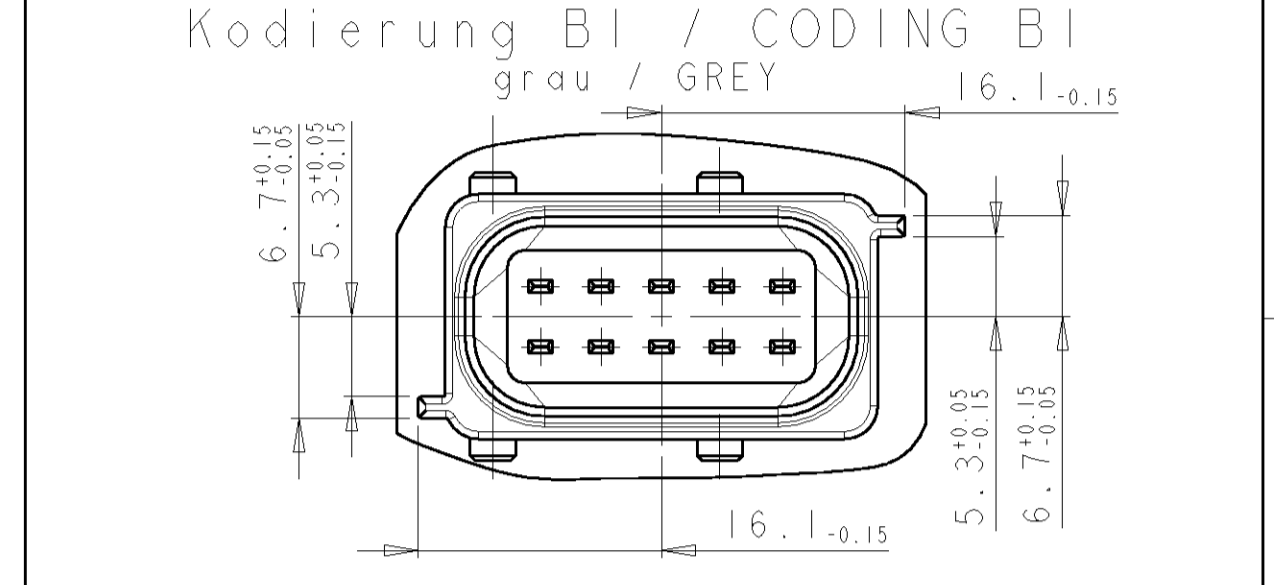
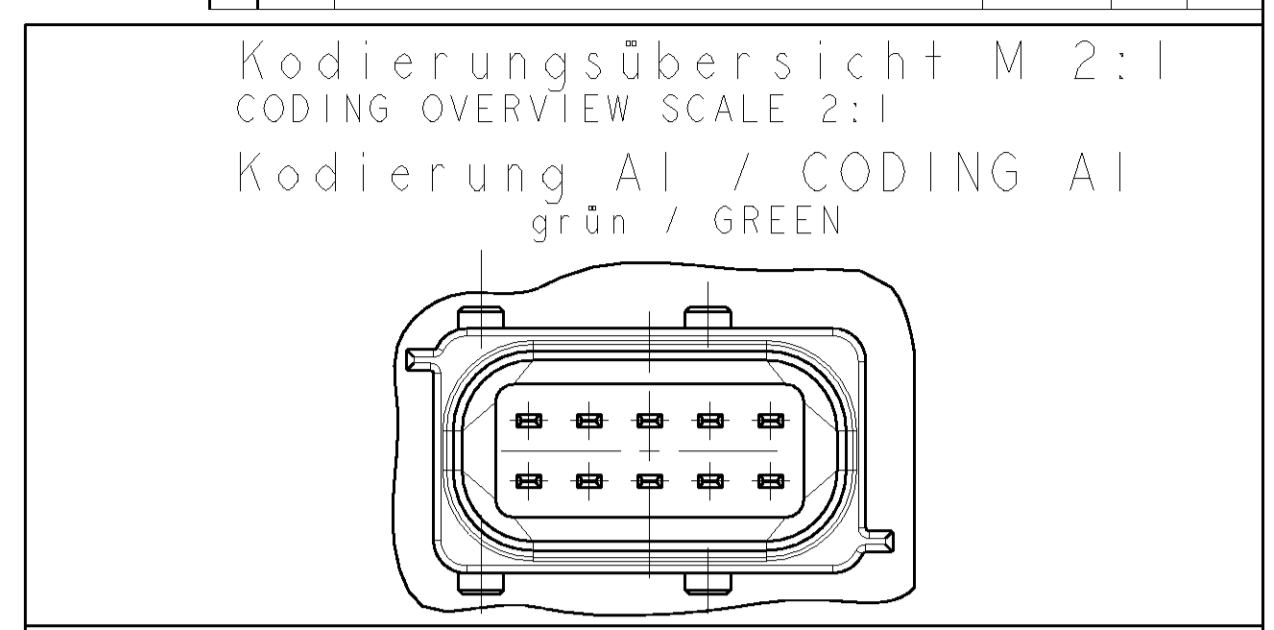

DIMENSIONS:		TOLERANCES UNLESS OTHERWISE SPECIFIED:		DWN: B. MADERER 06APR99		AMP Deutschland GmbH	
mm		9 PLC ±0.1		CHK: A. MACHILL 06APR99		D - 63225 Langen	
1 PLC ±0.1		2 PLC ±0.1		APPV: H. ROUDA 06APR99		NAME: MATING CONNECTION 10 POSITION	
2 PLC ±0.1		3 PLC ±0.1		PRODUCT SPEC:		FOR MT3 REC. HOUSING	
3 PLC ±0.1		4 PLC ±0.1		APPLICATION SPEC:		SIZE: CAGE CODE DRAWING NO. RESTRICTED TO	
4 PLC ±0.1		ANGLES ±1°		WEIGHT:		A1 00779 C=114-18340 GM	
MATERIAL:		FINISH:		CUSTOMER DRAWING:		SCALE: 5:1 SHEET 1 OF 1 REV: B1	