



.060 Tab / Recep. Contacts

1. SCOPE

This specification covers the special guidelines for the application of the .060 Tab/Recep contacts. The instructions are intended primarily for automatic or semi-automatic application of all versions. The various .060 Tab/Recep contacts are listed and sorted by their wire ranges and crimping.

이 시방서는 .060 Tab/Recep 단자의 압착을 위한 지침서이다.

설명서는 자동 혹은 반자동 압착을 위해 우선적으로 참조된다.

다양한 .060 Tab/Recep. 단자는 전선 종류와 압착에 의해 구분된다.

2. REFERENCED DOCUMENTS

2.1 Customer Drawings

There are 2 drawings 2109005 and 2109006 with the measures and materials of the contacts. In the case of a conflict between this document and the customer drawing, the customer drawing takes precedence.

도면 2109005 와 2109006 은 단자의 치수와 원재료가 포함되어 있다.

이 문서와 고객 도면 사이에 상이한 것이 있으면, 고객 도면을 우선시 한다.

2.2 Product Specification

The Product Specification 108- 61116 describes the characteristics of these contacts, together with the electrical and mechanical requirements.

제품 시방서 108-61116 은 전기적, 기계적 요구 조건과 함께 이 단자의 특성을 나타낸다.

2.3 Application Specification

The general guidelines laid down in Application Specifications 114-18022.

일반적인 지침서는 압착 시방서 114-18022 을 참조하십시오.

2.4 Instruction Sheet for Rework: 411-61008

작업 지시서: 411-61008

3. DESCRIPTION OF NOMENCLATURE

The terms shown below are used in the specification.

아래의 용어가 시방서에 사용된다.

3.1 Contacts

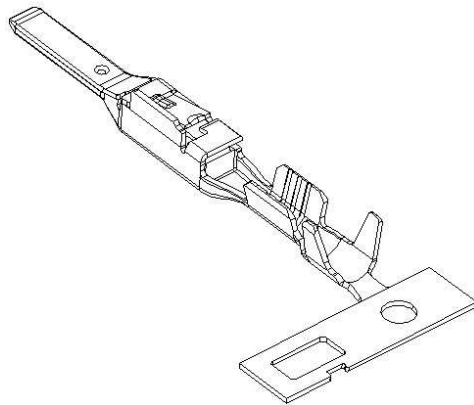

Tab

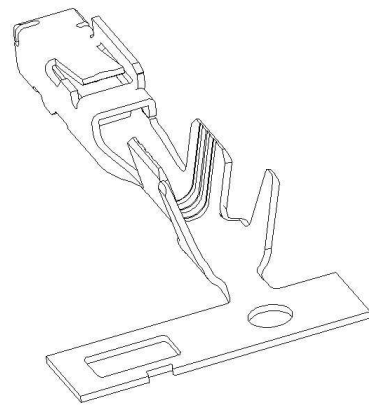

Recep.

Fig. 1

3.2 Contacts with insulation crimp

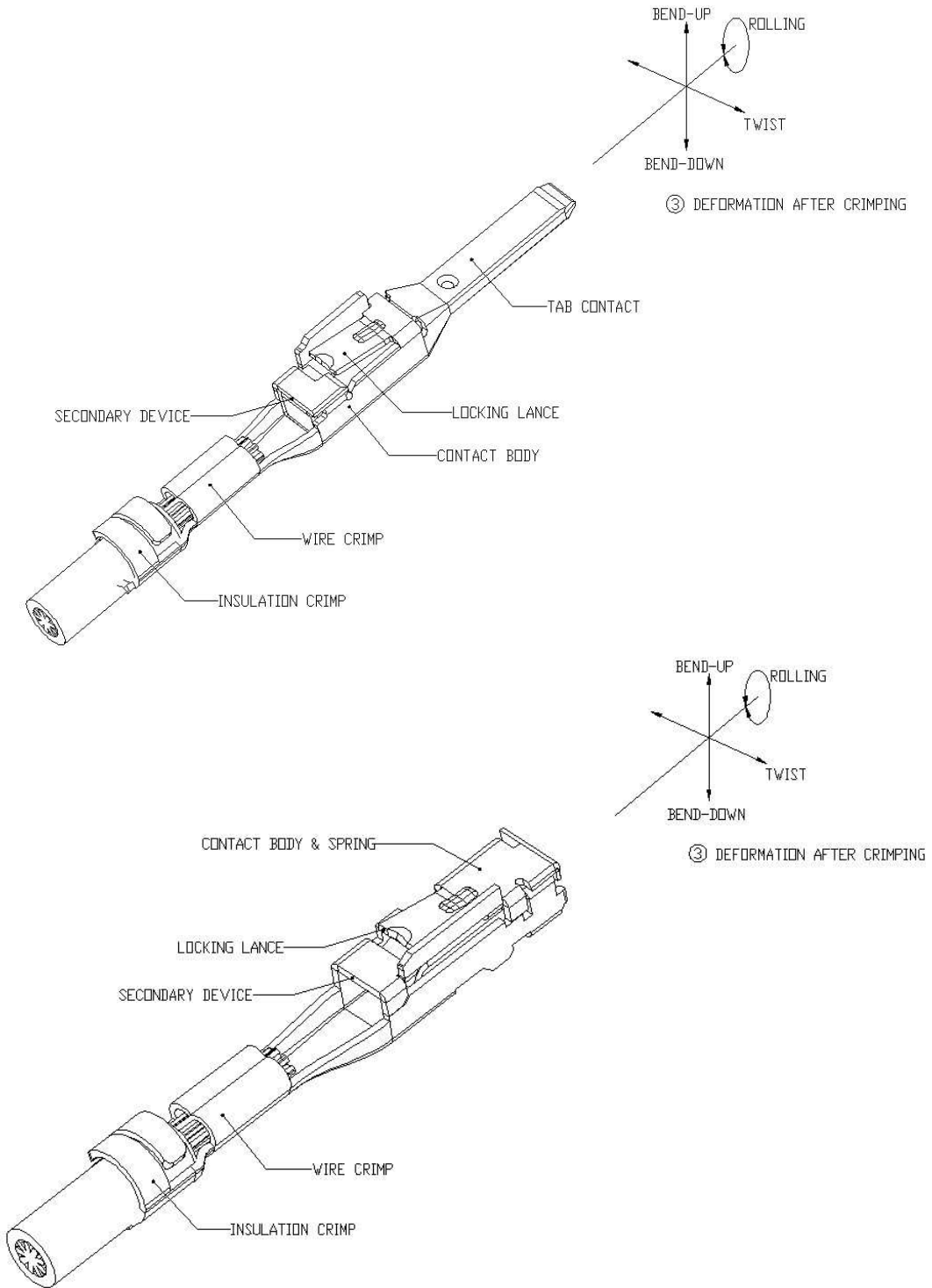

Fig. 2

3.3 Crimp design

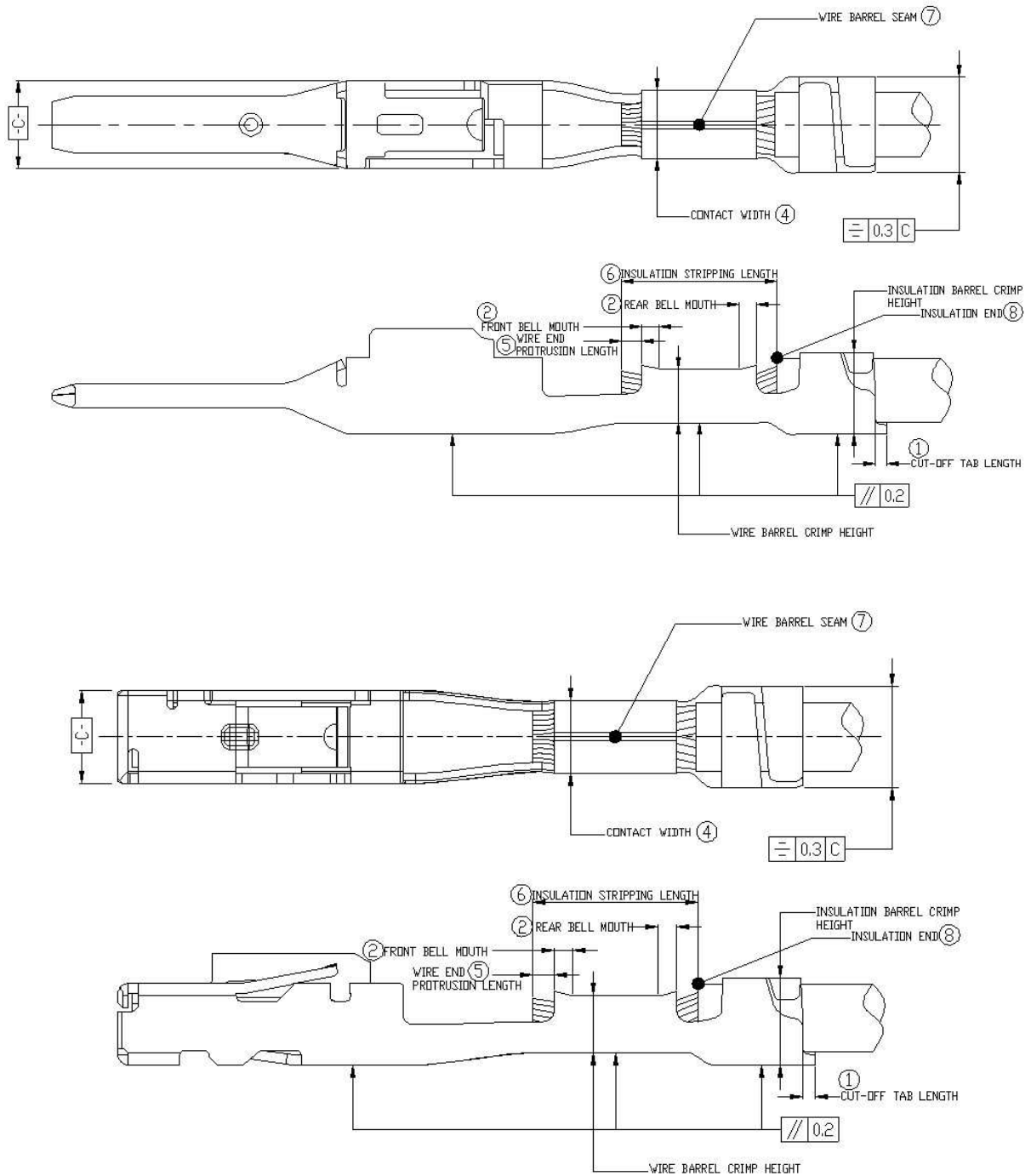

Fig. 3

4. REQUIREMENTS

No.	Checking Items	Requirements	Remarks
1	Deformation after Crimping	Bend	-2°, +3° Max.
		Twist	±3° Max.
		Rolling	±10° Max.
2	Cut-off Tab Length	0.3 mm Max.	Fig. 3 ①
3	Bell-mouth	Front	0.3 mm Max.
		Rear	0.3 ± 0.2 mm
4	Contact Width after Crimping	CB ₁ +0.2 mm Max.	Fig. 3 ④
5	Wire-end Protrusion Length	0.3 ~ 0.8 mm	Fig. 3 ⑤
6	Insulation Stripping Length	4.0 ± 0.3 mm	Fig. 3 ⑥
7	Wire Barrel Seam	Seam must be closed (No strand looses out of the seam)	Fig. 3 ⑦
8	Insulation End	Insulation End must be between Wire Barrel and Insulation Barrel	Fig. 3 ⑧

Caution Height of front bell-mouth after crimping allows Max 2.0mm from bottom of contact body.

That is, the height must be same or less than the top of contact body.

압착 후 Front bell-mouth 의 높이는 단자의 바닥 면에서 최대 2.0mm 까지 허용한다.

즉, 높이는 단자의 상단과 동일하거나 낮아야만 한다.

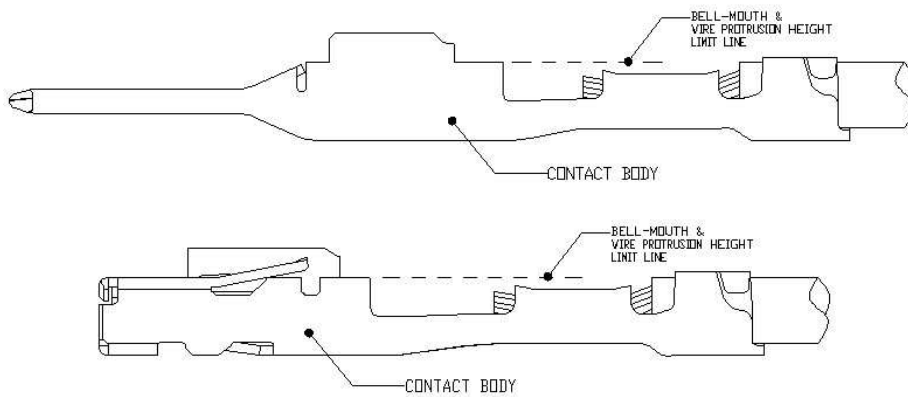

5. CRIMP DATA

Application Crimp:

Contact P/N	Wire Range (mm ²)	Insulation Range Ø (mm)	Strip Length (mm)	Wire Barrel Crimp		Insulation Barrel Crimp		
				Width(CB ₁) (mm)	Height (CH ₁) (mm)	Width(CB ₂) (mm)	Height(CH ₂) (mm)	Crimp Surrounding Circle(CD ₂) (mm)
0-2109005-1 0-/1-2109006-1	0.22	1.0-1.05	4.0 ± 0.3	1.27 "F"	0.865 ± 0.025	1.78 REF "O" Wrap	1.85 Max. From 1)	-
	0.3/0.35	1.2-1.5			0.965 ± 0.025			
0-2109005-2 0-/1-2109006-2	0.5	1.4-1.7		1.57 "F"	1.03 ± 0.03	1.83 REF "O" Wrap	2.05 REF	2.1 Max. Form 2)
	0.75	1.7-1.9			1.16 ± 0.03			
0-2109005-3 0-2109006-3	0.85	1.8-1.9		1.78 "F"	1.20 ± 0.03	2.29 REF "O" Wrap	2.45 REF	2.5 Max. Form 2)
	1.0	1.9-2.1			1.31 ± 0.03			
	1.25	2.1-2.4			1.38 ± 0.03			
	0.3X0.3**	2X1.2~1.4			1.16 ± 0.03			2.5 Max
8-2109005-2 8-2109006-2	0.75 (Aluminum)	1.3-1.5		1.57 "F"	1.2 ± 0.05	1.83 REF "O" Wrap	2.05 REF	2.1 Max. Form 2)
8-2109005-3 8-2109006-3	1.25 (Aluminum)	1.7-1.9		1.78 "F"	1.35 ± 0.05	2.29 REF "O" Wrap	2.45 REF	2.5 Max. Form 2)

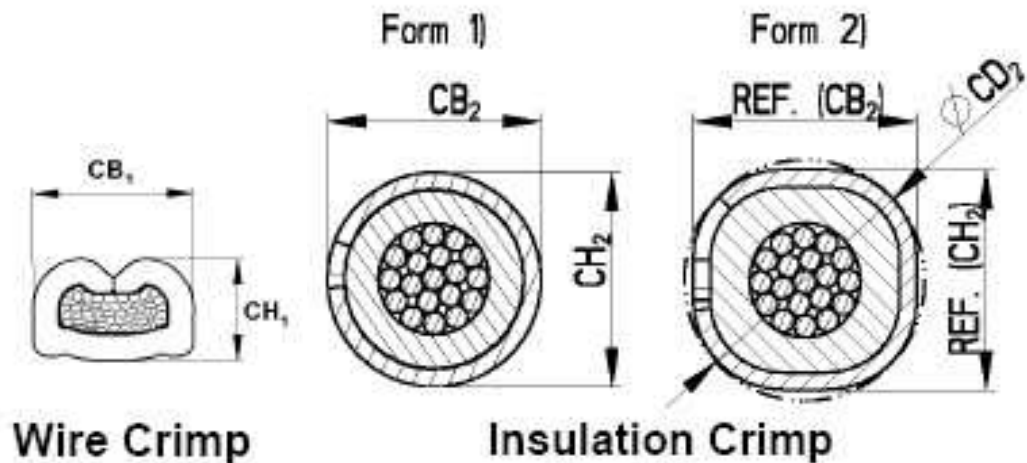



Note: (1) Crimp Width dimension are not the product width after crimping, but given by the width of crimper slot for reference
 (2) Control the width of wire barrel within CB₁ +0.2mm after crimp.
 ** Caution Crimp data for contacts with double crimp. This is restricted suitable.

(1) Crimp 폭 치수는 압착 후 제품의 폭은 아니지만, 참조용으로 Crimper 의 폭으로 주어진다.
 (2) Wire Barrel 의 폭은 압착 후 CB1 +0.2mm 이내에서 관리하십시오.
 ** 주의 2 wire 압착 단자를 위한 Crimp 자료. 이것은 제한적으로 안정적이다.

6. APPLICABLE WIRE RANGE

Wire range based on CHFUS (ISO 6722), AVSS (JASO D 611), FLRY-B (ISO 6722, DIN 72551)

Nominal Wire Size	Number of Strands / Diameter of Strand (mm)	Calculated Cross Section Area (mm ²)	Overall outside Diameter	
			Normal	Maximum
0.22	7 / Compressed	0.2425	1.0	1.05
0.3	7 / 0.26	0.3717	1.4	1.5
0.35	12 / 0.21	0.4156	1.2	1.4
0.5	7 / 0.32	0.5630	1.6	1.7
0.75	24 / 0.21	0.8313	1.7	1.9
0.85	19 / 0.24	0.8595	1.8	1.9
1.0	32 / 0.21	1.1084	1.9	2.1
1.25	19 / 0.29	1.2550	2.1	2.2

For Aluminum wire

Nominal Wire Size	Number of Strands / Diameter of Strand (mm)	Calculated Cross Section Area (mm ²)	Overall outside Diameter	
			Minimum	Maximum
0.75	11 / Compressed	0.778	1.3	1.5
1.25	16 / Compressed	1.368	1.7	1.9