

**Corner Guide Pin and Socket Kits for
 104-Position M Series Connectors With Center Fastener**

CORNER GUIDE KIT	
PIN	SOCKET
202173-[]	202174-[]
	204099-[]
201540-[]	—

Figure 1

1. INTRODUCTION

The corner guide pin and socket kits listed in Figure 1 are used to align connectors (plug and receptacle) during mating. The kits can also be used for keying connectors to provide proper mating.

Reasons for reissue of this instruction sheet are provided in Section 4, REVISION SUMMARY.

2. DESCRIPTION

Each kit consists of a guide pin or socket, lock washer, and 6–32 hex nut. Some kits include a spacer. The hardware is designed to be used in the mounting holes of housings having a minimum of 2 holes.

Nut Driver 811262–2 can be used to secure the hardware to the connector.

3. INSTALLATION (Refer to Figure 2)

1. Insert the threaded end of the guide pin or socket into the front of the appropriate mounting hole of the connector and, if present, through the panel.

NOTE *Install the guide pin onto one mating connector, and the guide socket onto the other mating connector; except for Kit 201540–[], install two guide pins (one in each diagonal mounting hole) into one connector.*

**Corner Guide Pin and Socket Kits for
 104-Position M Series Connectors With Center Fastener**

CORNER GUIDE KIT	
PIN	SOCKET
202173-[]	202174-[]
	204099-[]
201540-[]	—

Figure 1

1. INTRODUCTION

The corner guide pin and socket kits listed in Figure 1 are used to align connectors (plug and receptacle) during mating. The kits can also be used for keying connectors to provide proper mating.

Reasons for reissue of this instruction sheet are provided in Section 4, REVISION SUMMARY.

2. DESCRIPTION

Each kit consists of a guide pin or socket, lock washer, and 6–32 hex nut. Some kits include a spacer. The hardware is designed to be used in the mounting holes of housings having a minimum of 2 holes.

Nut Driver 811262–2 can be used to secure the hardware to the connector.

3. INSTALLATION (Refer to Figure 2)

1. Insert the threaded end of the guide pin or socket into the front of the appropriate mounting hole of the connector and, if present, through the panel.

NOTE *Install the guide pin onto one mating connector, and the guide socket onto the other mating connector; except for Kit 201540–[], install two guide pins (one in each diagonal mounting hole) into one connector.*

2. If the connector is not panel-mounted or if the connector is mounted to a panel having a thickness less than 3.17 millimeters [.125 inch], slide the spacer over the threads (if using Kit 201540-[], a spacer is not required).

3. Thread the lock washer and hex nut onto the threads. Tighten the hex nut.

4. REVISION SUMMARY

Revisions to this instruction sheet include:

- Updated document to corporate requirements
- Removed obsolete part numbers
- Added tool to Section 2

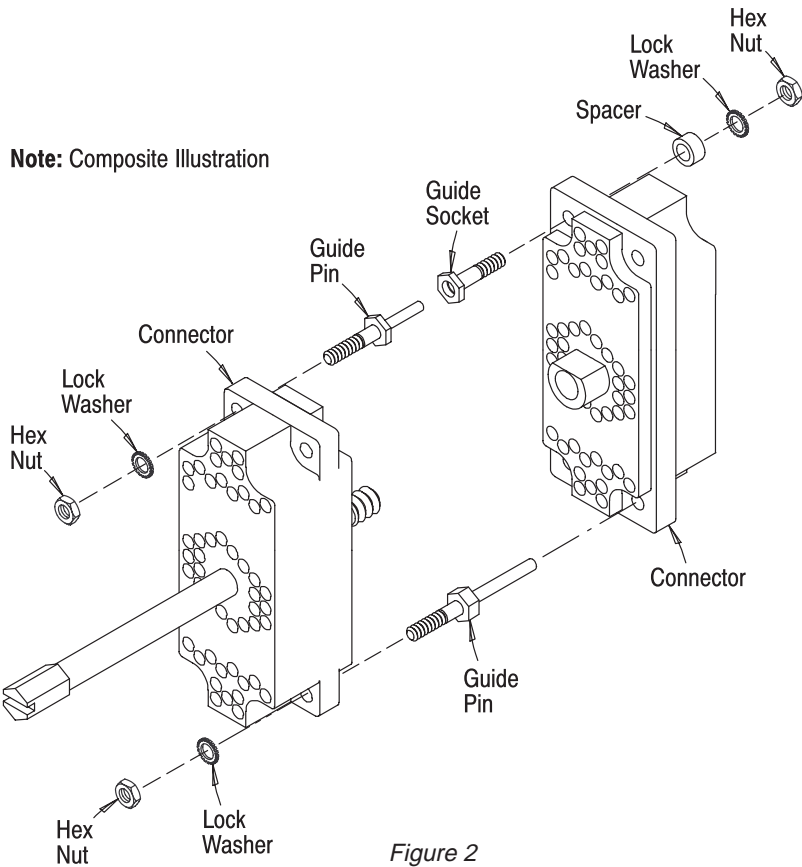

2. If the connector is not panel-mounted or if the connector is mounted to a panel having a thickness less than 3.17 millimeters [.125 inch], slide the spacer over the threads (if using Kit 201540-[], a spacer is not required).

3. Thread the lock washer and hex nut onto the threads. Tighten the hex nut.

4. REVISION SUMMARY

Revisions to this instruction sheet include:

- Updated document to corporate requirements
- Removed obsolete part numbers
- Added tool to Section 2

