

CONNECTOR TYPE	CABLE TYPE	TOOLS REQUIRED:
OSSP PANEL FEED-THROUGH PLUG RECEPTACLE-THREADED INSTAL.	N/A	TORQUE WRENCH: 2598-5160-54

O-RING

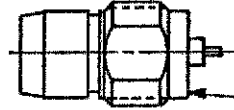

CONNECTOR



CONNECTOR

ASSEMBLY OPERATIONS

1.0 MOUNTING HOLE PREPARATION

- 1.1 DRILL $.051 + .001$ DIAMETER PILOT HOLE THROUGH PANEL.
- 1.2 INSERT STEP REAMER INTO PILOT HOLE AND REAM TO DEPTH SHOWN.
- 1.3 TAP $.190-36$ THREAD TO DEPTH SHOWN.
- 1.4 PLATE PER CUSTOMER APPLICATION RECOMMENDED MAXIMUM TOTAL PLATING IS $.00019$.
- 1.5 CLEAN IN SOLVENT.

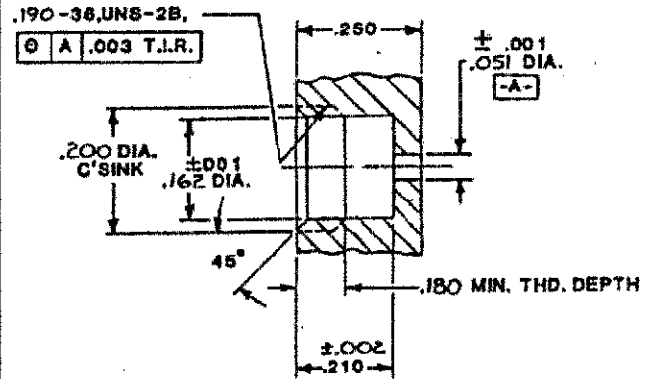

2.0 INSTALLATION OF CONNECTOR INTO PANEL

- 2.1 THREAD CONNECTOR INTO MOUNTING HOLE.
- 2.2 USING A TORQUE WRENCH WITH A $.156$ HEX, TORQUE CONNECTOR TO 7-10 IN/LBS.
- 2.3 THIS COMPLETES INSTALLATION OF THE CONNECTOR

