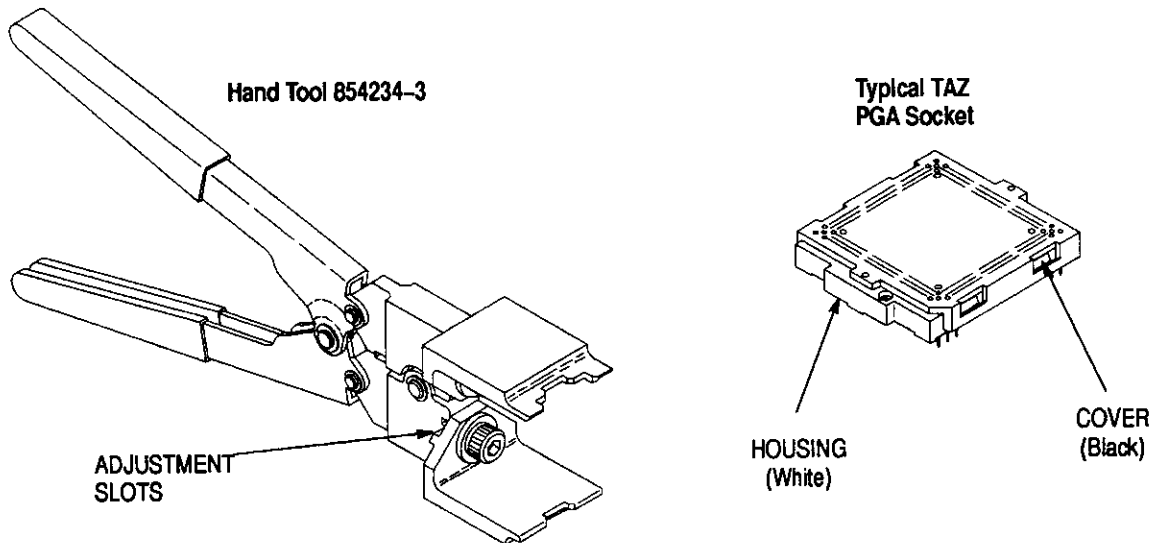

**PROPER USE GUIDELINES**

Cumulative Trauma Disorders can result from the prolonged use of manually powered hand tools. AMP hand tools are intended for occasional use and low volume applications. AMP offers a wide selection of powered application equipment for extended-use, production operations.

**Figure 1**

cad 9718, cad 114-1068

**1. INTRODUCTION**

AMP Hand Tool 854234-3 is used to open and close Tool Actuated ZIF (TAZ) Pin Grid Array (PGA) Sockets for installing and removing PGA devices. The hand tool is designed to be used on sockets having grid sizes of 25x25 contacts, on 2.54 mm [.100 in.] centerlines. Refer to AMP Application Specification 114-1068 and AMP Catalog 82172 for detailed product information.

**NOTE**

*Dimensions on this sheet are in millimeters  
[with inch equivalents in brackets].*

**2. DESCRIPTION**

Each TAZ PGA Socket has a black cover and a white housing. The tool has two squeeze arms, one longer than the other. The long arm engages the housing, while the short arm engages the cover.

The squeeze arms are attached to pivot blocks by socket head cap screws. The screws can be loosened to adjust the arms to the appropriate slots in the blocks for the size product engaged.

**3. USING THE HAND TOOL****A. Loading a PGA Device**

1. Position device in socket as shown in Figure 2. An empty socket is designed to always be in the open position.
2. One edge of white socket housing will be visible from above—engage this side of housing with long squeeze arm; long arm will straddle housing boss. Engage cover with short arm; short arm will rest on housing boss.
3. Squeeze tool handles together until socket cover clicks to a closed position. Refer to Figure 3. Cover will visibly move to other side of housing, revealing a white housing edge on side of socket opposite from when it was open.

**B. Unloading a PGA Device**

1. Socket loaded with device will be in closed position; one edge of white socket housing will be visible from above. Engage this side of socket with long squeeze arm of tool. Engage cover with short arm.

2. Squeeze tool handles together until socket cover clicks to open position. Refer to Figure 3. Cover will visibly move to other side of housing, revealing a white housing edge on side of housing opposite from when it was closed.

3. Lift PGA device straight up and out of socket as shown in Figure 4.

#### 4. MAINTAINING THE TOOL

Inspect the tool when you receive it and at regular intervals to ensure continued good service.

##### A. Daily Maintenance

Tool operator should check the tool at the end of each shift to make sure retaining rings and pins are secure. Clean the tool with a clean, soft, lint-free cloth and lightly coat bearing surfaces using SAE No. 20 motor oil.

##### NOTE

*DO NOT oil tool excessively.*

Store the tool in a clean, dry area.

##### B. Repair

All parts of this tool are customer replaceable. Retaining pins and rings, screws and washers should be stocked to allow immediate replacement if damaged or lost. Stocking of other parts is at your discretion. Refer to Figure 5 for correct part numbers. Order replacement parts through your AMP representative, or call 1-800-526-5142, or send a facsimile of your purchase order to 1-717-986-7605, or write to:

CUSTOMER SERVICE (38-35)  
AMP INCORPORATED  
P.O. BOX 3608  
HARRISBURG, PA 17105-3608

When necessary, the entire tool may be returned for evaluation and repair, with a written description of the problem, to:

CUSTOMER REPAIR (01-12)  
AMP INCORPORATED  
1523 NORTH 4TH STREET  
HARRISBURG, PA 17102-1604

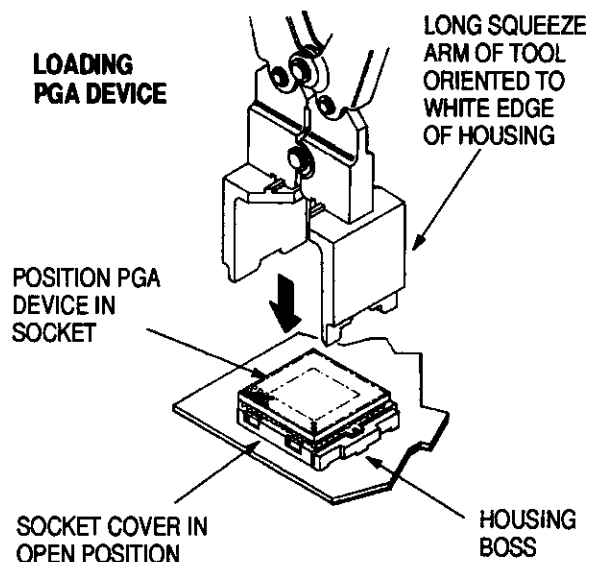

Figure 2

91-315

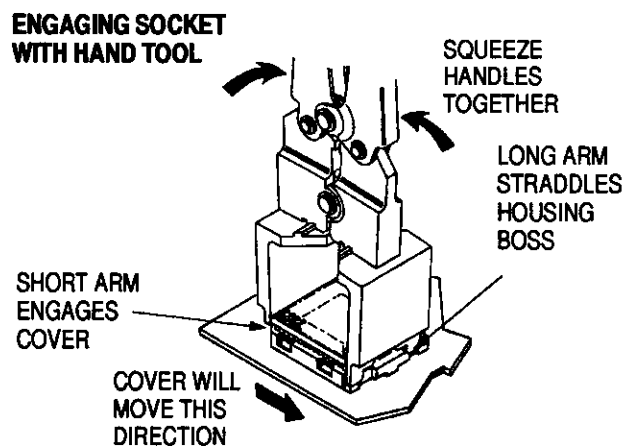

Figure 3

91-316

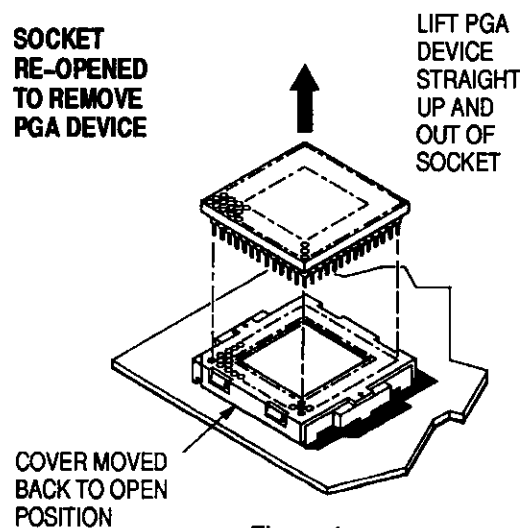

Figure 4

91-317

## CUSTOMER-REPLACEABLE PARTS

ITEM NO.	DESCRIPTION	PART NUMBER	QTY
1	4.78 [.188] Dia Retaining Ring	21045-3	4
2	4.78 [.188] Dia Retaining Pin	300432	2
3	6.35 [.25] Dia Retaining Pin	7-59558-5	1
4	6.35 [.25] Dia Retaining Ring	21045-6	2
5	Right Pivot Block	314812-1	1
6	Right (Long) Squeeze Arm	354431-1	1
7	6.35 [.25] Flat Washer	21055-8	2
8	6.35 [.25]-20 x 2.22 [.875] Socket Head Cap Screw	21001-5	2
9	Left (Short) Squeeze Arm	354432-1	1
10	Left Pivot Block	314810-1	1
11	Handle Assembly	986301-1	1

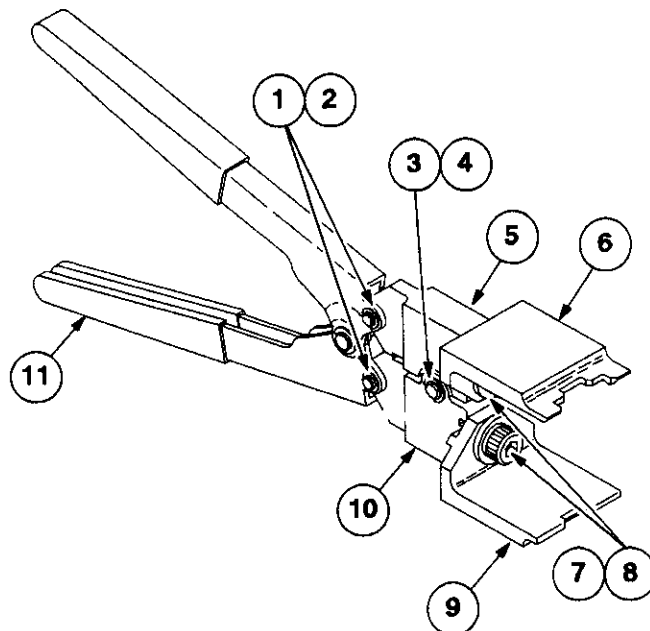

Figure 5

cad 9718