

1.6mm CONTACT SYSTEM MALE AND FEMALE CONNECTORS

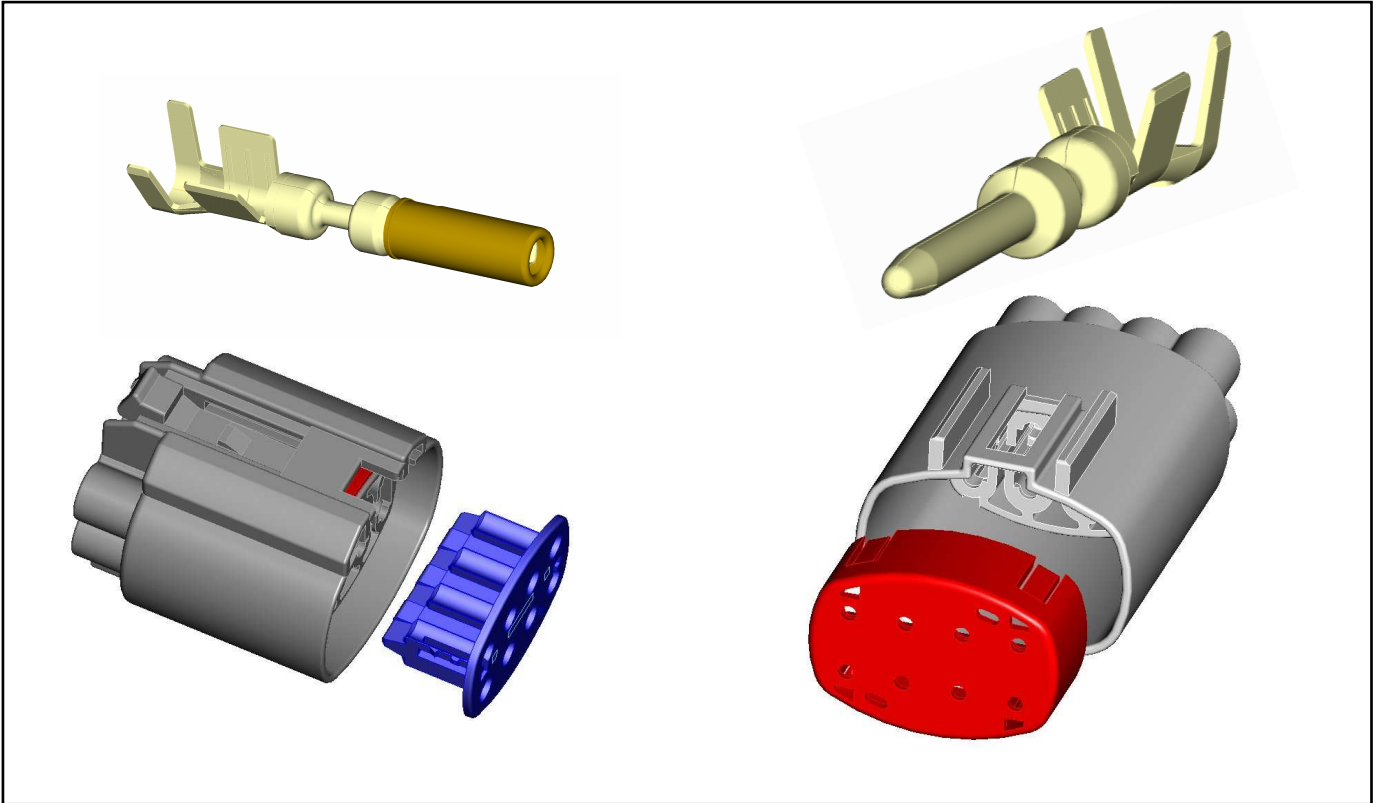

A - OBJECT

1,6mm contact system family, 2 to 8 positions connectors in all configurations and versions (P/Ns listed in next page).

B - SCOPE

To provide useful information for the correct assembly of the harness, using the connectors in object.

A	REDRAWN	M.GHISOLFI/R.MARTINI	20/11/2007
0	PRELIMINARY ISSUE	J.SLUSSER	26/07/2004
REV.	DESCRIPTION	DR/CHK	DATE

C - LIST OF INVOLVED P/Ns:

C1 - Connectors:

2 way connector male	3 way connector male	4 way connector male	6 way connector male	8 way connector male
P/N	P/N	P/N	P/N	P/N
0-1437710-1	7-1437710-6	8-1437710-4	4-1437710-0	4-1437709-5
5-1437710-5	7-1437710-7	8-1437710-5	4-1437710-1	4-1437710-5
5-1437710-6	7-1437710-8	8-1437710-6	4-1437710-2	4-1437710-6
5-1437710-7	7-1437710-9	8-1437710-7	4-1437710-3	4-1437710-7
5-1437710-8	8-1437710-0	8-1437710-8	4-1437710-4	4-1437710-8
5-1437710-9	8-1437710-1	8-1437710-9		4-1437710-9
6-1437710-0	8-1437710-2	9-1437710-0		5-1437710-0
6-1437710-1	8-1437710-3	9-1437710-1		5-1437710-1
6-1437710-2		9-1437710-2		5-1437710-2
6-1437710-3		9-1437710-3		
6-1437710-4				
6-1437710-5				
6-1437710-6				
6-1437710-7				
6-1437710-8				
6-1437710-9				
7-1437710-0				
7-1437710-1				
7-1437710-2				
7-1437710-3				
7-1437710-4				
7-1437710-5				
2 way connector female	3 way connector female	4 way connector female	6 way connector female	8 way connector female
P/N	P/N	P/N	P/N	P/N
2-1437712-5	3-1437712-1	3-1437712-3	2-1437712-0	1-1437712-3
2-1437712-6	3-1437712-2	3-1437712-4	2-1437712-1	2-1437712-2
2-1437712-7		3-1437712-5		2-1437712-3
2-1437712-8				
2-1437712-9				
3-1437712-0				
2-1437713-6				

C2 - Contacts:

Description	Tyco Part Number	Wire range	To be used in
Tin plated female contact	1-1437709-4	0.35mm ²	Male connectors
	1-1437709-5	0.5-1.0mm ²	
	1-1437709-6	1.5-2.5mm ²	
Gold plated female contact	0-1437709-9	0.35mm ²	Male connectors
	1-1437709-0	0.5-1.0mm ²	
	1-1437709-7	1.5-2.5mm ²	
Tin plated male contact	1-1437709-1	0.35mm ²	Female connectors
	1-1437709-2	0.5-1.0mm ²	
	1-1437709-3	1.5-2.5mm ²	
Gold plated male contact	0-1437709-6	0.35mm ²	Female connectors
	0-1437709-7	0.5-1.0mm ²	

C3 - Single wire seals / Cavity plugs:

Description	Tyco Part Number	Insulation Dia. range
Single wire seal	1-1437713-1	1.2-1.4mm
Single wire seal	1-1437713-2	1.5-2.1mm
Single wire seal	1-1437713-3	2.2-2.4mm
Cavity plug	1-1437713-4	---

D - CONTACTS LOADING

Before inserting the contacts into housing, be sure that they meet all requirements of the applicable Tyco Electronics Crimp Specification (114-20121).

D1 - Insert the contacts one at a time into the rear of the connector housing.

Note: 2 adjacent contacts cannot be inserted at the same time, but they must be inserted one at a time:



D2 - After insertion of a contact, pull back the wire lightly in order to check if the contact is securely locked in position. Do not twist the wire or contact when lightly pulling!

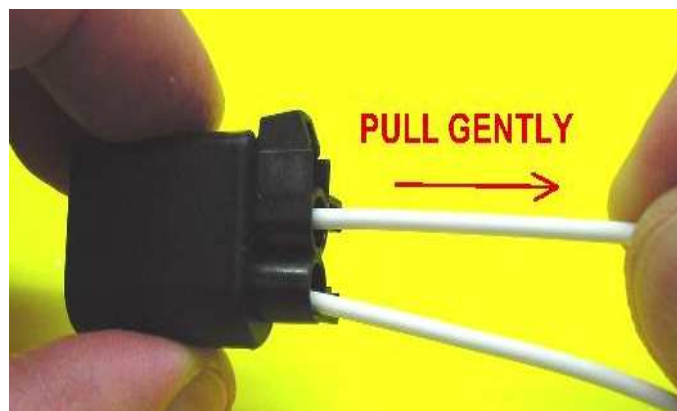

E – POSITIONING OF LOCKING SPACER

The 1.6mm connectors are supplied with a locking spacer pre-assembled on both pin and socket housings. After having loaded all the crimped contacts, the spacers must be pushed into its final lock position:

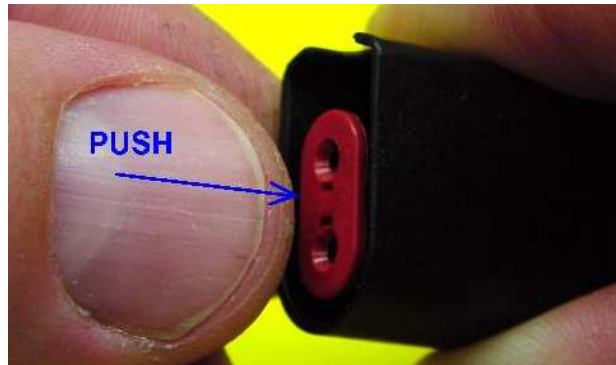

Note: If one or more contacts are not properly seated in the housing, the locking spacer cannot be closed. This condition is a warning for the user to correct. Also, when the locking spacer is not in final lock position, the connector cannot be successfully mated with the counterpart.

F – INSERTION OF CAVITY PLUGS

If using a sealed application, a cavity plug must be used to plug unused cavities, to sustain the sealed environment. Insert it deeply into the rear of the housing, approx. 4mm past flush with the back of the housing:

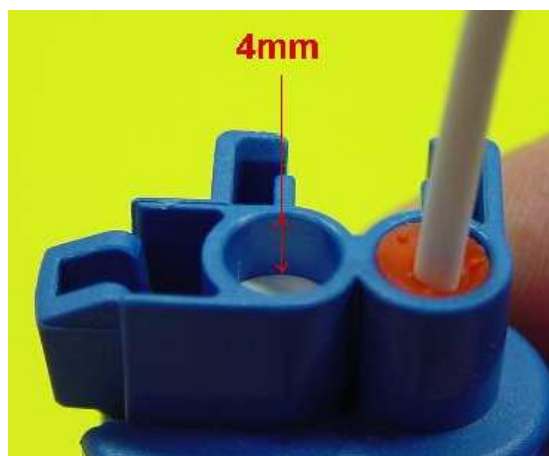

If removal of a cavity plug is necessary, it can be removed by pushing from the front of the connector with a thin point. Do not reuse the cavity plug if damaged.

G – REMOVAL OF CONTACTS

The locking spacer must be first removed from the housings to gain access to the primary locking arm inside the housings.

G1 - Removal of socket contacts.

G1.1: The locking spacer must be firstly removed by wedging a small flat-blade screwdriver under the edge of the locking spacer and gently prying it up:



G1.2: The contacts can then be extracted by placing an extraction tool (or small screwdriver) between the contact and the tip of the primary locking arm and gently lifting it up to clear the contact:

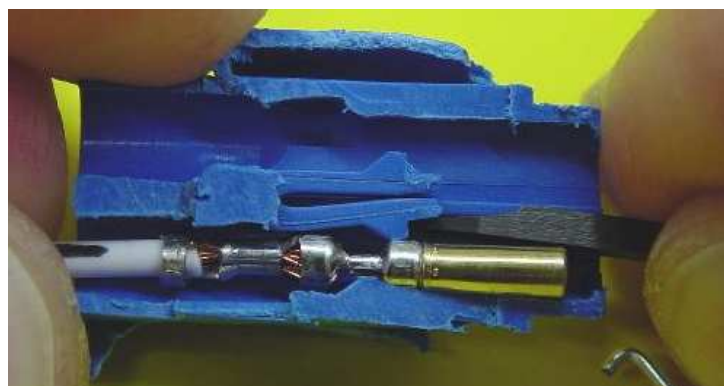
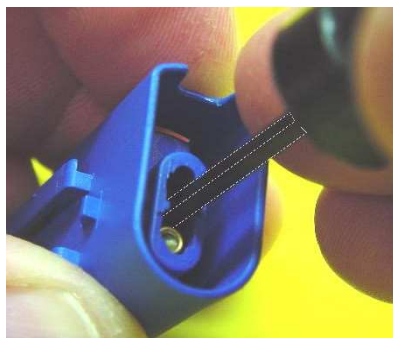

G2 - Removal of pin contacts.

G2.1: The locking spacer must be firstly removed by using a small hook placed in one of the extraction holes:

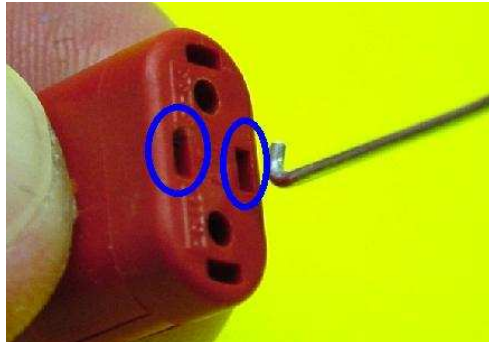

The tool is not provided by Tyco Electronics, but a suggested tip detail is suggested here:

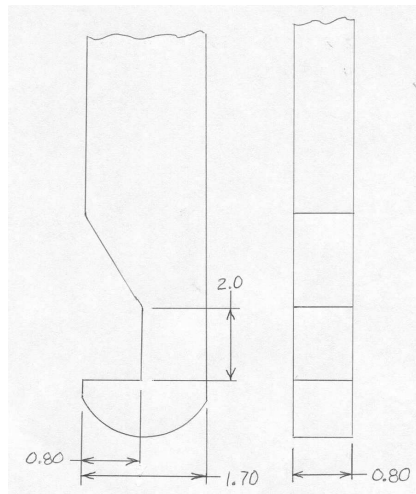

Firmly pull the spacer to remove it from the housing, being careful not to damage it in the process:



G2.2: The contacts can then be extracted by placing an extraction tool (or small screwdriver) between the contact and the tip of the primary locking arm and gently lifting it up to clear the contact. (see G1.2).

H – PANEL MOUNT OPTION

The socket housings can be provided with rails in which can be inserted a special panel clip.

These clips are not manufactured or sold by Tyco: they can have different shapes, according to the individual application.

An example is shown here below, using TRW # 6475293801:

