

THIS DRAWING IS UNPUBLISHED. RELEASED FOR PUBLICATION 20  
 © COPYRIGHT 20 BY - TE CONNECTIVITY CORPORATION ALL RIGHTS RESERVED.

REVISIONS					
P	LTR	DESCRIPTION	DATE	DWN	APVD
A		RELEASE	17JAN2013	D.C.	P.Y.
A1		ECR-13-013853	22AUG2013	D.C.	X.X.

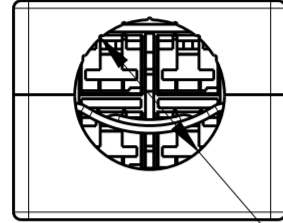

Ø19.8 REF.

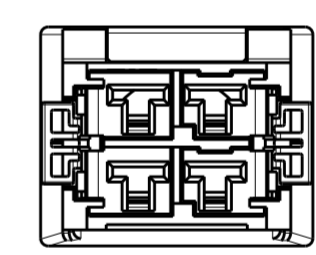
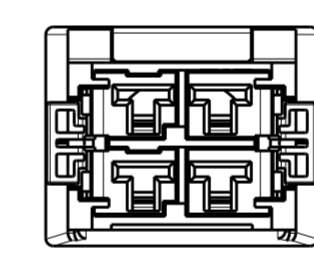
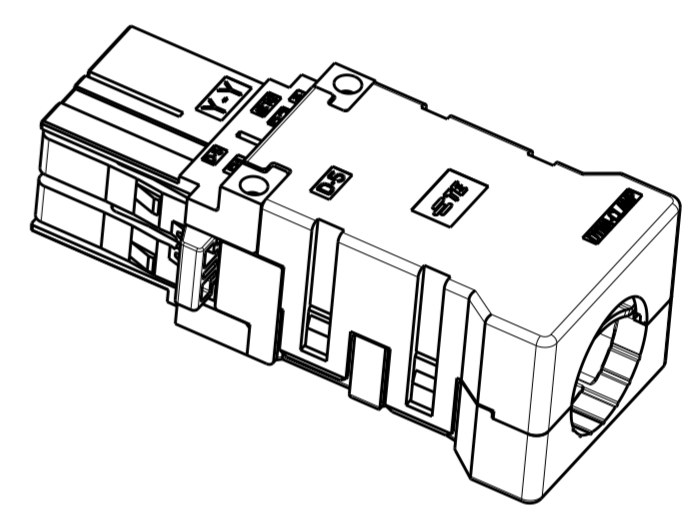
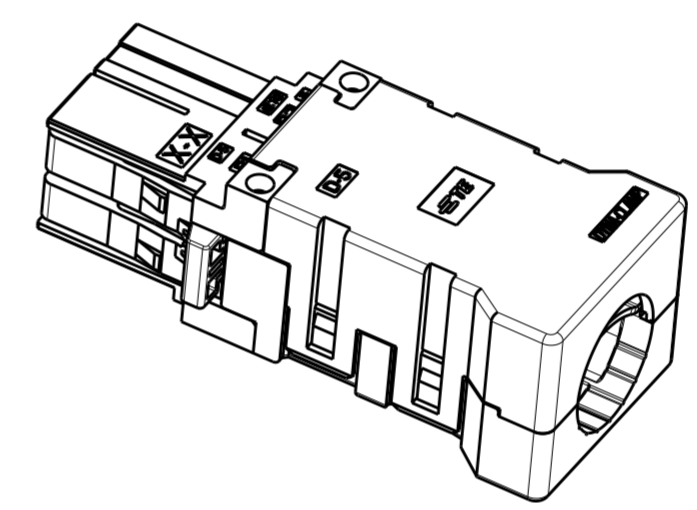
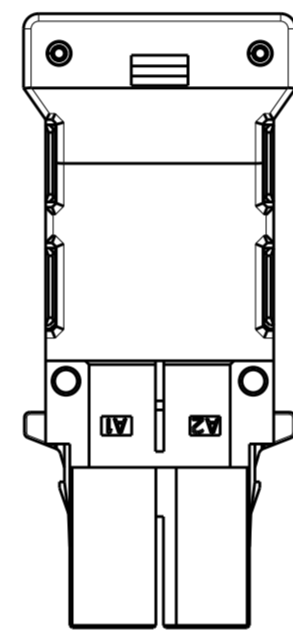
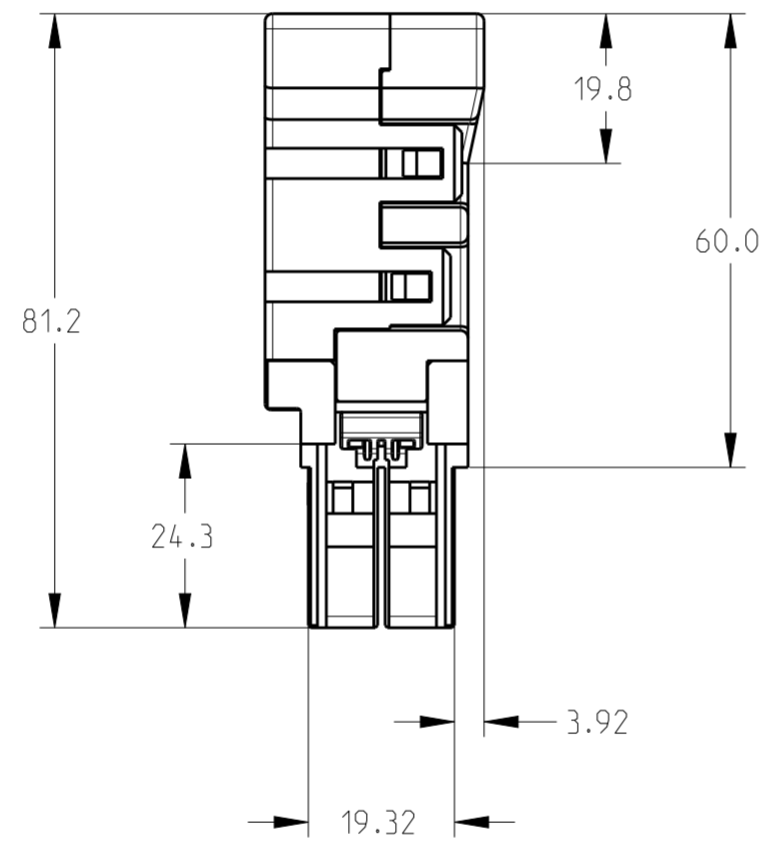
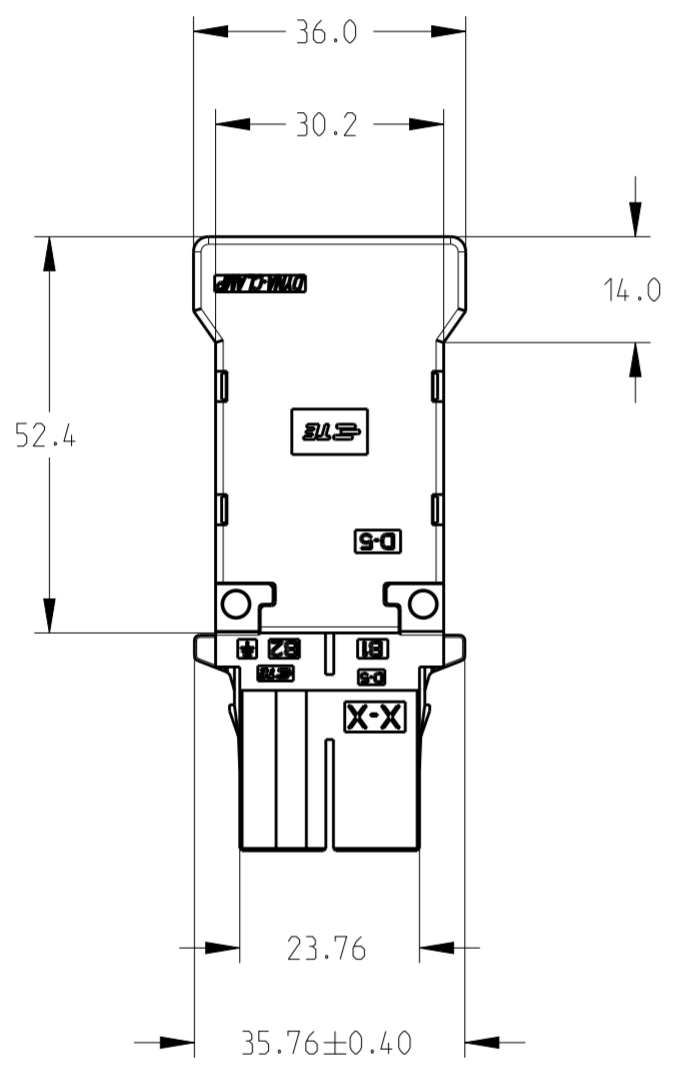
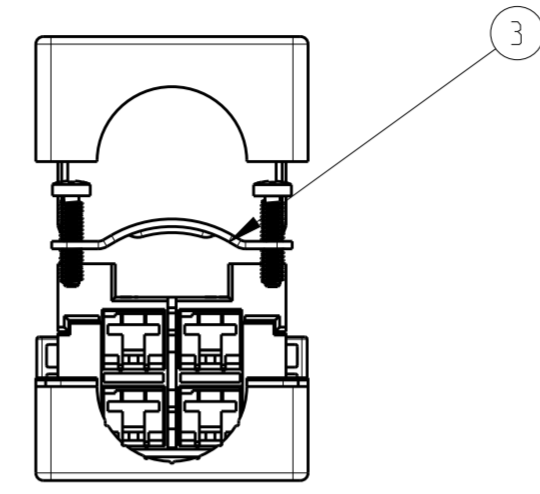
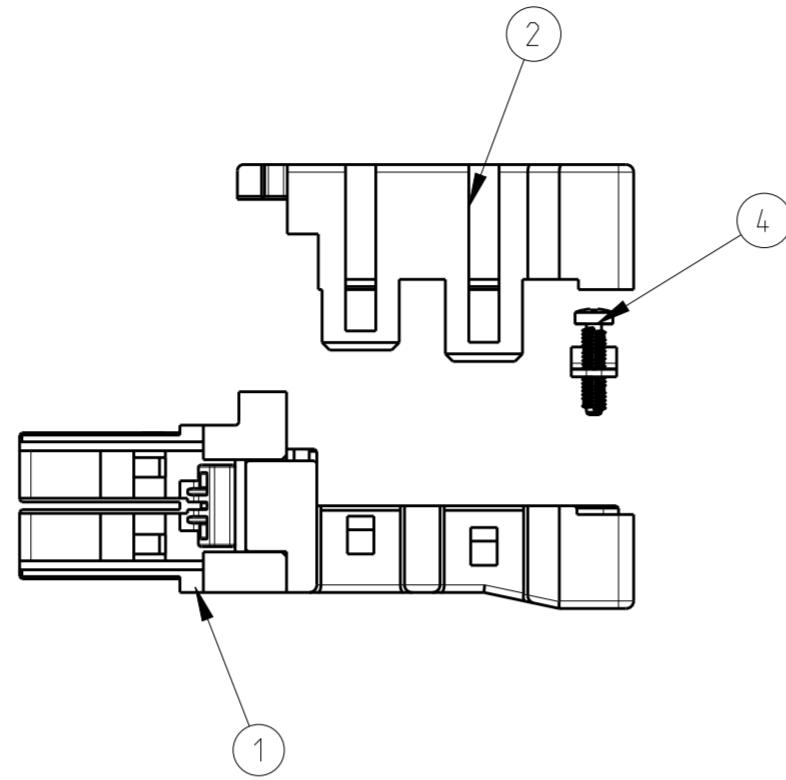

KEY: X-X  
 P/N: 1971239-1  
 COLOR: BLACK

KEY: Y-Y  
 P/N: 1971239-2  
 CPLOR: BLACK

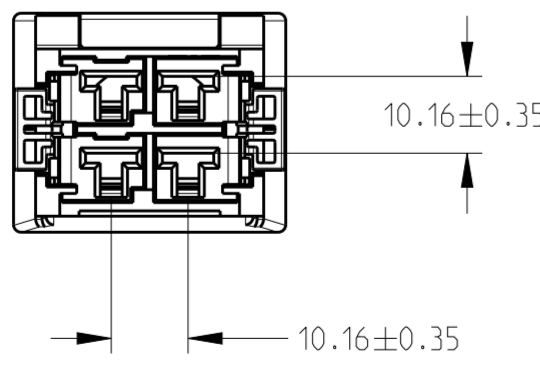

NOTE:  
 1. APPLICABLE WIRE OD: Ø:14.8~19.3mm  
 2. APPLICATION PROCESS SEE SHEET 2

Q'TY	FINISH, MATERIAL	DESCRIPTION	ITEM
2	STAINLESS STEEL	BAIND SMALL SCREW M3X12	4
1	STAINLESS STEEL	CABLE CLAMP	3
1	GLASS FILLED THERMO PLASTIC POLYESTER(UL 94V-0) (BLACK)	COVER	2
1	RIVET:ALUMINUM, BIT INSERT:BRASS/Ni PL OVER Cu PL. HSG:GLASS FILLED THERMO PLASTIC POLYESTER(UL 94V-0)(BLACK)	REC SUB ASSY	1

THIS DRAWING IS A CONTROLLED DOCUMENT.		DWN DANNY CHEN 17JAN2013	TE Connectivity	
DIMENSIONS: mm		CHK DAVID WANG 17JAN2013		
TOLERANCES UNLESS OTHERWISE SPECIFIED:		APVD PETER YIN 17JAN2013	NAME D5200 REC CABLE CLAMP 4P(2ROW) KIT (CABLE OD:14.8~19.3mm)	
0 PLC ±		PRODUCT SPEC	SIZE	
1 PLC ±0.5		APPLICATION SPEC	CAGE CODE	
2 PLC ±0.30		WEIGHT	DRAWING NO	
3 PLC ±		Customer Drawing	RESTRICTED TO	
4 PLC ±			A2100779 C-1971239	
ANGLES ±			SCALE 1:1 SHEET 1 OF 2 REV A1	
FINISH				

THIS DRAWING IS UNPUBLISHED. RELEASED FOR PUBLICATION 20  
 © COPYRIGHT 20 BY - TE CONNECTIVITY CORPORATION ALL RIGHTS RESERVED.

REVISIONS					
P	LTR	DESCRIPTION	DATE	DWN	APVD
-		SEE SHEET 1	-	-	-

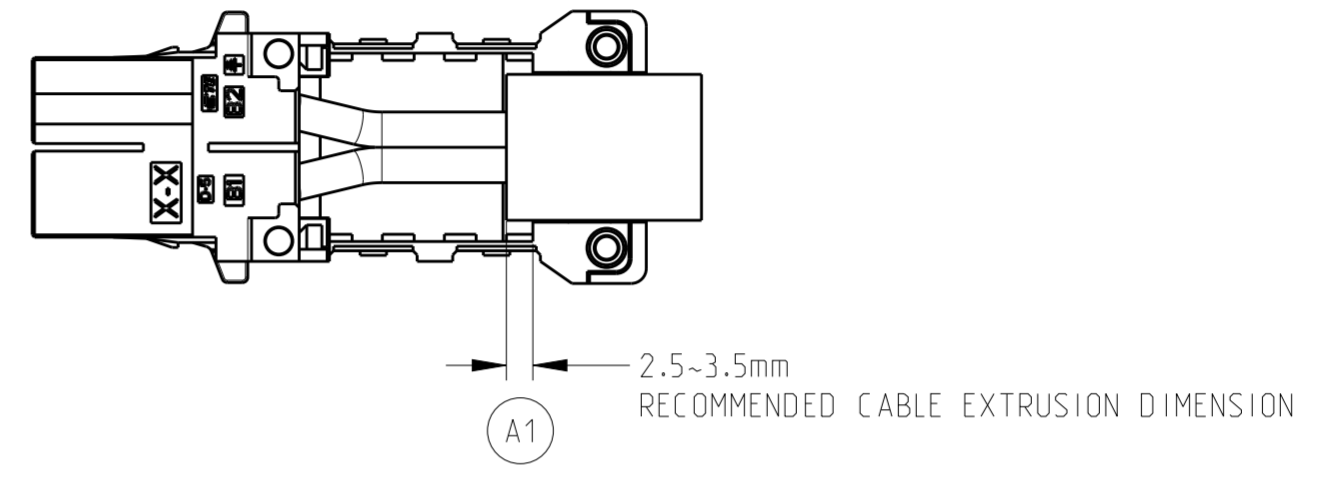
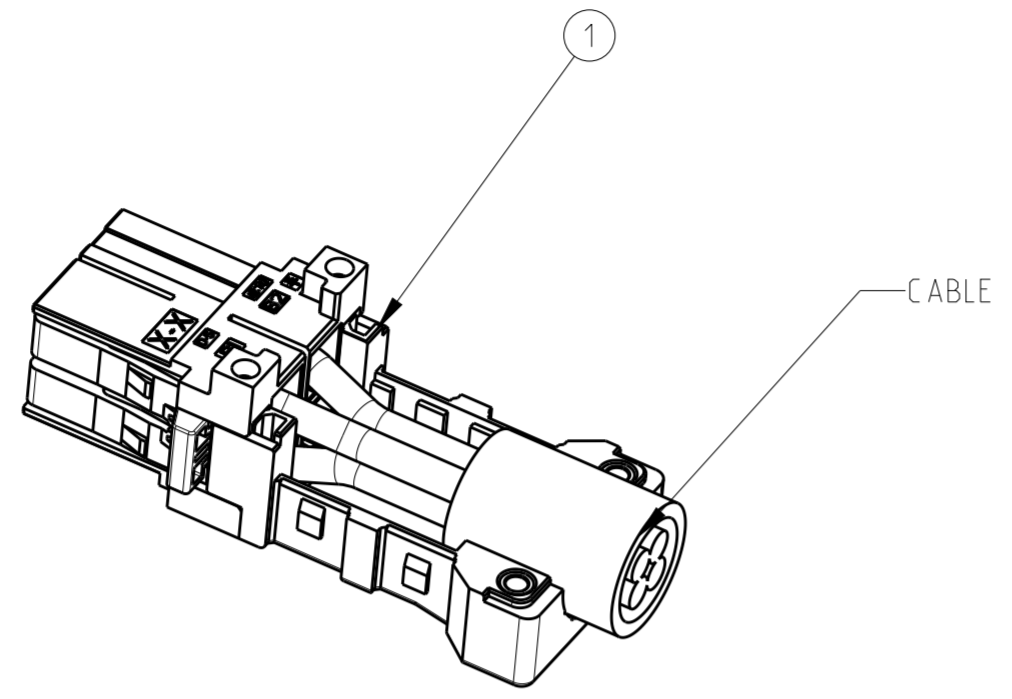

STEP 1

AFTER CRIMPING FOUR CONTACTS WITH WIRES, INSERT CABLE WITH CRIMPED CONTACT TO REC HOUSING AND MAKE THE CABLE THE RIGHT POSITION OF REC SUB ASSY

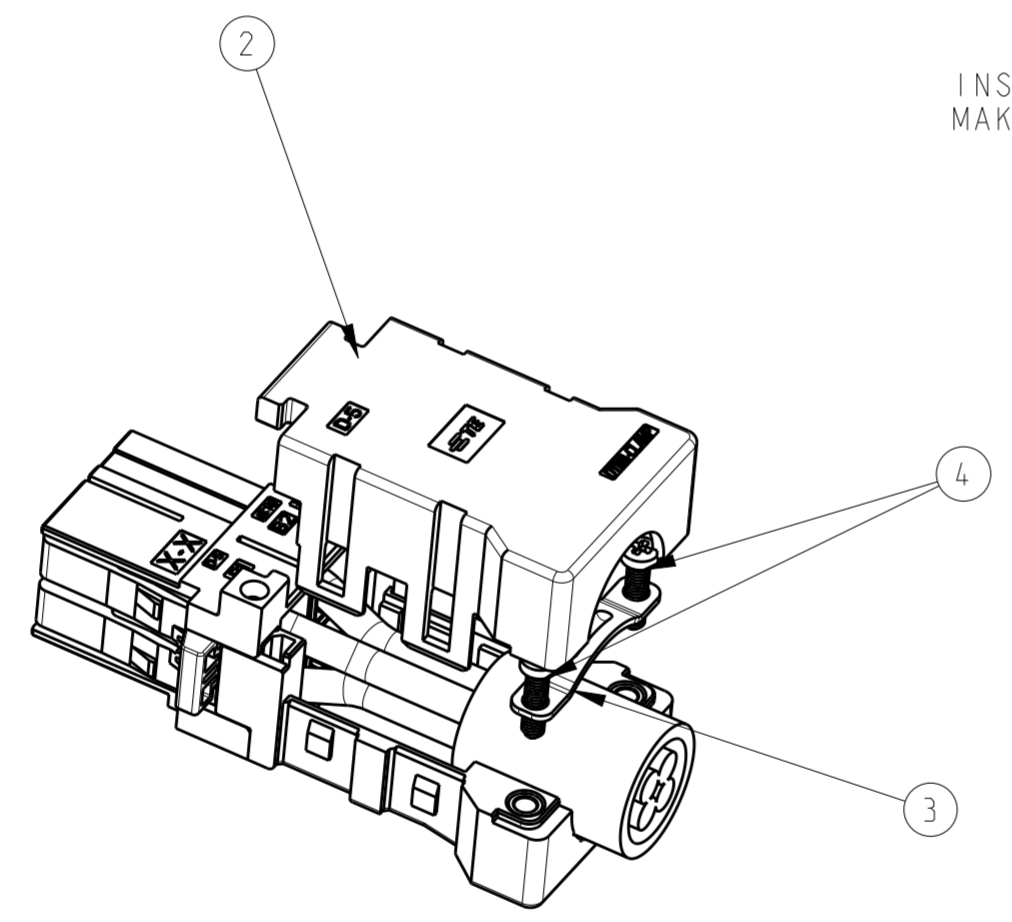

STEP 2

PUT A CABLE CLAMP ON A JACKET BINDS, AND FIX A M3X9 BIND SCREW TIGHT ON THE BASE HOUSING. PLEASE GIVE THE BOLTING TORQUE OF A SCREW AS ABOUT 2.2~2.8KGF.CM

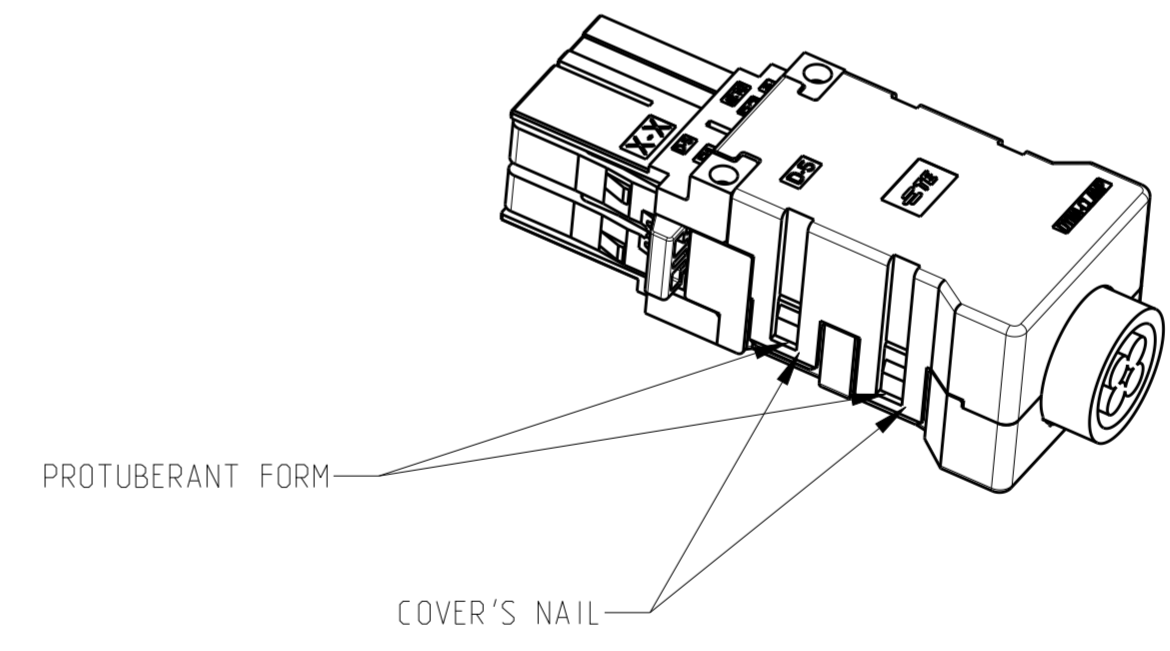

STEP 3

FIT COVER ONTO BASE HOUSING CERTAINLY UNTIL IT SOUNDS CLEAR LOCK FEELING. IN THIS TIME, CONFIRM COVER'S FOUR NAILS ARE SURE TO SCRATCH THE PROTUBERANT FORM OF REC SUB ASSY

THIS DRAWING IS A CONTROLLED DOCUMENT.		DWN DANNY CHEN 17 JAN 2013	TE Connectivity																						
		CHK DAVID WANG 17 JAN 2013																							
		APVD PETER YIN 17 JAN 2013	NAME D5200 REC CABLE CLAMP 4P(2ROW) KIT (CABLE OD:14.8~19.3mm)																						
DIMENSIONS: mm		PRODUCT SPEC																							
TOLERANCES UNLESS OTHERWISE SPECIFIED:		APPLICATION SPEC																							
<table border="0"> <tr><td>0 PLC</td><td>±</td><td></td></tr> <tr><td>1 PLC</td><td>±0.5</td><td></td></tr> <tr><td>2 PLC</td><td>±0.30</td><td></td></tr> <tr><td>3 PLC</td><td>±</td><td></td></tr> <tr><td>4 PLC</td><td>±</td><td></td></tr> <tr><td>ANGLES</td><td>±</td><td></td></tr> <tr><td>FINISH</td><td></td><td></td></tr> </table>		0 PLC	±		1 PLC	±0.5		2 PLC	±0.30		3 PLC	±		4 PLC	±		ANGLES	±		FINISH			WEIGHT		
0 PLC	±																								
1 PLC	±0.5																								
2 PLC	±0.30																								
3 PLC	±																								
4 PLC	±																								
ANGLES	±																								
FINISH																									
MATERIAL		RESTRICTED TO																							
		SIZE A2		CAGE CODE 00779																					
		DRAWING NO C-1971239		SCALE 1:1																					
		SHEET 2 OF 2		REV A1																					
		Customer Drawing																							