

P	LTR	DESCRIPTION	DATE	DWN	APVD
A		RELEASE TO PRODUCTION	26AUG2019	AY	PS
A1		REMOVED TOLERANCE FROM DIM F	17DEC2019	AY	PS
A3		PARTS OBSOLESCENCE	21JUN2023	BGC	PS

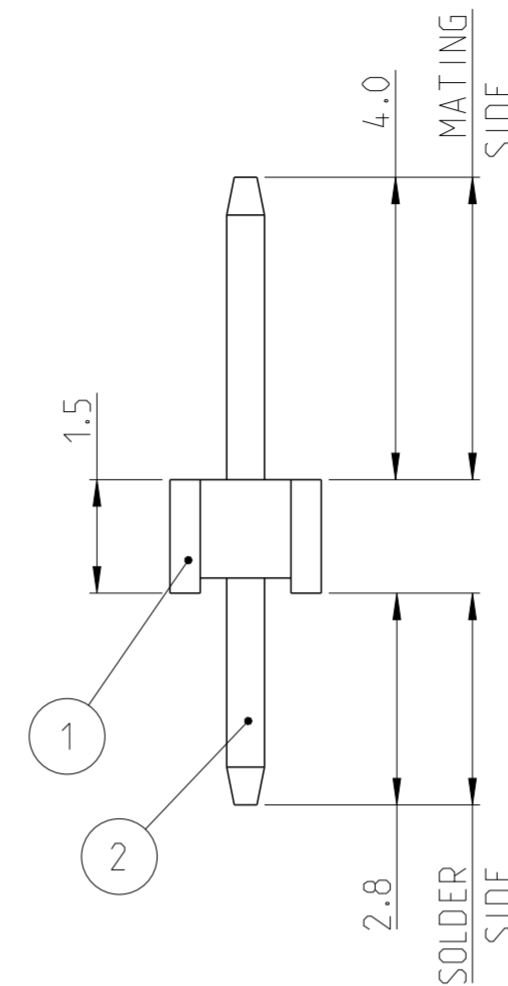

NOTES:

- MATERIAL  
HOUSING : HIGH TEMPERATURE THERMOPLASTIC, UL94-V0; COLOR- BLACK  
CONTACT PIN : COPPER ALLOY  
FINISH :  
MATING SIDE: MIN. 0.38 μm GOLD OVER NICKEL UNDER PLATING.  
SOLDER SIDE: MIN. 2.0 μm BRIGHT TIN OVER NICKEL UNDER PLATING.
- PACKAGING: BULK PACK.
- TOLERANCE NOT CUMULATIVE.
- CUTTING BURR MAX. 0.25 mm.

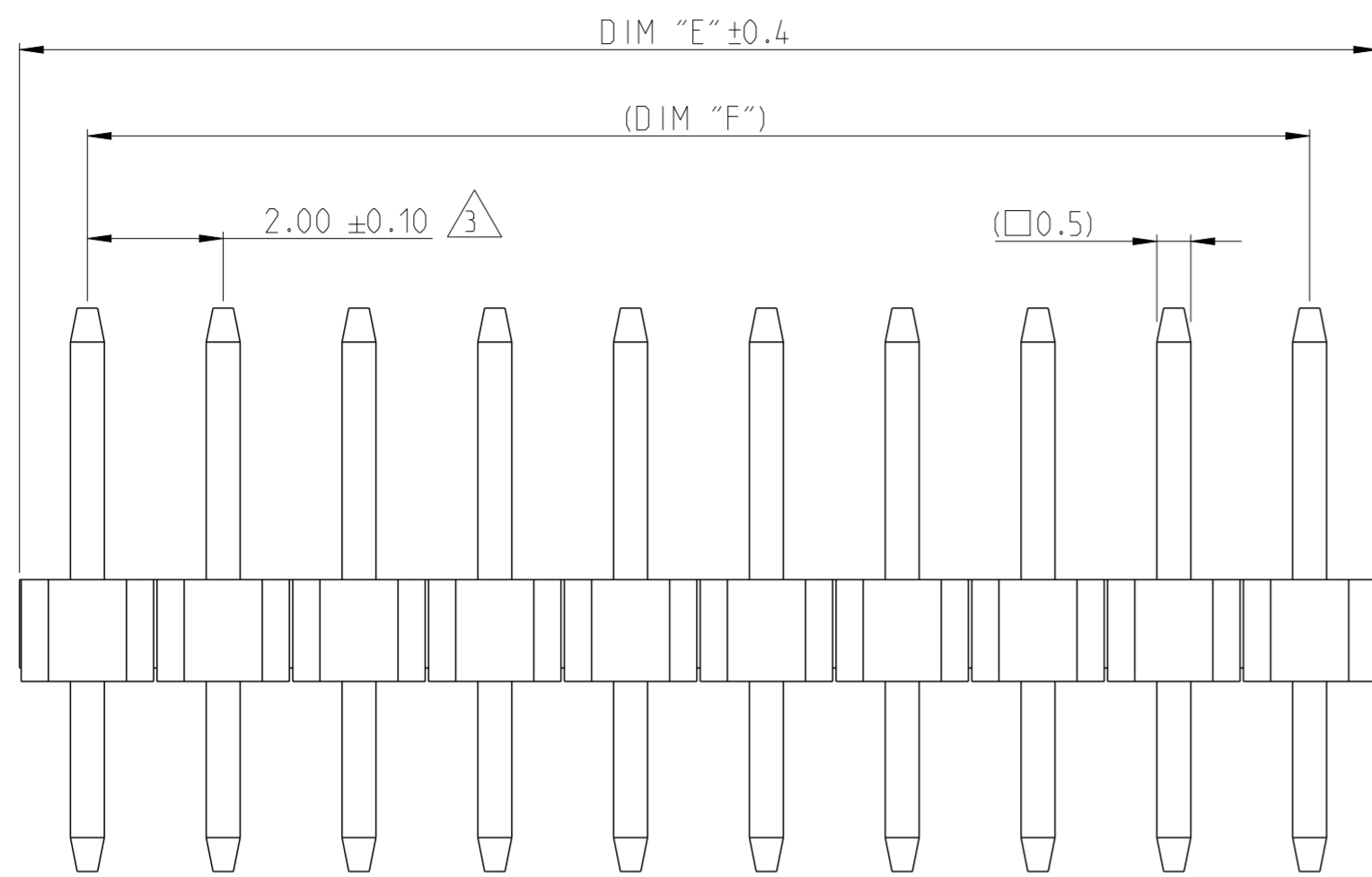
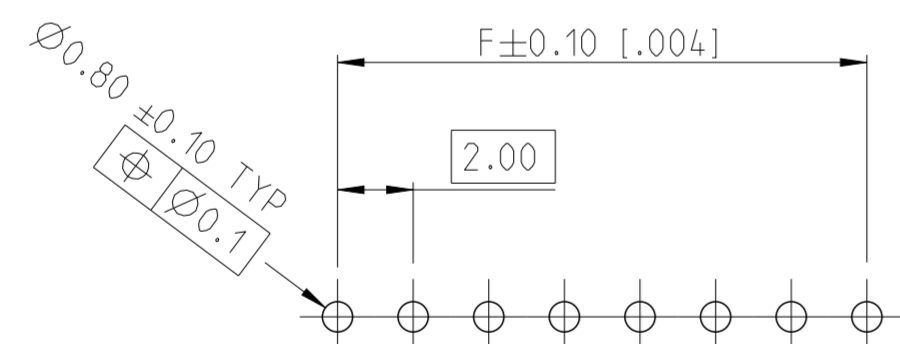
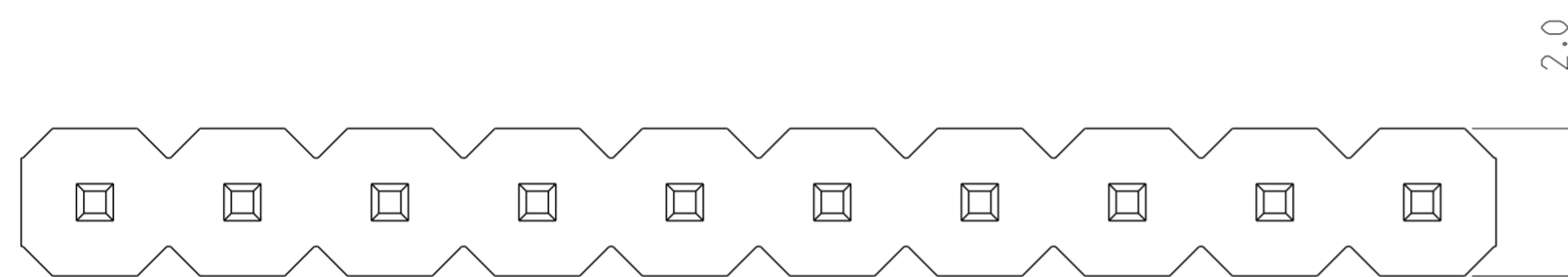

RECOMMENDED PCB HOLE PATTERN FOR THROUGH HOLE WAVE

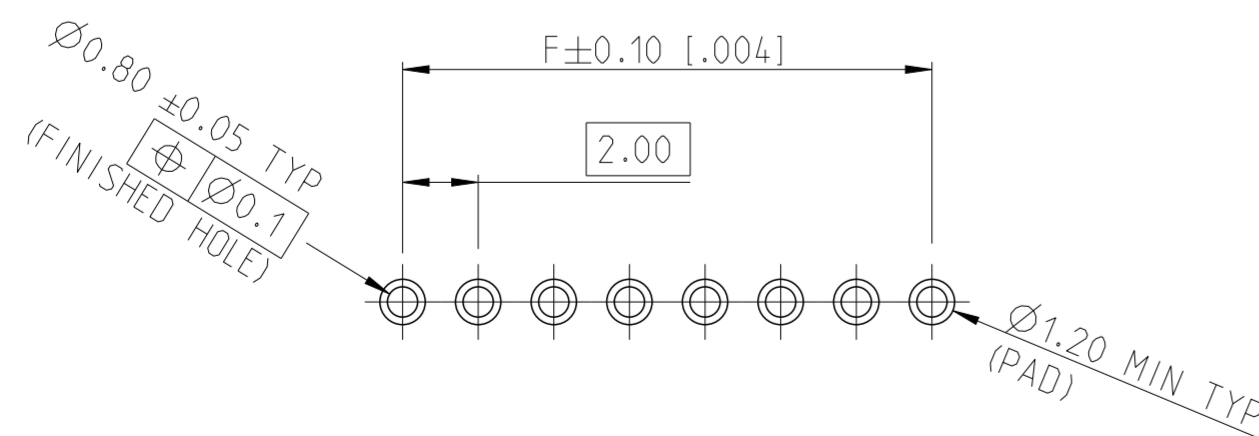

RECOMMENDED PCB HOLE PATTERN FOR THROUGH HOLE REFLOW / PIN-IN-PASTE

1-2355181-0 AS SHOWN

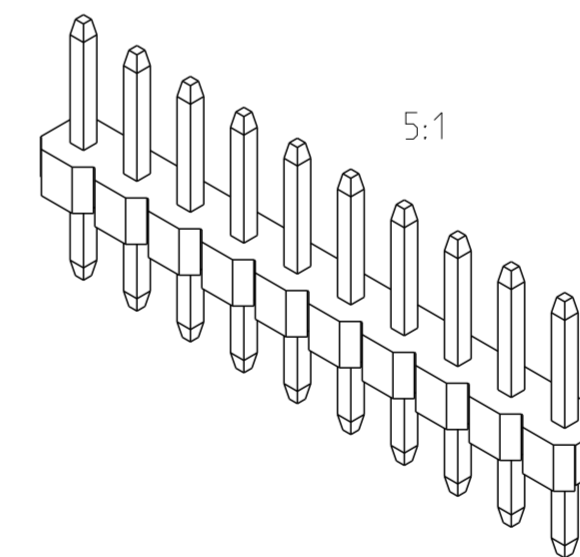

Length (mm)	Width (mm)	Position	Part Number
48.0	50.0	25	2-2355181-5
46.0	48.0	24	2-2355181-4
44.0	46.0	23	2-2355181-3
42.0	44.0	22	2-2355181-2
40.0	42.0	21	2-2355181-1
38.0	40.0	20	2-2355181-0
36.0	38.0	19	1-2355181-9
34.0	36.0	18	1-2355181-8
32.0	34.0	17	1-2355181-7
30.0	32.0	16	1-2355181-6
28.0	30.0	15	1-2355181-5
26.0	28.0	14	1-2355181-4
24.0	26.0	13	1-2355181-3
22.0	24.0	12	1-2355181-2
20.0	22.0	11	1-2355181-1
18.0	20.0	10	1-2355181-0
OBSOLETE	16.0	9	2355181-9
OBSOLETE	14.0	8	2355181-8
OBSOLETE	12.0	7	2355181-7
	10.0	6	2355181-6
	8.0	5	2355181-5
	6.0	4	2355181-4
	4.0	3	2355181-3
	2.0	2	2355181-2
DIM "F"	DIM "E"	POS	TE PN

THIS DRAWING IS A CONTROLLED DOCUMENT.

DIMENSIONS: mm

TOLERANCES UNLESS OTHERWISE SPECIFIED:

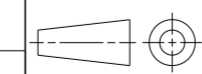

0 PLC ±  
1 PLC ±0.2  
2 PLC ±0.15  
3 PLC ±  
4 PLC ±  
ANGLES ±2°  
FINISH

MATERIAL

SEE NOTES

DWN 09APR2019  
RAGHAVENDRA.K  
CHK 14AUG2019  
KARTHIK.JK  
APVD 16AUG2019  
PRASHANTH  
PRODUCT SPEC

108-64040  
APPLICATION SPEC  
114-32259

WEIGHT -

CUSTOMER DRAWING

**STE** TE Connectivity

NAME: AMPMODU 2mm BREAKAWAY HEADER, SINGLE ROW, VERTICAL, 0.38 Au, BULK

SIZE	CAGE CODE	DRAWING NO	RESTRICTED TO
A2	00779	C-2355181	-

SCALE 10:1 SHEET 1 OF 1 REV A2

CONTACT PIN	2
HOUSING	1
DESCRIPTION	ITEM NO.