

P	LTR	DESCRIPTION	DATE	DWN	APVD
A		RELEASE TO PRODUCTION	26AUG2019	AY	PS
A1		REMOVED TOLERANCE FROM DIM F	17DEC2019	AY	PS
A2		PARTS OBSOLESCENCE	22JUN2023	BGC	PS

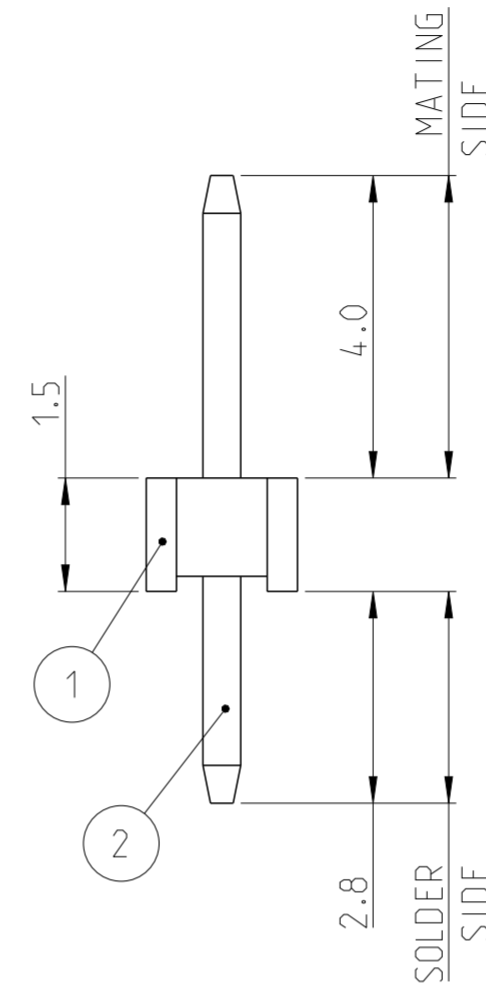

NOTES:

- MATERIAL
HOUSING : HIGH TEMPERATURE THERMOPLASTIC, UL94-V0; COLOR- BLACK
POST : COPPER ALLOY
FINISH :
MATING SIDE: MIN. 0.76 μ m GOLD OVER NICKEL UNDER PLATING.
SOLDER SIDE: MIN. 2.0 μ m BRIGHT TIN OVER NICKEL UNDER PLATING.
- PACKAGING: BULK PACK.
- TOLERANCE NOT CUMULATIVE.
- CUTTING BURR MAX. 0.25 mm.

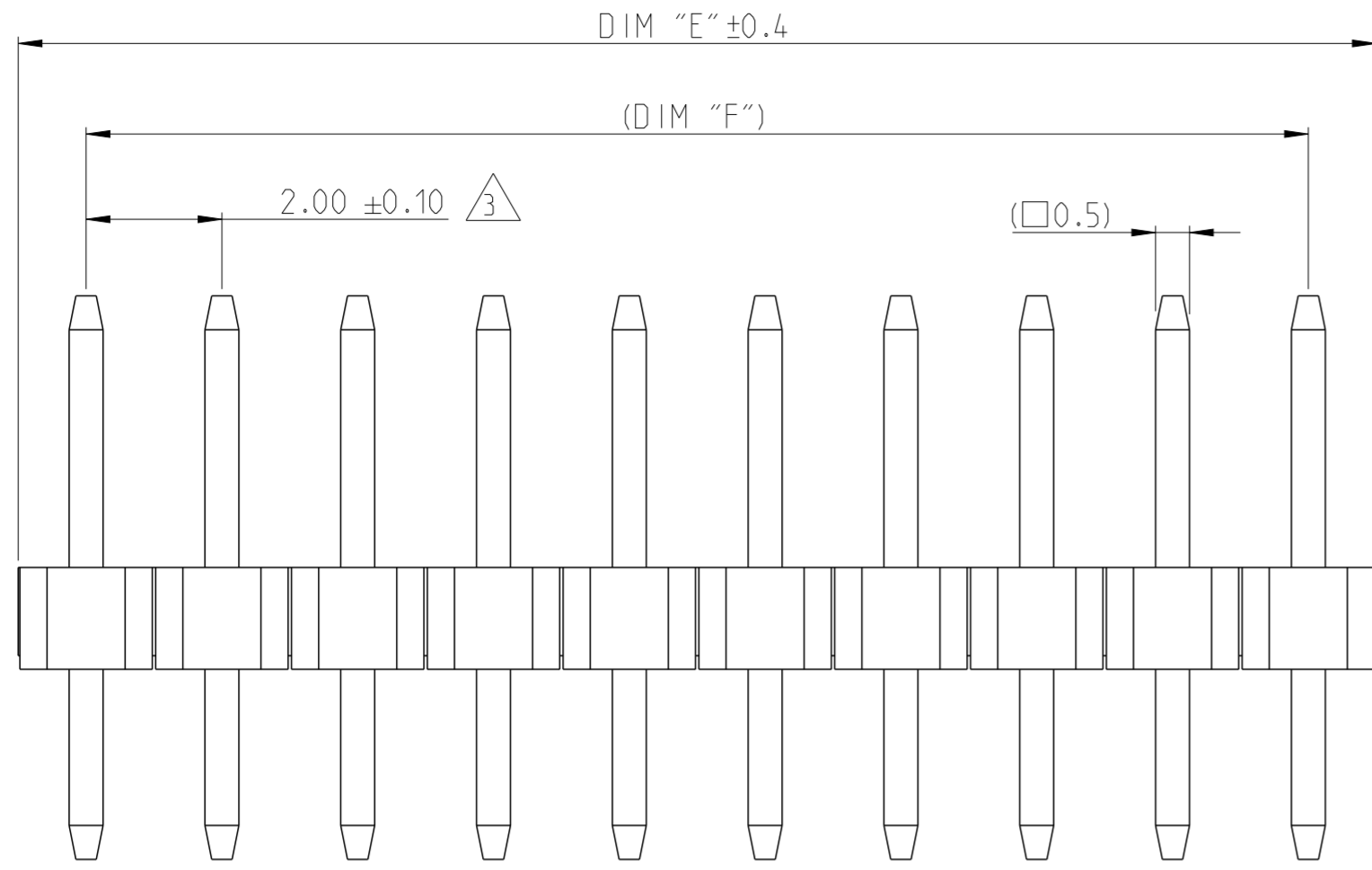
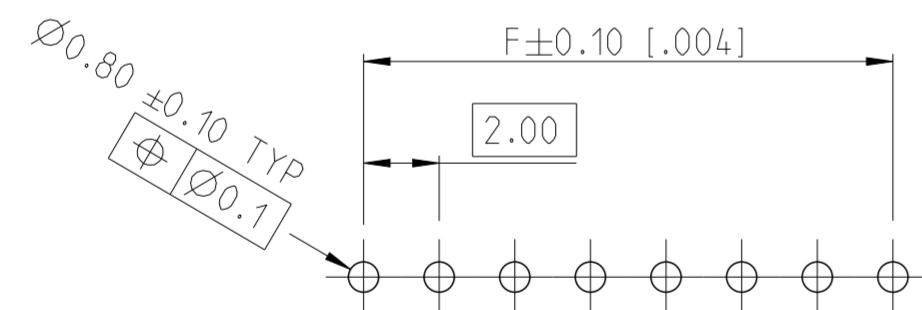
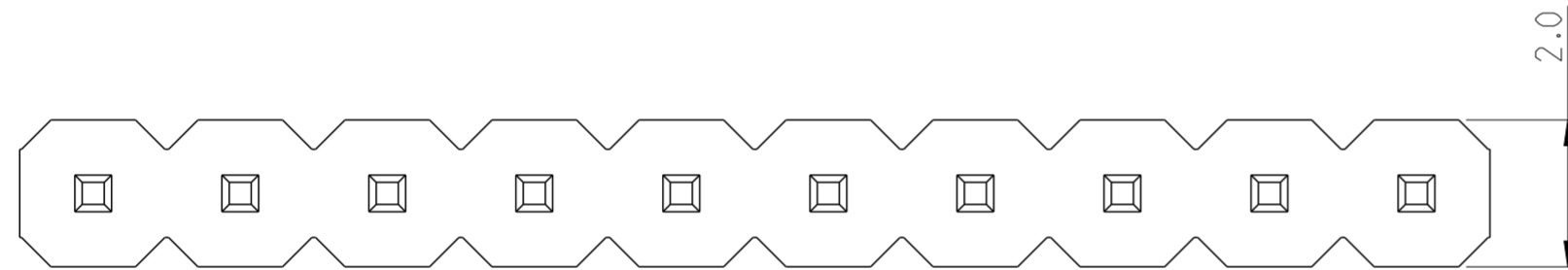

RECOMMENDED PCB HOLE PATTERN FOR THROUGH HOLE WAVE

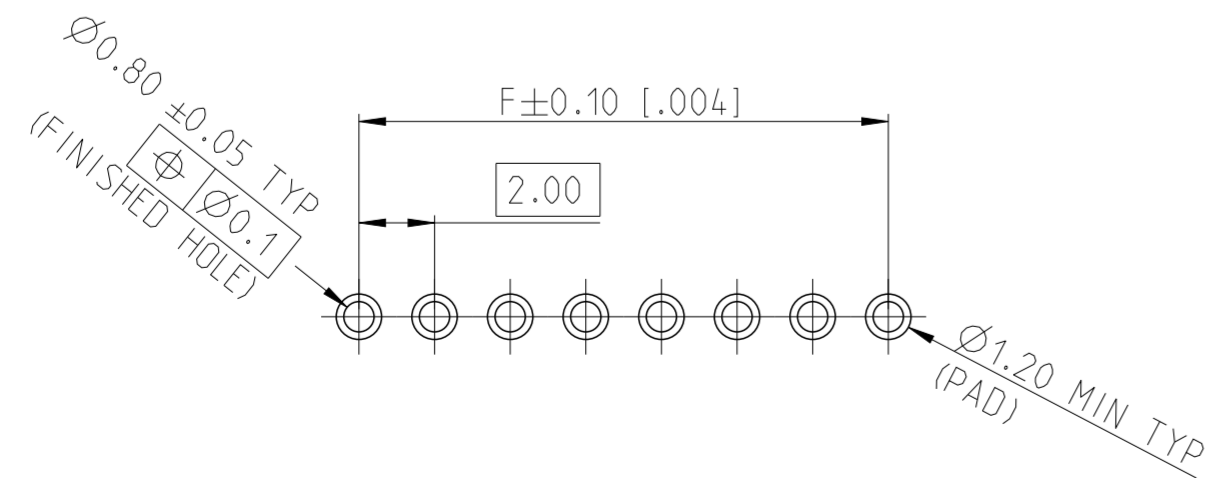

RECOMMENDED PCB HOLE PATTERN FOR THROUGH HOLE REFLOW / PIN-IN-PASTE

1-2355186-0 AS SHOWN

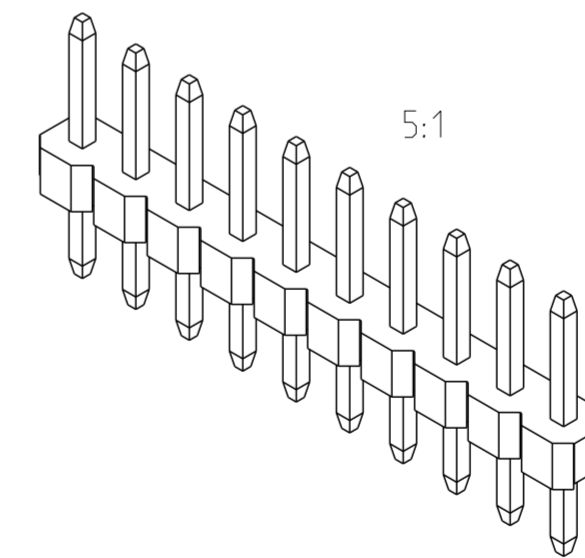

POS	DIM "E"	DIM "F"	TE PN
25	48.0	50.0	2-2355186-5
24	46.0	48.0	2-2355186-4
23	44.0	46.0	2-2355186-3
22	42.0	44.0	2-2355186-2
21	40.0	42.0	2-2355186-1
20	38.0	40.0	2-2355186-0
19	36.0	38.0	1-2355186-9
18	34.0	36.0	1-2355186-8
17	32.0	34.0	1-2355186-7
16	30.0	32.0	1-2355186-6
15	28.0	30.0	1-2355186-5
14	26.0	28.0	1-2355186-4
13	24.0	26.0	1-2355186-3
12	22.0	24.0	1-2355186-2
11	20.0	22.0	1-2355186-1
10	18.0	20.0	1-2355186-0
9	16.0	18.0	2355186-9
8	14.0	16.0	2355186-8
7	12.0	14.0	2355186-7
6	10.0	12.0	2355186-6
5	8.0	10.0	2355186-5
4	6.0	8.0	2355186-4
3	4.0	6.0	2355186-3
2	2.0	4.0	2355186-2

THIS DRAWING IS A CONTROLLED DOCUMENT.

DIMENSIONS:
mm

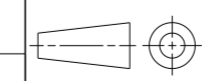

TOLERANCES UNLESS OTHERWISE SPECIFIED:

0 PLC ±
1 PLC ±0.2
2 PLC ±0.15
3 PLC ±
4 PLC ±
ANGLES ±2°
FINISH

DWN 09APR2019
RAGHAVENDRA.K
CHK 14AUG2019
KARTHIK.JK
APVD 16AUG2019
PRASHANTH
PRODUCT SPEC

108-64040
APPLICATION SPEC
114-32259

WEIGHT -

CUSTOMER DRAWING

STE TE Connectivity

NAME: AMPMODU 2mm BREAKAWAY HEADER, SINGLE ROW, VERTICAL, 0.76 Au, BULK

SIZE	CAGE CODE	DRAWING NO	RESTRICTED TO
A2	00779	C-2355186	-

SCALE 10:1 SHEET 1 OF 1 REV A2

CONTACT PIN	2
HOUSING	1
DESCRIPTION	ITEM NO.