

4

3

2

1

THIS DRAWING IS UNPUBLISHED. RELEASED FOR PUBLICATION 20
 © COPYRIGHT 20 BY - ALL RIGHTS RESERVED.

REVISIONS				
P	LYR	DESCRIPTION	DATE	DWN APVD
	A	FIRST VERSION	18OCT2018	G.F S.M
	A1	ECR-19-005614 UPDATE LAYOUT DIMENSION	08APR2019	G.F S.M

NOTES :

MATERIALS AND FINISH:
 - HOUSING: HIGH TEMPERATURE RESIN, NATURAL
 - CONTACTS: COPPER ALLOY, FINISH: PRE-TIN OVER NICKEL UNDERPLATE

- MUST COMPLY WITH DIRECTIVE 2002/95/EC (ROHS)
- WIRE TYPES AND SIZES ACCEPTED
 SOLID WIRE: 18AWG, 20AWG, 22AWG, 16AWG (ONLY ONE TIME INSERTING)
 STRANDED WIRE(TIN-DIPPED): 18AWG; 20AWG; 22AWG
 MAX INSULATION OD: 2.05mm MAX.
 STRIP LENGTH: 8.0±0.5mm
- PACKAGED IN TAPE AND REEL

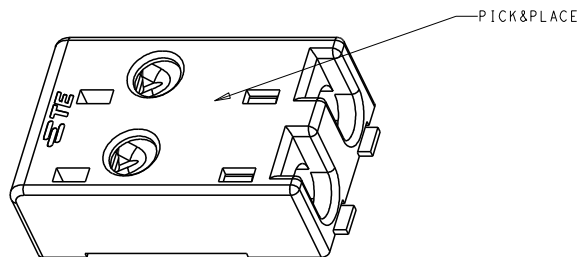
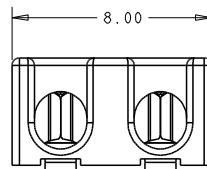
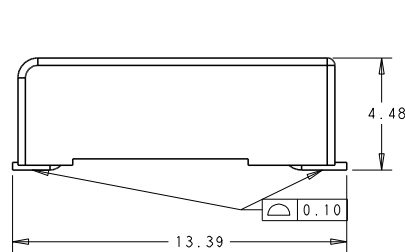
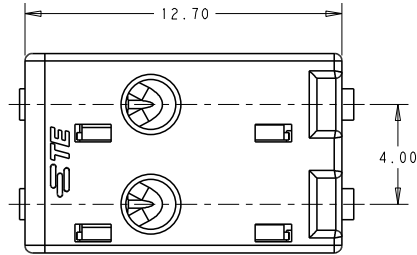

P/N: 2834385-2

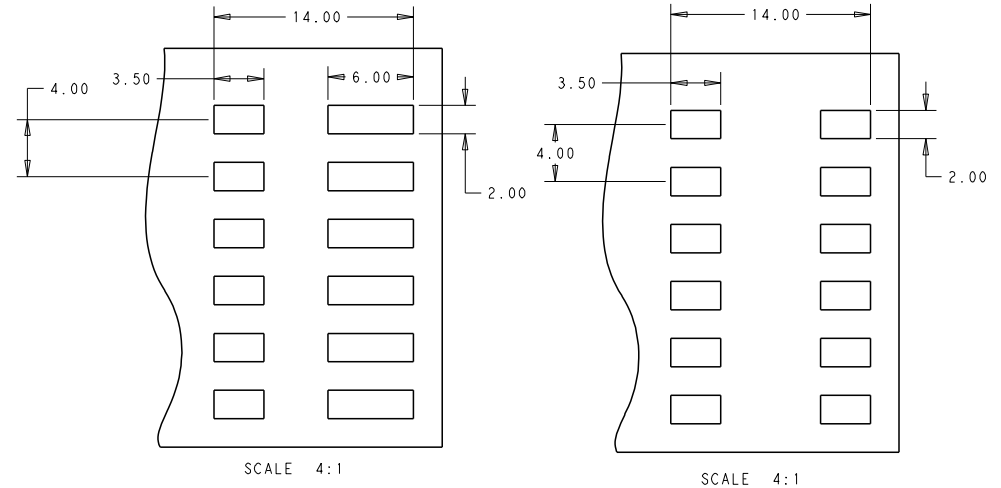

THIS DRAWING IS A CONTROLLED DOCUMENT.		DWN - GEORGE FU 18OCT2018	STE TE Connectivity
		CHK - GEORGE FU 18OCT2018	
		APVD - GEORGE FU 18OCT2018	NAME 2P CONNECTOR ASSEMBLY RELEASEABLE POKE-IN
		PRODUCT SPEC SHELL MING 108-137055	
DIMENSIONS: (mm)		APPLICATION SPEC 114-137055	SIZE CAGE CODE DRAWING NO
TOLERANCES UNLESS OTHERWISE SPECIFIED:		WEIGHT -	A200779 ©=2834385
0 PLC ±-	1 PLC ±0.2	CUSTOMER DRAWING	RESTRICTED TO
2 PLC ±0.13	3 PLC ±-	SCALE 2:1	SHEET 1 OF 1
4 PLC ±-	ANGLES ±-		REV A1
MATERIAL SEE NOTE	FINISH SEE NOTE		