

Battery Disconnecter 2x300A Page 1 of

For this drawing we reserve the copyright in accordance with DIN ISO 16016

Technical Data:

Case Material	PA GF black
Switch Lever Material	PA GF red
Min. Insulation Resistance	100MΩ
Dielectric Withstanding Voltage	1050V-1min.
Max. Contact Drop during Resistive Load	150mV
Voltage	up to 32VDC
Duty Rating	2x 300A
Overload	2x 500A-180sec. 2x 1000A-30sec.
Sealing	IP 67/ IEC 529
Vibration	4G/ 50-2000Hz
Shock G-Lever	6G/ 11ms
Weight	~420g / 0.93 pound
Temperature Range	-40°C to +85°C
Wire Section (At Nominal Load)	min. 95mm ²
Mounting Position	optional
Switch Lever	not removeable
Torque (Main Terminals)	15-20Nm

Date	Name	mm	Scale	Drawing No.
Create 17.05.2006	Mielk	General Tolerances	1:2	35-323-151-R
Edited 03.03.2020	Seeger			
Check 10.03.2020	Grind			

NSN:

REVISIONS					
P	LTR	DESCRIPTION	DATE	DWN	APVD
	A	TE STANDARD UPDATED	06JUN2024	KS	RB

NOTE
Bemerkungen:

1 TE-CONNECTIVITY ORDER-NUMBER
TE-connectivity Bestellnummer

2 DO NOT SWITCH UNDER LOAD!
Nicht unter Last schalten!

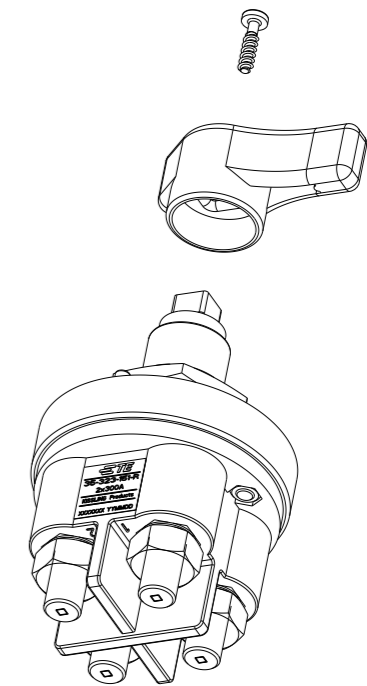

K1127651	A	BATTERY DISCONNECTOR 2x300A Batterietrennschalter 2x300A	1
TE ORDER-NO.	REV.	DESCRIPTION	ITEM NO



THIS DRAWING IS A CONTROLLED DOCUMENT.		DWN N.Mielke 17MAY2006												
DIMENSIONS: mm		CHK K.Seeger 03MAR2020												
TOLERANCES UNLESS OTHERWISE SPECIFIED: DIN ISO 2768 cl		APVD U.Grindemann 10MAR2020												
<table border="0"> <tr> <td>0 PLC</td> <td>±</td> </tr> <tr> <td>1 PLC</td> <td>±</td> </tr> <tr> <td>2 PLC</td> <td>±</td> </tr> <tr> <td>3 PLC</td> <td>±</td> </tr> <tr> <td>4 PLC</td> <td>±</td> </tr> <tr> <td>ANGLES</td> <td>±</td> </tr> </table>		0 PLC	±	1 PLC	±	2 PLC	±	3 PLC	±	4 PLC	±	ANGLES	±	PRODUCT SPEC
0 PLC	±													
1 PLC	±													
2 PLC	±													
3 PLC	±													
4 PLC	±													
ANGLES	±													
MATERIAL		APPLICATION SPEC												
FINISH		WEIGHT												
-		CUSTOMER DRAWING												

NAME BATTERY DISCONNECTOR 2x300A Batterietrennschalter 2x300A			
SIZE	CAGE CODE	DRAWING NO	RESTRICTED TO
A3	00779	35-323-151-R	-
SCALE		SHEET	REV
		1 OF 1	A